

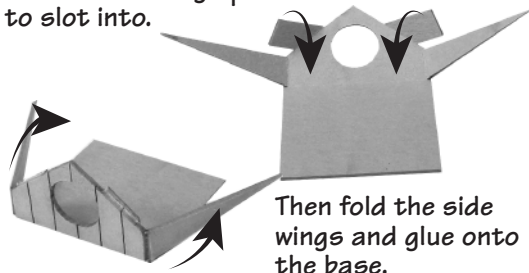
Fig. 7. DORMER CLOCK

First carefully cut free a clock from the selection below. If you would like a glass front to the clock simply glue the clock to a small piece of the clear glazing and then cut around the clock face.



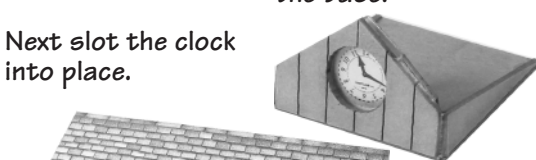
Like so.

Next fold back the tabs on the dormer face to create a snug space for the clock face to slot into.



Then fold the side wings and glue onto the base.

Next slot the clock into place.



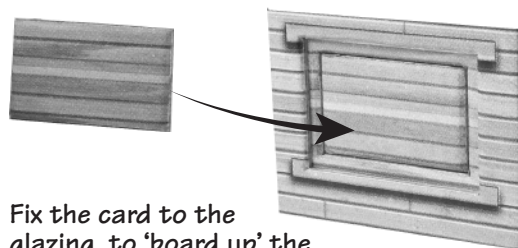
Now align the clock to the centre of the roof, with the back of the base flush to the roof join.

Then add the dormer roof.

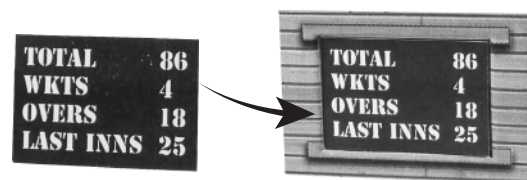


Fig. 8. NOTICE/SCORE BOARDS

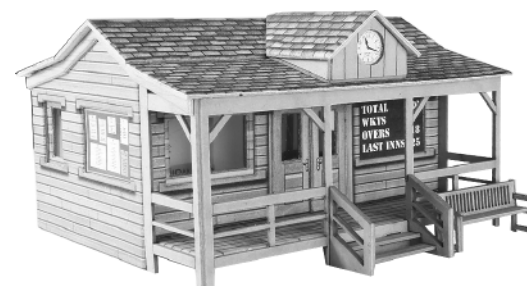
To add a notice or score board, first use the fills from the window frames, these are the rectangular bits of card that are pushed out for the windows.



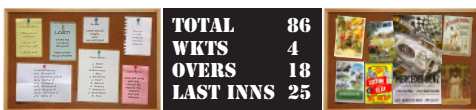
Fix the card to the glazing, to 'board up' the window.



Cut free the printed sign and it will fit snugly into the window frame.



Add some park benches (P0503) to complete the model.



PO410 OO/HO Scale WOODEN PAVILION

READ THROUGH ALL THE INSTRUCTIONS BEFORE YOU START.

To construct this kit you will need the following:

1. A Modellers knife.
2. A pair of sharp pointed scissors.
3. A steel ruler.
4. Glue - UHU Clear Adhesive is our favourite.
5. Ultra Fine Tip Glue Applicator, see right.
6. A cutting surface - a sheet of card or a cutting mat.
7. Fine point tweezers to hold the smaller components.
8. Water colour paints and a very fine brush, for painting the edges and corners.

GETTING STARTED

To stop the components from falling off the sheets, they are held secure with score lines. These are cuts that only go about 75% of the way through the card. To release them simply run the point of your knife along the score lines and they will come seamlessly away.

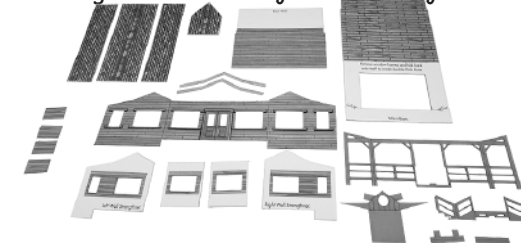
These score lines are indicated with blue arrows: WARNING, Cut with care using a knife that is not too sharp, this will reduce the risk of the blade running out of the score and cutting the kit components.

The score lines on the laser cut card components are indicated by an extended score line.

Extract all the components from each of the sheets.

Keep some of the printed card from the window frames and wall strengtheners for use in making notice/score boards (see fig. 8)

Place these components neatly in a tray or separate piece of thick card away from your working area to create your builders yard.



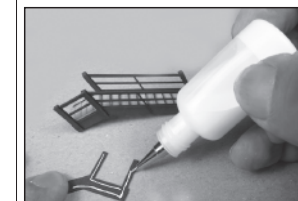
INSTRUCTION SHEET

CHECK LIST

This kit pack should contain the following:

- 1 x SHEET A - Printed card components
- 1 x LIGHT BROWN CARD - Laser cut parts
- 1 x INSTRUCTION SHEETS.
- 1 x Plain Glazing sheet.

The METCALFE Ultra Fine Tip Glue Bottles are essential for gluing the smaller components in this kit.



Tiny strips or spots of glue can be accurately laid down with precision.

Always replace the pin after use and store the bottles upside down to keep the glue moist.



UHU All Purpose Adhesive Glue

Is available in standard and solvent free. Both types are fine for use in our glue bottles, even though the instructions on the back of the packs warn against solvent based glues, we have tested the UHU solvent based glue and it works fine. The solvent free glue doesn't string as much, but can be a little harder to clean off if it drips onto unwanted areas.

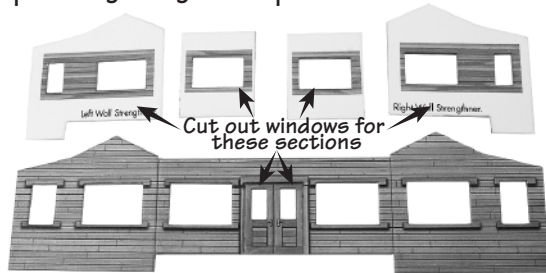
Speed Bond by Deluxe Materials

This is an excellent PVA. based glue that dries quickly, but also allows time to get parts into position. It has the added advantage that it dries clear leaving little evidence if it oozes out of joints etc. Used in our fine glue applicator bottles a 112g bottle lasts for ages. www.deluxematerials.com

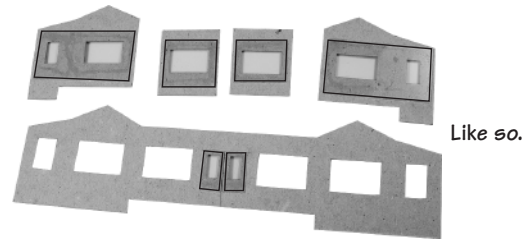
Your WORKING area should have a clean flat surface, and should only contain the kit parts you are actually working on.

Fig. 1. WINDOWS

This kit doesn't have printed windows, so you just cut out strips from the clear plastic glazing sheet provided.



You need to cut out 2 strips of glazing 25mm by 45mm for the left and right wall strengthen. 2 square sections 25mm by 25mm for the window frames. Finally 2 small 8mm by 15mm windows for the doors. Then fix the glazing to the back of the frames.



Next carefully align the inner window frames and side strengtheners and glue into place against the main wall section.

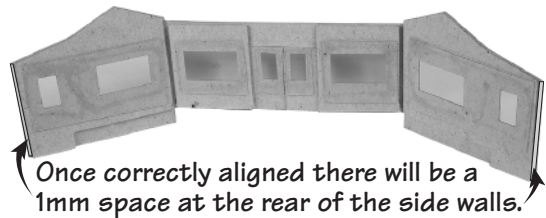


Fig. 2. BASE

Fold the main base back onto itself and glue into place.

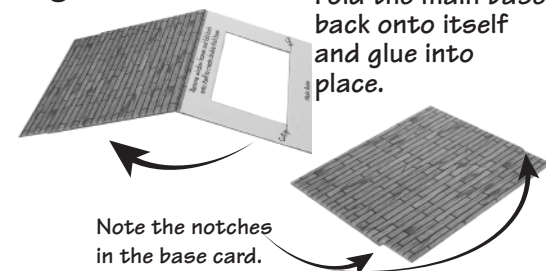


Fig. 2. BASE continued...

Now fix the base to the main walls. The notches on the base face the rear of the building, fold faces the front. Test the fit before gluing into place. The base fits flush to the underside of the front wall.

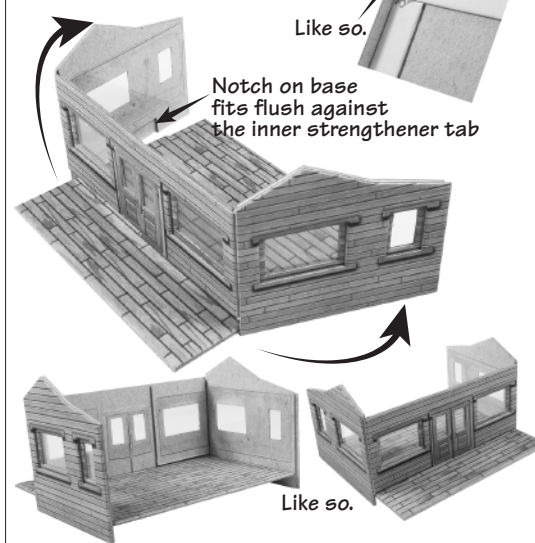


Fig. 3. REAR WALL

Now add the rear wall. Fold back onto itself the rear wall section and glue.

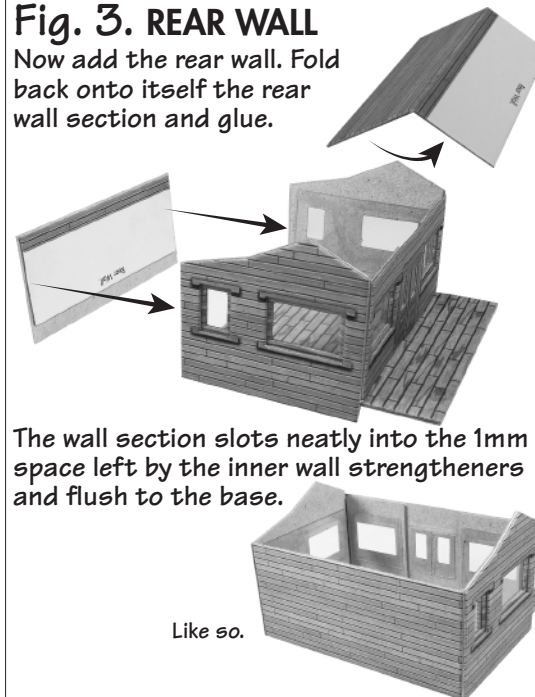
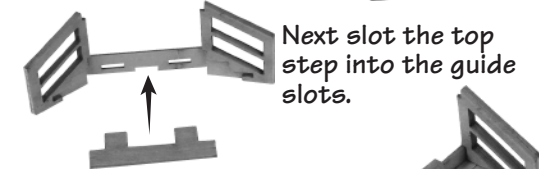
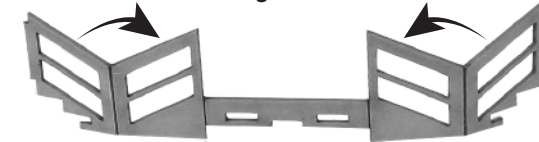
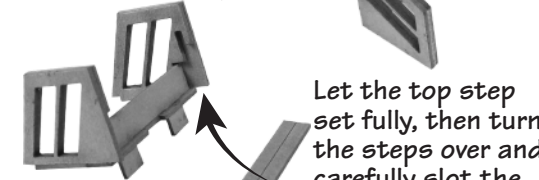


Fig. 4. STEPS

First fold back and glue the side handrails.



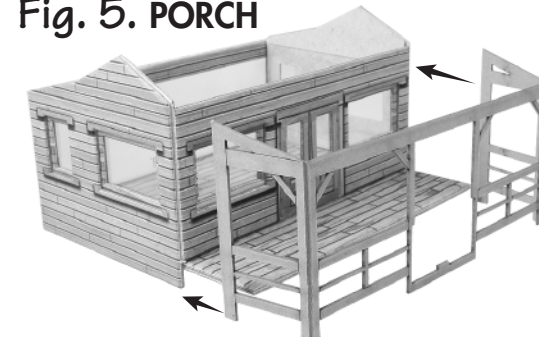
Then fold the handrails flush to the step sides.



Test the fit before applying the glue.



Fig. 5. PORCH



Carefully align and fold the main porch section around the raised floor of the main building, and glue into place.

Fig. 5. PORCH continued...

Once the porch section is set in place carefully align and slot into place the step assembly. The top step tabs fit snugly underneath the decking floor.

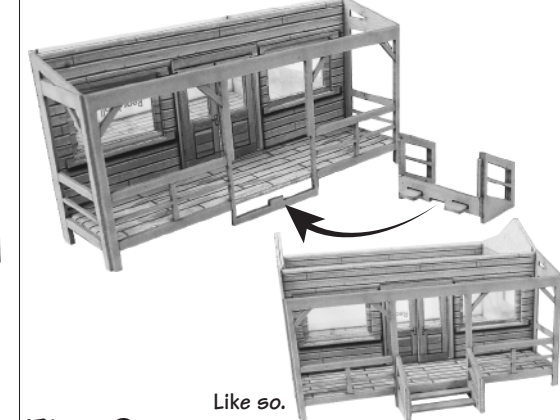


Fig. 6. ROOF

First centre and align the centre roof section into place.

Then the front and back roof sections.

Finally add the barge boards.

Align the 2 barge boards flush to the under hang of the roof and glue into place.

