

PO400 OO/HO Scale PLATFORM UNDERPASS

READ THROUGH ALL THE INSTRUCTIONS BEFORE YOU START.

To construct this kit you will need the following:

1. A Modellers knife.
2. A pair of sharp pointed scissors.
3. A steel ruler.
4. Glue - UHU Clear Adhesive is our favourite.
5. Ultra Fine Tip Glue Applicator, *see right*.
6. A cutting surface - a sheet of card or a cutting mat.
7. Fine point tweezers to hold the smaller components.
8. Water colour paints and a very fine brush, for painting the edges and corners.

GETTING STARTED

To stop the components from falling off the sheets, they are held secure with scorelines. These are cuts that only go about 75% of the way through the card. To release them simply run the point of your knife along the scorelines and they will come seamlessly away. ➡

These scorelines are indicated with blue arrows: **WARNING**, Cut with care using a knife that is not too sharp, this will reduce the risk of the blade running out of the score and cutting the kit components.

The scorelines on the grey card and the lasercut card components are indicated by an extended scoreline.

Extract one set of the components from each of the sheets - one set of the wall sections, roofs, inner wall from the printed sheet A, half of the steps from the grey sheet and 3 of the 6 hand rails and 1 underpass entrance from the laser cut brown sheet.

Next carefully cut out the windows from the glazing sheet, cut along the thin white outline. Place these components neatly in a tray or separate piece of thick card away from your working area to create your builders yard.

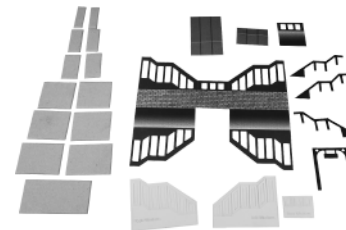

INSTRUCTION SHEET

CHECK LIST

This kit pack should contain the following:

- 1 x SHEET A - Printed wall/roof sections
- 1 x PLAIN GREY CARD - Steps
- 1 x BROWN CARD - Laser cut parts
- 1 x INSTRUCTION SHEET.
- 1 x GLAZING SHEET

The METCALFE Ultra Fine Tip Glue Bottles are essential for gluing the smaller components in this kit.

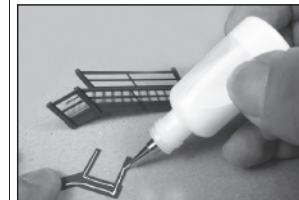

Tiny strips or spots of glue can be accurately laid down with precision.

Always replace the pin after use and store the bottles upside down to keep the glue moist.



UHU All Purpose Adhesive Glue

Is available in standard and solvent free. Both types are fine for use in our glue bottles, even though the instructions on the back of the packs warn against solvent based glues, we have tested the UHU solvent based glue and it works fine. The solvent free glue doesn't string as much, but can be a little harder to clean off if it drips onto unwanted areas.

Speed Bond by Deluxe Materials

This is an excellent PVA. based glue that dries quickly, but also allows time to get parts into position. It has the added advantage that it dries clear leaving little evidence if it oozes out of joints etc. Used in our fine glue applicator bottles a 112g bottle lasts for ages.
www.deluxematerials.com

Your **WORKING** area should have a clean flat surface, and should only contain the kit parts you are actually working on.

Fig. 1. WINDOWS

Start off by carefully aligning the left, right and rear windows to the main wall section.

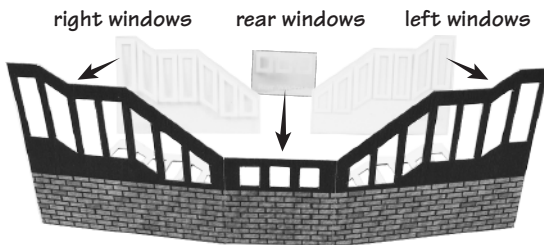

Once the windows have set in place, fold back the inner wall sections to 'sandwich' the glazing. Then carefully align and glue into place the small inner rear wall section.

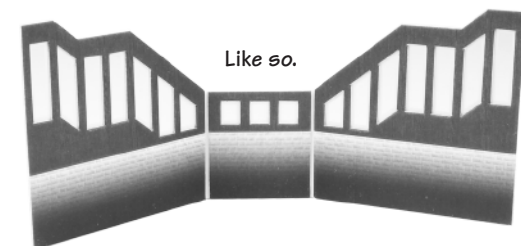
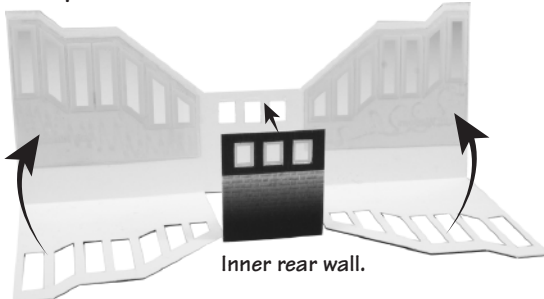

Leave this section squished under a heavy book while the glue dries.

Fig. 2. STEPS

While you wait for the wall section to set, build up the steps.

The goal is to finish up with a set of steps like this.



Fig. 2. STEPS continued...

From the plain grey card, there are 2 sets of steps (One for each underpass). Place the largest step on your work surface (there is only one of these per set). Then match up the rest of the rectangular steps into pairs and glue them together keeping all the edges flush.

Then build the steps keeping the back and side edges flush. Use your ruler to keep the edges flush.

Gradually add all the step pairs to the base step.

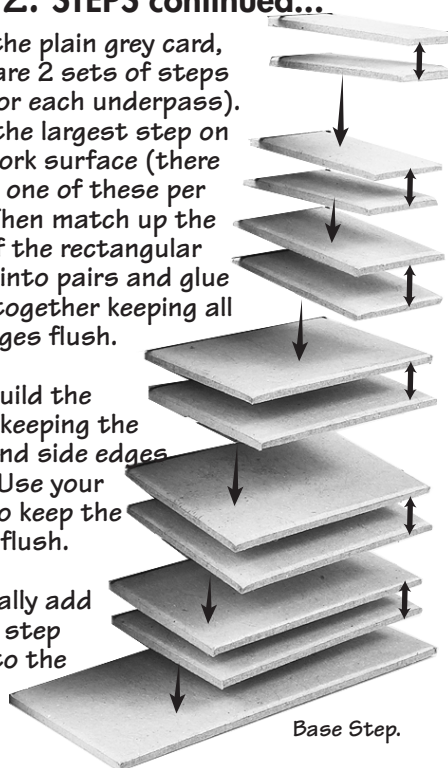
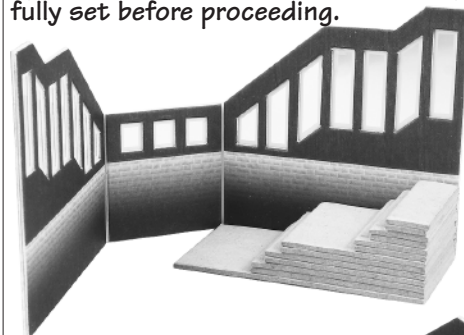

Fig. 3. WALLS

Now add the wall sections to the steps. This is a snug fit so try the fit before applying the glue. Make sure the steps have fully set before proceeding.



Wrap the walls around the steps keeping the 'top' step at the entrance.

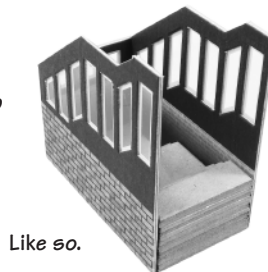
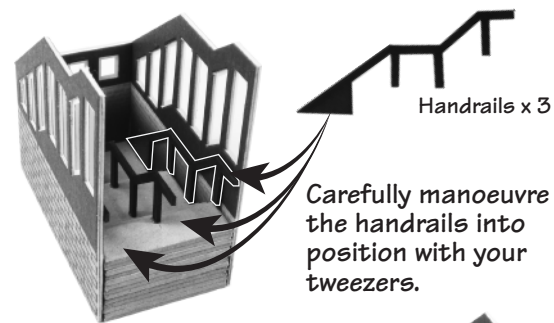

Fig. 4. RAILS & ENTRANCE

Before adding the roof, fix into place the handrails. These follow the angle of the steps and fit flush against the wall and down the centre.



Next align the entrance into place. This needs to be flush to the side and top of the side walls.

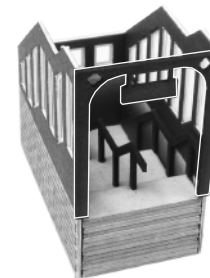

Fig. 5. ROOF



Start with the rear roof section. Centre the roof on the wall sections, there will be about 1mm overhang along the sides.

Then add the front roof, use the dark grey 'tramlines' on the roof artwork to help align the 2 sections.



Fig. 6. SIGNS

All that's left to do is to pick a sign from the selection below. Carefully cut out your choice and add to the overhead sign at the underpass entrance.



Then set into the surface of the platform. (P0216 or P0235)



SUBWAY	TO PLATFORM 1	SUBWAY	TO PLATFORM 1	SUBWAY	TO PLATFORM 1
SUBWAY	TO PLATFORM 2	SUBWAY	TO PLATFORM 2	SUBWAY	TO PLATFORM 2
WAY OUT	TO PLATFORM 3	WAY OUT	TO PLATFORM 3	WAY OUT	TO PLATFORM 3
TOILETS	TO PLATFORM 4	TOILETS	TO PLATFORM 4	TOILETS	TO PLATFORM 4
SUBWAY	TO PLATFORM 1	SUBWAY	TO PLATFORM 1	SUBWAY	TO PLATFORM 1
SUBWAY	TO PLATFORM 2	SUBWAY	TO PLATFORM 2	SUBWAY	TO PLATFORM 2
WAY OUT	TO PLATFORM 3	WAY OUT	TO PLATFORM 3	WAY OUT	TO PLATFORM 3
TOILETS	TO PLATFORM 4	TOILETS	TO PLATFORM 4	TOILETS	TO PLATFORM 4