

PN950 No1 Market St. N Scale Timber Framed Building

PLEASE READ THESE INSTRUCTIONS BEFORE YOU START TO BUILD.
It is important you familiarise yourself with all the components and building techniques.

CHECKLIST.

- 1 x SHEET A. Printed components for main building.
- 1 x SHEET B. Printed Thicker card containing shop inner frame, window frames & other inner parts.
- 1 x GLAZING SHEET.
- 1 x INSTRUCTION BOOKLET (this one).

Kit components at a glance.

SHEET A.



SHEET B.



GLAZING SHEET.



1 Tools to build this kit.

- To build this kit you will need a few basic tools:
1. A modellers knife. *We find that a Swann Morton knife with 10a blade is the best tool for the job.*
 2. A cutting surface - A cutting mat or thick card will do.
 3. A sharp pair of scissors
 4. A steel ruler.
 5. Fine point tweezers.
 6. METCALFE Ultra Fine Tip Glue Bottles (see 3).
 7. Water colour paints to paint over corners and edges.

2 Glue.

We recommend using a combination of glue:

Speed Bond is slightly slow drying, ideal for where a little positioning is required as you build.

UHU All Purpose solvent free.

This is the **best** glue for fixing the plastic glazing to the window frames.

Roket Card Glue is an instant and fast drying glue, great for where you need stuff to stay just where you place it.

Supplied with its own fine tip applicator.



INSTRUCTIONS

3 Ultra Fine Tip Glue Applicators.

An absolute 'must' when building this kit. When used with **Speed Bond** or **UHU** perfect amounts of glue can be applied to very precise areas without any mess.

Speed Bond in an applicator was used to build most of this kit.
UHU for fixing the glazing.



A METCALFE product supplied in packs of 3
Product code MT907 Glue not included

Care & Use of glue applicators

Always replace the pin if not using for more than a couple of minutes. The nozzle will block up from time to time, so simply tip the bottle up as shown here and push the pin inside, then vigorously push and pull the pin whilst squeezing the bottle at the same time. This allows the glue to moisten the dry glue in the nozzle.



If this doesn't help, then take the metal nozzle off and rod it out with the pin from the other end.

Speed Bond is a water based glue so running warm water over it as you go helps soften any hard glue in the nozzle.

ALWAYS store the bottles upside down when not in use. This keeps the glue moist around the nozzle end of the bottle.

This simple holder was made using hard foam corner packaging (out of a furniture flat pack). You could also fashion one from styrene foam packing.



When using the bottles stick the pin into the foam for safe keeping.

They are very easy to lose!

All tools & Glues available at:
www.metcalfe-models.com

4 Extracting components from base sheets.

To stop the components falling off the base sheets, they are held secure with score lines (marked with blue arrows) that cut about 75% of the way through the card.

To release them run the point of your knife along these score lines and they will come seamlessly away.

WARNING, Cut with care to reduce the risk of the blade running out of the score and cutting the component.

Only extract components when instructed as you build the kit. There are a lot of tiny parts that are easily lost and best left on the base sheets until needed.

5 Painting Corners & Edges.

Before you start any building work, it is best to get this job out of the way. The white card that shows on the corners and edges doesn't have to be painted, but if you are a perfectionist it is easiest painted before you build.

All you need is a simple set of child's watercolour paints like these and a fine brush. Mix the colours in the lid.

Mix your colour with lots and lots of water, approx. 1 part paint to 5 parts water or more. TEST ON WASTE CARD FIRST UNTIL YOU HAVE THE CORRECT SHADE & COLOUR.

Fold the edges of the card back fully and gently run the end of your brush along the exposed corner.

Paint the inner edges of the window and door openings too.



Wipe away any paint that has run onto the printed surface before it dries.

REMEMBER Use VERY much watered down paint. DON'T paint a thick solid line of strong coloured paint down the edges, you will only make it look worse.

START BUILDING

6 The Shop Inner Frame.

This is a small cube style structure that forms the shop section with the shop windows, the door and interior. Once complete, the rest of the building's outer walls wrap around it.

From SHEET A. Extract:

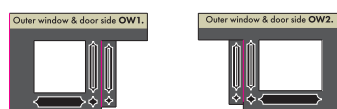

Outer window & door sides OW1. & OW2.

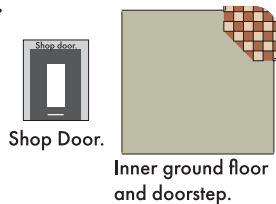

Shop Door. Inner ground floor and doorstep.

From SHEET B Extract:

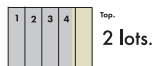

Window display shelf & spacers.

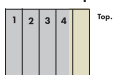

Shop door frame.

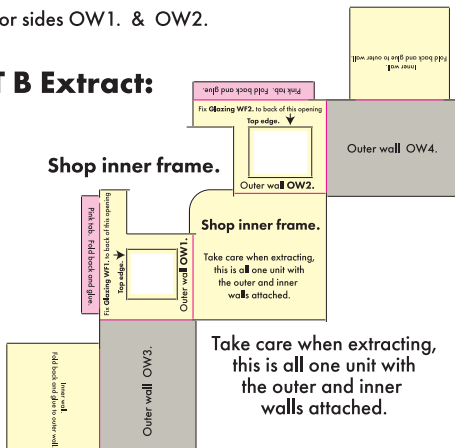

Shop inner frame.

Shop inner frame.

Take care when extracting, this is all one unit with the outer and inner walls attached.

From GLAZING SHEET Extract:



Glazing WF1.



Glazing WF2.



WF3. Shop door.

Fix the shop window glazings WF1. & WF2. to the back of the window openings

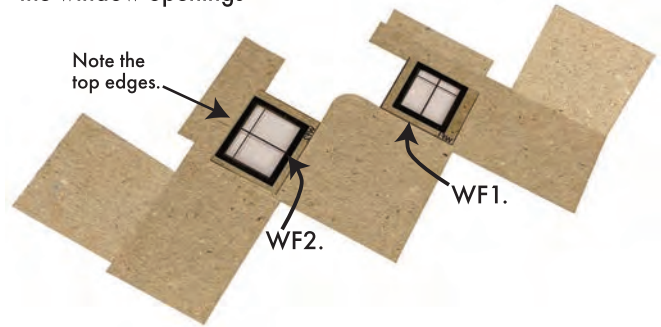

Fold over and fix the two top pink tabs.

Then the two yellow inner walls.

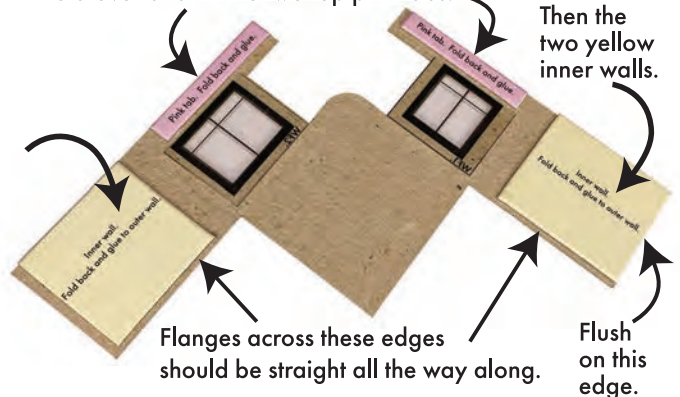

Flanges across these edges should be straight all the way along.

Flush on this edge.

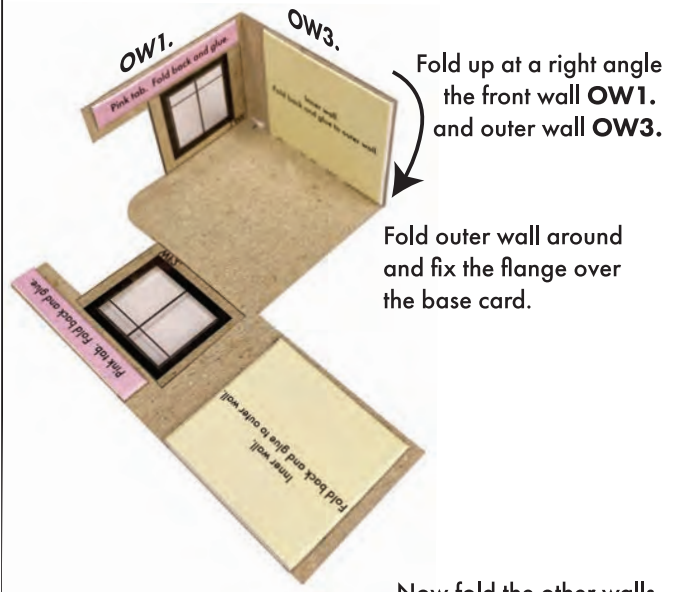

Fold up at a right angle the front wall OW1. and outer wall OW3.

Fold outer wall around and fix the flange over the base card.

Now fold the other walls up and around. Fix corners together.

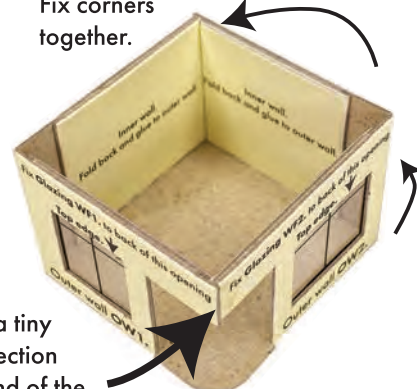

There is a tiny slotted section on the end of the card over the door top

Internal wall backdrops.

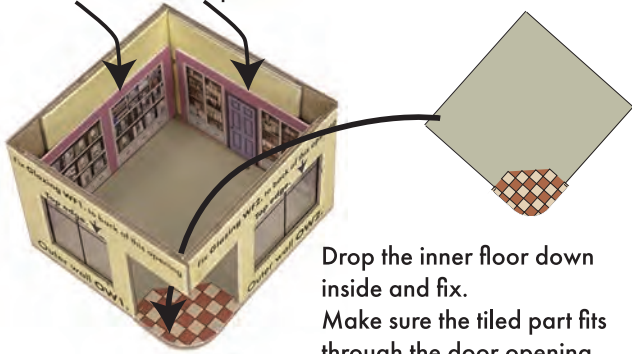

Drop the inner floor down inside and fix. Make sure the tiled part fits through the door opening edges flush with base card.

Decide which style of shop you want. There are different signs for different uses. Choose the appropriate back drops and fix to back walls.

Now fix the outer window and door side **OW2** on to the top of the yellow outer wall.

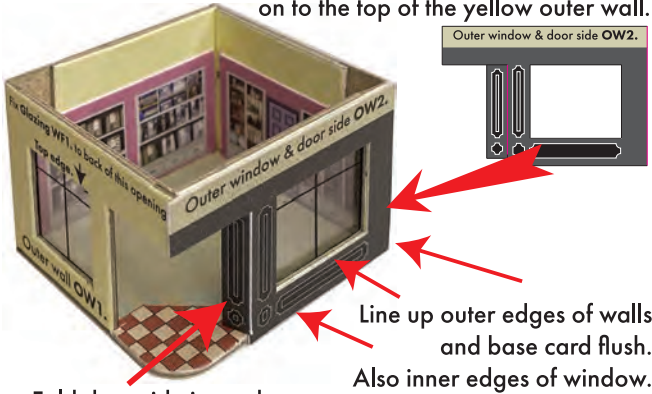

Fold door side inwards at 45° angle

Note door sides: Test that both door sides will fold inwards without glue first. You may need to trim a fraction off the top edge to get them to fold inwards cleanly.

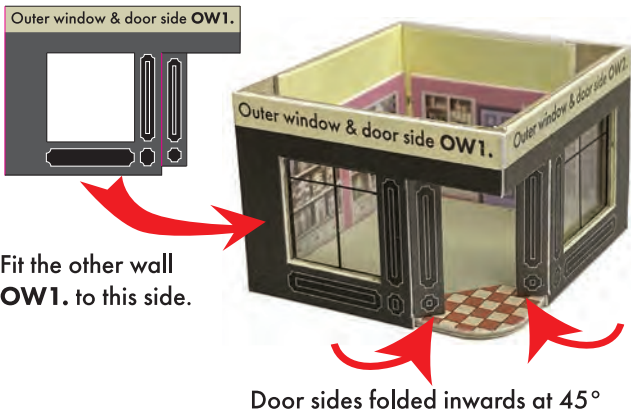

Fit the other wall **OW1** to this side.

Door sides folded inwards at 45°

Shop Door.

Fix glazing to the back of the shop door, then fix the door to the back of the door frame

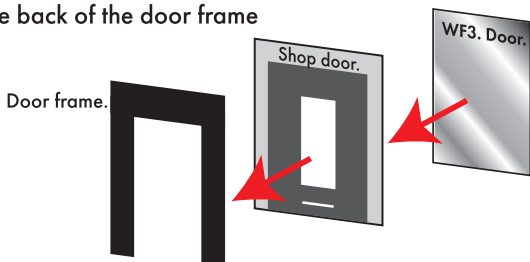

The door now fits down inside the shop unit fixed to the back of the two doorway sides.



Like This.



Window displays.

Start with the window shelf Each shelf is made from 5 pieces of card glued one on top of the other to form a solid block.

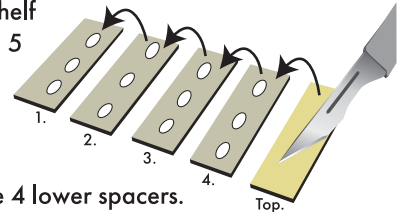

Tiny spots of glue on the 4 lower spacers. Pick up top card with point of knife.

Once you have made a block like this one with all edges flush

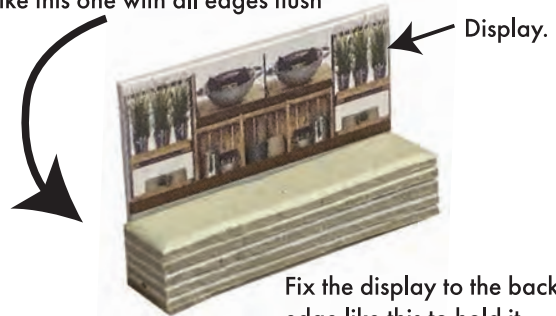

Fix the display to the back edge like this to hold it upright, then place inside the shop against the window.

Like this.



7 The Main Building.

From SHEET A. Extract:

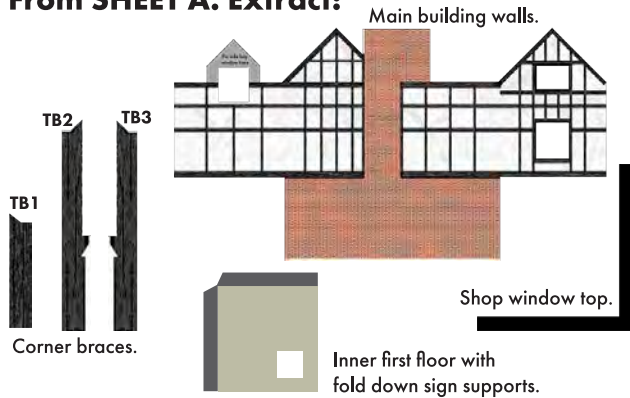

From SHEET B Extract:

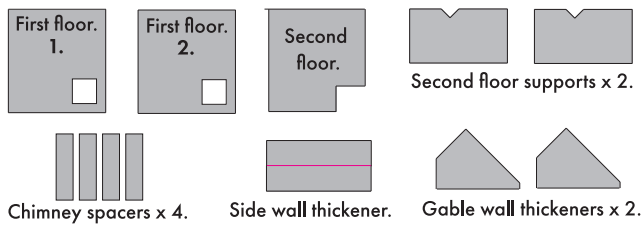

Main Building Chimney Stack.

The chimney stack needs making up first.

As with the window display shelves, take the 4 chimney spacers and glue them together to form a solid block.

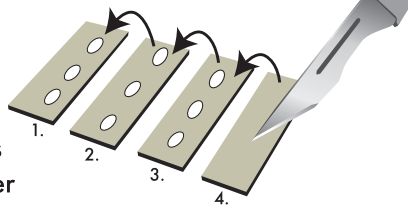

Then wrap the chimney stack tightly around the spacer block. Keep all edges squared up at right angles.

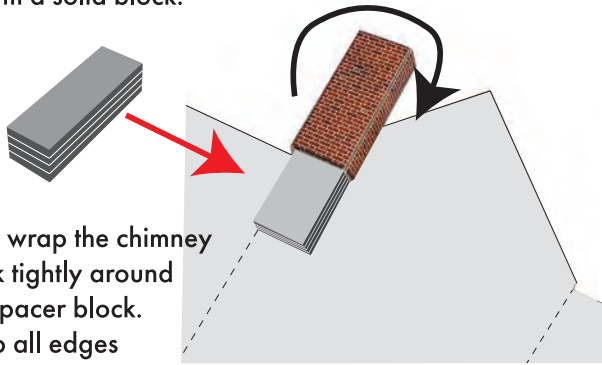

Once the chimney is fast fold the walls around the shop unit keeping all base edges flush.

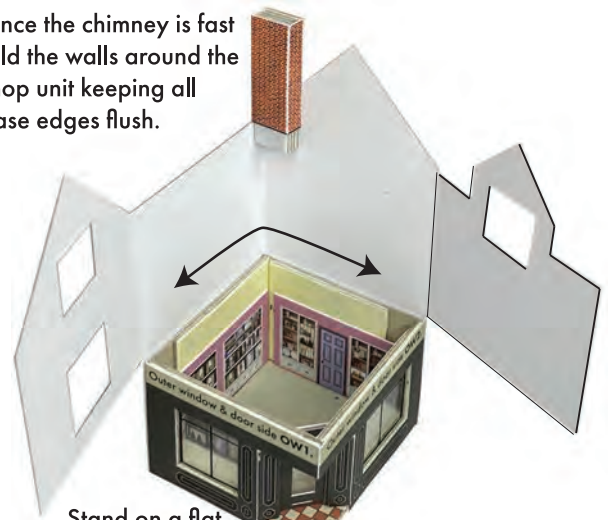

Stand on a flat surface as you attach the outer walls.

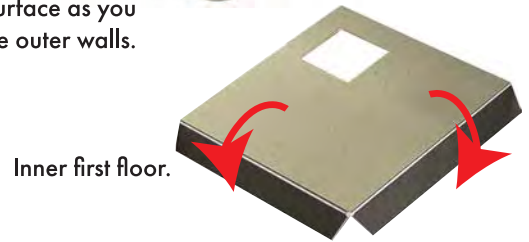

Fold the two sides fully over to loosen the scores.

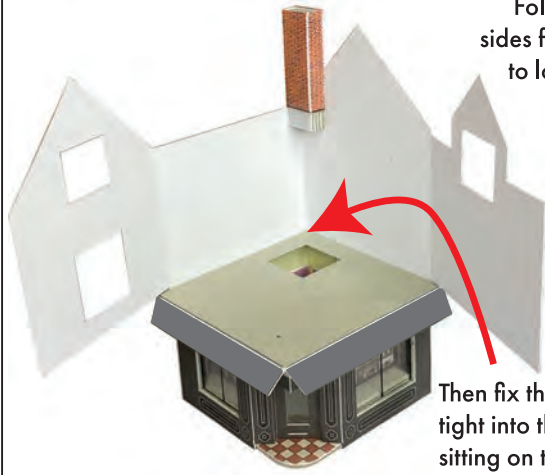

Then fix the floor tight into the corner sitting on top of the shop below.

Fit the grey First floor card No. 1. on top of the inner first floor

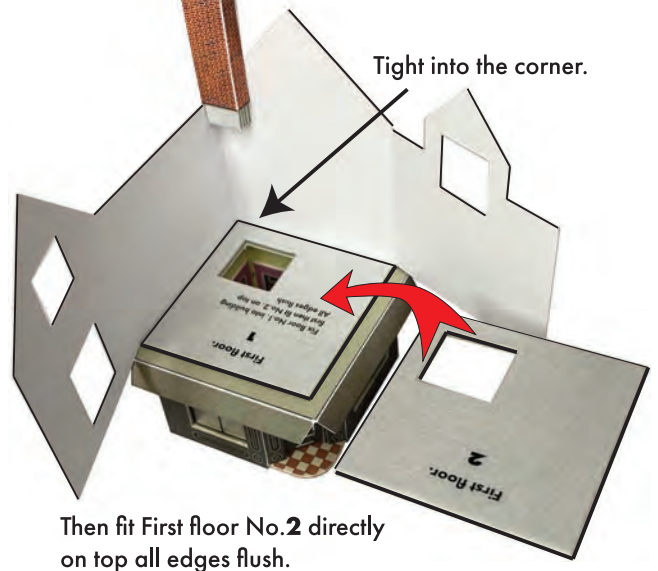

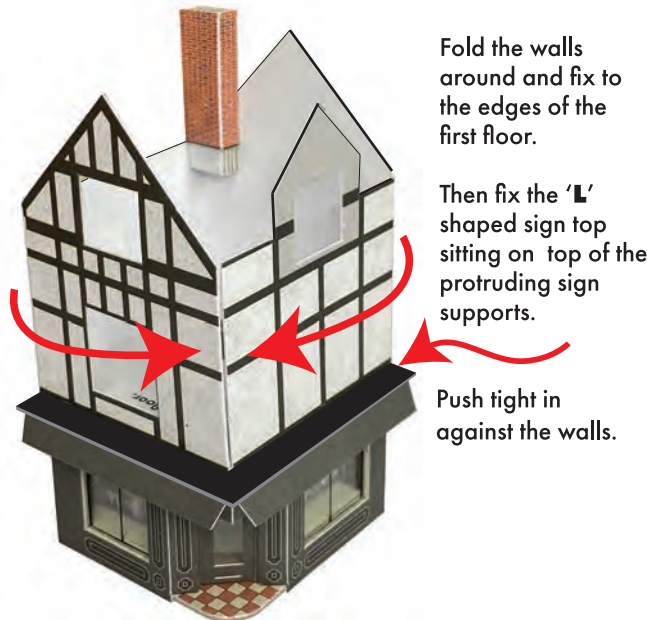

Fold the walls around and fix to the edges of the first floor.

Then fix the 'L' shaped sign top sitting on top of the protruding sign supports.

Push tight in against the walls.

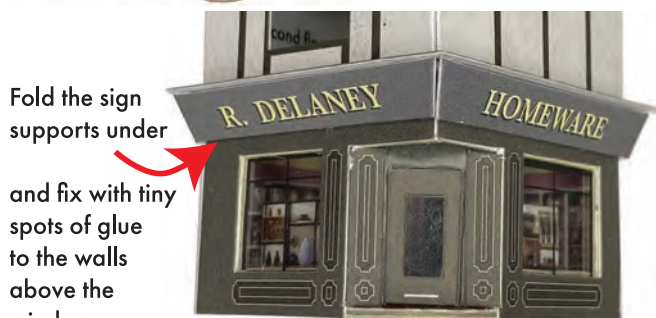

Fold the sign supports under

and fix with tiny spots of glue to the walls above the windows.

When fast attach the signs of your choice directly on top.

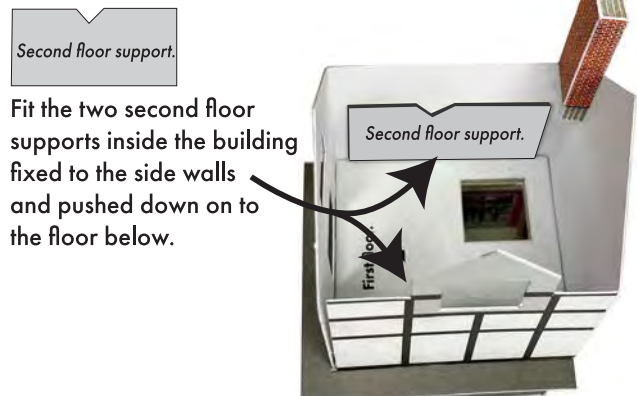

Second floor support.

Fit the two second floor supports inside the building fixed to the side walls and pushed down on to the floor below.

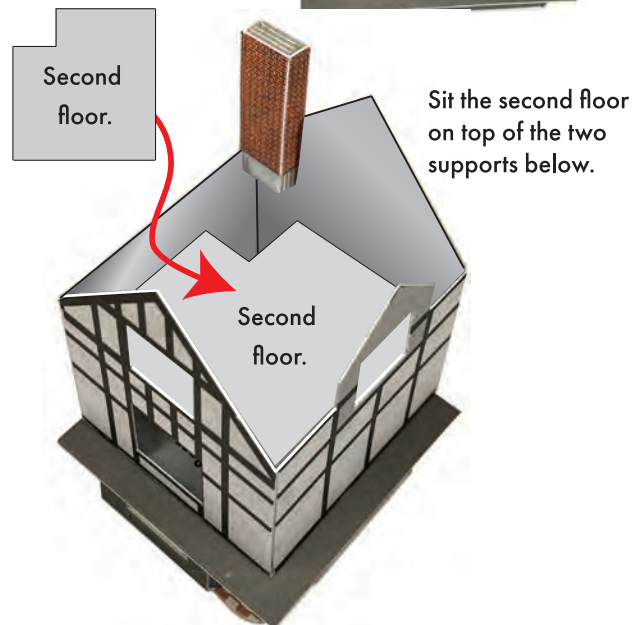

Second floor.

Sit the second floor on top of the two supports below.

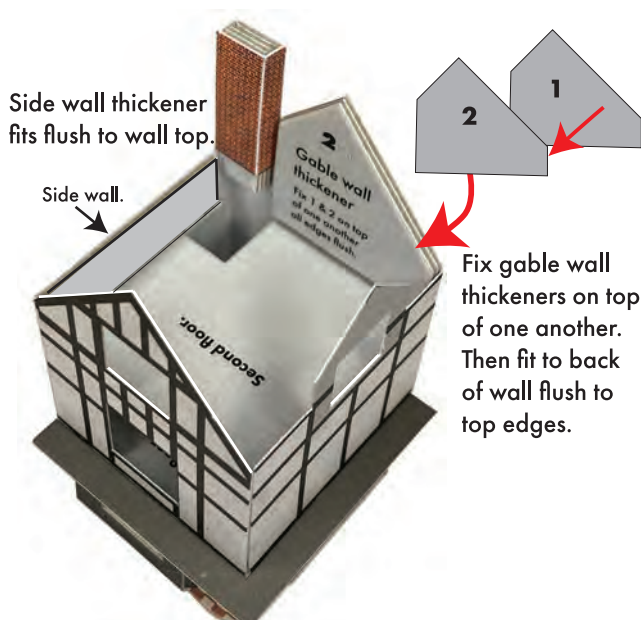

Side wall thickener fits flush to wall top.

Side wall.

Gable wall thickener fits 1 & 2 on top of one another all edges flush.

Fix gable wall thickeners on top of one another. Then fit to back of wall flush to top edges.

Corner braces

These strips of card fold to a right angle and fit around the corners of the building

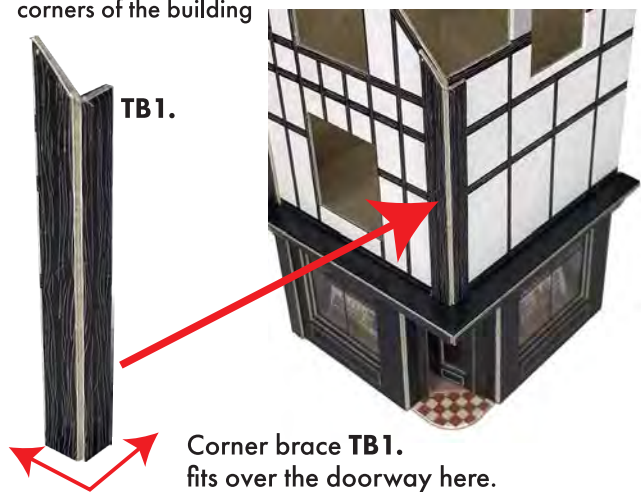

TB1.

Corner brace TB1 fits over the doorway here.

Fold to a right angle.

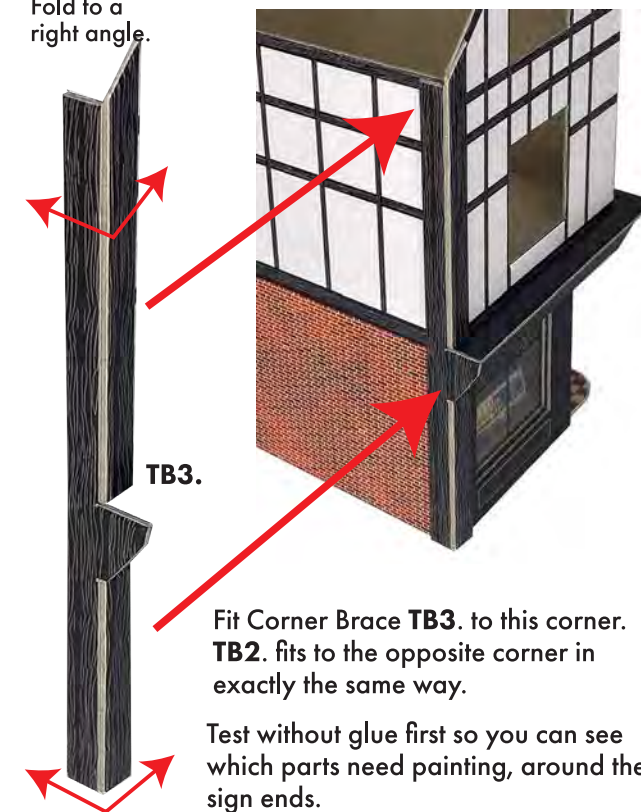

TB3.

Fit Corner Brace TB3 to this corner. TB2 fits to the opposite corner in exactly the same way.

Test without glue first so you can see which parts need painting, around the sign ends.

8 The Windows.

From SHEET A. Extract:



From SHEET B Extract:

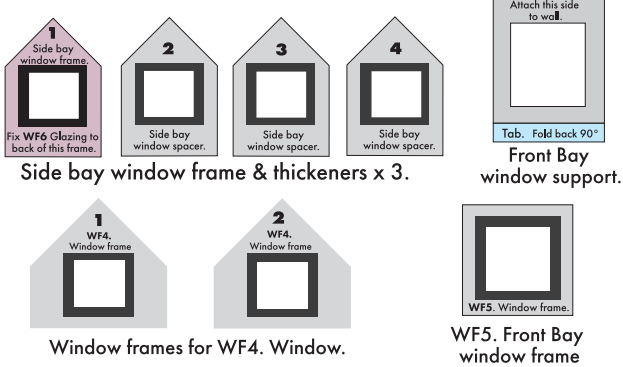

From GLAZING SHEET Extract:



1st. Floor Bay Window.

Fit the bay window support to the front wall (printed side fixed to the wall) sitting on top of the shop window. Line hole up with opening in wall.

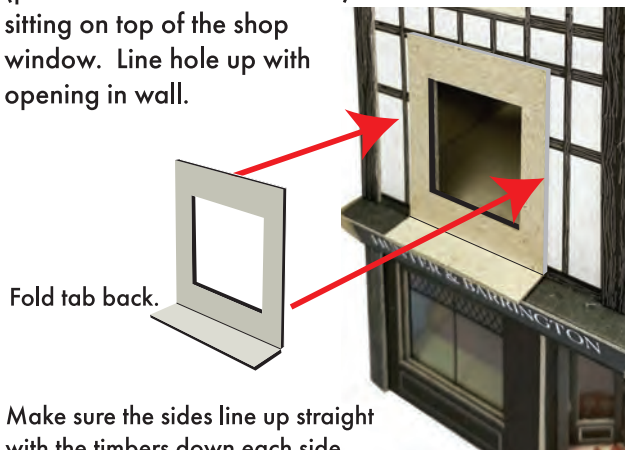

Fold tab back.

Make sure the sides line up straight with the timbers down each side.

Fold the sides of the bay around at right angles.

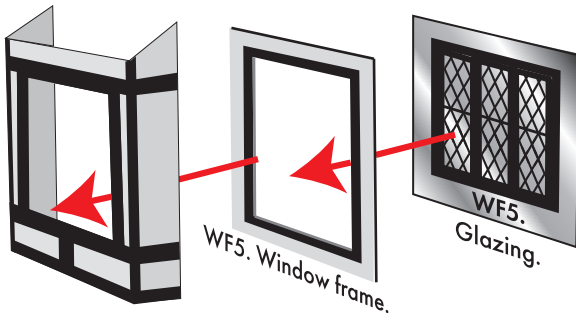

Fix the WF5. glazing to the back of the window frame then insert into the back of the bay window.

Fit over the support.



Then fit the small roof.



CURTAINS

See page 12 for notes about fitting.

Front Top Window.

Sandwich the WF4. glazing between the two window frames WF4. 1 & 2.

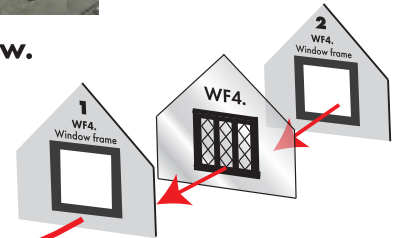

Then fit the window behind the top opening. Make sure the top edges of window are flush with the outer wall. This also acts as a wall thickener.

Side Bay Window.

Fix WF6. glazing to the back of side bay window frame.

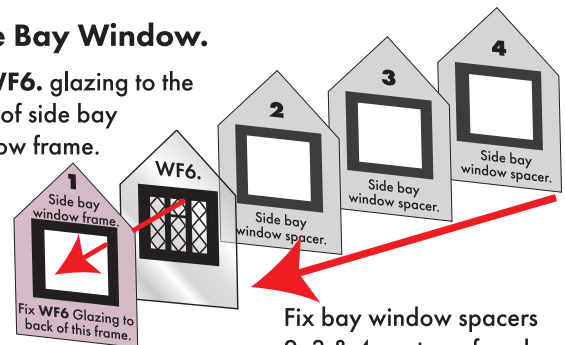

Fix bay window spacers 2, 3 & 4. on top of each other all edges flush. Then fix to back of window frame and glazing.

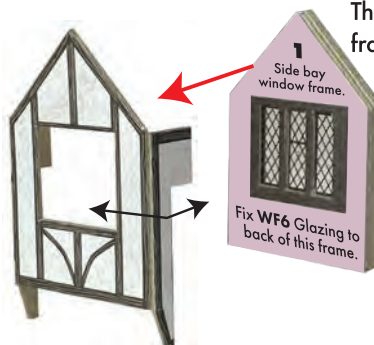

Then fix the window into the side bay with the small sides folded around at right angles.

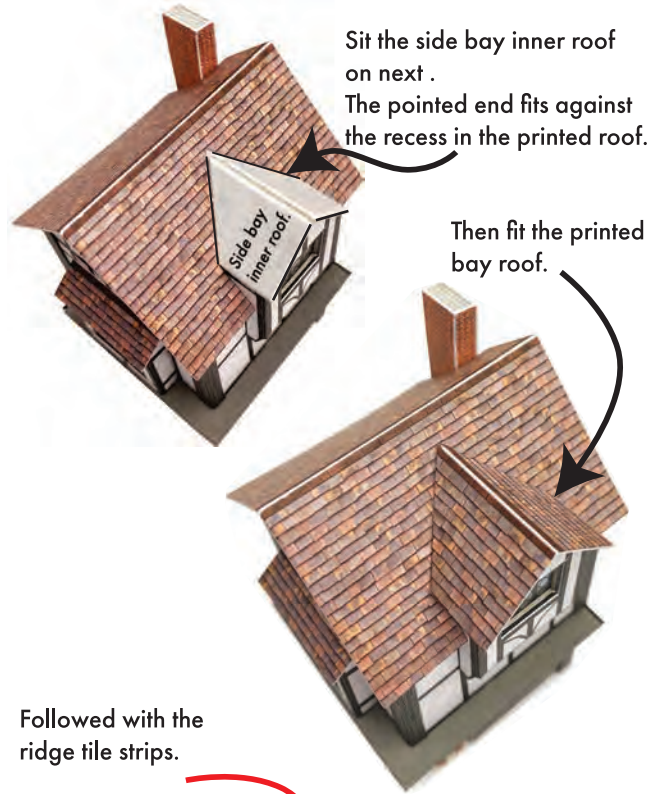
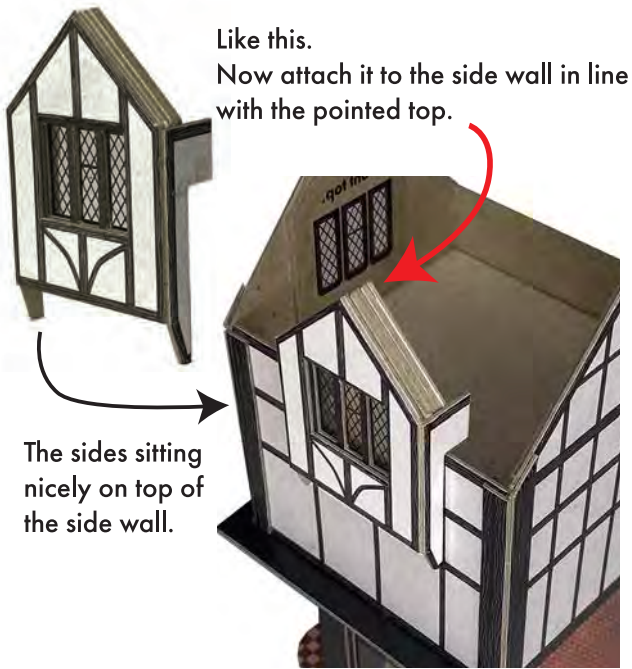

The Roof.

From SHEET A. Extract:

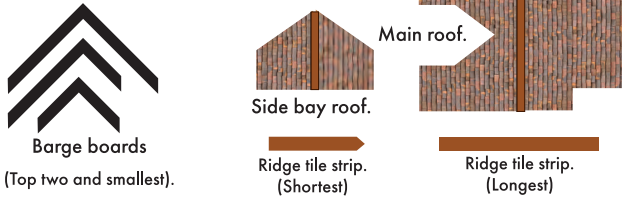

From SHEET B Extract:

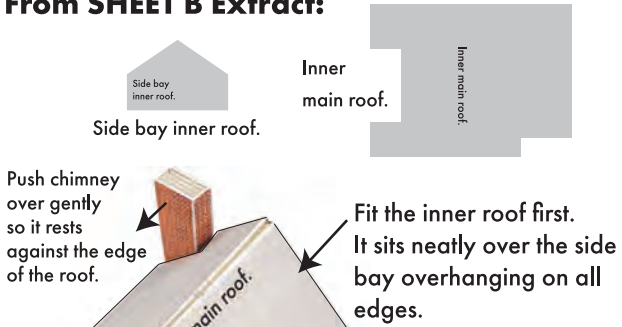

Fit the printed roof on top. It should just drop into place overhanging the inner roof.



Followed with the ridge tile strips.

Locate the scoreline down the centre and bend to fit the roof. Looks best if you paint the scoreline to cover the white card.

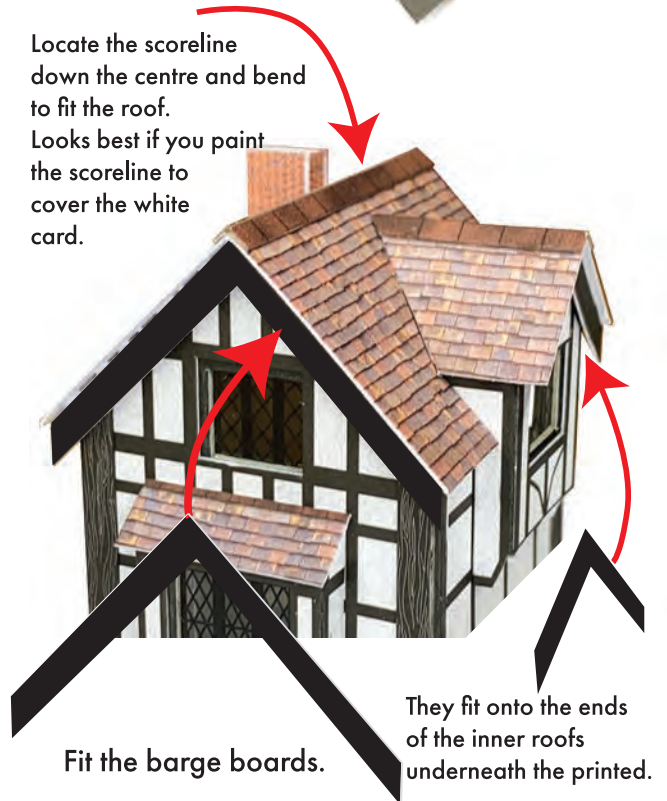

10 The Side Building.

From SHEET A. Extract:

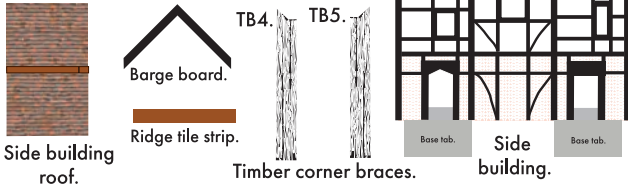

From SHEET B Extract:

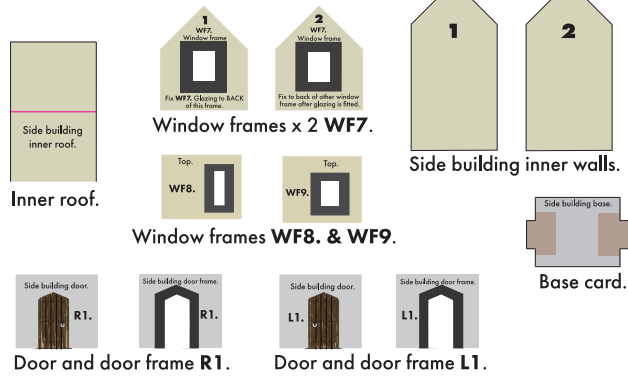

From GLAZING SHEET Extract:



Start with the windows.

Sandwich the WF7 glazing between the two window frames WF7. 1 & 2.

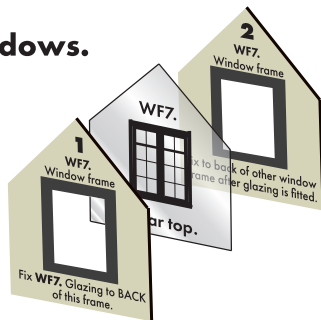

Then fix the glazings WF8. & WF9. to the back of their matching window frames.



Fold the walls around so the base cards meet in the centre.

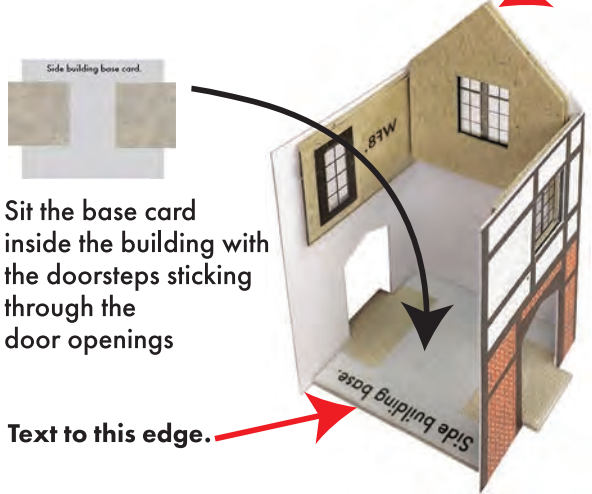
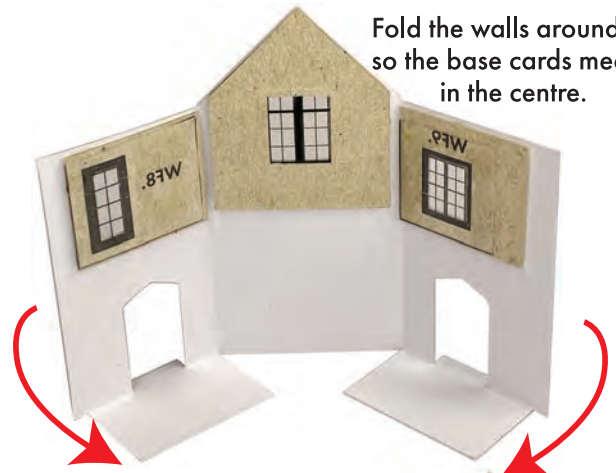

Sit the base card inside the building with the doorsteps sticking through the door openings

Text to this edge.

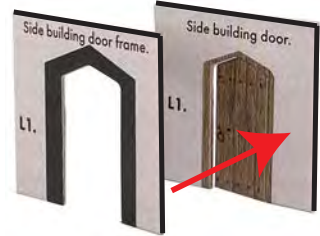

Fix the door frames to the doors on both right and left hand doors.

Fit the doors inside the building.

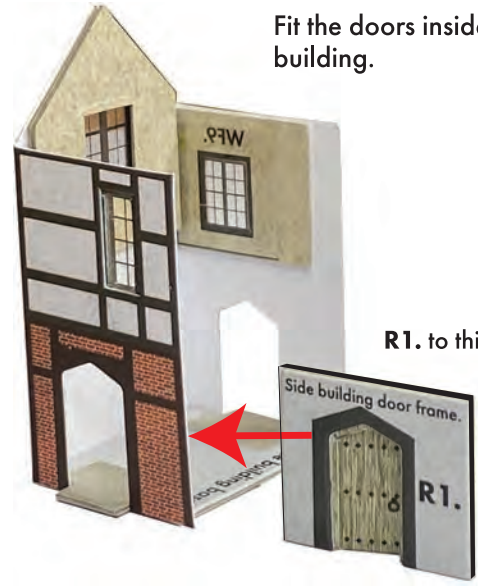

R1. to this side.

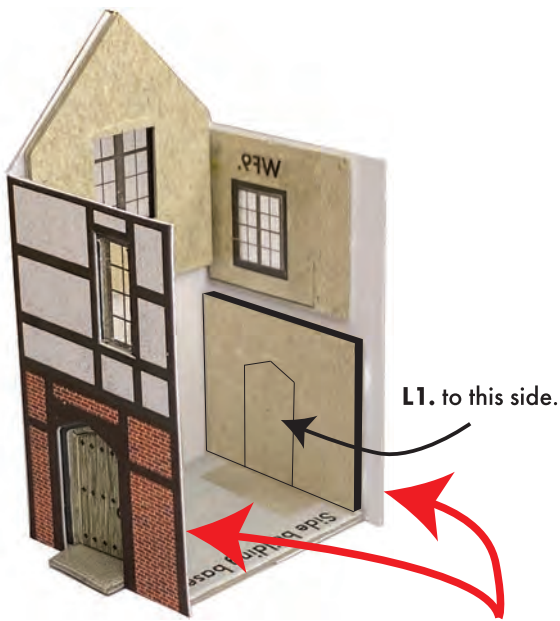

NOTE: There needs to be recessed slots down each wall end here to allow the building to fit over the inner walls.



Attach the two inner walls to

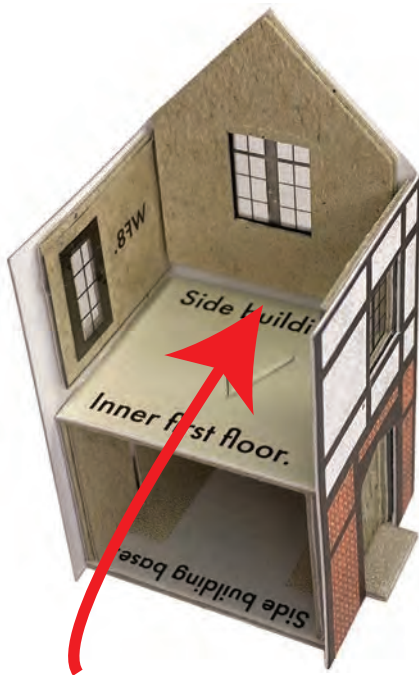

Fit the inner first floor pushed tight against the gable wall to give a gap on the back edge to allow it to fit over the inner wall.



Slot the building over the inner wall pushed up against the main building.

Fit TB4. & TB5.
corner braces.

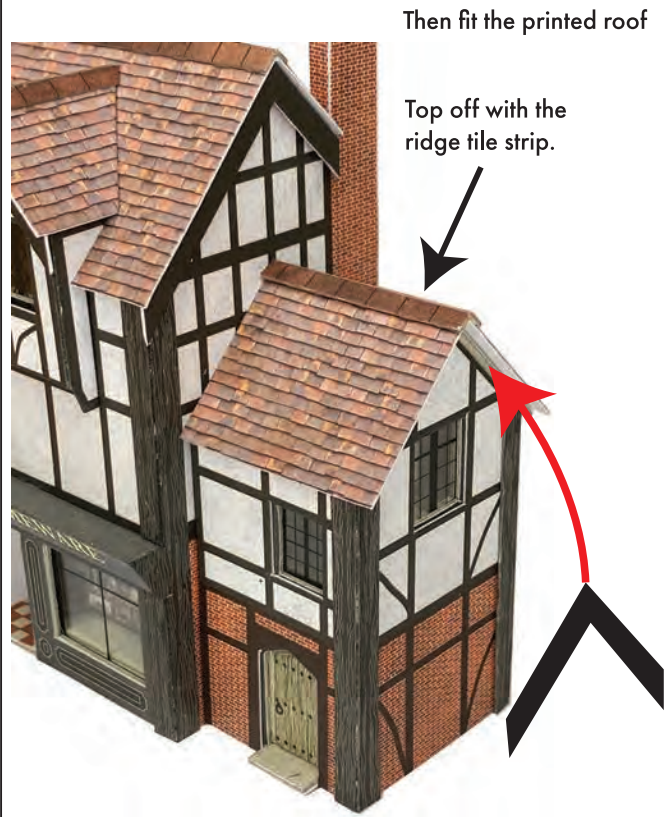
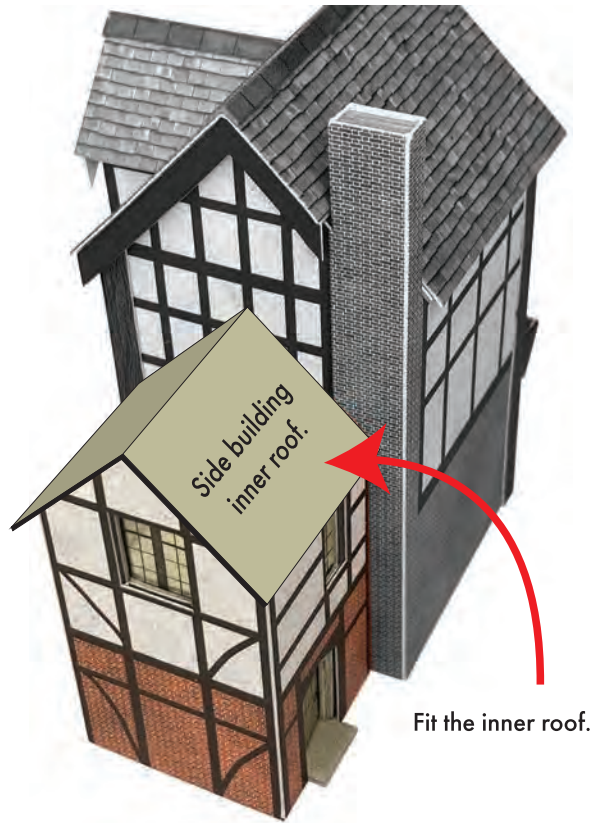
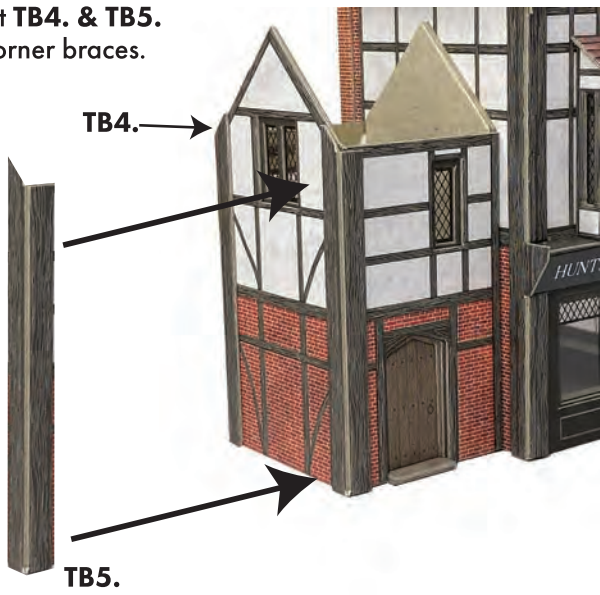

For chimney pots and other bits go to page 12.



More interior back scenes.



Wine shop back scenes.



Pub back scenes.

Curtains.

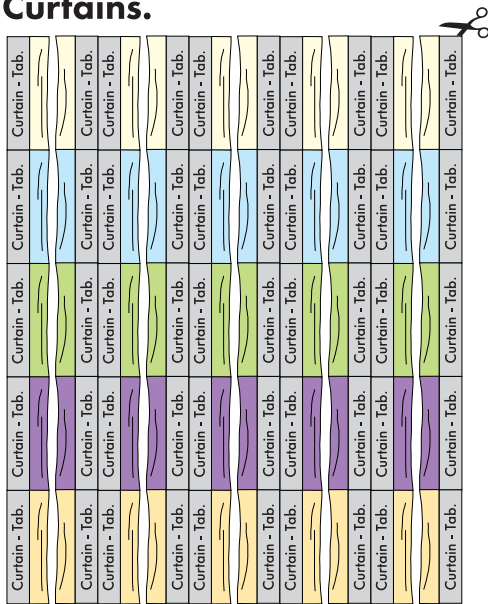

The curtains are an optional extra that require a lot of intricate work to complete, but they give the upper windows a nice finishing touch. To fit the curtains fix a small strip of waste card down each side of the window to space the curtain back.

Some windows in this kit already have frames that can be use to space the curtains back from the glazing. Lighter curtains will also reflect light so you can see the leaded effect of the glazing.

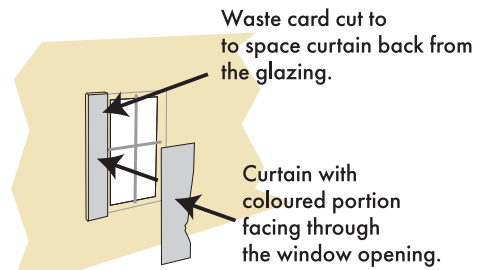
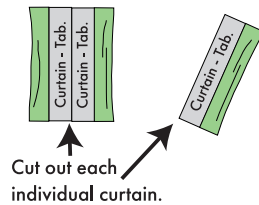

Fit waste card down each side of the window. CAUTION: Don't allow it to overlap the edges of the window frame, as it may hinder the fitting of inner floors.

Chimney Pots.

This job can seem a little tedious but well worth the effort. It's a job best done whilst watching TV, listening to the radio or even a podcast!

Cut out the terracotta coloured strips (below) roll each one tightly around a metal rod to form a cylindrical shape.

Drill bits, nails or even small screw drivers (like this one right) which is 2 mm diameter are just right for the job.

They needs to be between 2 and 2.5mm. diameter for N scale.



Keep edges straight.

Roll up tight and keep rolling until the paper is fully curled around.

Then unroll the end back out just enough to smear with a little glue, then roll back up and hold tight until the glue has set.

Paint tops black to hide white card edges.

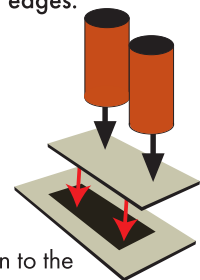

Mount the pots on to the chimney capping stones **YOU WILL FIND THEM ON SHEET B.** before fixing to the main chimney stack.



Extra curtains and chimney pots can also be downloaded from our web site www.metcalfe-models.com