

# PN926 N Scale PARISH CHURCH

## CHECK LIST

This kit should contain the following:

- 1 x SHEET A. Tower, porch & lychgate.
- 1 x SHEET B. Nave, aisles & chancel.
- 1 x SHEET C. Tower TW3a. windows.
- 1 x SHEET D. plain grey card with inner strengthening components.
- 1 x Small card with laser cut parts (L1)
- 1 x GLAZING sheet.
- 1 x Ridge tiles card.
- 1 x INSTRUCTION BOOKLET.

## READ THROUGH ALL THE INSTRUCTIONS BEFORE YOU START.

This is a complex kit that requires particular attention to detail, so proceed with care!

To construct this kit you will need the following:

- 1. A modellers knife.
- 2. A pair of sharp scissors.
- 3. A steel ruler.
- 4. Glue - See *glues*.
- 5. Ultra Fine Tip Glue Applicator, see below.
- 6. A cutting surface - a sheet of card or cutting mat.
- 7. Fine point tweezers.
- 8. Water colour paints and a very fine brush for painting edges and corners.

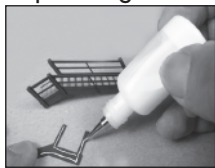
## METCALFE

### Ultra Fine Glue Tip Bottles.

These bottles are essential for gluing the smaller components in this kit.



Tiny strips and spots of glue can be accurately laid down with precision.



## INSTRUCTION SHEET

## GLUES

### UHU Solvent Free All Purpose Adhesive Glue

Works superbly well in our fine glue applicators. Dries quickly, but allows time for positioning of kit parts as described further on in the instructions.

Also Deluxe Materials 'SPEEDBOND'  
A fast drying PVA.

see [www.deluxematerials.com](http://www.deluxematerials.com)

## GETTING STARTED

### 1 EXTRACTING COMPONENTS FROM THE BASE SHEETS.

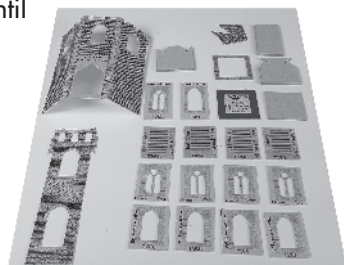
To stop the components from falling off the sheets, they are held secure with score lines. These are cuts that only go about 75% of the way through the card.

To release them run the point of your knife along these score lines and they will come seamlessly away. These score lines are marked with blue arrows: **WARNING**, Cut with care using a knife that is not too sharp, this will reduce the risk of the blade running off the score and cutting the components.

### 2 MAKE YOUR 'BUILDERS YARD'.

As you extract the components from the base sheets they need to be kept away from your working area on a thick piece of card or a tray until needed.

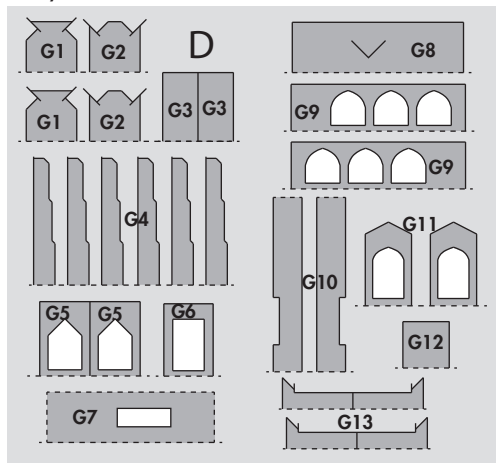
Example of builders yard.



**Only extract the components from the sheets as instructed.**

### 3 PLAIN GREY STRENGTHENING CARD (D)

This card contains the bits that fit inside the kit to strengthen and hold it together. They are identified here with numbers and a key below.



#### Key to components:

1. Tower inner floor type A.
2. Tower inner floor type B.
3. Tower inner side walls.
4. Buttress spacers x 6.
5. Tower to Nave joiners.
6. Nave end roof support.
7. Nave floor (with hole).
8. Nave ceiling.
9. Aisle side supports.
10. Aisle floor.
11. Chancel joiners.
12. Chancel floor.
13. Yard wall spacers.

### 4 GLAZING

Cut out all the clear glazing components and place on a separate sheet of white card so they don't get lost.



### 5 PAINTING CORNERS & EDGES.

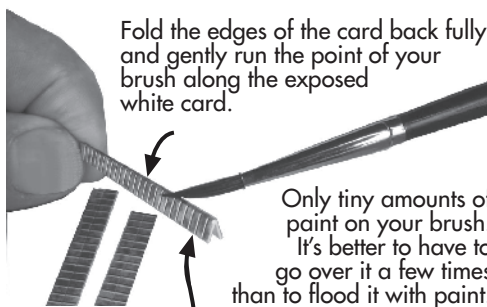
The white card that shows on the corners and edges is best painted **before you build the kit**. All you need is a simple set of water colour paints and a fine brush.

Something like this set of 'Reeves' watercolours or even simple child's watercolours.

As long as it contains a warm red, a brown and black, you will be able to match the colours in this kit.



Mix your colour with lots and lots of water, apx. 1 part paint to 5 parts water or more. **TEST ON WASTE CARD FIRST UNTIL YOU HAVE THE CORRECT SHADE & COLOUR.**



**Paint the outer edges too.**

Before the paint dries, run your finger along the edge to rub the colour into the absorbent white card.

Then wipe away any paint that has run onto the printed surface before it dries.

Remember, you only need to just slightly tint the card with a little colour.

**DON'T** paint a thick solid line down the edges, you will only make it look worse.

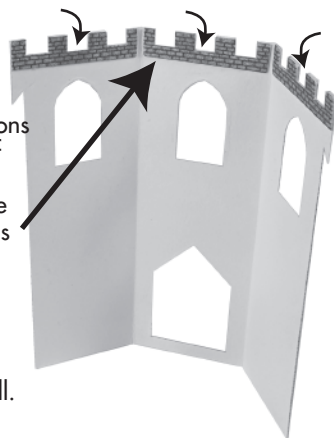
### LETS START TO BUILD!

#### Fig. 1. THE TOWER.

Extract from sheet 'A' the tower walls and window components **TW1, TW2, TW3** and **TW4**. plus roof and **TT1**. and **TT2**. Also **TW3a**. from the small sheet 'C'. Place in your builders yard as shown on front page.

Start by folding over the three battlement sections along the top of the walls. Glue them to the back of the walls to make double sided.

Repeat with the single section of the tower wall.



flower window



TW1

## TOWER INNER FLOORS.

Fix B on top of A keep all outer edges flush.

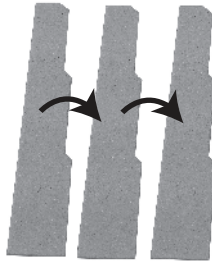
Π2.



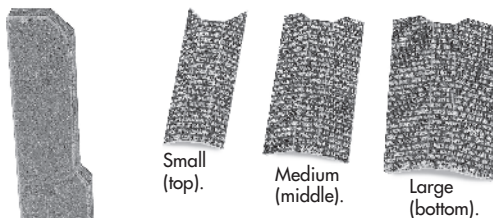
Lower Top  
T11  
Electric or magnetic  
the induced current  
flowed in the  
direction

## THE CORNER BUTTRESSES.

Each buttress is made by first gluing three of the long grey card inner buttress spacers one on top of the other to form a solid block. Keep all outer edges absolutely flush.

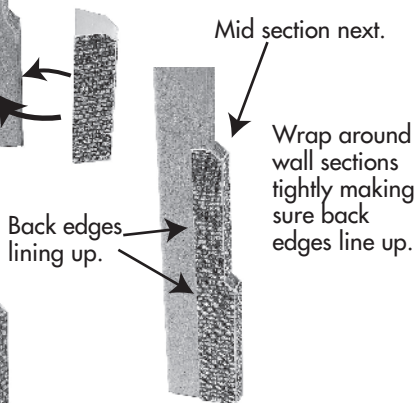


There are three printed wrap around wall sections that fit to the block.



Start with the large wall section at the bottom.

Mid section next.



When all three walls are fitted, cap the two lower steps with small pieces of tiling, cut from the buttress tops strip. Cut each apx. three rows of tiles deep. Just enough to allow an overhang on the bottom edge



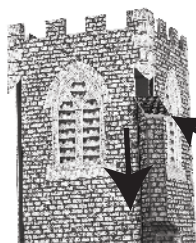
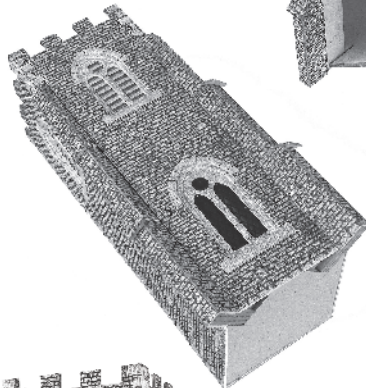
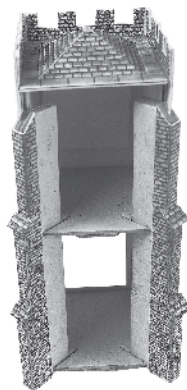
Three rows deep.

Top one five rows deep, but don't fit just yet.

Make the other buttress in same way.

Slide the two buttresses into the corner slots. Push in till the printed wall fits against the tower side walls. **DON'T GLUE.**

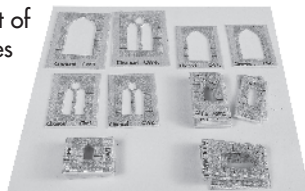
Next drop the west wall into place so the top walls line up. Only fit it to the inner floors and the top corners of the tower.



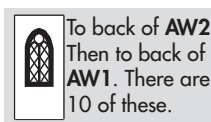
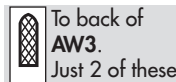
Let the glue dry then slide the buttresses down a little and fit the top capping strip. Then slide back up and glue the buttresses into the tower.

## Fig.2. THE REST OF THE WINDOWS.

Cut out all the rest of the window frames from sheet 'B'  
AW1, 2 & 3.  
NW1.  
CW1, 2, 3 & 4.



Attach all the glazings to windows as follows:



Chancel glazings to back of CW2 then to CW1. East window to back of CW4 then to CW3.



## Fig.2. WINDOWS Continued.

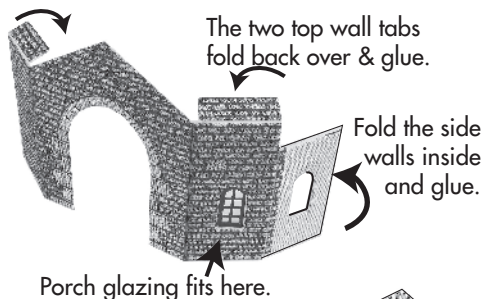
Place the completed windows in your builders yard.  
You should now have just one glazing left.



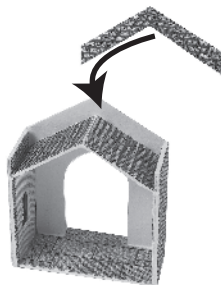
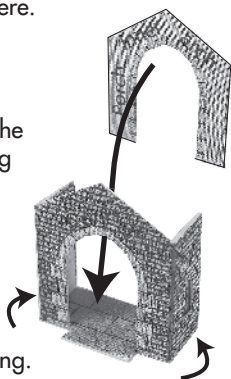
This little glazing piece fits in the side wall of the porch. See Fig.3.

## Fig.3. THE PORCH.

Extract the five porch components from sheet 'A' (located directly above the tower)



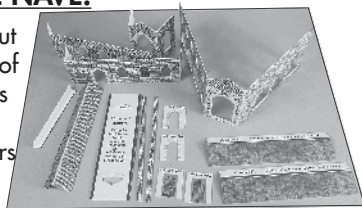
Fold the walls around the base card and fix along the bottom edges with tiny spots of glue then when fast, fit the inner arch so it is standing on the base fixed up against the back of the door opening.



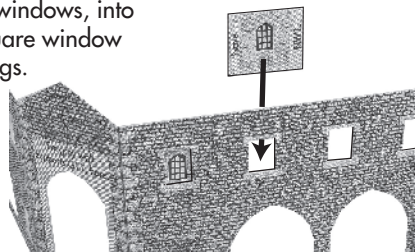
The roof sits down inside sitting on top of the inner arch and the inner side walls. Then fit the inner top wall to back of front wall sitting on top of the roof.

## Fig.4. THE NAVE.

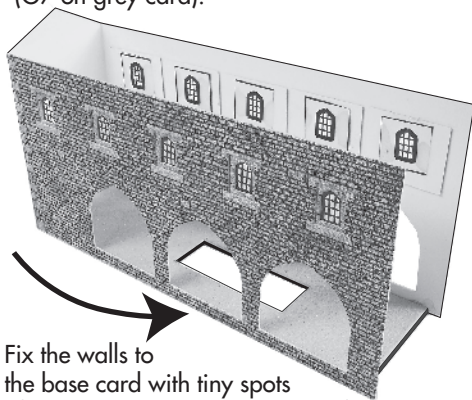
You can now cut out all the rest of the components on sheet 'B'. Place in builders yard.



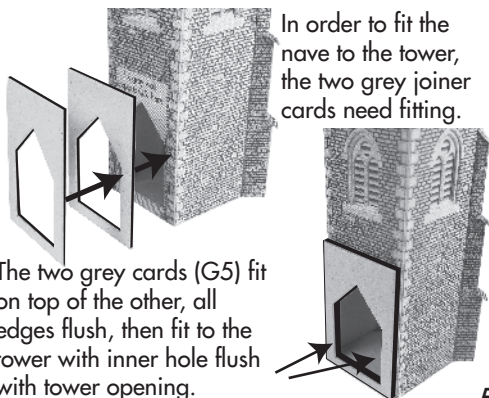
Take the nave walls and fit all eleven of the NW1 windows, into the square window openings.



Now fold the outer walls around the base card (G7 on grey card).

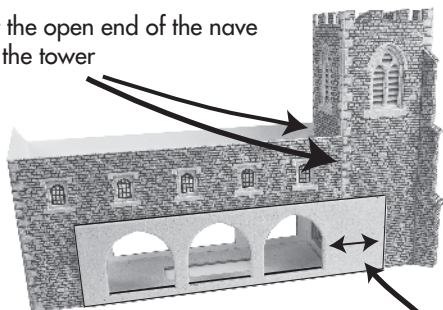


Fix the walls to the base card with tiny spots of glue placed around the edge of the base card. Make sure base is pushed up against the end wall. Stand on flat surface till glue has set.

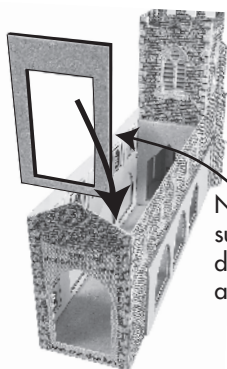


The two grey cards (G5) fit on top of the other, all edges flush, then fit to the tower with inner hole flush with tower opening.

Fit the open end of the nave to the tower

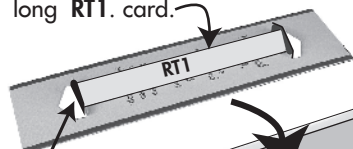


Then attach the aisle side supports (G9) to either side of the building. Fix with the longer ends fitting over the side of the tower.

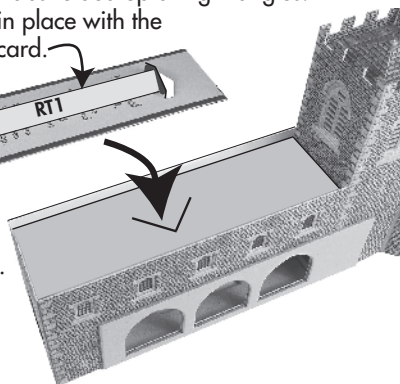


Next attach the end roof support (G6) which stands down inside the nave up against the end wall.

Fit the grey ceiling card marked with 'V' then sit the nave roof support on top with its two tabs folded up at right angles. Hold them in place with the long RT1. card.

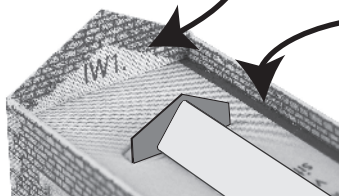


Tabs folded up at each end.

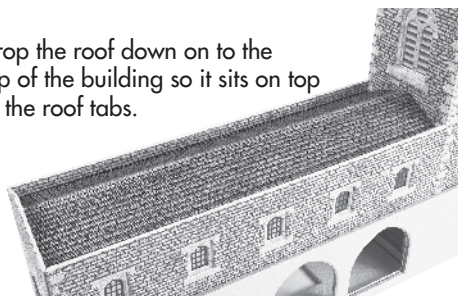


Fit the inner end gable wall IW1.

and the two inner side wall strips IW2. to the backs of the outer walls where the white card shows.



Drop the roof down on to the top of the building so it sits on top of the roof tabs.

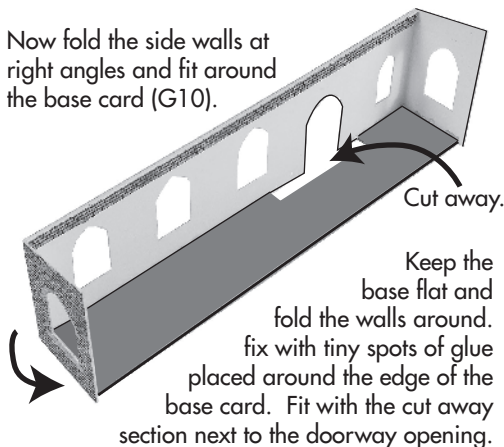


## Fig.5. THE AISLES (North and South).

Both go together in exactly the same way. Start with the outer walls. First, fold over the thin strip along the top of the front wall and fold over gluing it to the back.

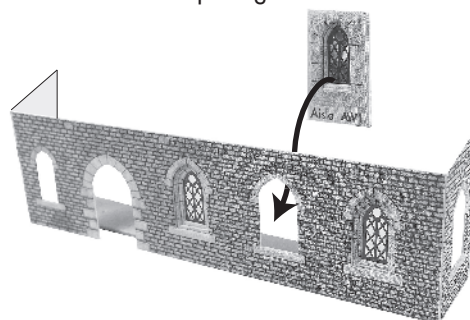


Now fold the side walls at right angles and fit around the base card (G10).



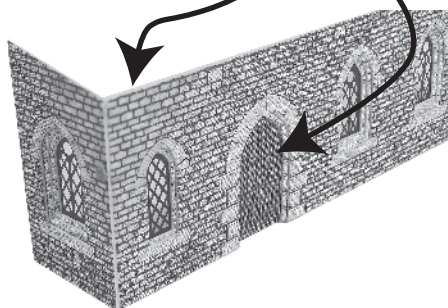
Cut away.  
Keep the base flat and fold the walls around. fix with tiny spots of glue placed around the edge of the base card. Fit with the cut away section next to the doorway opening.

Fit the five AW1. window units you assembled earlier behind the openings.

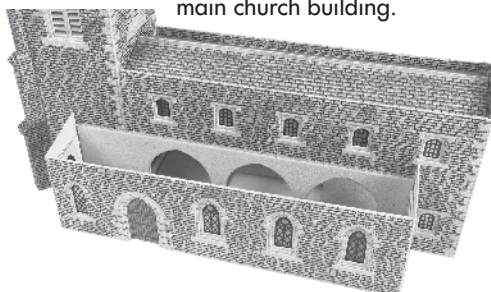




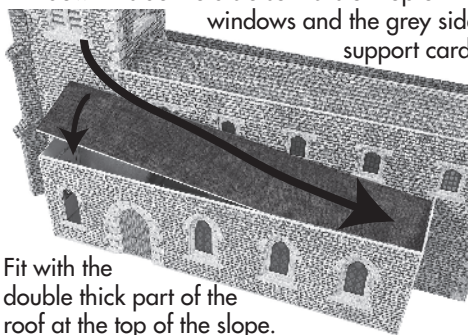
Fit the door with the frame (AD1 & AD2) and the smaller window AW3



Fix the aisle to the side of the main church building.



Fold the yellow section of the aisle roof back & glue to make double thickness, then carefully fit down inside the aisle so it sits on top of the windows and the grey side support card.



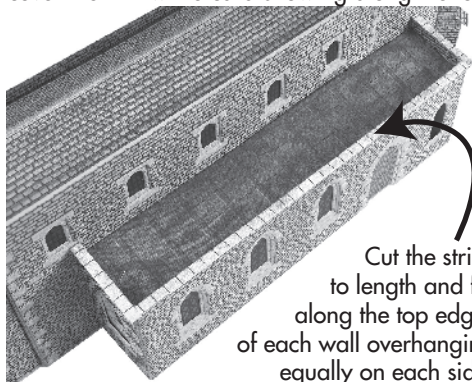
Fit with the double thick part of the roof at the top of the slope.



Cover the white bits of walls standing above the roof at each end with the small inner end walls (on sheet 'A')

CAPPING STONE STRIPS.

The three walls of each aisle need capping off to cover the thin white card showing along the tops.



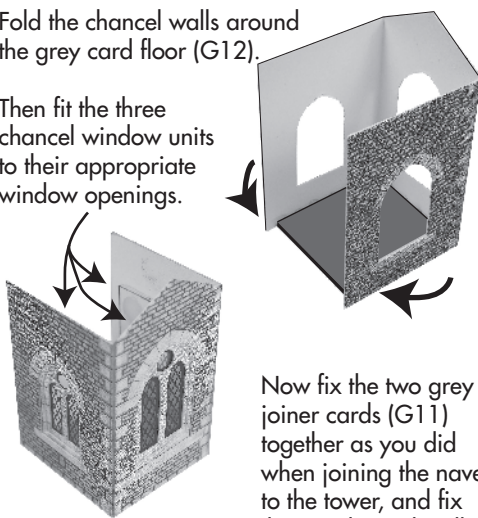
Cut the strips to length and fix along the top edges of each wall overhanging equally on each side.

Don't forget to paint the edges of the strips.

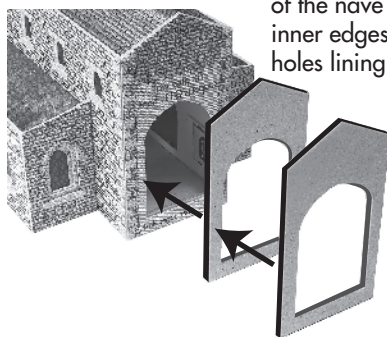
## Fig.6. THE CHANCEL.

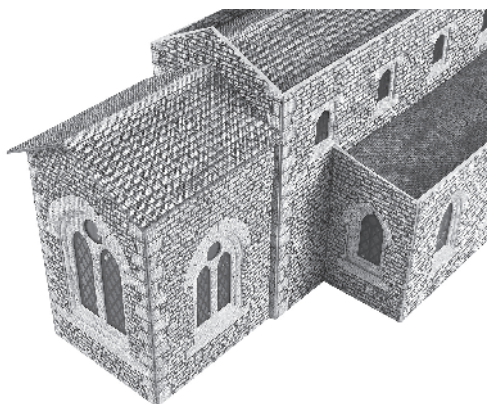
Fold the chancel walls around the grey card floor (G12).

Then fit the three chancel window units to their appropriate window openings.



Now fix the two grey joiner cards (G11) together as you did when joining the nave to the tower, and fix them to the end wall of the nave with the inner edges of the holes lining up flush.



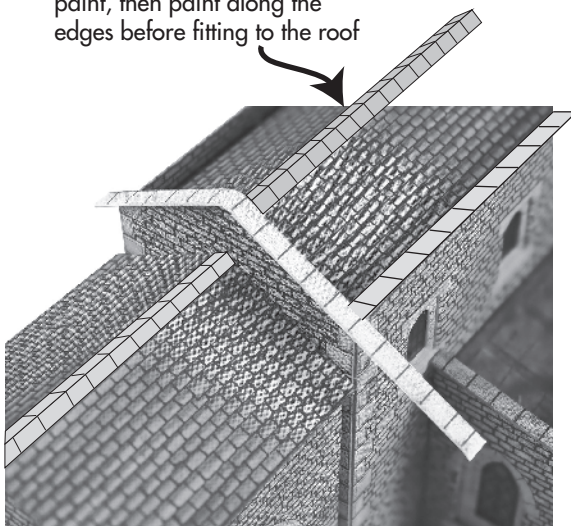


Fit the chancel on to the end of the nave like this and then sit the roof on top.

## Fig.7. WALL CAPPING & RIDGE TILES.

The three nave walls need capping with the thin card strips as with the aisles and all the roof ridges look much better if they are capped as well.

When fitting the ridge tile strips, first cut to the correct length and then locate the centre score line and loosen up a little by lightly running the point of your knife along it to make it fold easier. Now fold in half and then paint the white score line with a little watered down paint, then paint along the edges before fitting to the roof

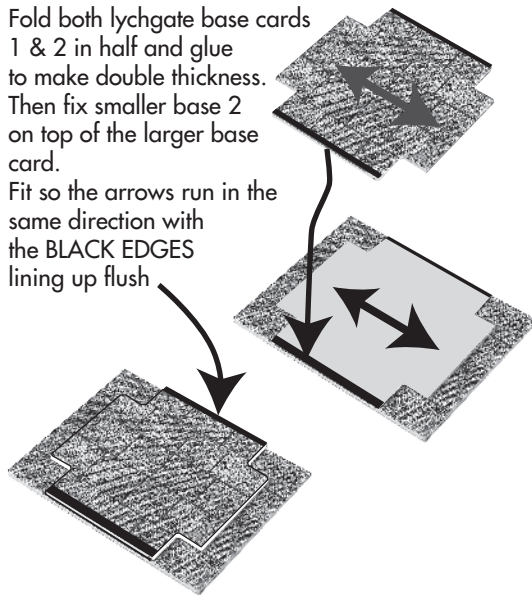


Fit the wall capping to the end sloping wall first, trim the overhangs after the glue has set, then sit the capping on the side wall last.

## Fig.8. THE LYCHGATE.

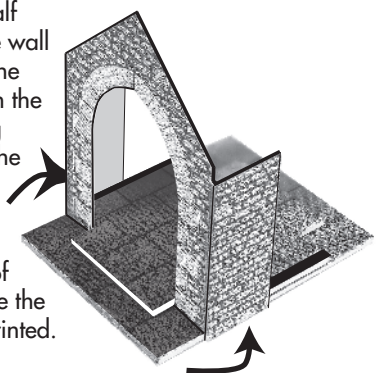
Fold both lychgate base cards 1 & 2 in half and glue to make double thickness. Then fix smaller base 2 on top of the larger base card.

Fit so the arrows run in the same direction with the BLACK EDGES lining up flush

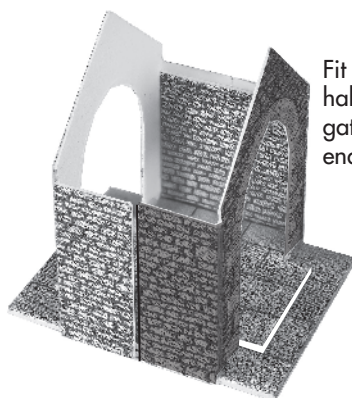


Now fit one half of the lychgate wall so it sits over the lower step with the opening sitting either side of the top step.

The side walls fixed around onto the side of the steps where the black line is printed.



Fit the other half of the gate to other end of steps.

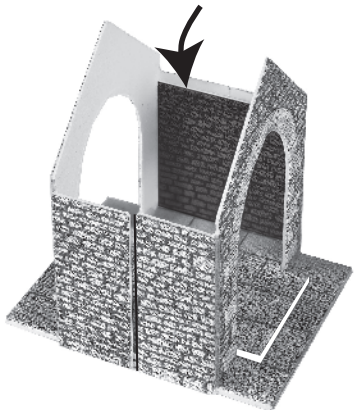


Don't worry if there is a gap in the side walls.



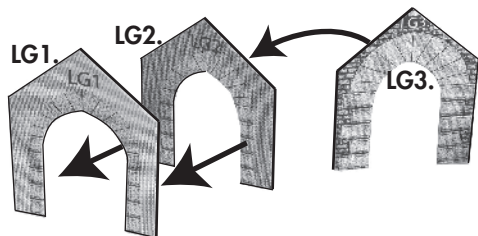
## Fig.8. THE LYCHGATE Continued.

Brace the side walls from inside using the two small inner side walls.



The archway openings in the gate have inner arches that are slightly stepped to give a more relief effect.

There are three arches for each opening.



Fit LG2 to the back of LG1 then LG3 turned the other way around so when fitted to the back of LG2 the whole unit is printed on both sides. Fit them all together bottom edges flush.

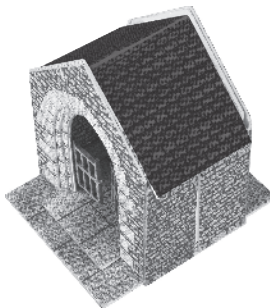


NOTE: the inner arches LG2 & 3 are slightly shorter than LG1. The roof sits down on top of these allowing the outer walls to stand taller for the capping strips to sit on them.



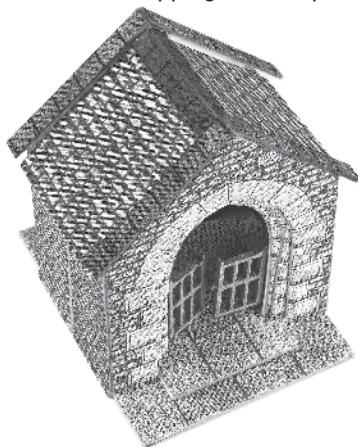
Fit the laser cut gates to the back of one of the openings

Fit the two arch units inside the lychgate, It's easy enough to work out how they fit. Make sure they are sitting down on the base card



The roof sits down on to the lower inner walls with the outer front and back walls standing taller.

Finish off with the addition of ridge tiles followed with the wall capping stone strips.

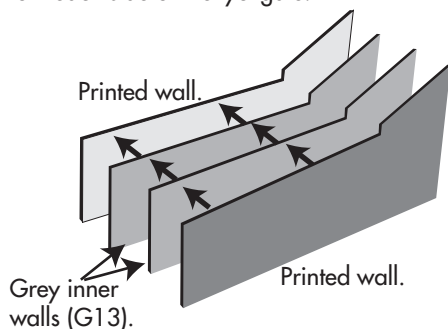


And finally, fit the two tiny crosses as shown.

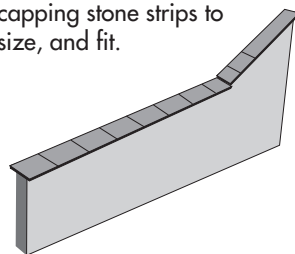


**Fig.9. LYCHGATE SIDE WALLS.**

The side walls are short bits of wall that run out from each side of the lychgate.

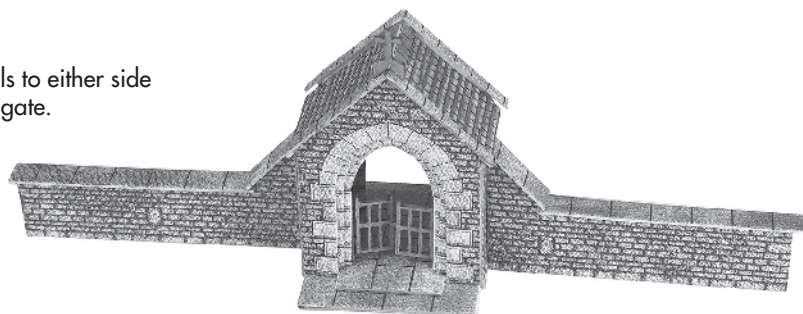


Then cut the wider wall top capping stone strips to size, and fit.

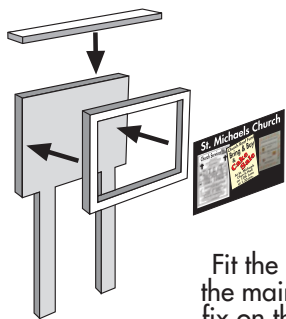


To build each wall take two printed walls and place them back to back, with two grey card inner spacing walls sandwiched in between.

Fit the walls to either side of the lychgate.



**Fig.10. NOTICE BOARD.**

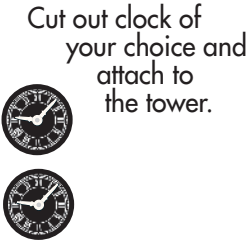


Fit the frame onto the main board and fix on the top strip, then fix notices inside the frame.

Cut out this notice board to edge of black print and fit inside the laser cut notice board as shown.



**CHURCH TOWER CLOCKS**



Cut out clock of your choice and attach to the tower.





## CHURCH PLAN

