

### Fig. 3 - PORCH

First test the side folds and carefully score them if needed. Make sure the sides fold freely. Then affix the handrails to the frame. The notches align snugly together.

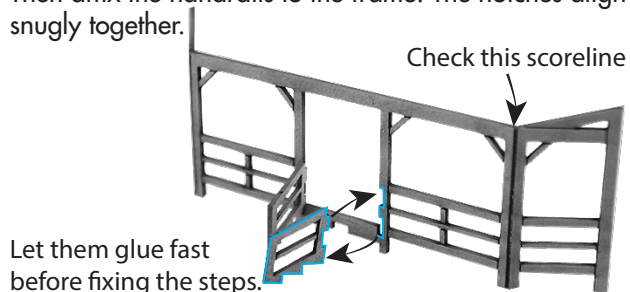

Use tweezers for fixing the steps.

First affix the top step, the step tab slides into the slot on the porch frame and into the notches on the handrails.

Allow the glue to dry.

Then affix the bottom step flush to the notches on the handrail base.

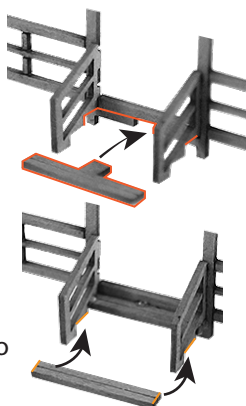

## PN821 Wooden Pavilion

### CHECK LIST

This kit pack contains the following:

1 x Printed Sheet	1 x Clear plastic sheet
1 x Brown Laser Sheet	
2 x Instruction Sheets	

## Instruction Sheet 1

**READ THROUGH ALL THE INSTRUCTIONS BEFORE YOU START.**

*You will definitely need the items in **bold** for this kit.*

To construct this kit you will need the following:

1. A Modellers knife.
2. A steel ruler.
3. Glue - UHU Solvent Free Clear Adhesive is our favourite.
4. A cutting surface - a sheet of card or a cutting mat.
5. **Fine point tweezers** to hold the smaller components.
6. **Metcalf UltraFine Tip Glue Bottle** (Code: MT907)

### EXTRACTING COMPONENTS FROM SHEETS.

To stop the components from falling off the sheets, they are held secure with small score points.

To release them simply run the point of your knife along the cut lines and they will come seamlessly away.

To release the laser components *carefully* push them out from the card, these components are delicate.

Store the released components in a separate 'Builders Yard'. This is an area kept away from your working surface, keep the components here until needed. Use a tray or thick piece of card to make your builders yard.

## Fig. 1 - EDGES & GLAZING

Start off by lightly painting the white edges of the card with water paint. Use a slightly lighter colour than the artwork.

Next cut out some windows from the clear plastic found in the box and affix to the back on the window frames.

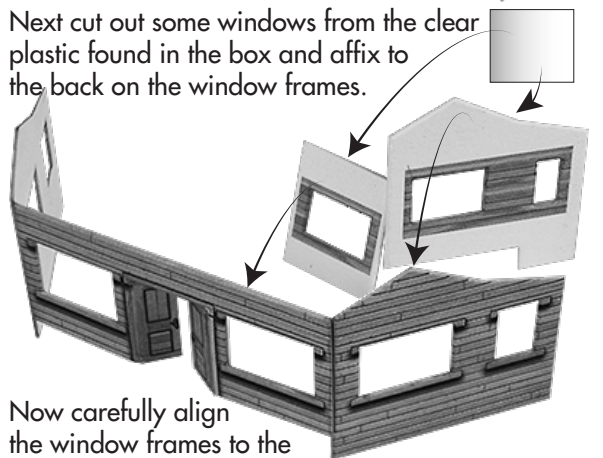

Now carefully align the window frames to the corresponding windows on the main wall section.

## Fig. 2 - BASE

Fold the pavilion floor back onto itself and glue together to make double thickness.

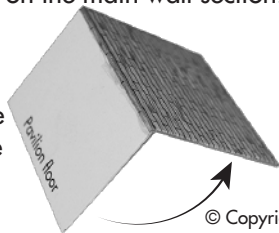

© Copyright 2015.

## Fig. 2 - BASE cont.

The main wall sits flush to the base with the side walls fitting flush to the side of the base. The notch on the base fits flush against the inner window frame tab.

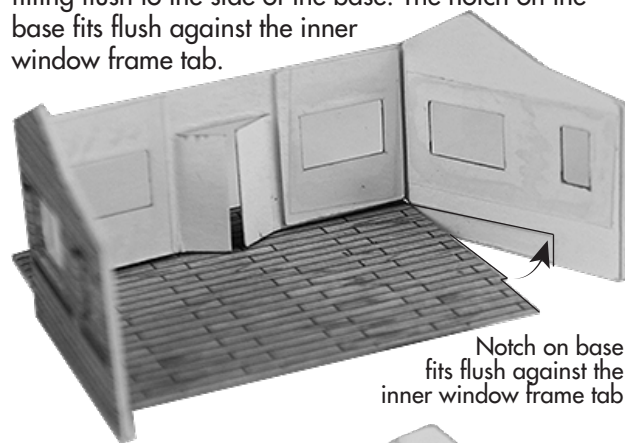

Next fold the rear wall in half and glue together.

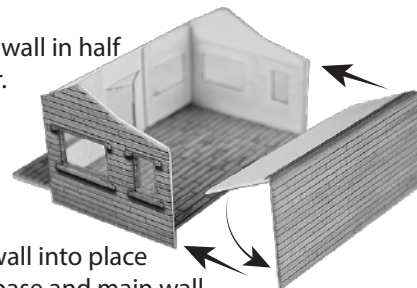

Then fix the rear wall into place flush against the base and main wall  
The folded inner wall fits flush to the top of the base.

Metcalfe Models and Toys Ltd. Bell Busk, Skipton, N. Yorkshire, BD23 4DU.

## Fig. 5 - DORMER CLOCK

First carefully cut out a section from the plastic sheet and glue to the clock faces below, once dry carefully cut one out.

Fold the top tabs down and fix flush to either side of the circular hole.

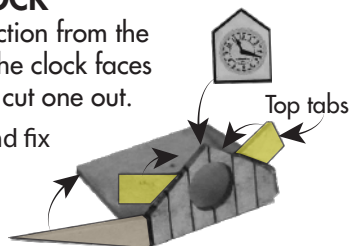

The cut out clock should fit snugly between the tabs, check the fit before fixing into place. Then fold back the triangular sides and glue to the square base.



Glue onto the front roof section, then attach the dormer roof section.



TOTAL	86
WATS	4
OVERS	18
LAST INNS	25



## PN821 Instruction Sheet 2

### Fig. 4 - PORCH & ROOF

Now wrap the finished porch around the extruded base section and glue flush to the side walls.

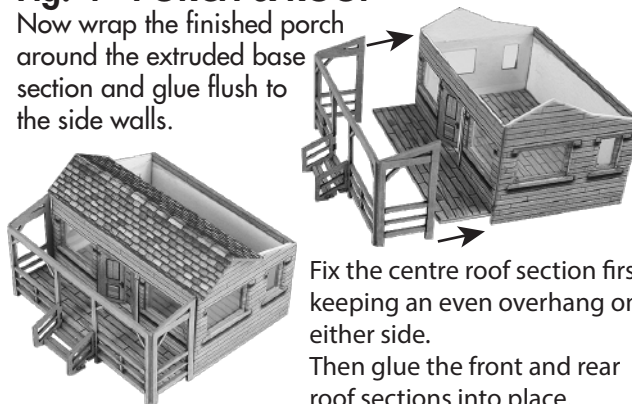

Fix the centre roof section first keeping an even overhang on either side. Then glue the front and rear roof sections into place.

Then glue the barge boards flush to the underside of the roof overhang.

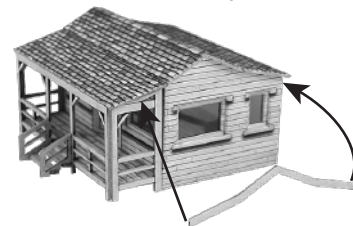

© Copyright 2015.

Metcalfe Models and Toys Ltd. Bell Busk, Skipton, N. Yorkshire, BD23 4DU.