

PN182 N Scale WAREHOUSE

READ THROUGH ALL THE INSTRUCTIONS BEFORE YOU START.

To construct this kit you will need the following:

1. A Modellers knife.
2. A steel ruler.
3. Glue - See best glues in next column.
4. Ultra Fine Tip Glue Applicator, see right.
5. A cutting surface - a sheet of card or a cutting mat.
6. Fine point tweezers to hold the smaller components.
7. Water colour paints and a very fine brush, for painting the edges and corners.

GETTING STARTED

1 EXTRACTING COMPONENTS FROM SHEETS.

To stop the components from falling off the sheets, they are held secure with scorelines. These are cuts that only go about 75% of the way through the card. To release them simply run the point of your knife along the scorelines and they will come seamlessly away. These scorelines are indicated with blue arrows: **WARNING**, Cut with care using a knife that is not too sharp, this will reduce the risk of the blade running out of the score and cutting the kit components.

2 MAKE YOUR 'BUILDERS YARD'.

This is an area kept away from your working surface, where you store ALL components extracted from the base sheets until needed. Use a piece of thick card or a tray to make your builders yard.

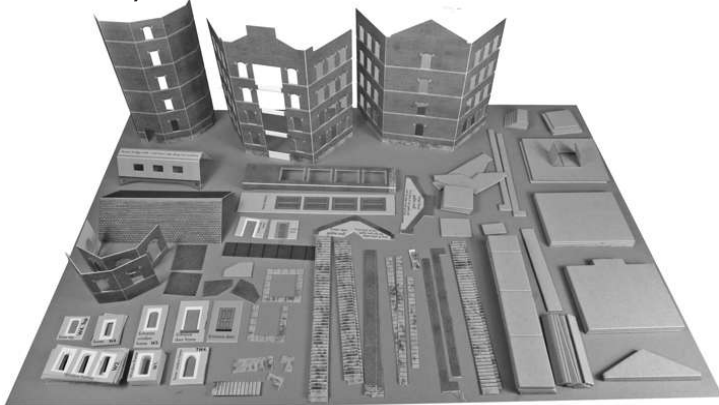

Keep multiple components in neat piles, and before you extract the plain grey card components, write their code numbers on the backs of each one (key to code number on next page).

Your **WORKING** area should have a clean flat surface, and should only contain the kit parts you are actually working on.

EVERYTHING ELSE SHOULD BE KEPT NEATLY ARRANGED IN THE BUILDERS YARD, UNTIL NEEDED.

PLEASE NOTE: Don't throw anything away. Keep all offcuts and waste card in a box until the kit is finished, just in case you can't find anything. The chances are that it will be there.

INSTRUCTION SHEET 1

CHECK LIST

This kit pack should contain the following:

- 1 x SHEET A - Main walls and corner stones etc..
- 1 x SHEET B - Window frames, bridge and tower.
- 1 x PLAIN GREY CARD - (Sheet 1) Inner floors etc.
- 1 x PLAIN GREY CARD - (Sheet 2) Steps and spacers etc.
- 2 x INSTRUCTION SHEETS.
- 1 x Glazing sheet.
- 1 x Ridge Tile sheet

The **METCALFE Ultra Fine Tip Glue Bottles** are essential for gluing the smaller components in this kit.

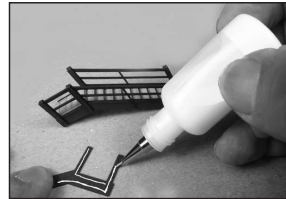

Tiny strips or spots of glue can be accurately laid down with precision.



Always replace the pin after use and store the bottles upside down to keep the glue moist.

UHU Solvent Free All Purpose Adhesive Glue

Works very well in our fine glue applicators.

Dries quickly, but allows time for positioning of kit parts.

Speed Bond by Deluxe Materials

This is an excellent PVA. based glue that dries quickly, but allows time to get parts into position.
www.deluxematerials.com

GLAZING

Cut out the glazing sheets along the outer white printed lines and place them on a separate piece of card or on small plate until needed.

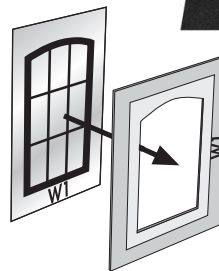
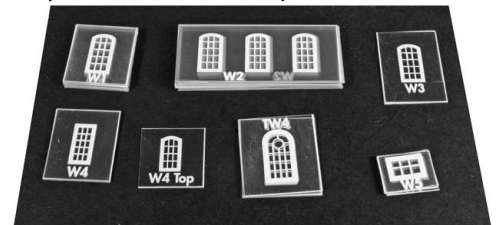

Attach each piece of glazing to the back of its corresponding window frame. Fix with the printed side facing through the openings.



Place back in builders yard till needed.

Note: The small glazing for the bridge (W5) has no window frames, they just fit straight to the bridge.

DOORS

Fix the two single doors for the entrance and the tower to the back of their matching door frames.

© Copyright 2015 Metcalfe Models & Toys Ltd.

PLAIN GREY CARDS

These grey die cut cards contain the components mainly used inside the buildings to strengthen and hold them together.

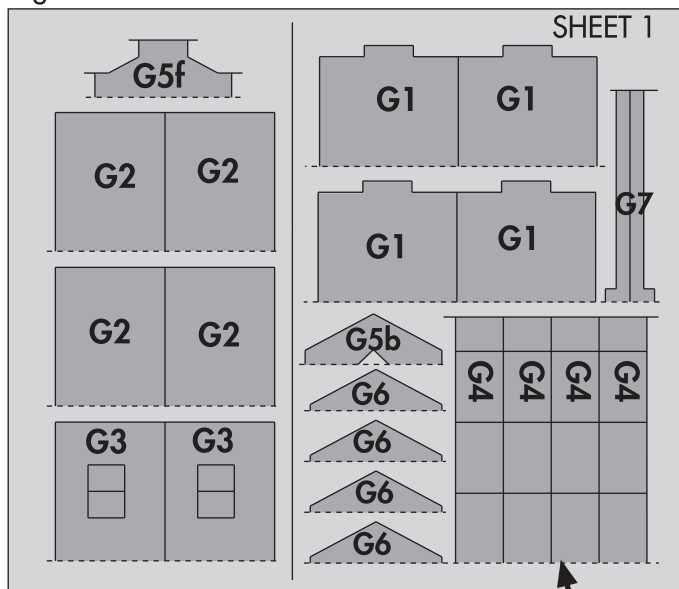

KEY

- G1. Inner floors with door tab.
- G2. Inner floors without door tab.
- G3. Top inner floors.
- G4. Floor spacers.
- G5. Front & rear inner gable spacers.
- G6. Roof supports.
- G7. Top inner side wall spacers

Dotted lines indicate score lines to be cut to release components.

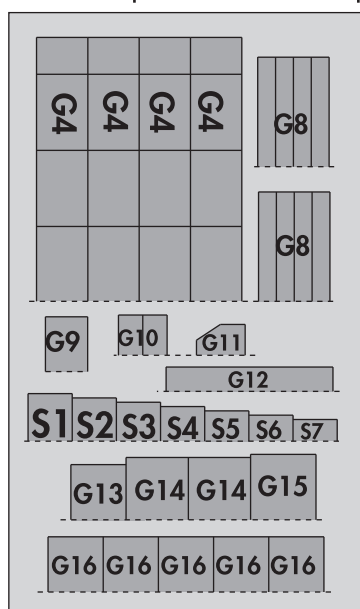

- G8. bottom floor spacers x 8
- G9. Entrance inner floor.
- G10. Bridge formers.
- G11. Inner spacer for steps side wall.
- G12. Bridge floor.
- G13. Tower top inner floor.
- G14. Tower top spacer (fit one either side of G15.).
- G15. Described above.
- G16. Tower inner floors x 5.
- S1-7. Seven steps to lead up to entrance building. (don't write on these)

Just to help things along, write in the centre of each plain grey component, the code numbers shown above. before you cut them out. DON'T write on the 7 steps though. Just keep these piled up in order of size until needed see Fig.12.

Lets Start Building

The main building is constructed in two halves. This allows the building to be either low relief for standing the two half sections against a back wall where space is tight or you can fix them together to make a stand alone structure. The bridge with this kit is for connecting buildings together at upper floor height when adding on more kits.

Fig.1. FIT THE WINDOWS

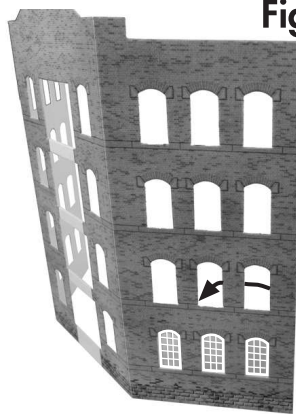

Fit all the window frames with glazing attached. Line each one up with the corresponding openings and slide into position so that the white frames are centred in the window openings.

When fitting just put tiny spots of glue between each window using the Ultrafine Glue Applicator. Not too much glue or it will ooze out around the windows as you position the window frames.

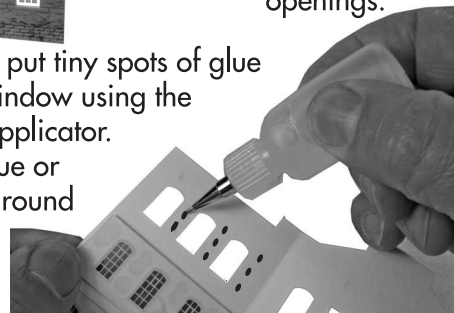
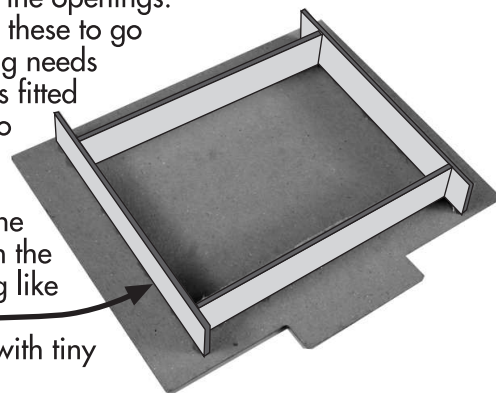

Fig.2. INNER FLOORS

Starting with the front section of the main building (that's the one with the door openings in the gable wall) there are four inner floors with tabs on one edge G1. that fit through the openings.

The first one of these to go into the building needs to have spacers fitted underneath it to hold it at the correct height. Stand four of the G8. spacers on the floor something like this



fixed in place with tiny spots of glue.



Now turn the floor over and stand on a flat surface whilst pushing the tab through the lower door opening. Fix the edges of the floor to the back of the front gable wall and just ONE side wall as shown. Make sure each floor is properly fast to the two walls and tight into the corner.

The floor spacers G4. fold around to form a triangular shape with the smaller tab fixed to the outer edge.

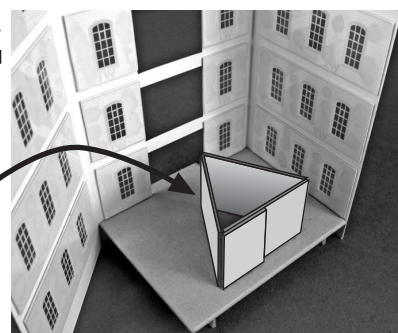

This is then stood on the bottom floor with the next inner floor sitting on top of it, and so-on floor by floor until all are installed.

Fig.2. Continued.

Fix the other three G1. inner floors into place, each one sitting flat down onto the triangular floor spacers G4. The top floor G3. should be fitted so that the two tabs are folded upwards. (These hold the roof supports, fitted later on). As each floor is fitted you will note that the edges of the floors fit against the outer walls in the small gap between the window frames.

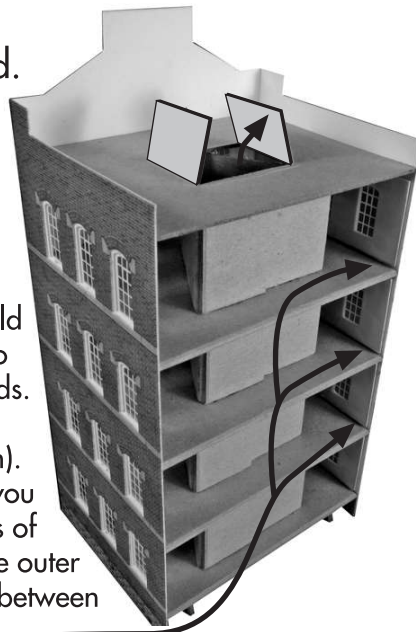

Finally, fold around and fix the other side wall to the edges of the inner floors. Hold tight till fast, or stand on its side and weight down till fast. Shown here are bits of scrap steel, but something like a book will do just as well.

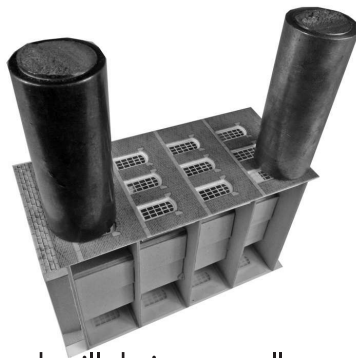

Now repeat the whole process with the other half of the building (using inner floors G2.)

Fig.3. INNER GABLE WALLS.

The inner front and rear inner gable walls on to the matching grey spacers (G5f & G5b) Keep all edges flush.

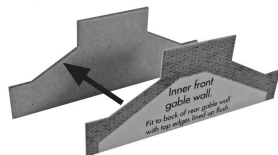

Fit them on the gable walls as shown here.

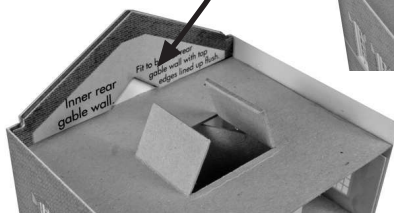
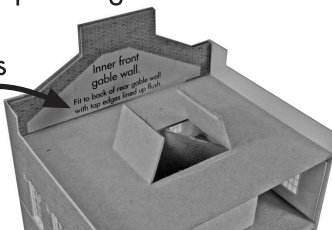

Make sure top edges all line up flush.

Fig.4. INNER SIDE WALLS.

These narrow strips fit along the inside of the wall tops. Fit the printed strips onto the grey strips G7. Keep all edges flush.

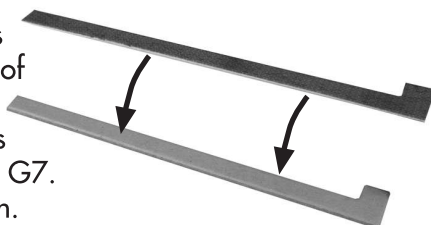

Put them to one side at this point until needed (Fig7/8).

Fig.5. FRONT GABLE DOORS.

The tall brick doorway unit has two side wall strips that fold around at a right angle. The door strip fits behind with doors showing through the four openings.

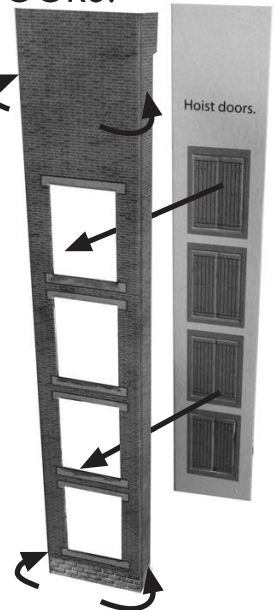

BUT BEFORE YOU DO ANY GLUING, We need to talk about painting the white edges that show on the corners.

These are best painted before fitting, and it is very easily done. All you need is simple set of child's water colour paints and a fine brush.

Fold the edges of the card back and gently run the point of your brush along the exposed white card.



Only tiny amounts of paint on your brush. It's better to have to go over it a few times than to flood it with paint.

The corner stone strips will need painting as well.



Paint the outer edges too!

Mix your colour with lots and lots of water, apx. 1 part paint to 5 parts water, maybe more. **TEST ON WASTE CARD FIRST UNTIL YOU HAVE THE CORRECT SHADE AND COLOUR.**

Before the paint dries, run your finger along the edge to rub the colour into the absorbent white card. Then wipe away any paint that has run onto the printed surface before it dries.

Remember, you only need to just slightly tint the card with a little colour, **DON'T** paint a thick solid line down the edges, you will only make it look worse.

BACK TO THE DOORS.

Fix the door to the front of the building with the long narrow sides folded around the floor tabs that stick out of the building. Test without glue first then

put tiny spots of glue on the edges of the walls and the inner floors. Hold firmly until fast.

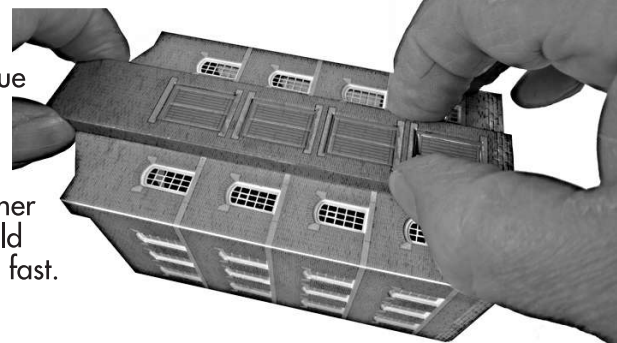

Fig.6. CORNER STONES.

The long corner stone strips fold along the centre to form a right angle before fitting over the corners of the buildings. Paint corners and edges as described in Fig.5.

DECISION TIME

By now you will have two almost complete half buildings. If you are making low relief buildings then carry on to the next section (Fig.7). If you want a complete stand alone building then the two halves of the warehouse will need to be fixed together, so go on to **Fig.8**.

Fig.7. FITTING THE ROOF.

The inner side wall strips, described in Fig.4. need to be cut in half and fitted to the inside of the walls with top edges lined up flush with outer walls.

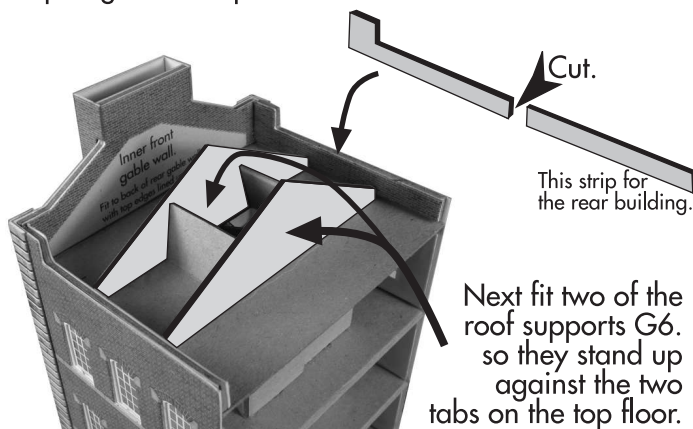

The roof will also need to be cut in half. Fit down on top of the roof supports before fitting the capping stone strips. Paint the edges before fitting. The two long capping stone side strips will need cutting to fit. Fit smaller capping as shown.

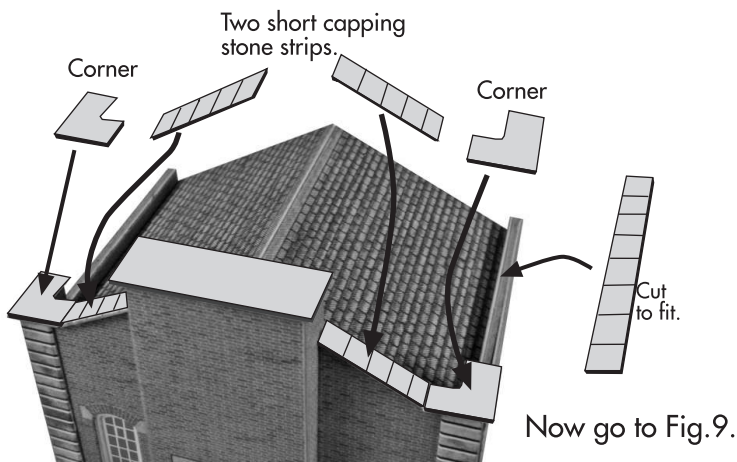
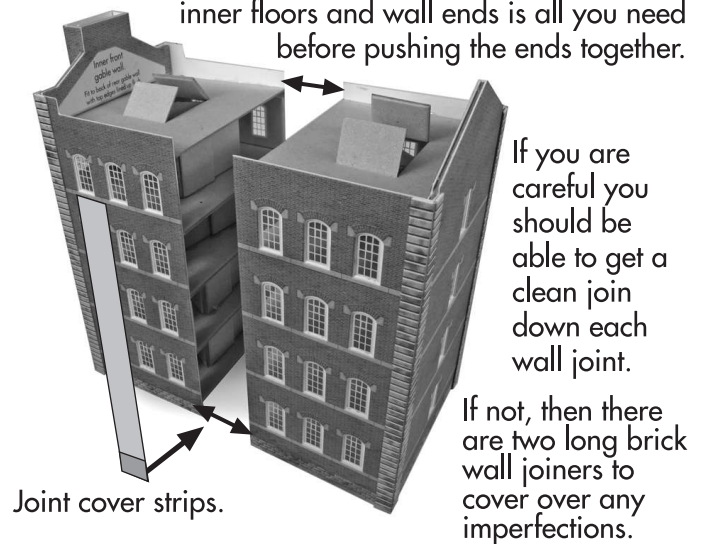
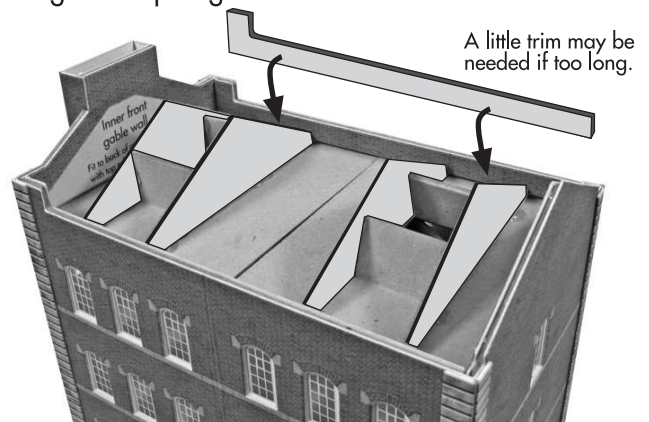

Fig.8. STAND ALONE BUILDING.

The two ends of the building can now be fixed together. Tiny spots of glue attached along the edges of the inner floors and wall ends is all you need before pushing the ends together.



Once fastened together, attach the inner side wall strips making sure top edges are flush with outer walls



Then fit the G6. roof supports are shown opposite, followed with the roof sitting down on top of them.

Finally fit the capping stones, as described opposite, but leaving the side strips as one long piece, which runs the full length of the wall overhanging a little at the end. The rear gable capping has a score in the centre.

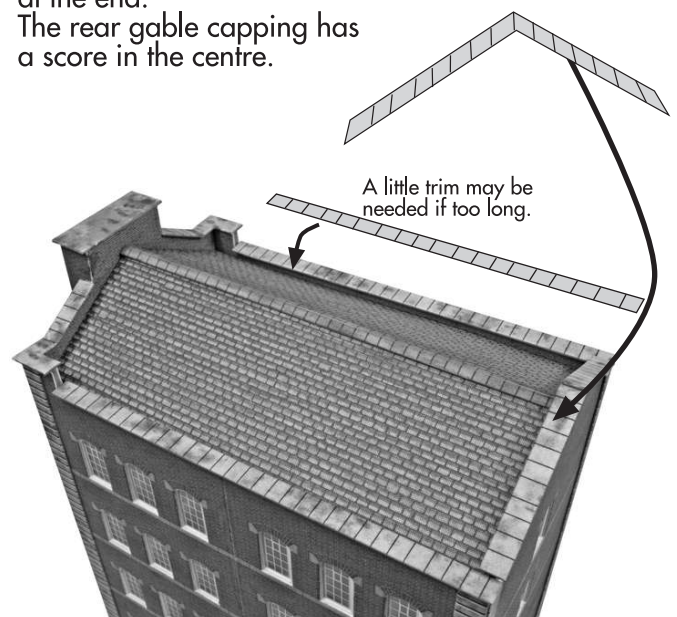

PN182 N Scale WAREHOUSE

Fig.9. THE TOWER.

Fit the five tower window frames first, then the five grey inner floors G16. Fix them to two walls as shown then fold the other walls around and fix

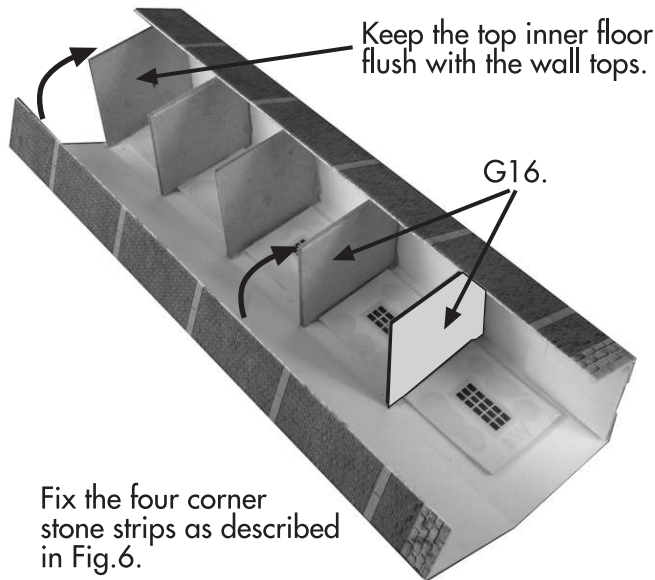

Fix the four corner stone strips as described in Fig.6.

Fig.10. THE TOWER TOP.

There are four different sized grey cards that fit between the top of the main tower and the Tower Top Building. These are G13. G14. & G15.

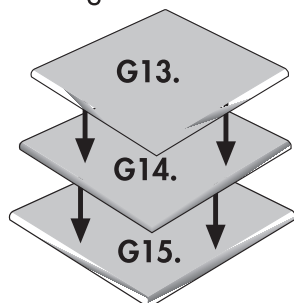

There are two G14. cards. Fit one of them directly on top of the tower. The other is sandwiched between G15. at the bottom and G13. on top

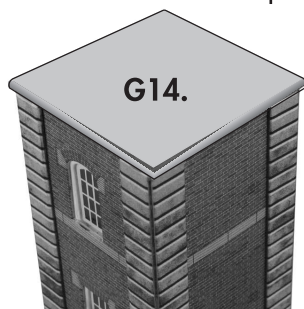

Fix them together each one centred on top of the other.

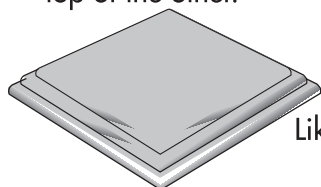

The tower top building wraps around the smallest top grey card G13. like this, with the two larger cards stepped out underneath.

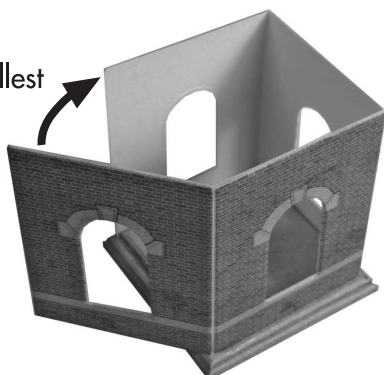

INSTRUCTION SHEET 2

Fig.10. THE TOWER TOP Continued.

Once the walls are fixed around the base card, fit the four small cornerstone strips. Then fit the four window frames (TW4.) inside the building so they are centred in each window opening.

Fit the flat roof down inside the building sitting on top of the window frames.

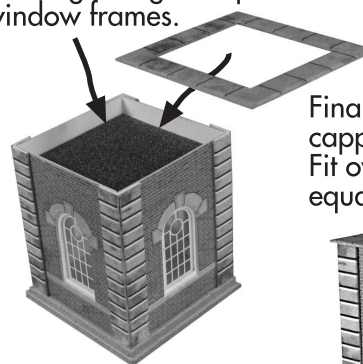

Finally fit the square capping stone piece. Fit overhanging equally on all four sides.

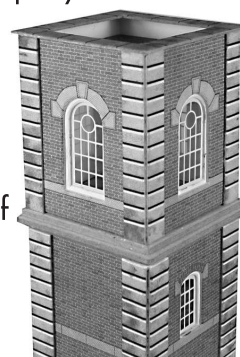

Then fit to the top of the tower.

Fig.11. THE ENTRANCE BUILDING

Start by fitting the two windows and the door with its frame, then wrap the building around the grey base card G9.

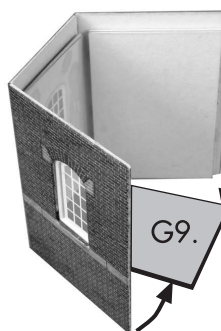

When fast, fit the flat roof which sits down on top of the windows and door. Finish off by fitting the capping stones.

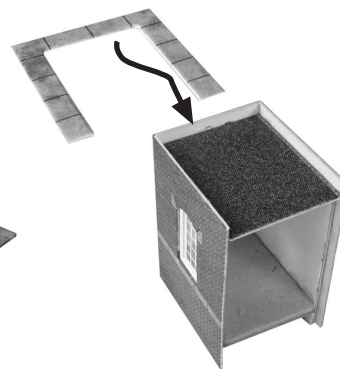

Your entrance building should look like this. It just needs the steps.

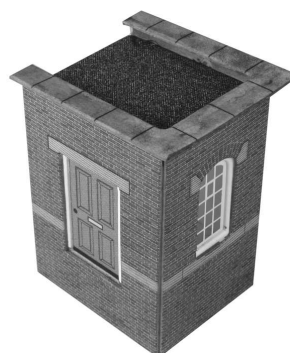
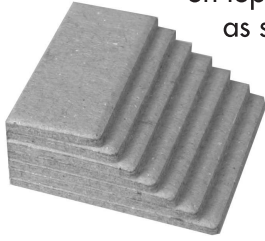
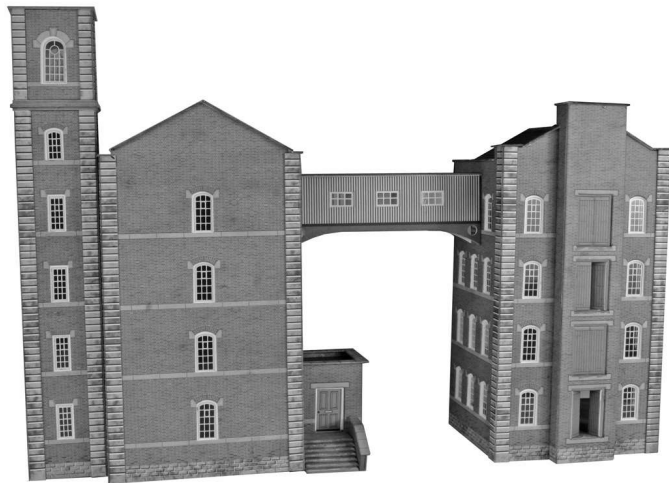
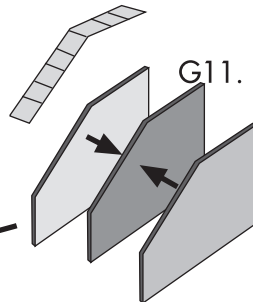
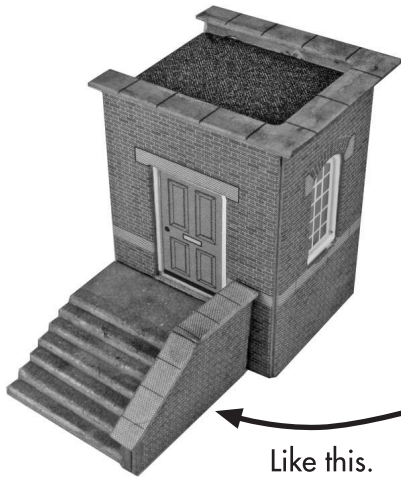

Fig.12. THE STEPS

The grey steps S1-7. are simply glued on top of one another to form the stairs as shown here. keep back and sides flush and straight.



The small wall that fits down the side of the steps is made by sandwiching the grey card G11. between the two small printed side walls. Cut and fit the capping stone strip.



Shown here built in low relief.

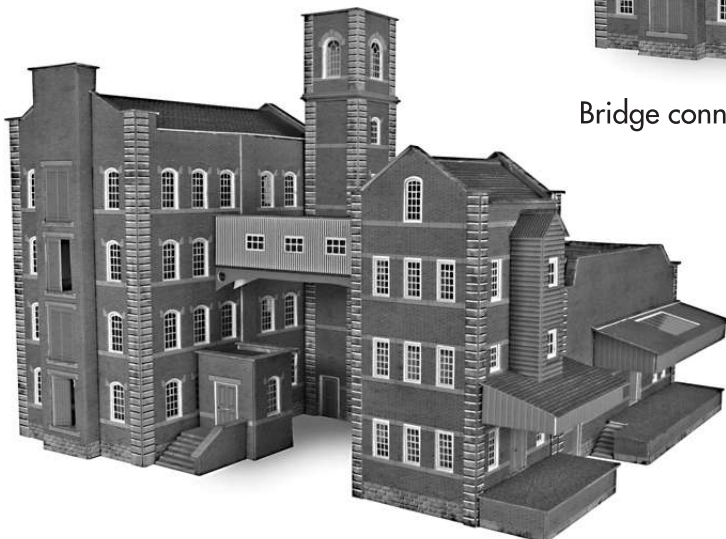
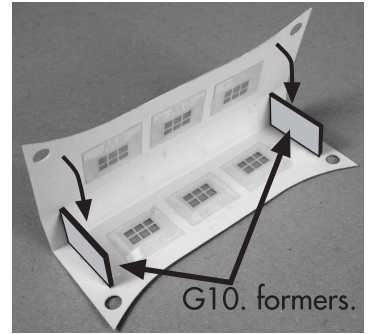
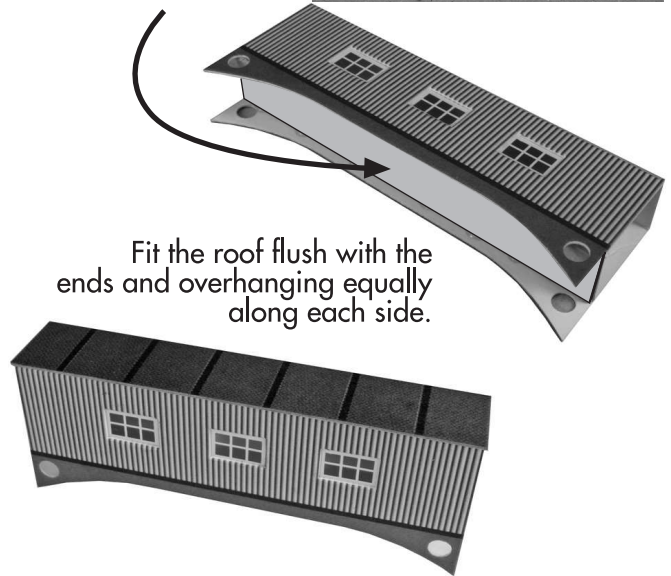

Fig.13. THE BRIDGE

Fit the tiny glazings if you haven't already done so and then fit the two tiny grey card formers G10. to the side wall and roof as shown here. Fold the other side wall down onto the formers and then fit the long grey bridge floor G12.



Fit the roof flush with the ends and overhanging equally along each side.



The bridge will only be needed if you are connecting two buildings together. You see then on many old mills connecting the upper floors between buildings.

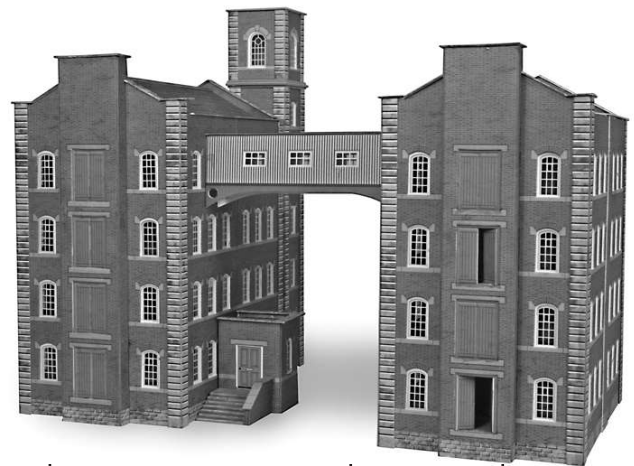

Bridge connecting two warehouses together.

Warehouse kit alongside PN183 Small Factory kit.