

PN176/7 N Scale Low Relief TERRACE HOUSE BACKS

READ THROUGH ALL THE INSTRUCTIONS BEFORE YOU START.

To construct this kit you will need the following:

1. A Modellers knife.
2. A pair of sharp pointed scissors.
3. A steel ruler.
4. Glue - UHU Clear Adhesive is our favourite.
5. Ultra Fine Tip Glue Applicator, *see right*.
6. A cutting surface - a sheet of card or a cutting mat.
7. Fine point tweezers to hold the smaller components.
8. Water colour paints and a very fine brush, for painting the edges and corners.

GETTING STARTED

1 EXTRACTING COMPONENTS FROM SHEETS.

To stop the components from falling off the sheets, they are held secure with scorelines. These are cuts that only go about 75% of the way through the card.

To release them simply run the point of your knife along the scorelines and they will come seamlessly away. These scorelines are indicated with blue arrows: →

WARNING, Cut with care using a knife that is not too sharp, this will reduce the risk of the blade running out of the score and cutting the kit components.

2 MAKE YOUR 'BUILDERS YARD'.

This is an area kept away from your working surface, where you store ALL components extracted from the base sheets until needed.

Use a piece of thick card or a tray to make your builders yard.

Cut out all the components from sheets A, B, C, & the grey strengthener sheet and place inside your builders yard.

Don't extract the chimney top stones from sheet B until you need them as they are easy to get mixed up.

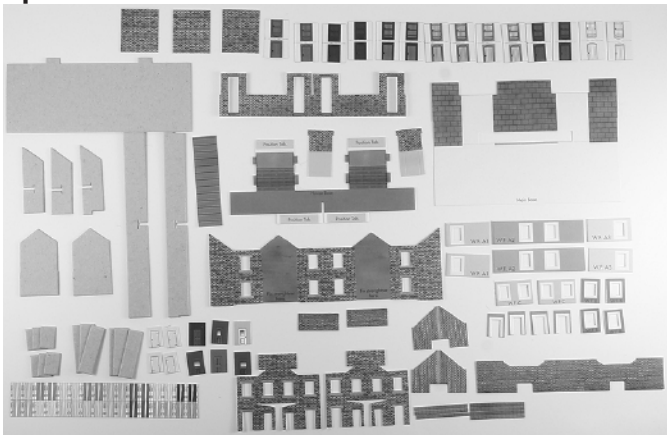

Your **WORKING** area should have a clean flat surface, and should only contain the kit parts you are actually working on.

EVERYTHING ELSE SHOULD BE KEPT NEATLY ARRANGED IN THE BUILDERS YARD, UNTIL NEEDED.

PLEASE NOTE: Don't throw anything away. Keep all and waste card in a box until the kit is finished, just in case you can't find anything. The chances are that it will be there.

INSTRUCTION SHEET 1

CHECK LIST

This kit pack should contain the following:

- 1 x SHEET A - Gable end parts
- 1 x SHEET B - Main wall and base
- 1 x SHEET C - Yard gates, curtains and extras.
- 1 x PLAIN GREY CARD - Interior strengthening parts.
- 3 x INSTRUCTION SHEETS.
- 1 x Glazing sheet.

The METCALFE Ultra Fine Tip Glue Bottles are essential for gluing the smaller components in this kit.

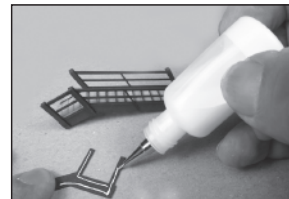

Tiny strips or spots of glue can be accurately laid down with precision.



Always replace the pin after use and store the bottles upside down to keep the glue moist.

UHU All Purpose Adhesive Glue

Is available in standard and solvent free. Both types are fine for use in our glue bottles, even though the instructions on the back of the packs warn against solvent based glues, we have tested the UHU solvent based glue and it works fine. The solvent free glue doesn't string as much, but can be a little harder to clean off if it drips onto unwanted areas.

Speed Bond by Deluxe Materials

This is an excellent PVA. based glue that dries quickly, but also allows time to get parts into position. It has the added advantage that it dries clear leaving little evidence if it oozes out of joints etc. Used in our fine glue applicator bottles a 112g bottle lasts for ages. www.deluxematerials.com

Fig. 1. MAIN HOUSE WINDOWS (code WA)

Cut out the glazing sheets along the outer white printed lines and place them on a separate piece of card or on small plate until needed.

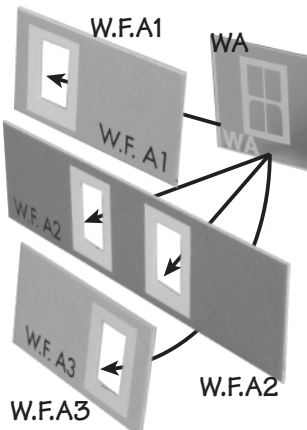
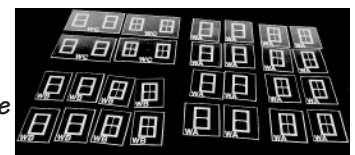

Start off by matching the WA glazing with the window frames:

- 2 x W.F.A1 (yellow)
- 2 x W.F.A2 (violet)
- 2 x W.F.A3 (pale green)

There are 2 different styles to choose from. Decide which style to use and fix each of the WA glazing to the back of the frames, matt side facing through the frame opening.

NOTE: The matt printed side of the glazing is the side that looks best facing through the window openings.

Fig. 2. GABLE END WINDOWS (code WB & WC)

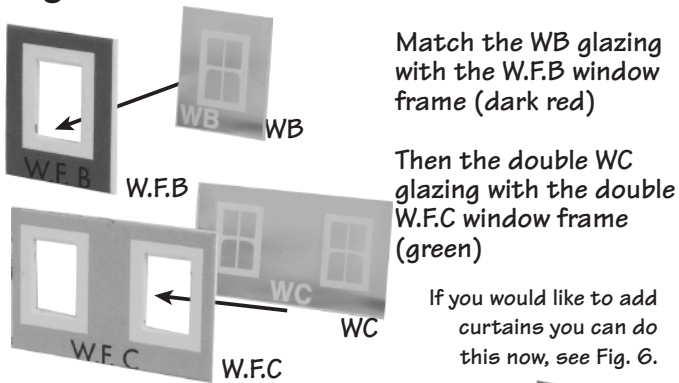
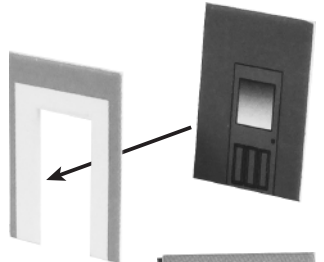

Fig. 3. DOORS

This is also a good time to fix the door of your choice to the orange door frames.



NOTE: Align the printed door to the inside of the frame, as the card on some of the doors are not perfectly aligned to the shape of the frame. Any card that 'overlaps' the door frame will need to be trimmed off so that the frame fits properly later on in construction.

Trim off any overlap flush to the frame

Fig. 4. STRENGTHENERS

Included in this kit is a plain grey card which contains strengthening parts. The diagram below assigns a code to each strengthener.

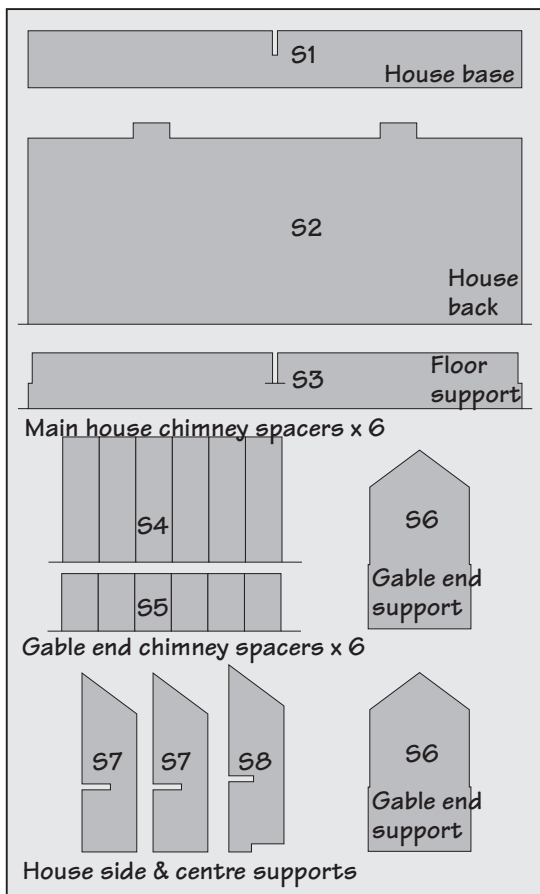
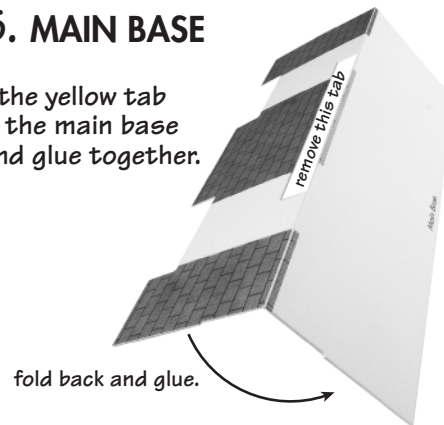
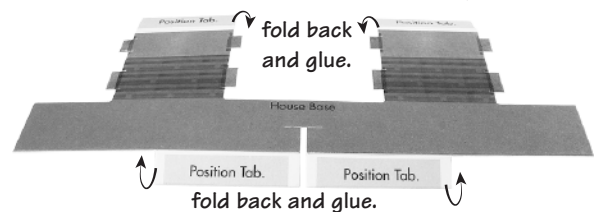

Fig. 5. MAIN BASE

Remove the yellow tab and fold the main base in two and glue together.



Next fold back the yellow position tabs on the house base and glue them into place.



These position tabs then fit snugly into the spaces on the main base, glue into place with the back edges flush.

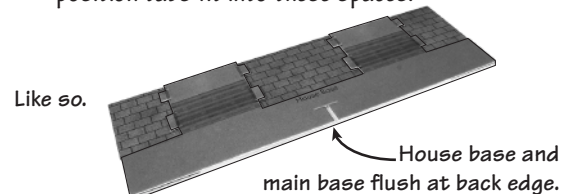
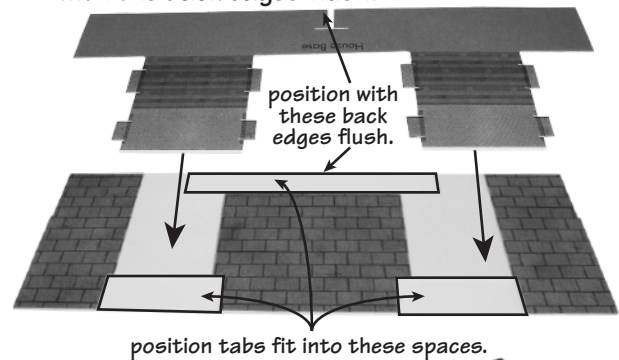

Next, glue into place the house base strengthener (S1). This needs to be flush to the front of the house base, ie flush to the paving artwork (as shown by the dashed line).

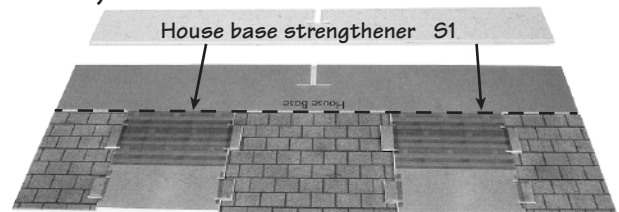

This will leave a brown step showing along the back edge, a little over 1mm deep

This step is where the house back strengthener sits later. (see fig.9)

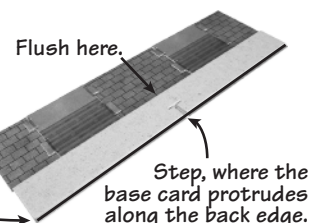

PN176/7

N Scale Low Relief

TERRACE HOUSE BACKS

Fig. 6. CURTAINS

Before you progress onto the main building, if you require curtains, now is the time to fit them.

To fit curtains fix a small strip of waste card to each side of the window, then glue the curtain to the waste card so that it shows through the window (the waste card will space the curtain back from the window a little giving a greater effect of depth).

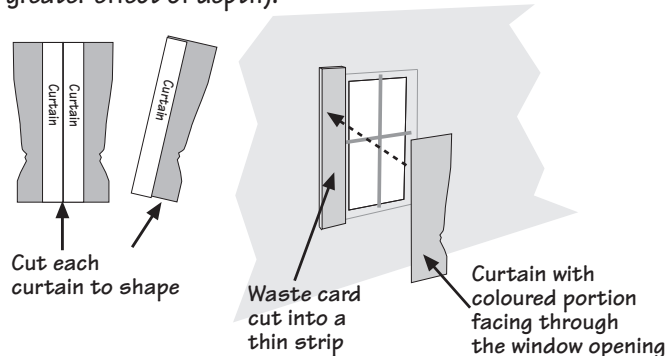
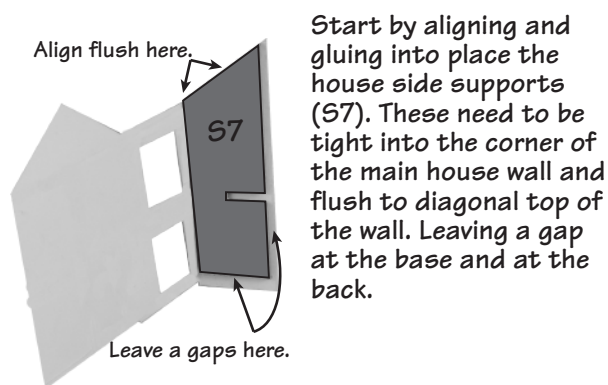
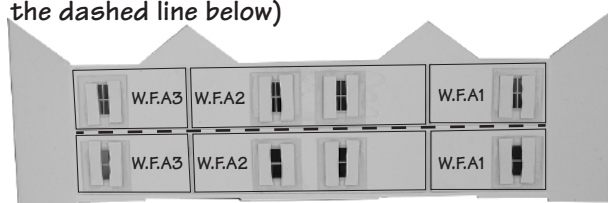
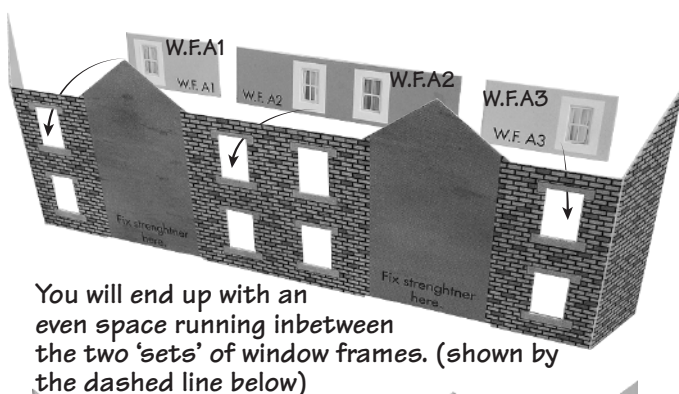

Fig. 7. MAIN HOUSE WALLS



Next, align and glue into place the 6 completed window frames, W.F.A1, W.F.A2 & W.F.A3 (from fig. 1). These windows are the same for both upstairs and downstairs. These are fitted from left to right - A1 on the left, A2 in the middle and A3 on the right.



INSTRUCTION SHEET 2

Fig. 7. MAIN HOUSE WALLS cont.

Now you need to fix the complete main house wall to the base. Test this fit before applying the glue!

The whole wall fits snugly against the strengthener on the base, with the end wall 'wings' folding around and flush against the side of the base.

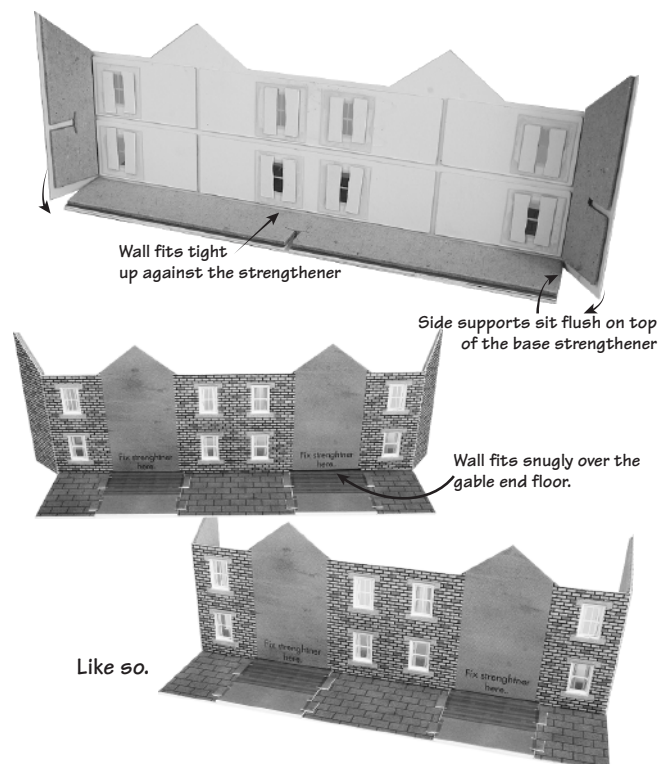
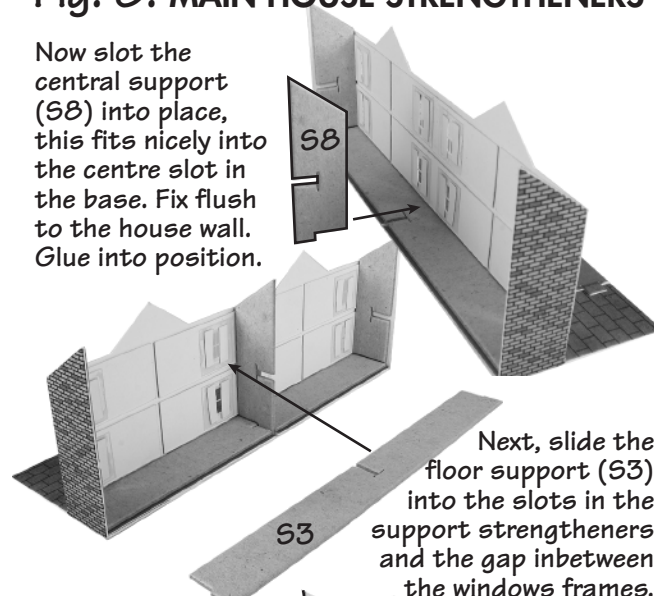

Fig. 8. MAIN HOUSE STRENGTHENERS

Now slot the central support (S8) into place, this fits nicely into the centre slot in the base. Fix flush to the house wall. Glue into position.



NOTE: The floor support needs to be flush to the main wall to leave a 1mm gap for the house back.

1mm gap marked with a dashed line

Fig. 9. MAIN HOUSE BACK

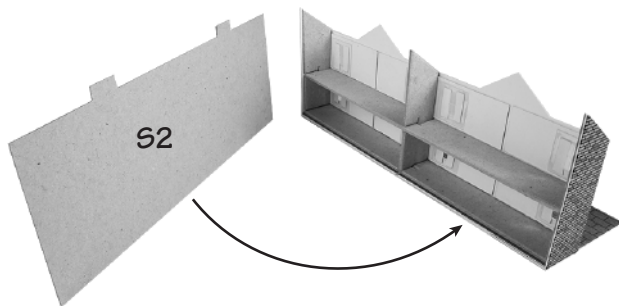

Now is the time to fit the house back (S2). If all has gone to plan you will have a snug groove down each side wall and on the base for the back to neatly slot into, becoming naturally flush with the back of the base and the side walls.

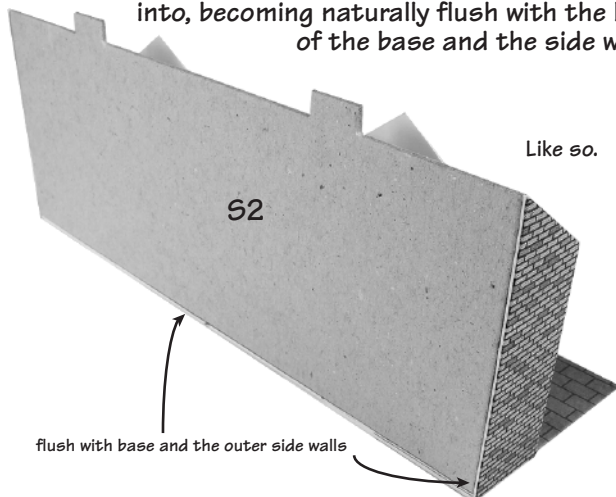
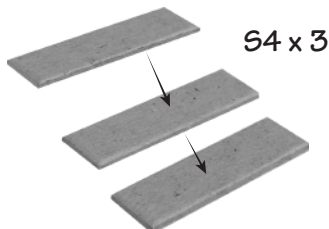

Fig. 10. MAIN HOUSE CHIMNEY STACK

Glue flush together two separate sets of three main house chimney spacers (S4)



Then 'wrap' the chimney stack around the three spacers keeping the top part (the end with the artwork) flush with the top of the spacers.

Then glue the completed stacks to the house back chimney tab. The chimney stack has 'short wings' that will hang onto the back to position it correctly.

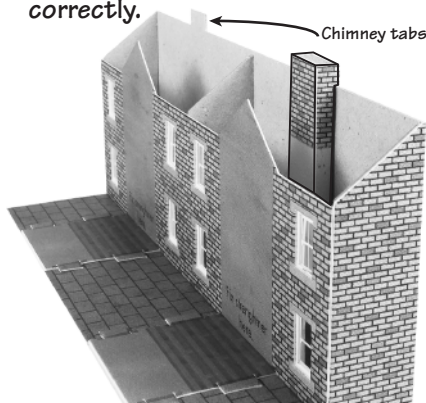

Fig. 11. GABLE END SUPPORTS

Before we move on to the gable ends, carefully align the two gable end supports (S6) flush to the main house wall. Make sure that the base is flush to the gable base floor and the top 'triangles' are aligned correctly.

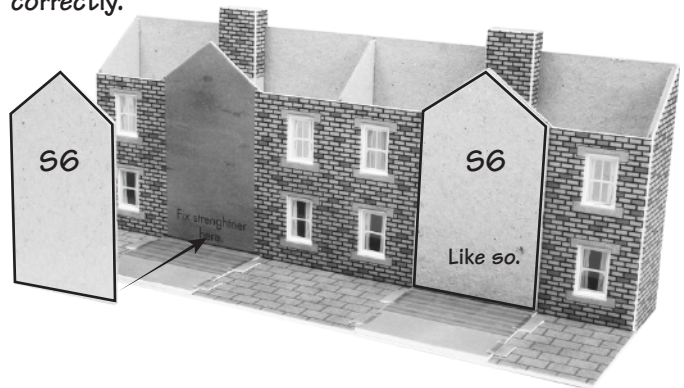
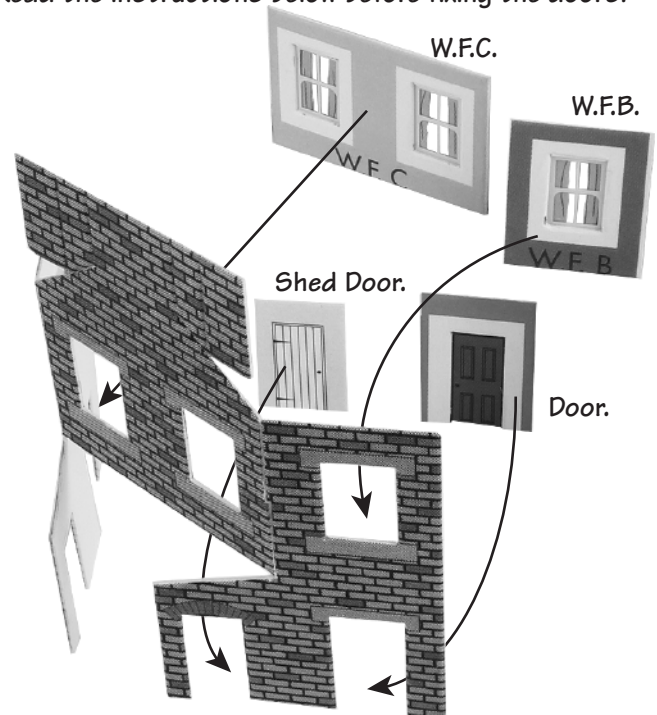
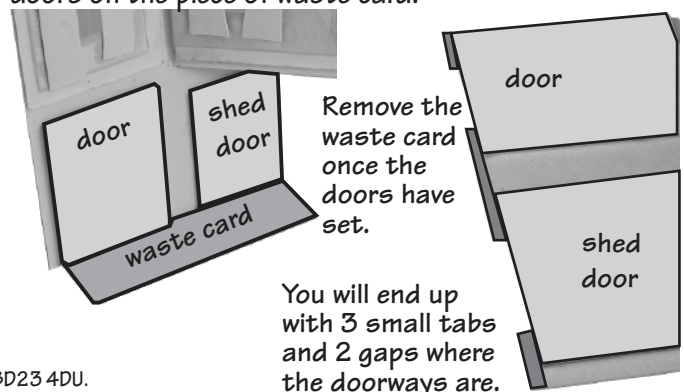

Fig. 12. GABLE END BUILDINGS

Start with the upstairs windows, leave the doors and the shed doors to one side for the moment. The double window (W.F.C.) fits against the end wall with single window (W.F.B.) fits above the doorway on either side. Align and glue into place. Read the instructions below before fixing the doors!



The doors need to be just under 1mm off the base of the gable wall so that the whole structure fits correctly on the base. Position a strip of waste card from sheet A or B flush against the gable wall, then align the doors into the doorways while 'resting' the doors on the piece of waste card.



PN176/7 N Scale Low Relief TERRACE HOUSE BACKS

Fig. 13. GABLE END CHIMNEY

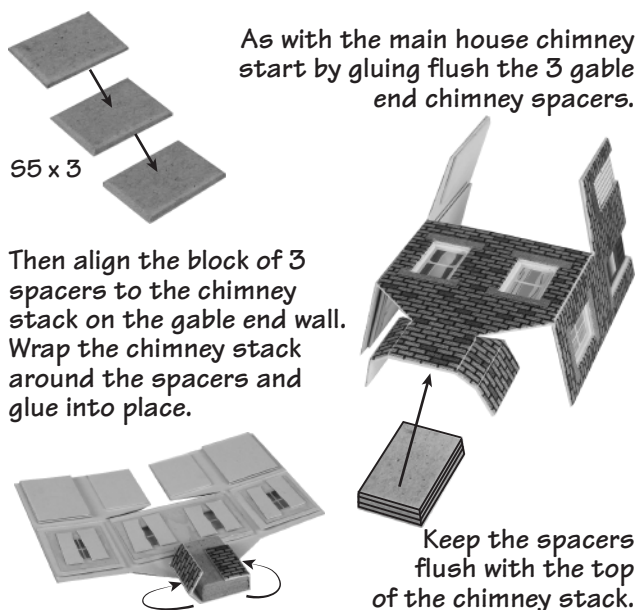

Fig. 14. GABLE END

Next you will need to fix the gable end into place on the main base and to the main house. **TEST THE FIT BEFORE GLUING INTO PLACE.**

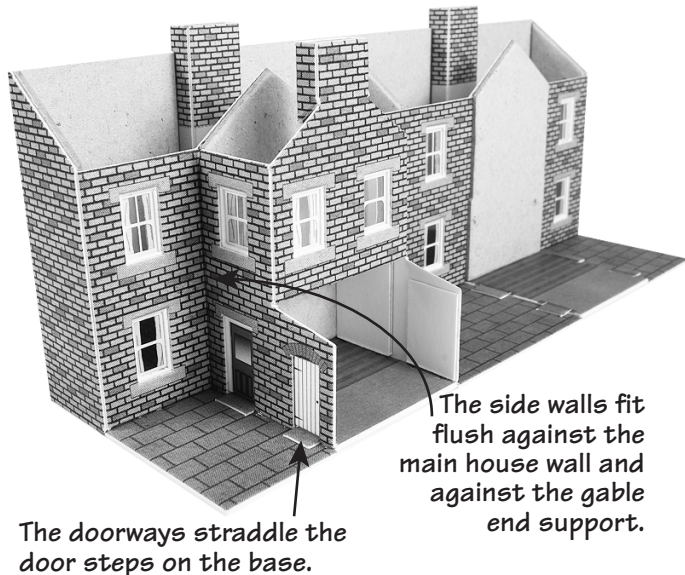
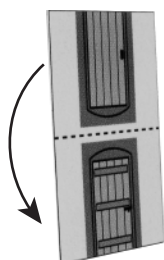

Fig. 15. GATES

On sheet C there are a selection of yard gates, simply cut out your colour choice, gently score and fold along the dotted line and glue.

You will need four gates in total.



INSTRUCTION SHEET 3

Fig. 15. GATES cont.

Once you have all your gates you will need the main yard wall section.

Align the gates in the gateways and glue into place, then fold the inner gateway wall over to 'sandwich' the gate in place.

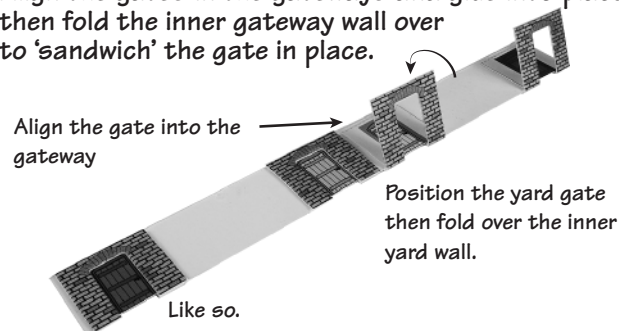

Then add the wall to the main model. The wall fits snugly into place with the inner yard gateways fitting flush to the shed walls

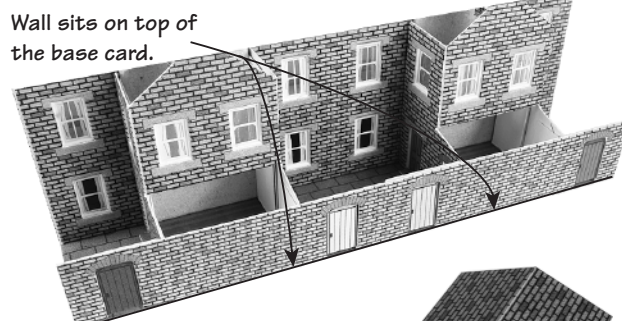

Next fold in two the three yard end walls and glue.

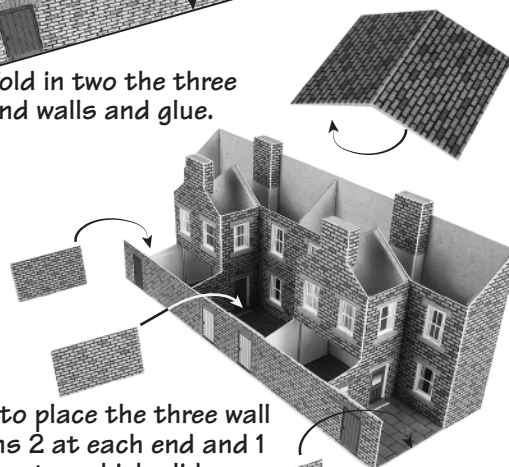

Glue into place the three wall sections 2 at each end and 1 in the centre, which slides neatly into the slot between the inner yard wall sections.

Fig. 16. ROOF SECTIONS

First attach the shed roofs. These simply slot into place, overhanging slightly the outer yard wall.

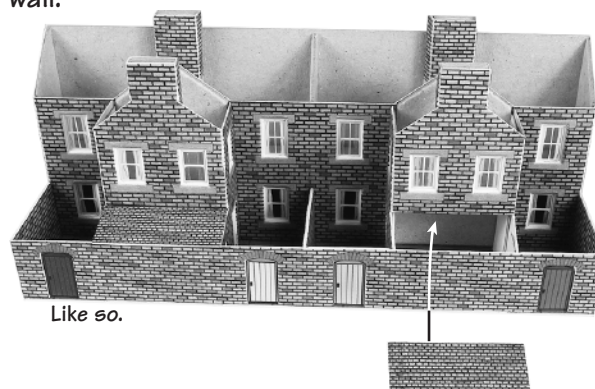
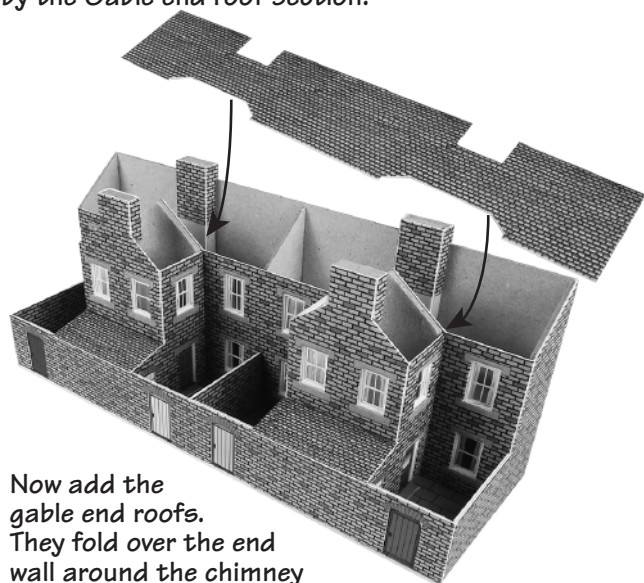

Fig. 16. ROOF SECTIONS cont.

Next, the main roof, this fits around the main chimneys and the gable end support, there will be a gap behind the gable end support - don't worry this will be covered by the Gable end roof section.



Now add the gable end roofs. They fold over the end wall around the chimney and fit flush to the main roof.

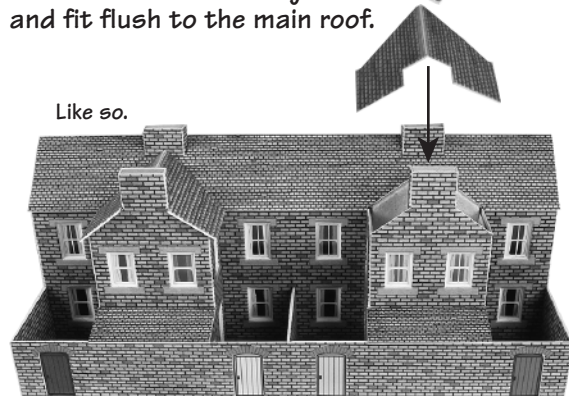
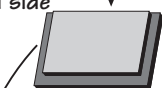

Fig. 17. CHIMNEY TOP STONES

Keep the chimney top stones separate as the gable end and the main house top stones are easily mixed up.

flush along
1 side



even space around
the other 3 sides

The main house chimney top stones first, align the smaller stone flush to the long edge of the base stone.



even space around
the all 4 sides.

The gable end chimney stones are very similar but this time the small top stone is centred on top of the larger stone.

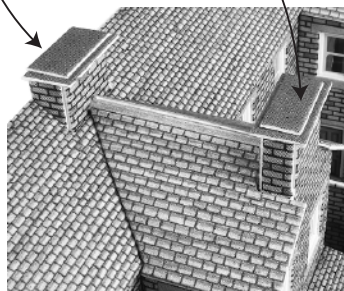

Then apply the top stones to the chimney stacks. Keep the flush edge of the main house chimney flush to the back of the building.

Fig. 18. CHIMNEY POTS

Cut into strips the chimney pots on sheet c, then roll tightly around a nail or screw (apx. 2mm dia.) and fix the end with a tiny spot of glue.

Curl strip
slightly
first.

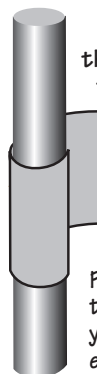

Roll up tight
then unroll
the end enough
to smear with
a little glue
then roll
back up
and hold
tight until
fast.

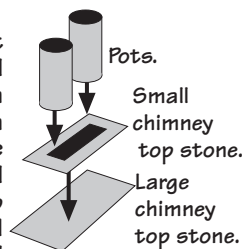

PLEASE NOTE - once you have perfected the art of rolling your own chimney pots you will soon realise that they are extremely realistic. So please be patient & keep trying, the chimney pots make all the difference.

Fig. 19. WALL CAPPING STONES

Gather the wall capping stone strips and trim to size to top off the yard walls, (there are extra lengths if you get it wrong) and glue into place along the wall tops.

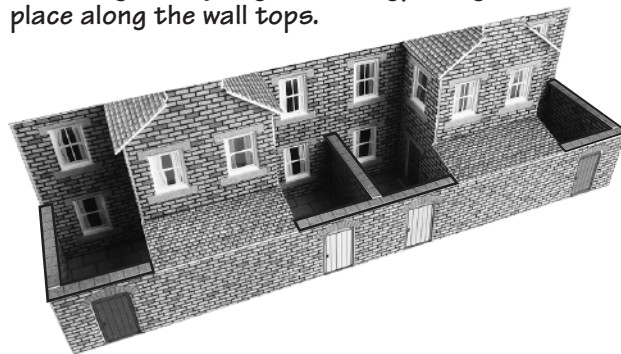

Fig. 20. RIDGE TILES

Finally from the ridge tile sheet cut out lengths of the colour you'd like and use them to finish off the roof by covering the folds on the roof sections.

