

1 Kit components.

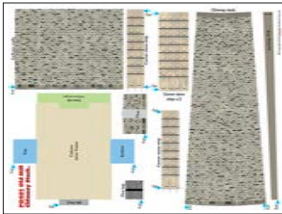

Printed sheet.

All the printed components to make this kit.

Small plain laser cut card.

Fine laser cut components.

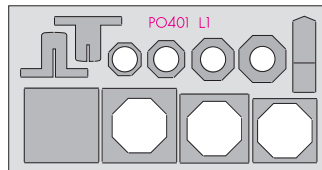

INSTRUCTION LEAFLET *This one*

2 Tools to build this kit.

- A modellers knife.
- A steel ruler. Glue - See glues.
- Ultra Fine Tip Glue Applicator, See below.
- A cutting surface. Fine point tweezers.
- Watercolour paints and fine brush.
- To paint corners and edges.

3 Glue.

Speed Bond is the best glue for this job. It dries fast, but allows time for repositioning where needed. Also **Roket Card Glue**. This is an impact adhesive. Use with a fine brush and only where you are confident that components are in place. This glue comes with its own fine tip applicator. Both glues available from metcalfe.com



4 Ultra Fine Tip Glue Applicators.

An absolute 'must' with this kit. When used with **Speed Bond** perfect amounts of glue can be applied to very precise areas without any mess.



A METCALFE product supplied in packs of 3
Product code MT907. Glue not included.

READ THROUGH ALL THE INSTRUCTIONS BEFORE YOU START.

5 Extracting components.

Components are held in place on the sheet by score lines that cut partway through the card marked with blue arrows. To release, fold the card to expose the score, then carefully run the point of your knife along score line so the parts come seamlessly away.

6 The Base Column.

Start with the inner frame.

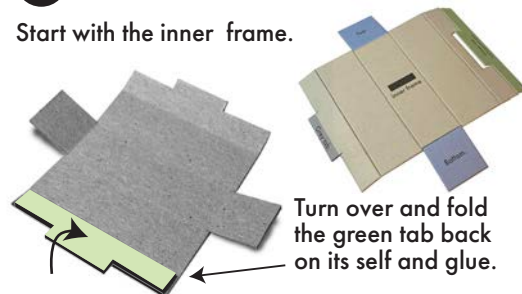

Now fold the four sides around and insert the tab into the slot.

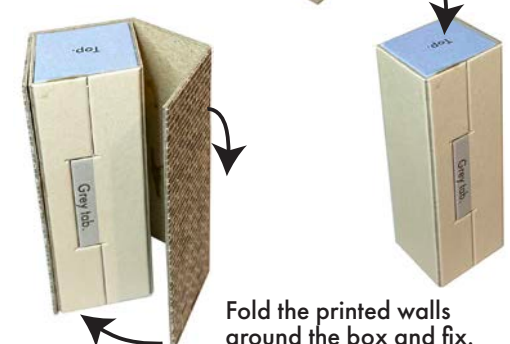
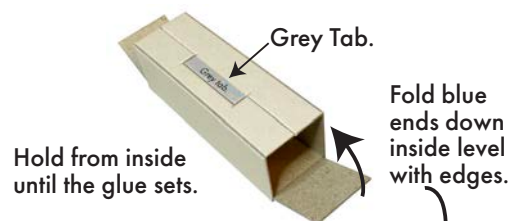

7 The Corner Stones.

Fold the four corner stone strips along the centre score line and fit to each corner.

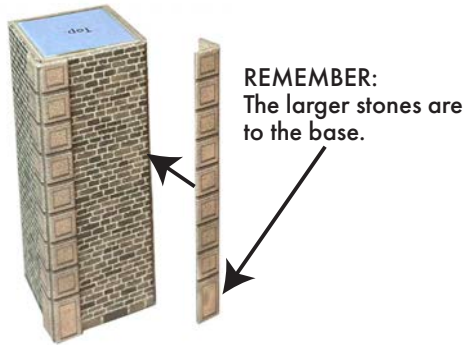

8 The Chimney Stack.

This is the difficult bit, so pay attention!

There are 8 score lines that run the length of the stack. Loosen them all up by folding each one fully back (maybe a couple of times).

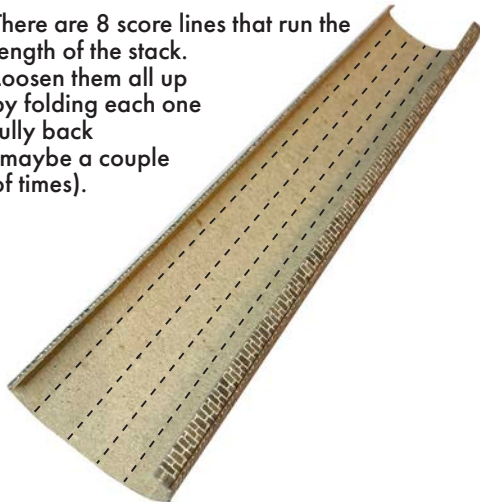

Open back out and fold the end section up at a right angle.

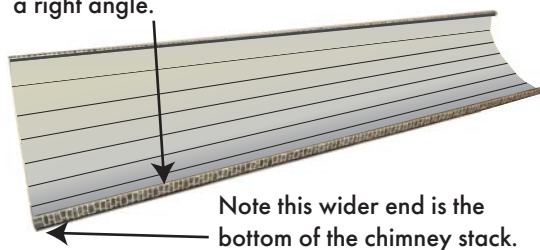

2

Fix the jointing strip to back of the end section you are holding upwards. Push down tight to the score line.

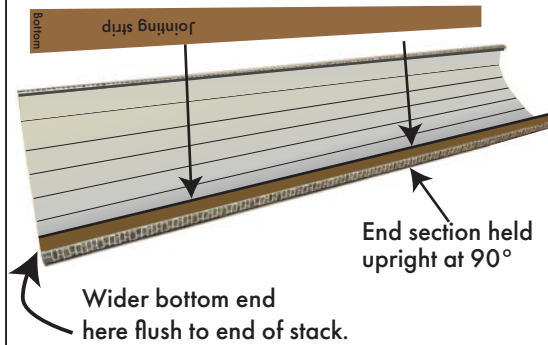

Keep holding and pressing the cards at 90° for a while.

Then fold the third score over and hold the whole section down flat till glue has set.

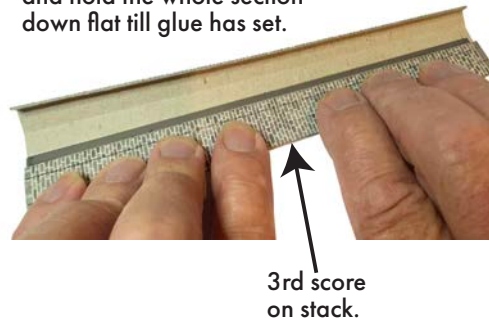

Now fold the other half of the stack over so the ends meet butt ended together.



Now you see how it fits, lift back up and glue the other section of the joiner strip. Place the stack back down butt ended against the other side. Hold down flat and keep pressing down till glue is fully set. Make sure edges are butted tight against each other at all times.

Open out to form a rough octagon shape.

9 The Chimney Stack Base.

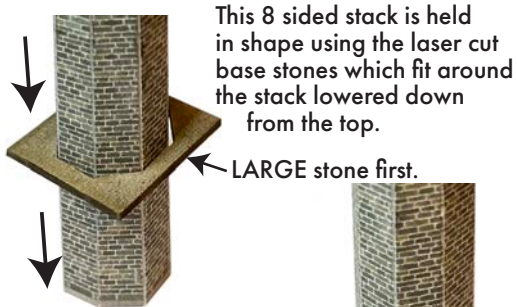
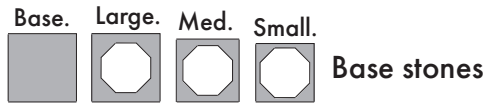

Slide carefully down from the top making sure it fits to the octagonal shape. All edges flush to the base.

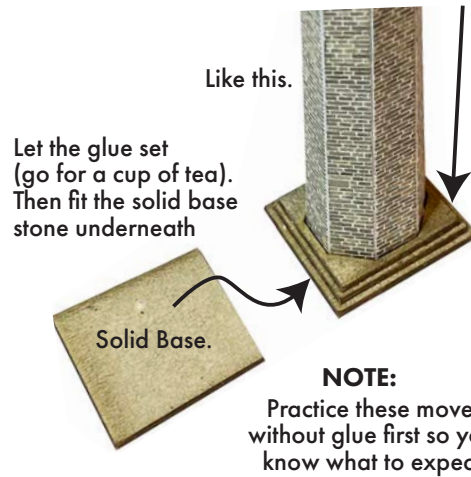
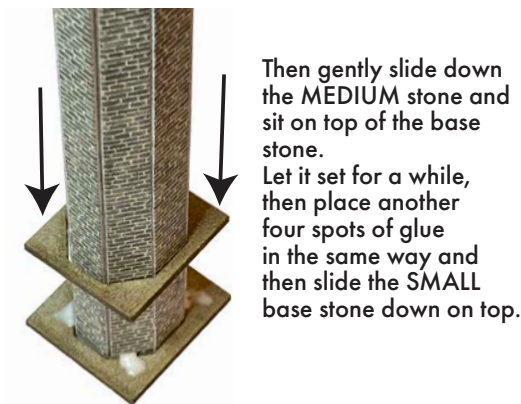

10 Chimney Top Stones.

The chimney is topped off with the four small top stones shown here plus the jig for correctly positioning them on top of each other.

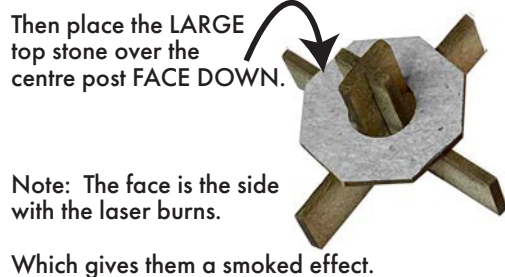
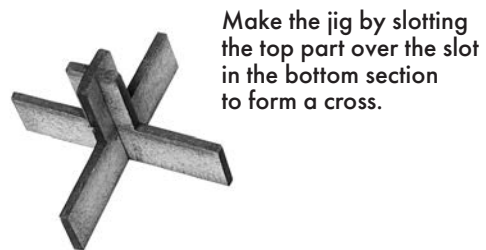

Place tiny spots of glue close to the centre hole.



Place the TINY top stone over the post onto the large top stone.

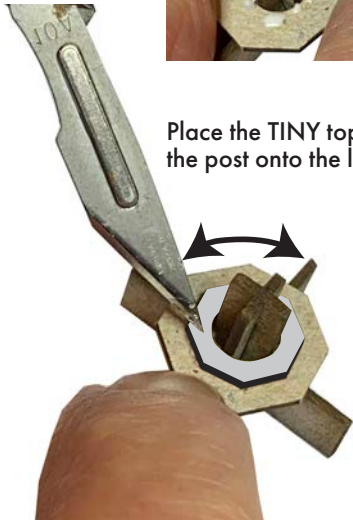

Before the glue sets rotate the stone with the point of your knife so that the flat sides line up.

TURN THE STONE OVER and slot back on to the jig

More spots of glue as shown then fit the MEDIUM stone on top.



Followed by the SMALL top stone.



Remember, Smoked side up!

At each stage rotate the stones to line them up with the stones below.

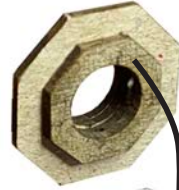

The finished top stone now slots down inside the top of the stack with the tiny top stone lined up with the eight wall sides to hold them in place.

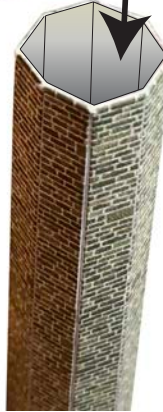

Fix the chimney stack on to the top of the column.

Now for the tiny flue.

Quite a lot of mill chimneys stood alone with the flue running underground. However if you want to attach it to a building there is a small flue.



Fix back wall of flue to column.

Base fits flat inside with walls fixed either side.



Flue top.

End.

Laser cut flue parts.

