

PO287 00 Scale Old Factory

INSTRUCTIONS

PLEASE

Read through the instructions and familiarise yourself with the kit components before you start any building.

CHECKLIST.

- 1 x SHEET A Printed components
- 1 x SHEET B Printed components.
- 1 x SHEET C Printed components.
- 1 x SHEET D Grey plain card components.
- 1 x SHEET E Grey plain card components.
- 1 x GLAZING SHEET.
- 1 x INSTRUCTION BOOKLET (this one).

Kit components.



SHEET A.
Printed components to make the main entrance building.

SHEET B.
Printed components to make the main factory.

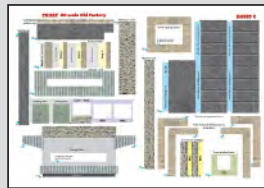
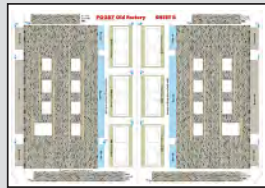

SHEET C.
Printed roof components and canopy .

GREY SHEET D.
Thick plain card pieces to fit inside the buildings.

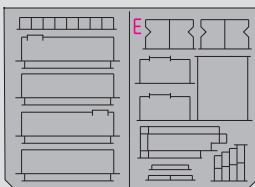
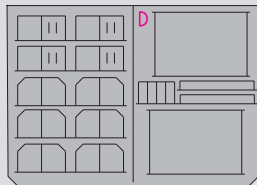

GREY SHEET E.
Thick plain card pieces to fit inside the buildings.

GLAZING SHEET.
Clear plastic glazing to fit behind the window frame openings.

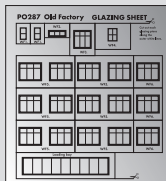

INSTRUCTION BOOKLET (this one).

1 Tools to build this kit.

To build this kit you will need a few basic tools:

1. A modellers knife.
2. A cutting surface - A cutting mat or thick card will do.
3. A sharp pair of scissors
4. A steel ruler.
5. Fine point tweezers.
6. Something to clamp surfaces together, Bulldog clips are good for this job.
6. METCALFE Ultra Fine Tip Glue Bottles (see 3)

2 Glue.

We recommend using a combination of glue: **Speed Bond** is slightly slow drying, ideal for where a little positioning is required as you build.



Made by Deluxe Materials - deluxematerials.com

Also UHU All Purpose solvent free.

This is the best glue for fixing the plastic glazing to the window frames.



3 Ultra Fine Tip Glue Applicators.

An absolute 'must' when building this kit. When used with **Speed Bond** or **UHU** perfect amounts of glue can be applied to very precise areas without any mess.

Speed Bond in an applicator was used to build most of this kit.
UHU for fixing the glazing.



A METCALFE product supplied in packs of 3
Product code MT907 Glue not included

4 Extracting components from base sheets.

To stop the components falling off the base sheets, they are held secure with score lines (marked with blue arrows) that cut about 75% of the way through the card. To release them run the point of your knife along these score lines and they will come seamlessly away. **WARNING**, Cut with care to reduce the risk of the blade running out of the score and cutting the component.

5 Plain Grey Sheet D.

Key to components.

- G1. Inner side wall supports (lower) x 4
- G2. Inner side wall supports (upper) x 6
- G3. Inner lower floor supports (front) x 2
- G4. Inner lower floor supports (side) x 4
- G5. Back wall for main factory building x 2

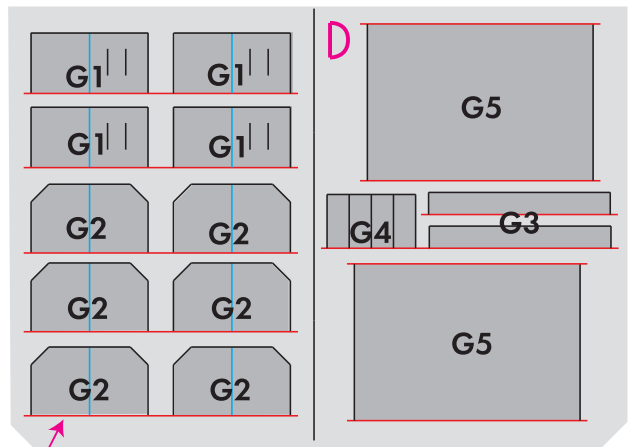

RED lines indicate score rules you need to cut to release components from base sheet.
BLUE lines are fold lines - Don't cut.

Plain Grey Sheet E.

Key to components.

- G6. Inner side wall supports (lower). x 2
- G7. Inner floors for building A. x 2
- G8. Back wall for Building A.
- G9. Lower floors for factory building.
- G10. Upper floors for factory building.
- G11. Platform inner frame.
- G12. Platform steps.
- G13. Front wall inner supports x 8.

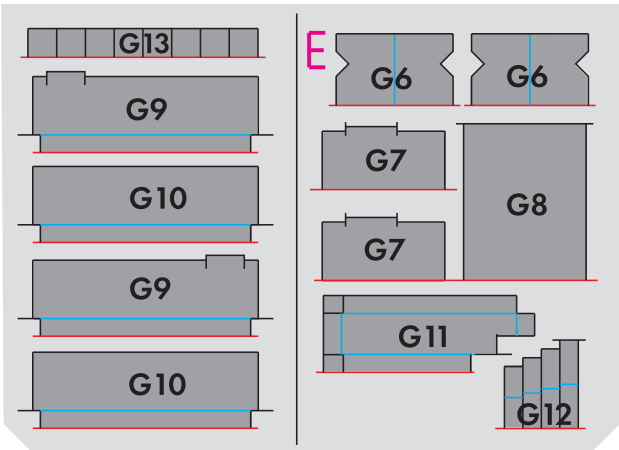

6 The Windows.

Each window opening has a corresponding window frame, so at each stage of the build it is best to get the glazing pieces attached to the backs of each window frame.

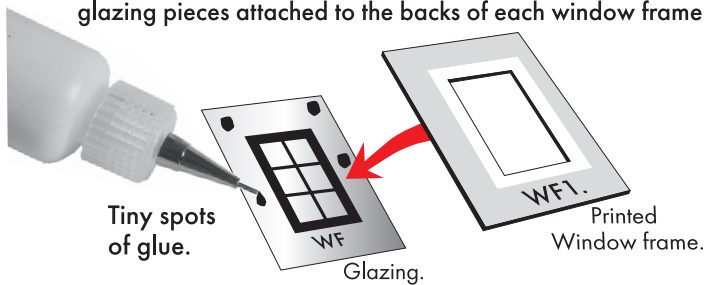

Using a fine tip applicator, place tiny spot of **UHU** glue on the edges of the glazing and then fix the window frame on top.

7 The Builder's Yard.

As you are guided to extract components at each stage, place them neatly on a separate piece of card or a tray (we call it the builder's yard) where they can be kept safe until needed.



START BUILDING

8 Entrance Building.

Sections 'A' and 'B'.

Extract the following components:

- From **SHEET 'A'**: ALL COMPONENTS
- From **SHEET 'C'**: Steps 1, 2, 3 and 4.
Tower capping stones.
Window frame **WF4**.
Entrance building roof.
2 x **IW1**. wall strips.

Cut out glazings **WF1**, 2, 3 and 4 from glazing sheet.

- From Grey Sheet '**D**' extract **G2** x 2,
- and Sheet '**E**' extract **G6** x 2,
- G7** x 2 **G13** x 8 **G8**

9 Entrance Building A.

First, attach the glazings to the back of the window frames.

Then fold the two blue tabs over on the wall tops of building 'A' and glue down. Then fold back the three brown tabs and glue.

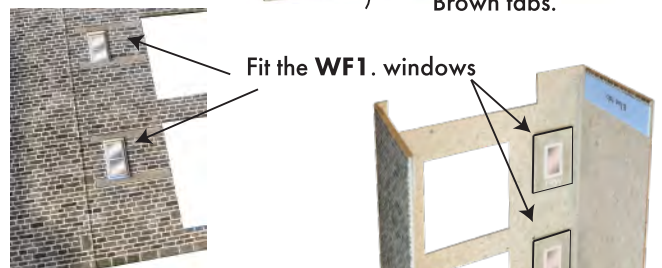
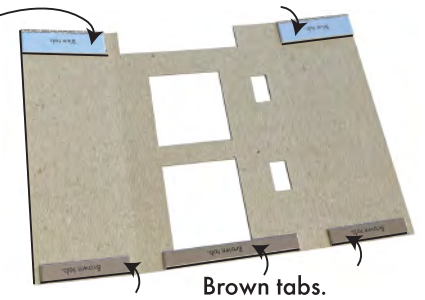

Then fit the lower floor **G7**.

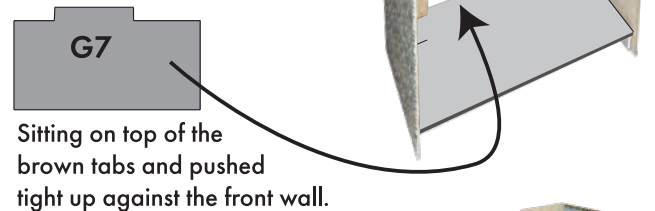

Sitting on top of the brown tabs and pushed tight up against the front wall.

Fold the two **G6**. cards in half and glue.

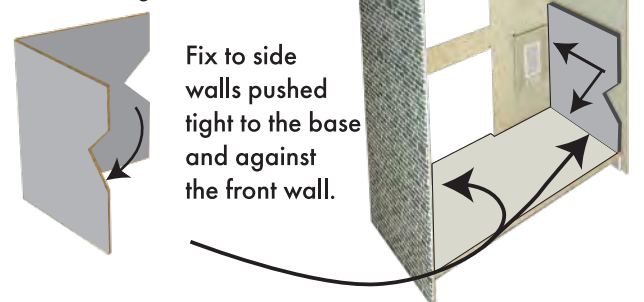

Fix to side walls pushed tight to the base and against the front wall.

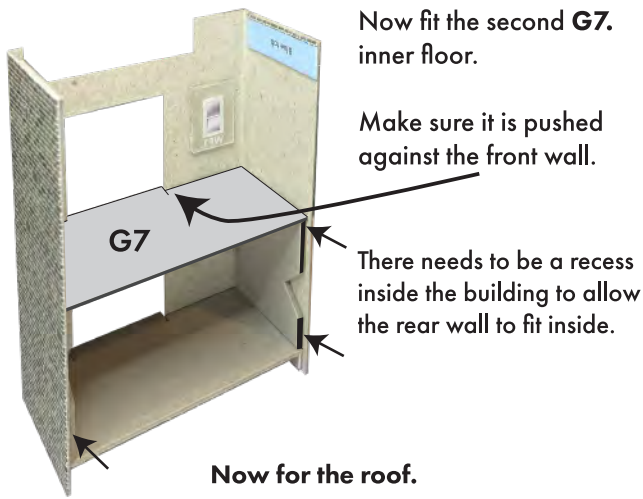

Now fit the second **G7**. inner floor.

Make sure it is pushed against the front wall.

There needs to be a recess inside the building to allow the rear wall to fit inside.

Now for the roof.

Fold the blue tab over and glue to the underside.

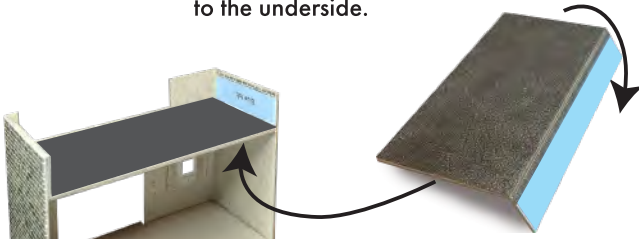

Fix up underneath attached to the edges of the blue tabs.

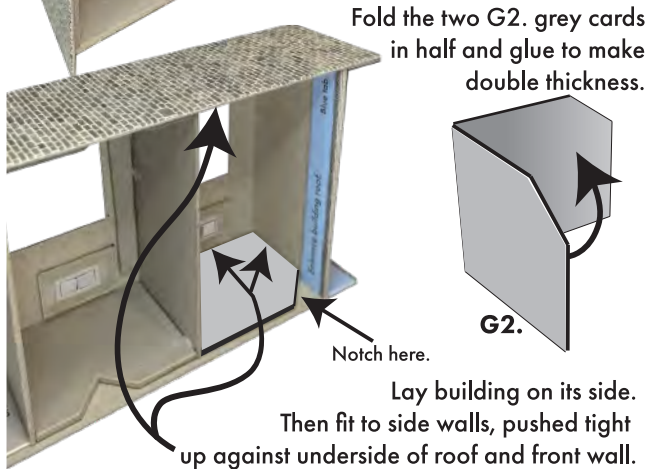

Fold the two **G2**. grey cards in half and glue to make double thickness.

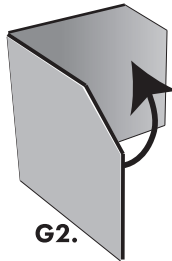

Notch here.

Lay building on its side. Then fit to side walls, pushed tight up against underside of roof and front wall.

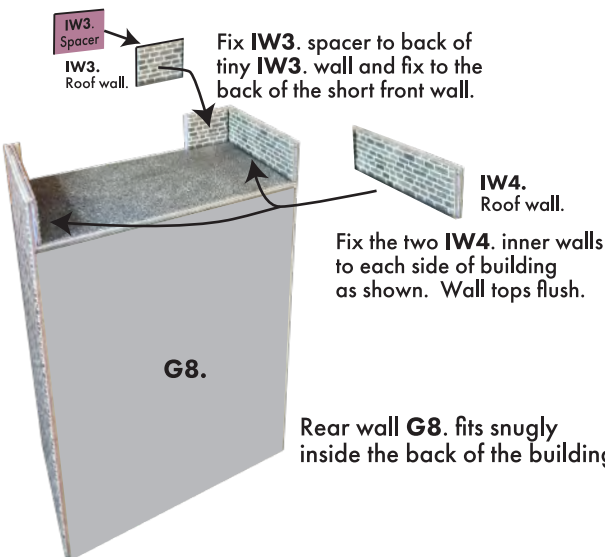

IW3. Spacer
IW3. Roof wall.

Fix **IW3**. spacer to back of tiny **IW3**. wall and fix to the back of the short front wall.

IW4. Roof wall.

Fix the two **IW4**. inner walls to each side of building as shown. Wall tops flush.

G8.

Rear wall **G8**. fits snugly inside the back of the building

10 Entrance Building B.

Lets start with the door **WF2**. & Window **WF3**. Which have tapered stone surrounds in front of them.

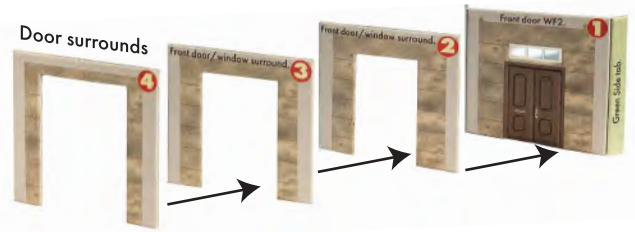

Fix surround **4** on top of **3** and then **2**. Keep ALL outer edges flush then fit one set to the door **WF2**. and one set to window **WF3**.



Fold the green tabs back as you fit the door surround. Keep edges flush, then fold green tabs back out.

Now for the main body of Building 'B'

Locate the six score lines and fold back to loosen up.

Then fold the two **PURPLE** tabs over and glue back.

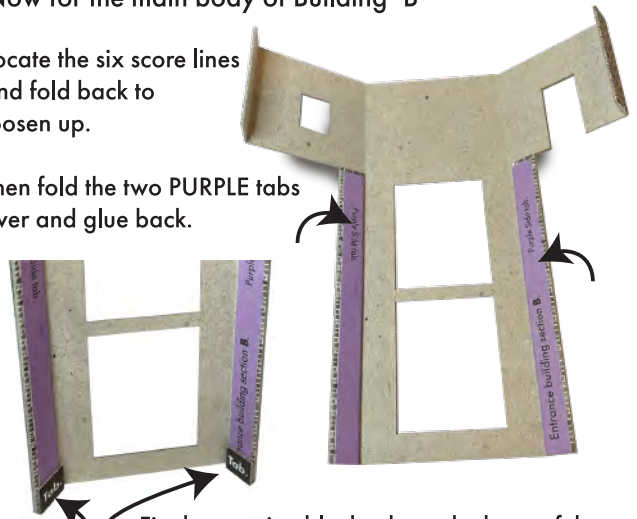

Fix the two tiny black tabs to the base of the purple tabs. Stand on flat surface so they sit flush to the bottom.

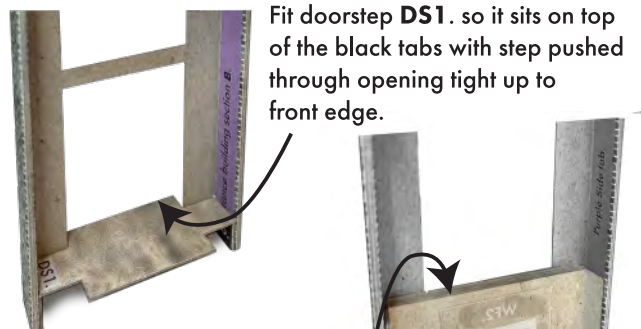

Fit doorstep **DS1**. so it sits on top of the black tabs with step pushed through opening tight up to front edge.

Fit the door section sitting on top of the door step. Push down tight. See next page for picture of other side

Don't glue the green tabs to anything, they are just there to support the floor above.



Green tabs.



Fit the other **DS1**. floor sitting on top of the door below.

Fit the upper window **WF3**.

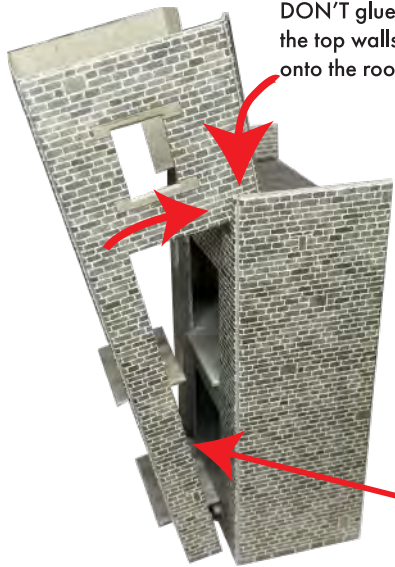

DON'T glue the top walls onto the roof.

The door section now slots into the main building 'A' with the two **DS1**. tabs sitting on top of the inner floors. Just glue the vertical walls and the door tabs.

Test a few times without glue first so you can see how it fits.

Fix the tower back wall inside the building tight into the corners.

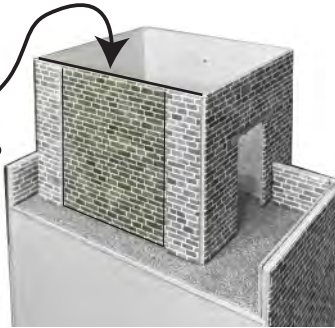

Tower door fits to the back of door frame then

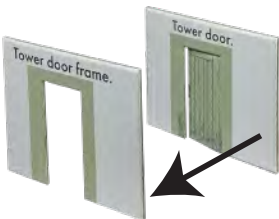

Fix to back of door opening.

Also fit window **WF4**.

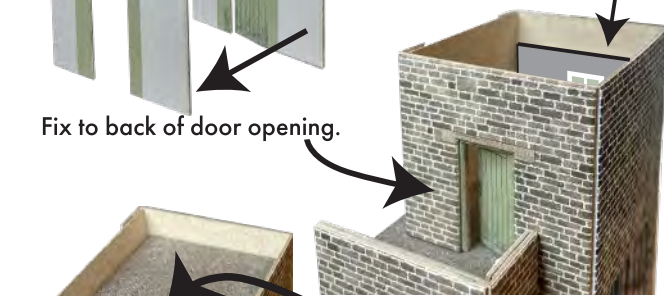

Sit the tower roof down inside the building sitting on top of the window and door. **NO NEED TO GLUE.**

The inner roof walls **IW1**. & **IW2**. fold in half longways to make double thickness.

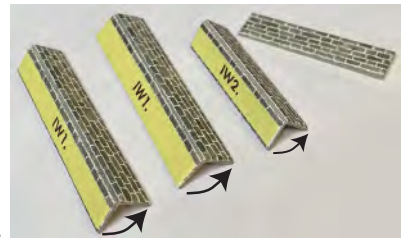

Fit the two long walls into the tower top first.

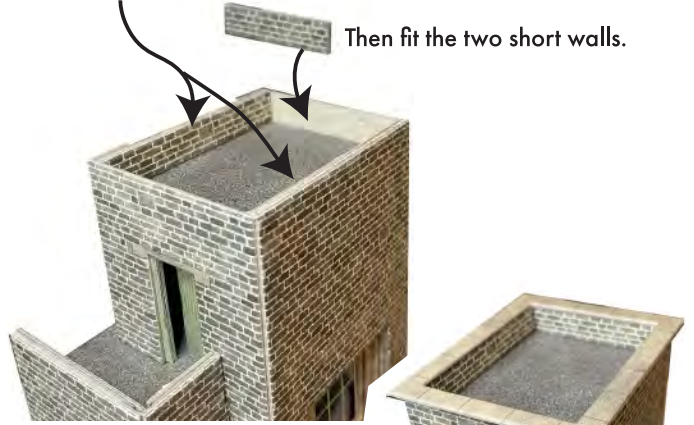

Then fit the two short walls.

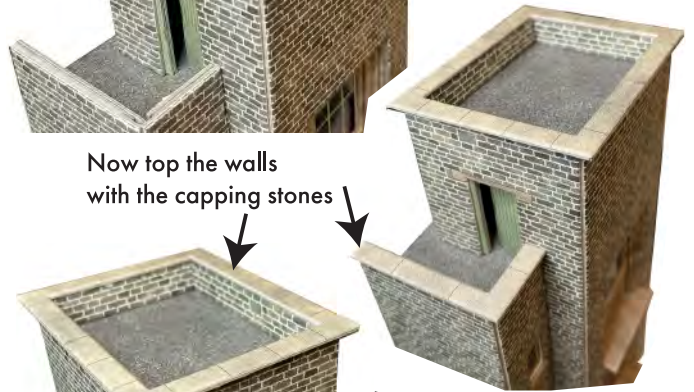

Now top the walls with the capping stones

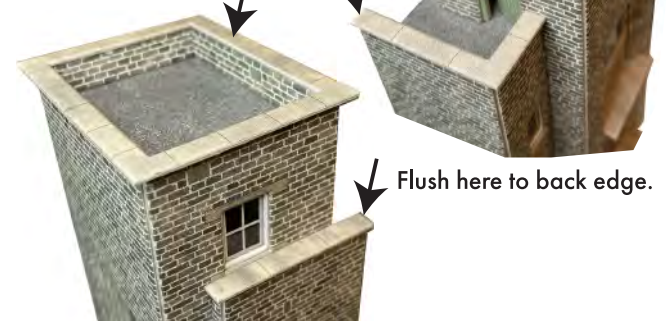

The Steps.

Steps 1, 2, 3 and 4 all fold in half along the score lines and glue back to back.

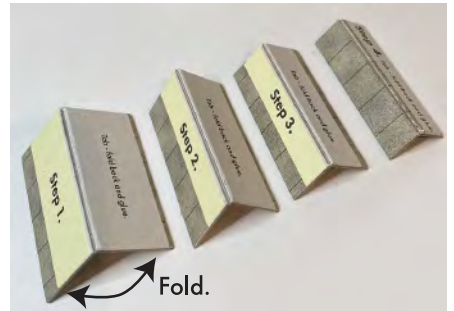

Fold.

Then fix them together to form the steps. One on top of the other. Back edge and sides flush.

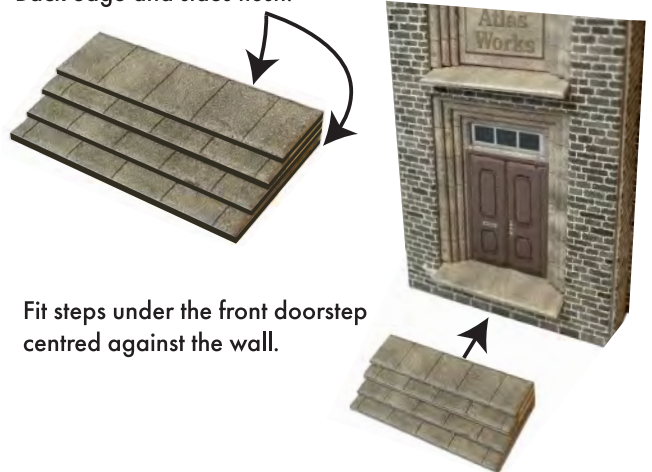

Fit steps under the front doorstep centred against the wall.

Front Walls FW1.

Each wall makes up in the same way.

Glue four **G13** spacers together to form a solid block.

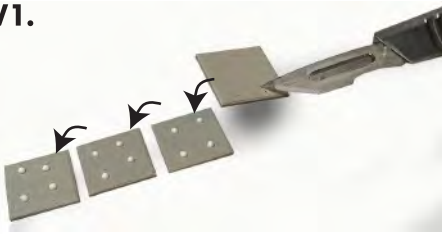

Wrap wall **FW1** around.



Then fix walls to either side of the steps.



Top off with the small capping stones.

11 Factory Buildings C. & D.

There are two factory buildings; 'C' & 'D' they both fit together in exactly the same way. They can be used as low relief buildings or fixed back to back to make a stand alone building.

Extract the following components:

- From **SHEET 'B'**: ALL COMPONENTS
- From **SHEET 'C'**: 2 x Roof sections.
- 2 x Loading doors.
- 3 x **WF6**. Window frames.
- 4 x Capping stone strips.

Then from the grey card 'E' extract :-

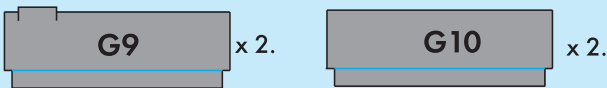

Note there are right and left hand versions of this floor.

And extract ALL the remaining components from grey card 'D'.

Start by fitting all the glazings - **WF5** & **WF6**. to their corresponding window frames.

Then fold the four **G1**. and four **G2**. grey cards in half and glue back to back.

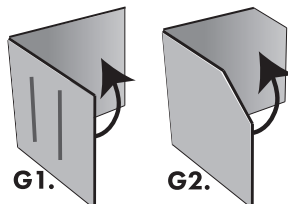

A few other little glue jobs to get out of the way before you start to build

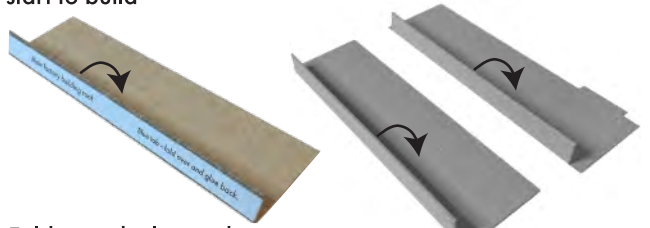

Fold over the long tabs on the two roofs and the grey inner floors **G9** & **G10**. and glue down. This makes them a little more rigid.

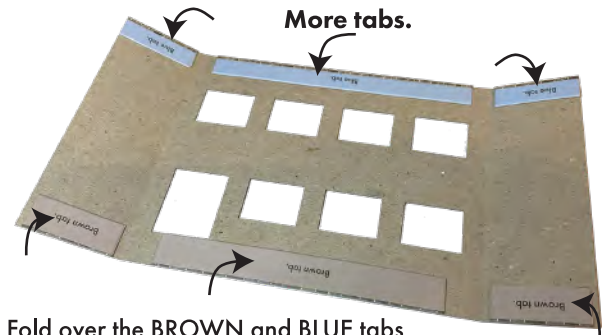

Fold over the **BROWN** and **BLUE** tabs on the top and bottom edges of the factory walls.

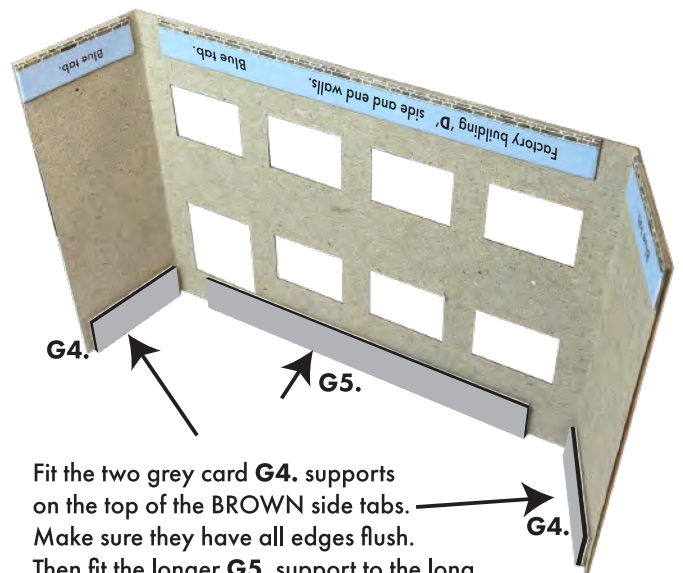

Fit the two grey card **G4**. supports on the top of the **BROWN** side tabs. Make sure they have all edges flush. Then fit the longer **G5**. support to the long front **BROWN** tab.

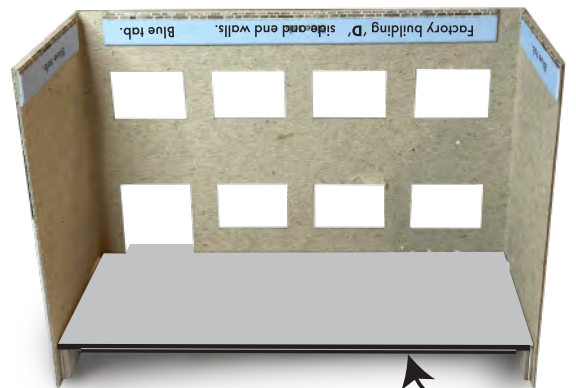

Fit lower inner floor **G9**. into the building with the door step fitted through the opening. All should be fixed tightly down on to the brown tabs underneath.

Now fit the windows into the back of the openings.
3 x WF5.

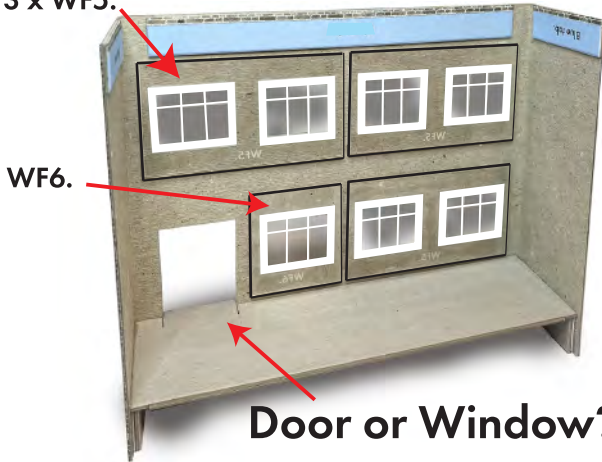

Each building has a doorway. If you don't want to use both, you can use the alternative window FW6. to fill in one of them.

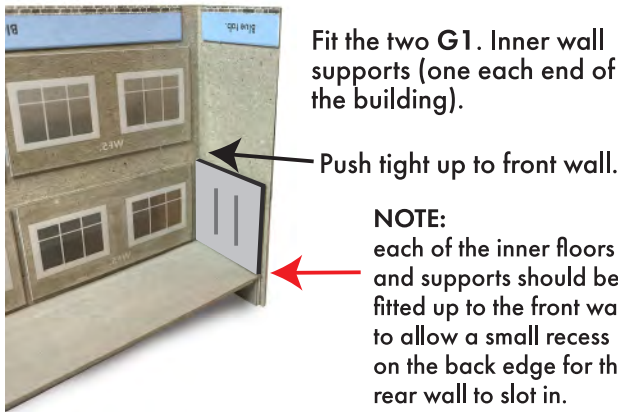

Fit G10. Inner Floor

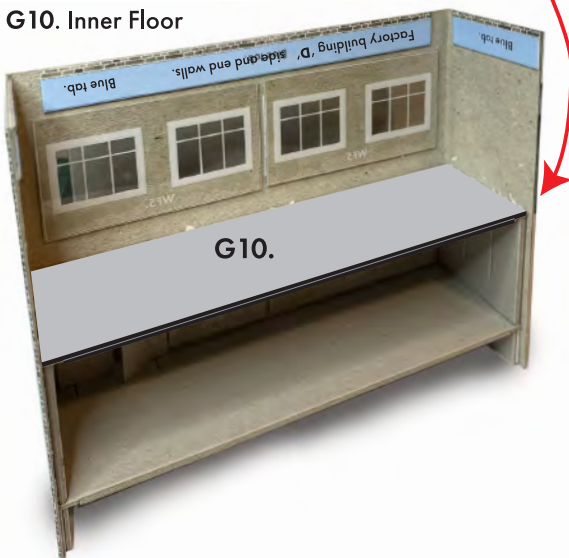

Fit the roof.

This fits up against the bottom edges of the blue tabs.



Next fit the inner supports G2.

Cut away corner to this edge.

Fit up against the underside of the roof and pushed forwards against the front wall.

Fit both ends.

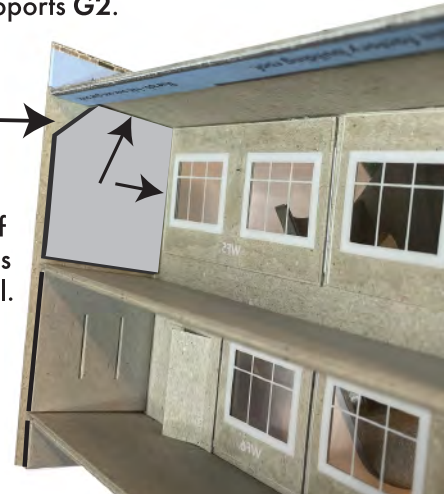

IW5.

Fit inner walls .
Fit IW6. long wall first



Fit the capping stones, but not until you have decided how you are joining buildings together. They may need trimming to fit. See page 8.

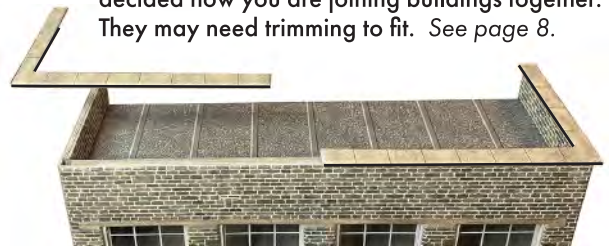

Make up the other factory building in just the same way.

12 The Canopy.

Fold all score lines to loosen them up.

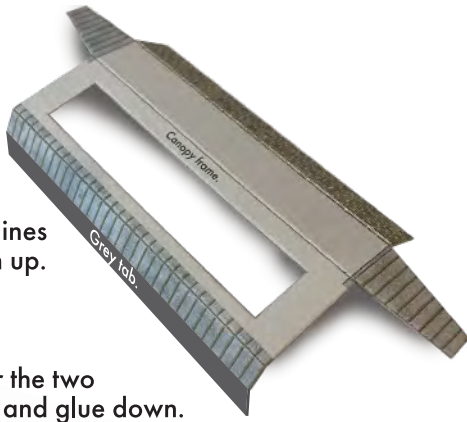

Then fold over the two long end tabs and glue down.

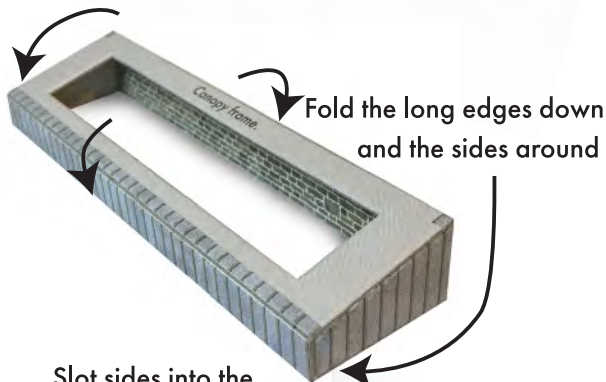

Slot sides into the recess on the corner and fix.

Fix back edge of canopy to the front wall using the upper window sills as a guide to keep level

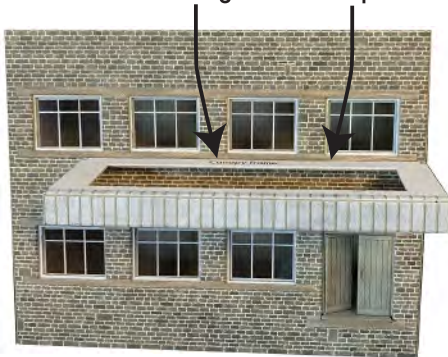

Attach the glazing to the back of the canopy roof. Then fix to the top of the canopy.

13 The Platform.

G11. Platform inner frame

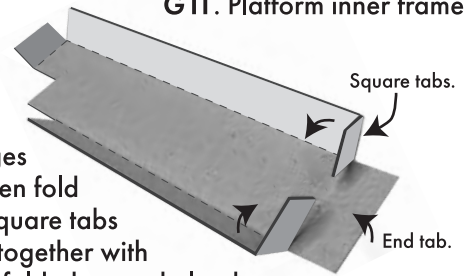

Fold all edges to loosen then fold in the two square tabs butt ended together with the end tab folded up and glued to them. Hold with all edges squared till set.

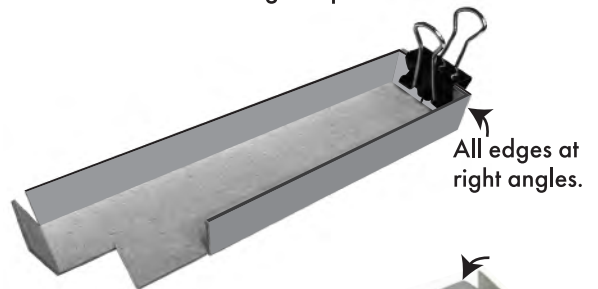

Turn over and wrap the platform wall around the inner frame.

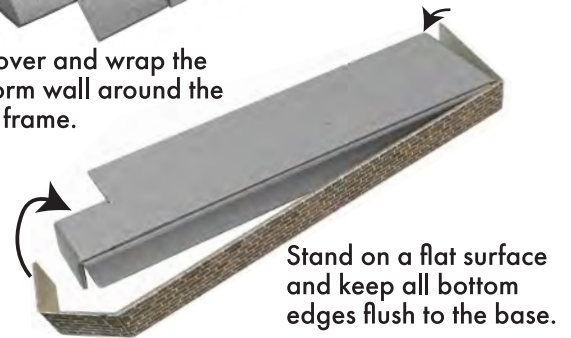

The steps are made up from the four grey card G12. steps. These fold in half and are glued together to form stairs as shown here.



Fix to platform like this.

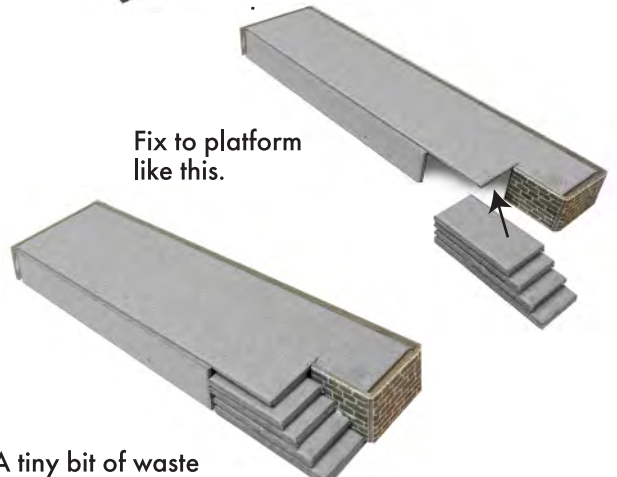

A tiny bit of waste grey card needs to be tucked into the gap on the top step.

Fix the platform to the front of the building.



Once fast, fit the platform top.



Like this.

The various ways you can piece together the factory to suit your needs.



Our builder sheets pack M0059 Old Mill Stone matches with the stone on this kit for customisation work



Cover the roof joint with the roof joiner and wall joins with long wall joiners

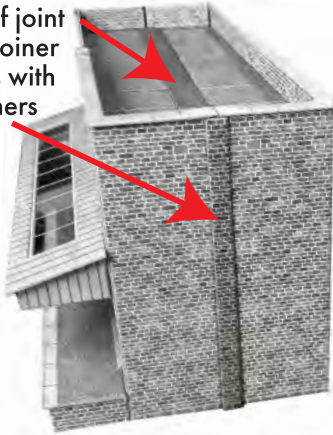

To make it look right, you may want to overlap the back of the entrance building a little. Cover over exposed grey card with a strip of jointing card.

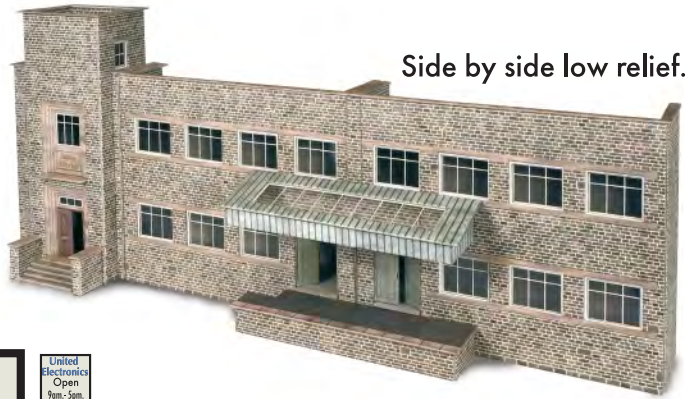

Side by side low relief.

Lots of Bargains
Don't Miss Out

United Electronics

United Electronics Open From 9pm Mon-Fri.

Layon Carpets Since 1923

SIGNS TO CUT OUT AND USE.

The Raving Herald & Pioneer Printing works

CARDLYWICK BREWERY Est. 1909 Bottling & Distribution

ALUCARD MEDICAL Blood Bank & Testing Laboratory

Laycock Hydraulic Systems Co Ltd

Bill's DISCOUNT WAREHOUSE Everything HALF PRICE

Fatima's Fashions Designers & Dressmakers

TATTERSALL & Co (CENTRAL) LTD

Cardlywick Affiliated Dairies

WEAVERS of FINE WOOLLEN CLOTH

HOOVACK Electrical Appliances

Concept & Innovation Centre