

PO323 Modern Day Platform Shelter INSTRUCTIONS

PLEASE

Read through the instructions and familiarise yourself with the kit components before you start building.

CHECK LIST

This kit should contain the following:

- 1 x SHEET A Main frame and stone walls.
- 1 x SHEET B Roof and brick walls.
- 1 x SHEET C Internal walls and windows.
- 1 x GLAZING SHEET.
- 1 x INSTRUCTION BOOKLET.

To construct this kit you will need the following:

1. A modellers knife.
2. A pair of sharp scissors.
3. A steel ruler.
4. Glue - See glues.
5. Ultra Fine Tip Glue Applicator, see below.
6. A cutting surface - a sheet of card or cutting mat will do.
7. Fine point tweezers.
8. Watercolour paints and fine brush.
9. Bulldog clips or clothes pegs are good for clamping whilst glue sets.

Glue.

We recommend using a combination of glue:

UHU All Purpose solvent free.

This is the best glue for fixing the plastic glazing to the window frames located on sheet C.

Speed Bond is good for gluing card to card it is slightly slow drying, ideal for where a little positioning is required as you build.

Both glues work well in our Ultra Fine Tip Glue Applicators.



Ultra Fine Tip Glue Applicators.

An absolute 'must' when building this kit. When used with **Speed Bond** or **UHU** perfect amounts of glue can be applied to very precise areas without any mess.

Speed Bond in an applicator was used to build most of this kit. **UHU** for fixing the glazing.



A **METCALFE** product supplied in packs of 3
Product code **MT907**
Glue not included

Painting Corners and Edges.

Things like the ridge tiles and the corners of the brick walls are the only things that need any touching up in this kit. Simple water colour paints like these here are good.

When mixing colours water down a lot and only apply a small amount of paint at first. Too much can spoil the effect. Always test on waste card first.



GETTING STARTED

First to do is push out all the window opening in-fills from sheets A & C.

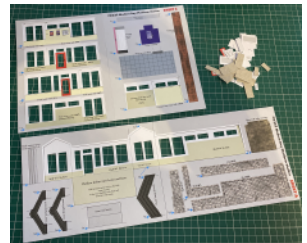

Then extract all the components from the base sheets

Extracting the components from the base sheets.

To stop the components from falling off the printed sheet, they are held secure with score lines (marked with blue arrows) that cut about 75% of the way through the card. To release them run the point of your knife along these scores and they will come seamlessly away.

As you extract the components from the base sheets they need to be kept away from your working area.

Glazing sheet.

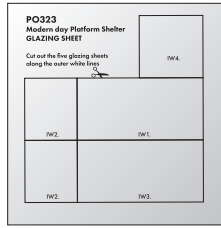

Cut out the five pieces of glazing as indicated. There are no printed window frames on this kit. Each glazing is simply sandwiched between matching inner walls, which act as the window frames.

1 The Main Frame & Base.

Stand the walls up at a right angle to the floor.

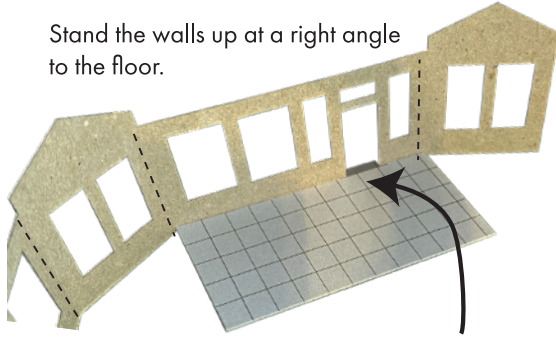

Fix the printed waiting room floor on top of the main floor, all edges flush and the door step fitting through the doorway.

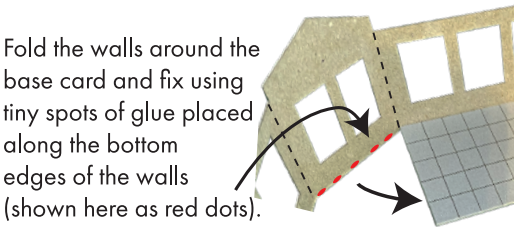

Make sure the floor is pushed firmly down inside against your work surface on all edges.

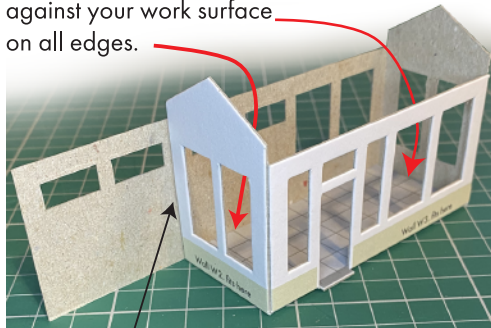

Don't glue wall to wall here.

Place to one side and go on to the Inner Walls.

2 Inner walls.

Each inner wall is made from two sections (inner and outward facing) fixed back to back with a sheet of glazing sandwiched in between.

Lets start with the front wall.

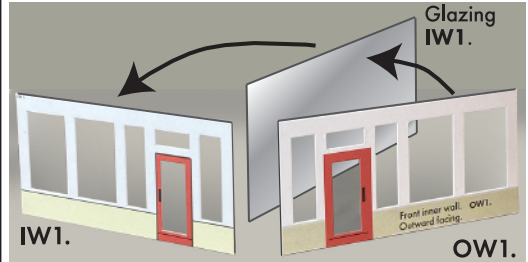

Fix glazing **IW1.** to the back of inner wall **IW1.** Use only tiny spots of glue to fix to avoid bleeding past the frame edges. Next fit outward facing wall **OW1.** so the two printed walls are back to back.

MAKE SURE ALL EDGES ARE FLUSH.

Fit the inner window unit inside the building

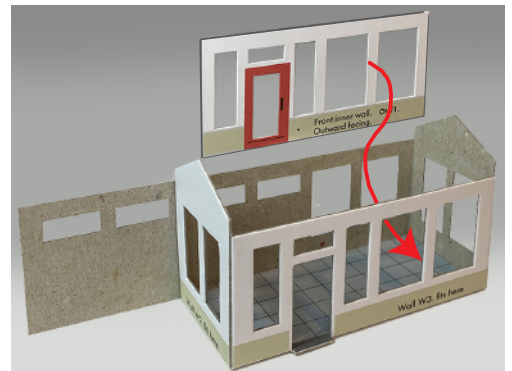

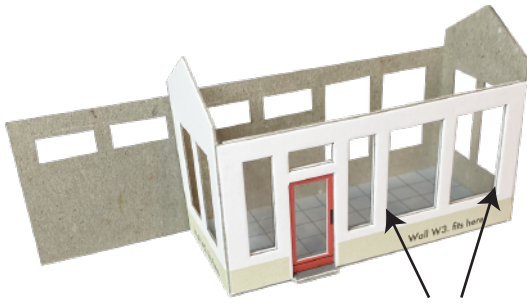

The window frames should all line up with the openings in the front wall. Test without glue first so you can see how it fits.

Now continue and make up the three other inner window frame units that fit inside the building. End walls **IW2/OW2**. x 2 and the rear wall **IW3/OW3**.

Each with their glazing sandwiched in between

Test without glue before you fit. It is important that the inner rear wall stands level with the outer wall top.

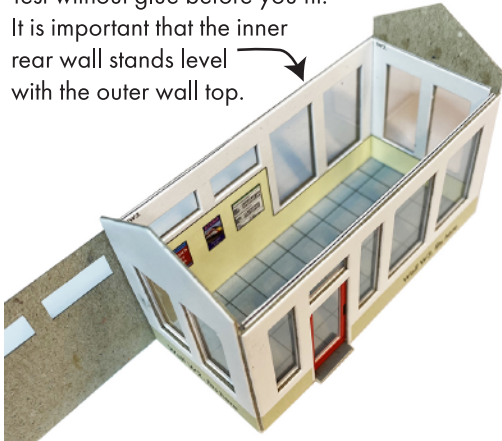

If it stands higher, this is probably because the floor isn't sitting flat to the base, so simply trim a tiny bit off the bottom of the wall to get the frames to fit. Same with all other inner walls.

3 Canopy Section.

Back wall first.

Fix **RW4**. back to back with **OW4**. with glazing sandwiched in between.

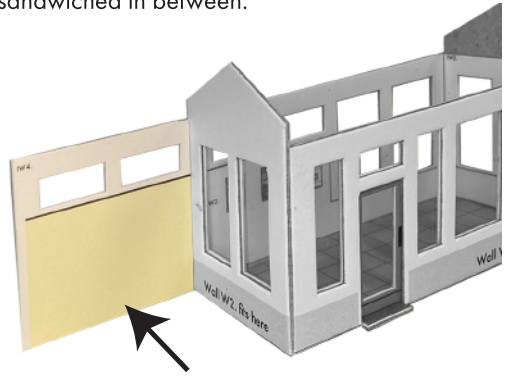

Then fix to the back of the outer wall, as you did with the others.

Now fit the canopy floor.

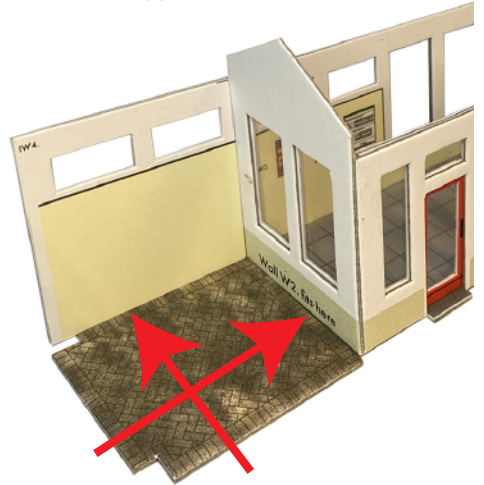

Tack it tight against the two walls as shown with tiny spots of glue to hold it in place.

4 Outer Stone/Brick Fascia.

Next it's decision time!

Brick or Stone?

You will have noticed that there are two identical sets of fascia walls - W1. W2. W3. & W4. which gives you a choice of brick or stone.

Whatever you choose, we are going to go with brick, for the purpose of these instructions. There is a photo of the stone style on the pack.

Start with wall **W1**.

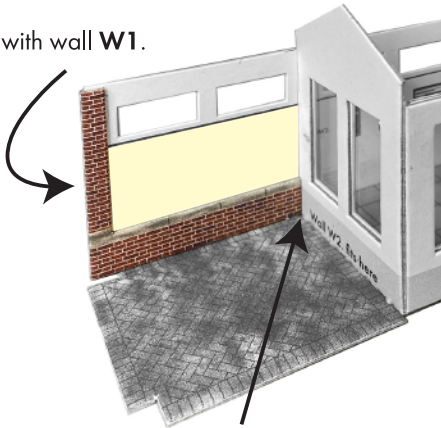

Fit tight into corner and down to base.

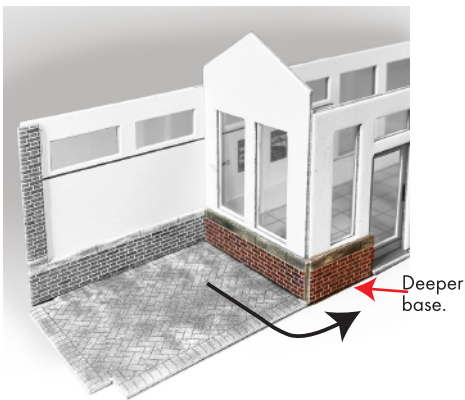

Now fit **W2**. which wraps around the corner. Note that the short front wall is slightly deeper along the base. This is to allow it to sit down to your work surface.

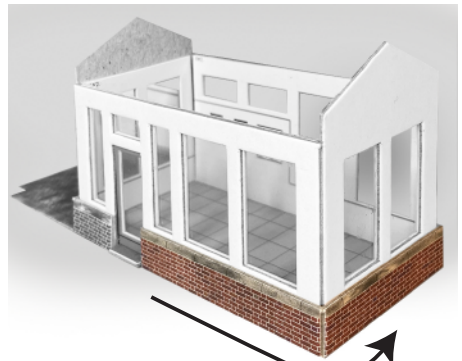

Wall **W3**. is next which wraps around the front and end walls.

Wall **W4**. next.

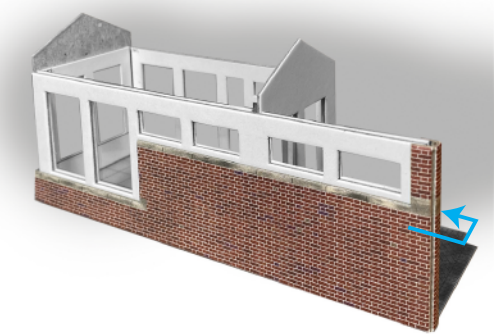

This rear wall fits along the full length of the back of the building with the end sections folding around the end of the wall at right angles.

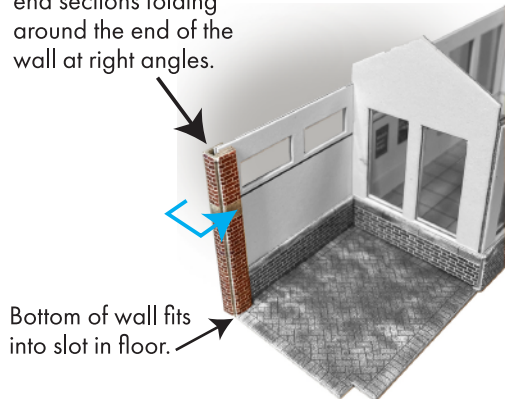

Hold or clamp tight until glue sets.

5 The Ticket Machine.



Is a very simple box style item. The sides and top fold back at right angles and are held in place with a brace that wraps around inside to hold all in place.



First fold the corners fully back and paint the white edges carefully with blue paint.

Like this.

Wrap the brace around inside the ticket machine

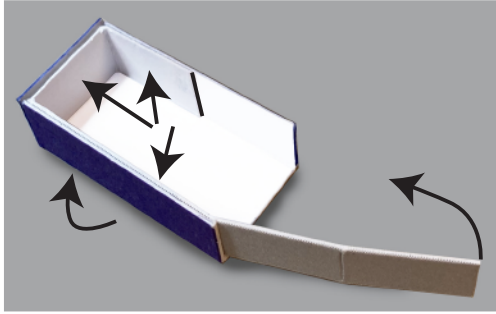

Fold the sides and top up and fix to the brace on the three edges shown. Hold or clamp each side firmly until the glue sets, then fold in the last two strips of the brace so the ends meet butt ended together.

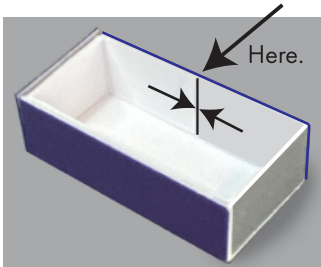

There is a more clearly printed version of the front of the ticket machine on page 8. If you want to use it simply cut out and attach to the finished machine.

Stand the ticket machine against the back wall.

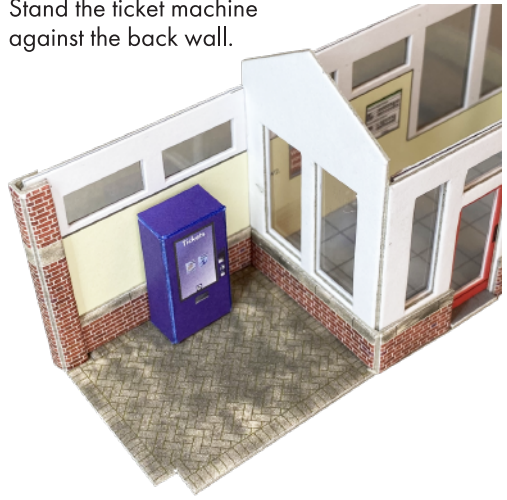

6 Canopy Corner Post.

One of the great problems with die cutting tiny components is that sometimes they just don't work as they should.

So carefully cut away the pink tab and throw it away!

You are left with a card with three score lines running lengthways down it. This card folds around to form a four sided post held in place by the three inner post spacers that fit inside it.

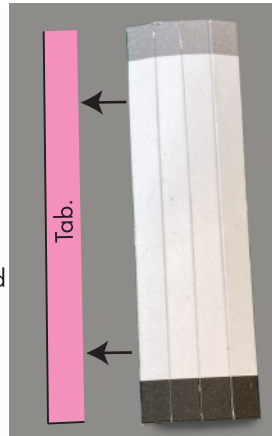

The three score lines on the post will need loosening up a bit to get them to bend easily. They need to fold at right angles around a post spacer shown overleaf.

So just run the point of your knife down each score very lightly. Be careful that you don't cut through.

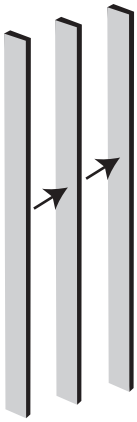

Glue the three spacers together keeping all edges flush and squared up.

BEFORE GLUE SETS
Wrap the outer canopy post around the inner spacers

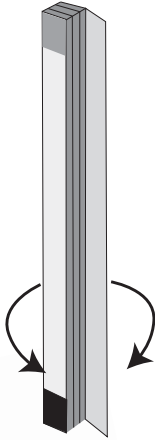

It is quite a tight fit and at first looks as though it won't form a square post. But keep firmly pressing the sides against the inner spacers and it gradually forms into the post as shown below.

Holding firmly until glue is set.



7 The Inner Roof.

Turn the Inner roof structure over. Fold the small cream coloured tab over and glue down.

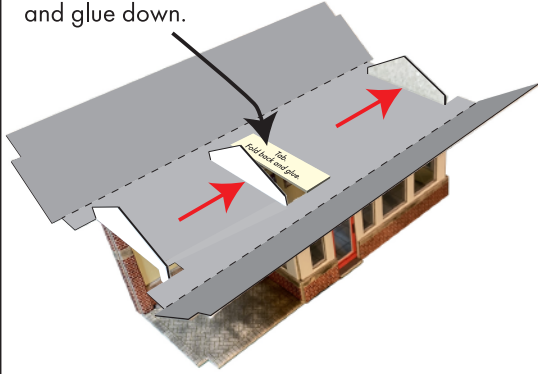

The structure sits directly on top of the walls straddling the two gables but then pushed up against them (as directed with the red arrows).

Test without glue first then place spots of glue along the wall tops and fit.

When glue has dried, take the small inner roof brace, fold it in half and glue.

Now fit it standing between the two gables as shown.

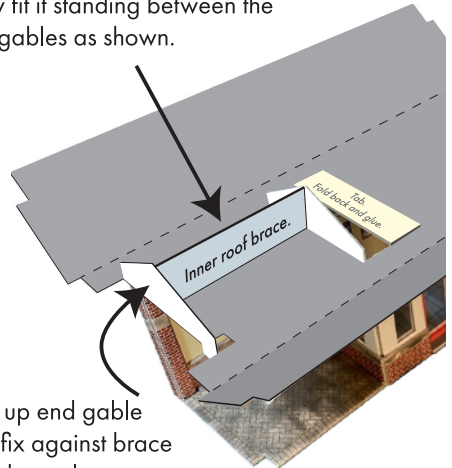

Fold up end gable and fix against brace at right angle.

8 Fit the Post.

The post slots down through the hole in the roof structure aligning directly above a notch cut out of the base card.

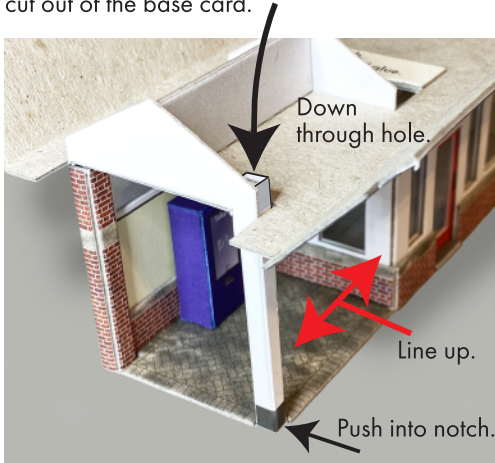

Test without glue first and check the post is in alignment with the other walls. You may need to cut a small piece out of the floor notch to get it lining up with the main building wall.

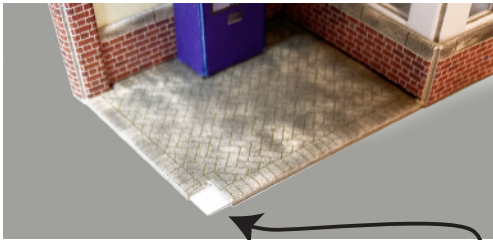

To give the post something to stand on, fix a piece of paper underneath the base like this.

Now slot the post back down through the hole and fix to the base card and to the back of the gable at the top.

9 Fit the Roof.

Fold over the two grey roof sections.



Don't press down too hard on this corner or you risk causing the roof to dip over the canopy area.

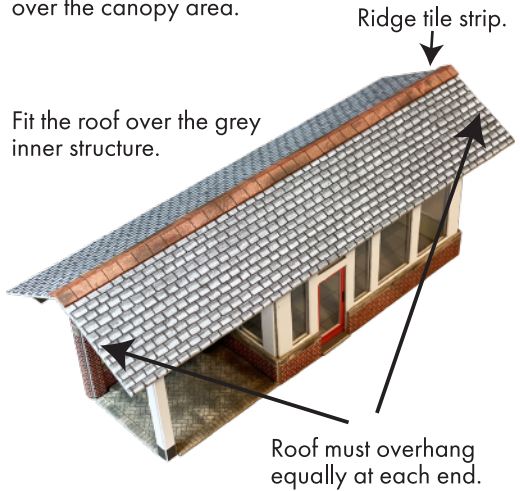

Fit the ridge tile strip. It will need the long score line loosening up by running the point of your knife along it.

Fold fully in half along the score line and paint the whit edges with a little water colour paint before you fit it.

10 The Barge Boards.

Fit the inner barge board first.



It sits on the recessed parts of the inner roof ends.

The outer barge board then sits on the edges of the inner roof where it sticks out a bit further.



Like This



The finished kit.



Ticket machine front.

