

PO513 Children's Play Area

CHECK LIST
This kit contains the following:
1 x Brown Sheet
1 x Dark Grey Sheet
1 x Instructions

Instruction Sheet

READ THROUGH ALL THE INSTRUCTIONS BEFORE YOU START.

To construct this kit you will need the following:

1. A Modellers knife.
2. Glue - UHU Clear Adhesive is our favourite.
3. A cutting surface - a sheet of card or a cutting mat.
4. Fine point tweezers to hold the smaller components.
5. Metcalfe UltraFine Tip Glue Bottle (Code: MT907)

GETTING STARTED

1 EXTRACTING COMPONENTS FROM SHEETS.

To stop the components from falling off the sheets, they are held secure with small score points. To release them push the components gently out from the sheet. Store the released components in a separate 'Builders Yard'. This is an area kept away from your working surface, keep the components here until needed. Use a tray or thick piece of card to make your builders yard.

Fig. 1 - CONSTRUCTING THE MAIN FRAME
There are 2 frames in this kit that are a mirror image of each other. Before you start construction make sure all the score lines (indicated below in blue) fold cleanly and easily. If needed gently run your knife along the score to deepen the fold.

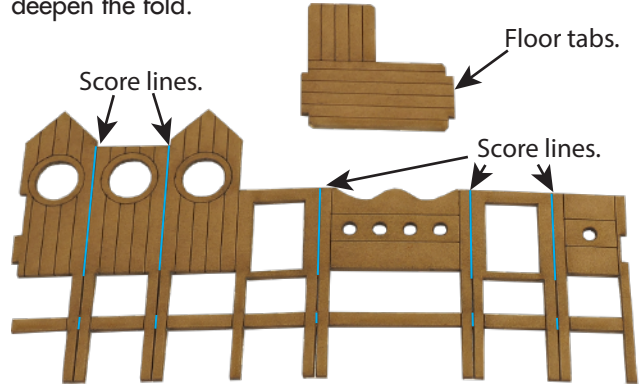
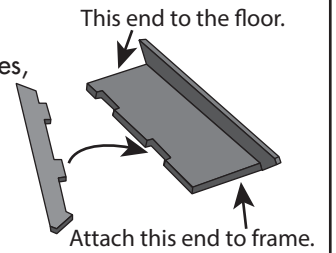

Fig. 2 - SLIDE
Using the tabs and slots as guides, add the slide sides upright onto the base. Attach this end to frame. This end to the floor.



The frame then wraps around the floor.

Finishing with the 'tower' wall section interlocking with the 'single circle wall'. Hold together and allow time for the glue to set before adding the roof.



Fig. 3 - FINISHING TOUCHES

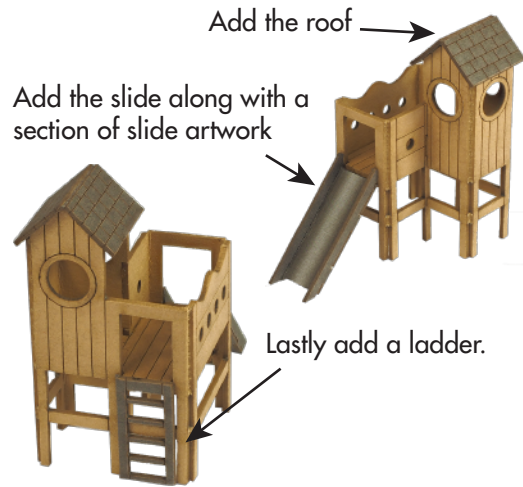

'Slide' the artwork in between the slide sides to give a more metallic appearance.

