

ISLAND PLATFORM BUILDING

for Mainline Station

CHECK LIST

This kit should contain the following:

- 1 x SHEET A. Printed with main building walls.
- 1 x SHEET B. Printed with corners and ridge tiles.
- 1 x Plain grey card with inner strengthening parts.
- 2 x (L1) Laser Cut Cream Cards with canopy parts.
- 1 x (L2) Laser Cut Dark Grey Card with canopy roof components.
- 1 x (L3) Laser Cut Mid Grey Thick Card with canopy inner parts and construction jig.
- 1 x GLAZING sheet.
- 2 x INSTRUCTION SHEETS.

READ THROUGH ALL THE INSTRUCTIONS BEFORE YOU START

This is a complex kit that requires particular attention to detail, so proceed with care!

To construct this kit you will need the following:

- 1. A modellers knife. and a pair of sharp scissors.
- 2. A steel ruler.
- 3. Glue - See glues below.
- 4. Ultra Fine Tip Glue Applicator, see below.
- 5. A cutting surface - a sheet of card or cutting mat.
- 6. Fine point tweezers to hold smaller components.
- 7. Water colour paints and a very fine brush for painting edges and corners.
- 8. Bulldog clips or clothes pegs for clamping.

METCALFE

Ultra Fine Tip Glue Bottles

These bottles are essential for gluing the smaller components in this kit.

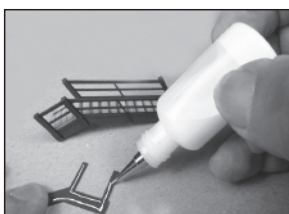

Tiny strips or spots of glue can be accurately laid down with precision.



Always replace the pin after use and store the bottles upside down to keep the glue moist.

GLUES

UHU Solvent Free All Purpose Adhesive Glue Works superbly well in our fine glue applicators. Dries quickly, but allows time for positioning of kit parts as described further on in the instructions.

Also Deluxe Materials 'SPEEDBOND' A fast drying PVA. see www.deluxematerials.com

INSTRUCTION SHEET 1

PLAIN GREY STRENGTHENING CARDS

This card contains the bits that fit inside the kit to strengthen and hold it together. They are described here with numbers and a key along side.

The dotted lines indicate the score lines you need to cut to extract them from the base sheet.

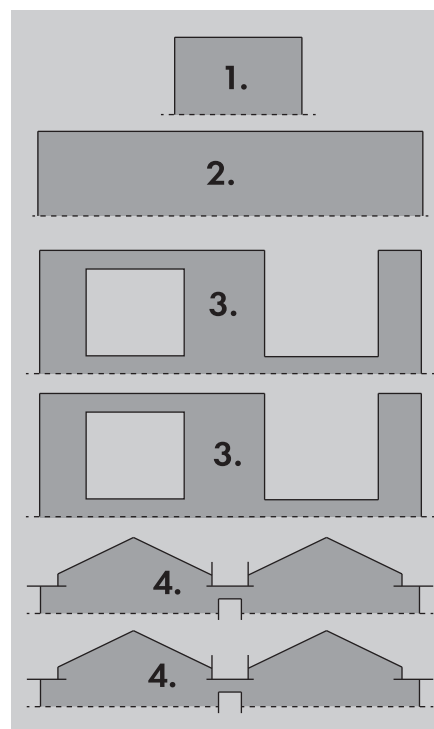

Key to components:

- 1. Inner centre wall.
- 2. Ceiling.
- 3. Side wall joiners.
- 4. Upper inner roof supports.

GETTING STARTED

1 EXTRACTING COMPONENTS FROM SHEETS.

To stop the components from falling off the sheets, they are held secure with score lines. These are cuts that only go about 75% of the way through the card. To release them run the point of your knife along these score lines and they will come seamlessly away. These score lines are marked with blue arrows: **WARNING**, Cut with care using a knife that is not too sharp, this will reduce the risk of the blade running out of the score and cutting into the kit components.

2 MAKE YOUR 'BUILDERS YARD'.

As you extract the components from the base sheets they need to be kept away from your working area on a thick piece of card or a tray until needed.

Example of builders yard.

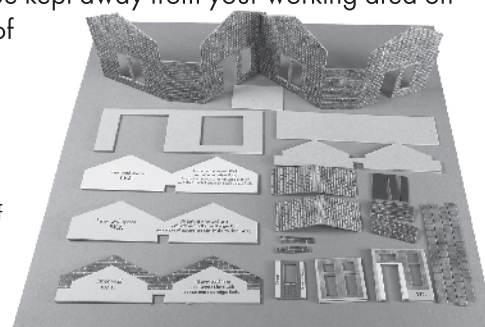

Only extract the components from the sheets as instructed.

Start with sheet A and the grey strengthener card as shown above, put the others to one side.

GLAZING.

The glazing in this kit is quite thick and is easier cut to size by scoring along the outer edges of the window sections with the point of a knife, guided by a straight edge.

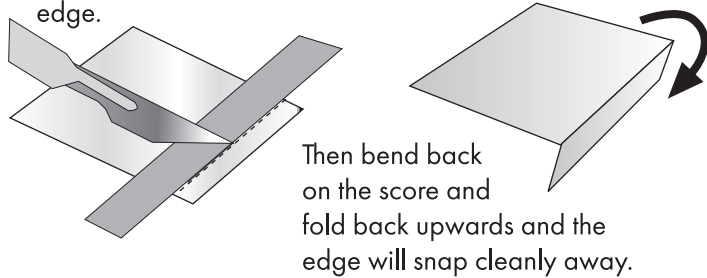

Then bend back on the score and fold back upwards and the edge will snap cleanly away.

Cut out the glazing pieces and place on a dark piece of card until needed.

NOTE: The canopy glazing needs care when cutting to size



Shown here in black for identification only.

It is important that you cut the glazing edges as indicated, otherwise the roof won't fit properly if they are cut bigger than shown.

PAINTING CORNERS & EDGES.

The only edges that need a touch up with paint on this kit are the corner stones and the ridge tiles.

All you need is simple set of child's water colour paints and a fine brush.

Mix your colour with lots and lots of water, apx. 1 part paint to 5 parts water or more. It needs to be very watered down. TEST ON WASTE CARD FIRST UNTIL YOU HAVE THE CORRECT SHADE & COLOUR.

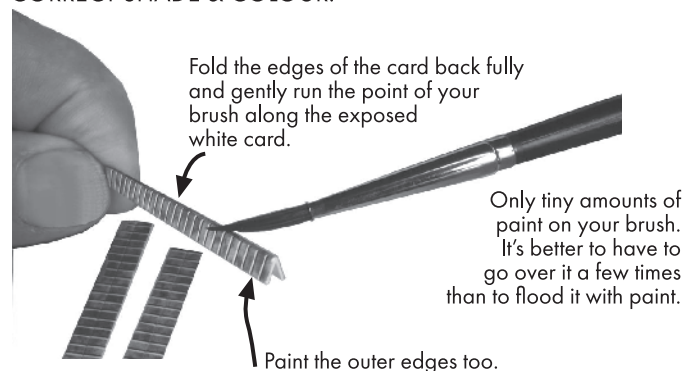

Before the paint dries, run your fingers along the edge to rub the colour into the absorbent card. Then wipe away anything that has run onto the printed surface before it dries.

Remember, you only need to slightly tint the card with a little shading to hide the white card.. DON'T paint a thick solid line down the scored edges, you will only make it look worse.

For the ridge tile strips use a WARM RED with a tiny bit of BROWN added plus lots of water.
For the corner stones use BROWN with a spot of BLACK.

LETS GET STARTED

Fig.1. WINDOWS & DOORS.

Start with the windows by attaching the glazings to the backs of the matching window frames with the matt printed side facing through the openings from behind.

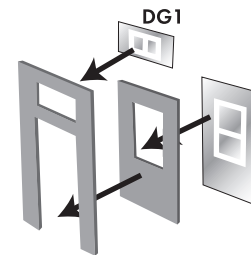

Also fit the door glazings to the back of the door and the smaller one to the opening at the top of the door frame.

Fit doors to backs of door frames. Place to one side until needed.

Fig.2. MAIN BUILDING WALLS.

The two outer walls are identical. Take one of them and fold the corners around, then fit one of the grey inner wall joiner cards (no. 3 on grey card) to the back of the wall with the door opening.

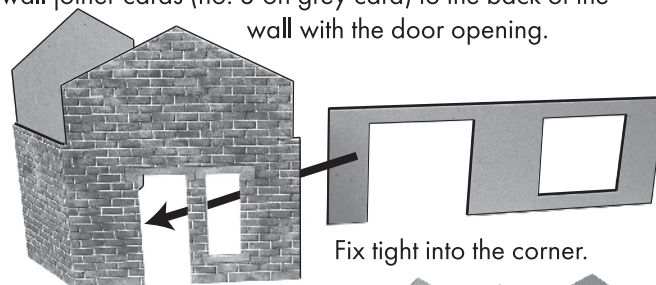

Fix tight into the corner.

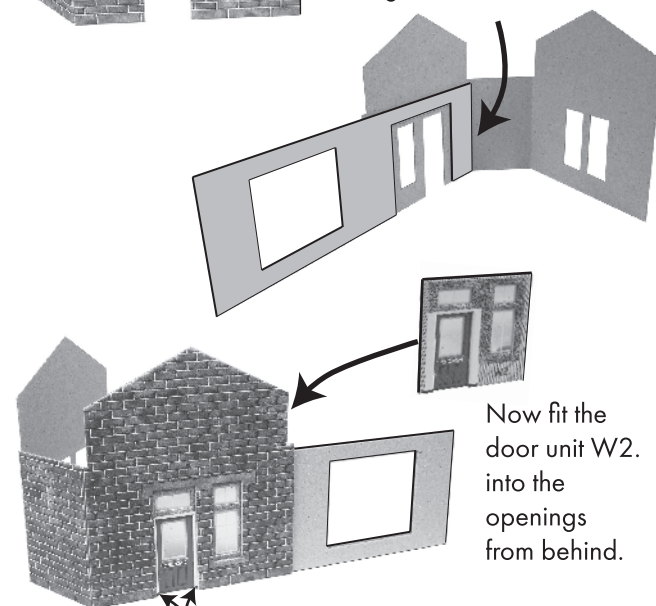

Now fit the door unit W2. into the openings from behind.

Centre the door frame in door opening.

Now repeat the whole thing again with the other wall.

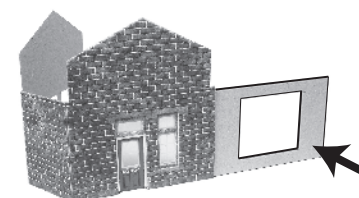

Note, this grey inner wall fits behind the wall with the windows on the other half of the building and vice versa see Fig.3.

Fig.3. JOIN THE WALLS TOGETHER.

Take the two halves of the building and fix the wall with windows onto the grey inner wall. Then repeat on the other side.

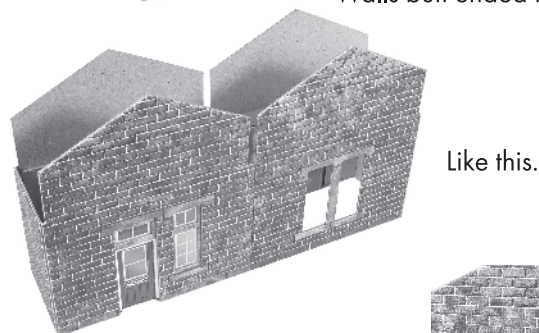
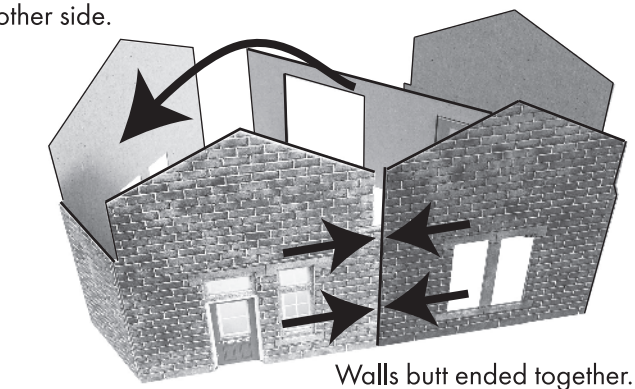

Insert and fix the windows W1.

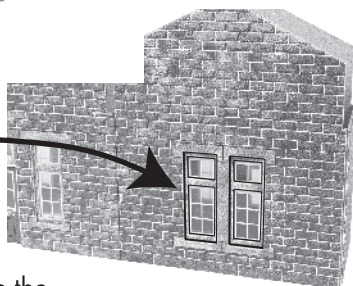

Fit the ceiling down inside the building sitting on top of the inner walls.

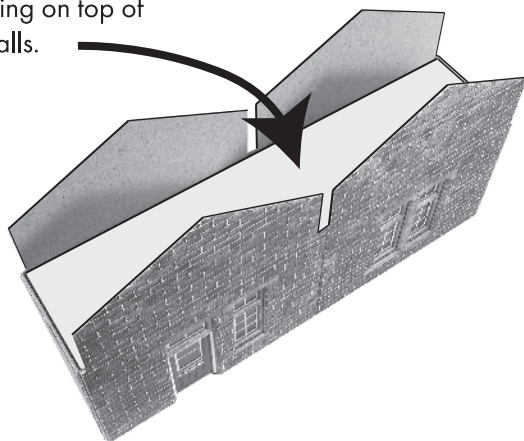

Fig.4. INNER WALLS.

There are two sets of inner walls, both fit together in the same way. Start with a set of inner walls 1, 2 & 3. glue together with base and side walls flush.

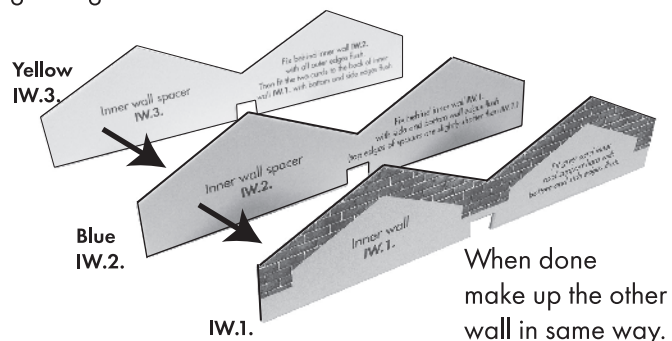

Fig.4. INNER WALLS cont.

Now fit the grey roof supports on to each of the walls

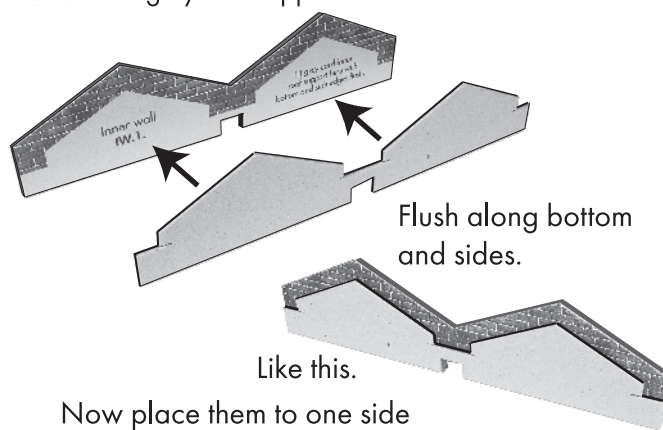

Fig.5. CORNER STONES.

Take the four corner stone strips from sheet B and paint edges and corners as described earlier then attach the corner stones to each corner of the building.

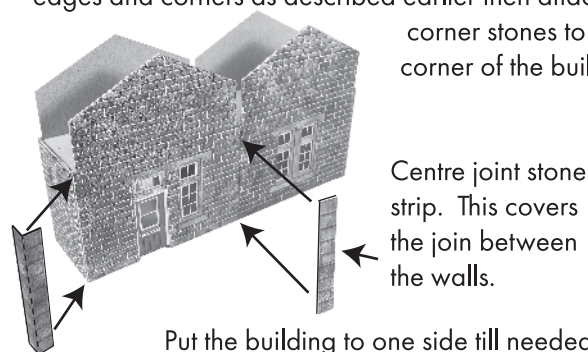

Fig.6. THE CANOPIES.

All the components for the canopies are laser cut and come on four separate sheets. If you hold the sheets up to the light you will see tiny pips holding the components onto the base sheet. These are relatively easy to push out with a little care not to bend them.

Lets start with the two cream coloured sheets 'L1'



1. Inner posts with beam & brackets. There are 2 of these

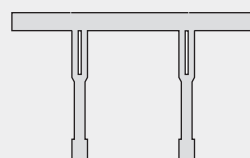

2. Outers posts with beam There are 4 of these



3. Cross beams. There are 10 of these (you only need 9).

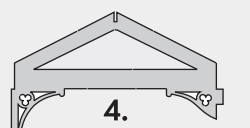

4. Roof truss x 4

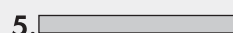

5. Side beams x 8

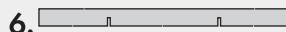

6. Long ridge plates x 2.

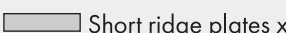

7. Short ridge plates x 4.

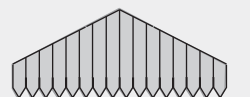

8. Gable ends x 8.

9. Post base (feet) two for each post 8 in total.

Place these cream coloured components in your builders yard and carry on extracting the grey laser bits from sheets L2 & L3.

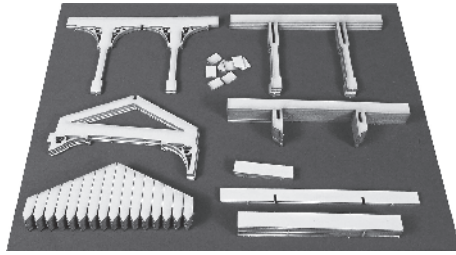

The dark grey sheet 'L2'

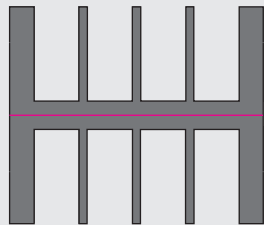

- 10.** Roof sections for end canopy. There are 2 of these.

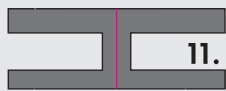

- 11.** Roof sections for side canopies. There are 4 of these.

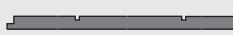

- 12.** End gutters x 2.

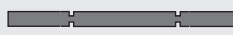

- 13.** End gutter, for use when adding extra canopies.



- 14.** Side gutters WITH NOTCH x 4.



- 15.** Side gutters WITHOUT NOTCH x 4.



- 16.** Thin end gutters x 2.

The light grey thick sheet 'L3'



- 17.** Gable end inner x 8.



- 19.** Wall plate x 4.

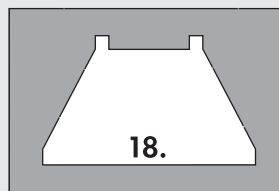

- 18.** Jig for assembling the post and beam units x 2.

Fig.7. ASSEMBLY JIG.

This jig is used to align the inner and outer parts of the leg and beam units when they are fixed together.

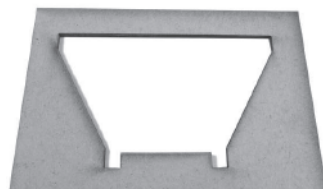
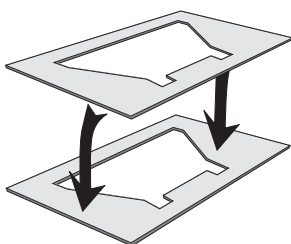

Take the two jig cards and glue one on top of the other. ALL OUTER AND INNER EDGES MUST LINE UP FLUSH.

Fig.8. POST & BEAM UNITS.

The main part of the canopy framework is the bit with the legs (or posts). There are two post & beam units, in this kit each consisting of one inner and two outer sections that are glued together to form a rigid set of posts with a beam above.

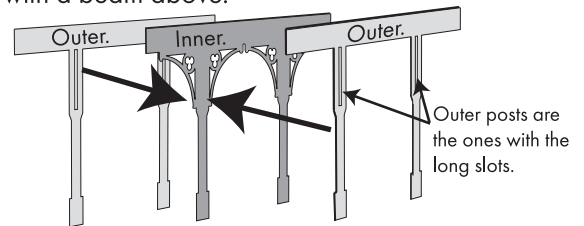

Each of the two Post & Beam units are made up with an inner post with brackets, sandwiched between the two outer posts.

To ensure that all outer edges line up flush when glued together, use the jig to hold them in place as they are fixed together.

Place the jig on a flat surface and fit one of the OUTER post and beams inside the opening.

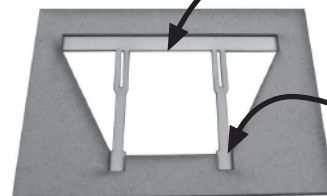

Make sure all the edges of the legs are pushed firmly down through the opening and sitting flat on your work surface.

Using your 'Ultra Fine Tip Glue Applicator' carefully glue the surface of the beam and posts with tiny spots of glue as shown. Don't glue near the slots.

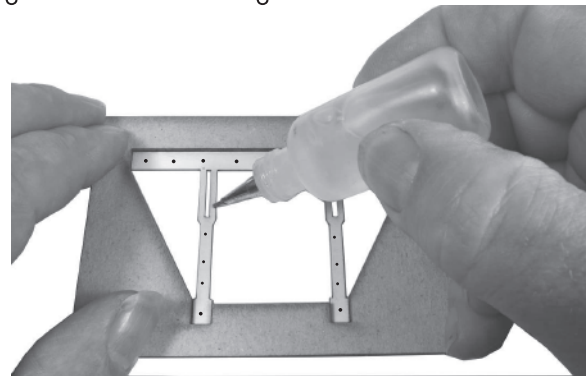

There needs to be enough glue to stick the inner leg unit on top but without glue oozing out around the edges

The INNER post and beam unit with brackets now sits down inside the jig, directly on top of the outer leg you just glued.

Push firmly down on top of the outer unit and slide around if needed to ensure that all edges of posts and beams line up.

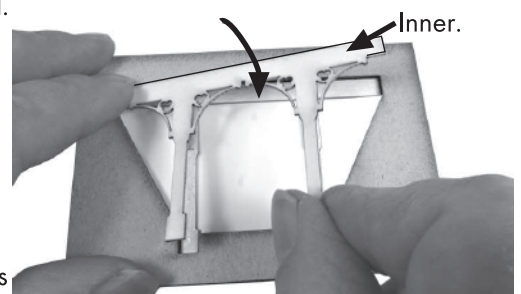

INSTRUCTION SHEET 2

Fig.8. cont'd. POST & BEAM UNITS.

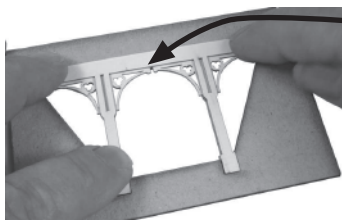

Now fit another outer post and beam unit into the jig on top of the ones you just glued together.

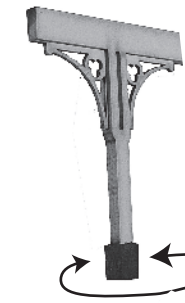

And now your first post & beam unit is almost complete.

Just one last thing:
Fix two of the tiny post base sections (feet) to either side of the base of the post.

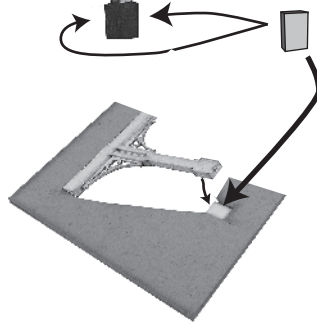

Line up the edges flush.

One good way to get them in position is to use the jig like this.

When fast paint the base black all the way around as shown here.

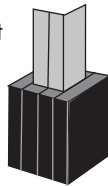

And 'Hey Presto' you've got your first completed frame. Now all you have to do is repeat this process with the other set.



Fig.9. CROSS BEAMS.

Glue the cross beams together in sets of three.

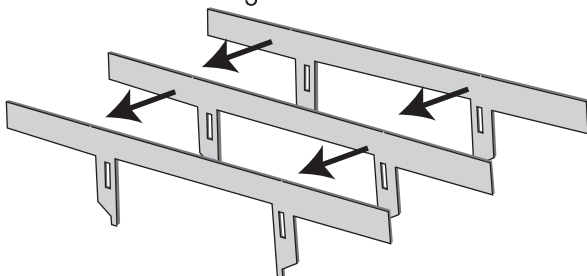

Keep all edges absolutely flush.
You can use the jig if you wish to guide you along.
You will end up with three sets of beams (and one single beam left over). Place to one side till needed.

Fig.10. TRUSS.

To strengthen the tie beam part of the truss, there are two side beams that are attached to each side of the tie beam.

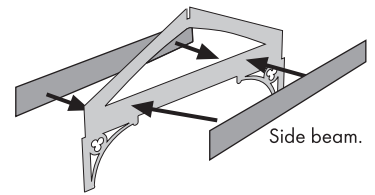

Make sure that the tops bottoms and ends all line up flush with the main beam, leaving the ends of the brackets free to fit into the slots in the posts.

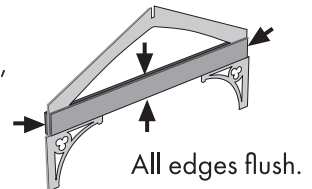

Repeat with other truss.

Fig. 11. GABLE END SECTIONS.

Each gable end is made of two parts. The outer cream coloured section has a grey inner card that is fixed to the back of it so that the upper and side edges are all flush with one another.

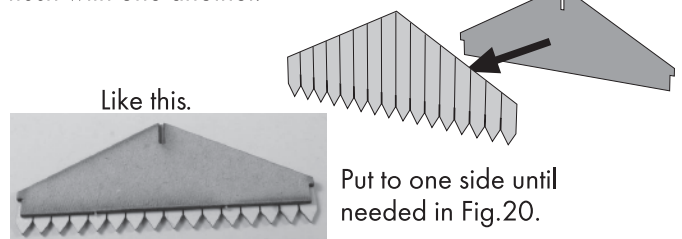

Like this.

Put to one side until needed in Fig.20.

Fig.12. FIT CROSS BEAMS.

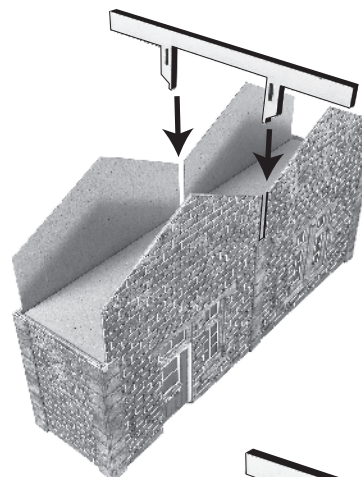

Start with the centre.
Carefully fit one of the beams down into the slots in the middle of the building, fitting the two side brackets down over the side walls and pushing the whole beam down until it is sitting firmly on the ceiling inside the building.

Fit the next beam so it sits on the wall top at the end of the building. Push down over the sides of the wall and up against the ends of the upper walls.

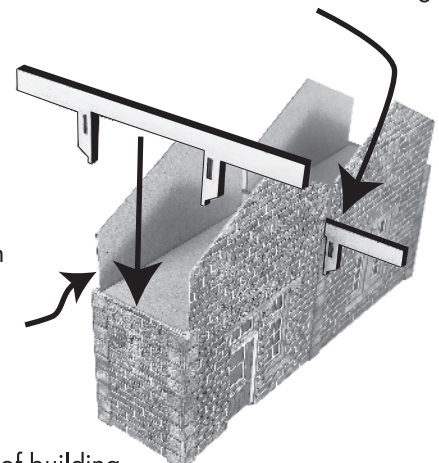

Repeat at other end of building.

Fig.12. Cont'd.

Your building should now look like this.

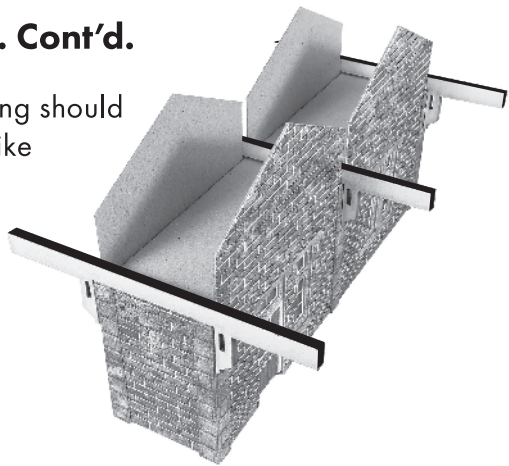
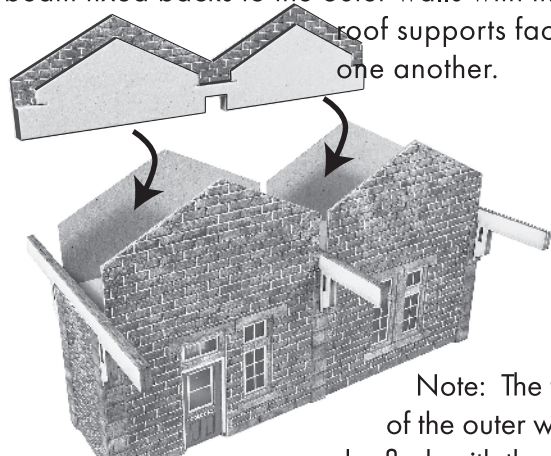

Fig.13. FIT THE INNER WALLS.

The two inner wall sections you made in Fig.4. now sit down inside the top part of the building. Fit so they stand on the ceiling over the centre beam fixed backs to the outer walls with the grey roof supports facing one another.



Note: The top edges of the outer wall should be flush with the top edges of the inner printed wall.

This allows the capping stones to sit evenly.

Fig.14. GUTTERS.

The three black gutters sit down onto the recessed areas of the inner roof supports.

The wider gutter in the centre.

The narrow gutters at each end.

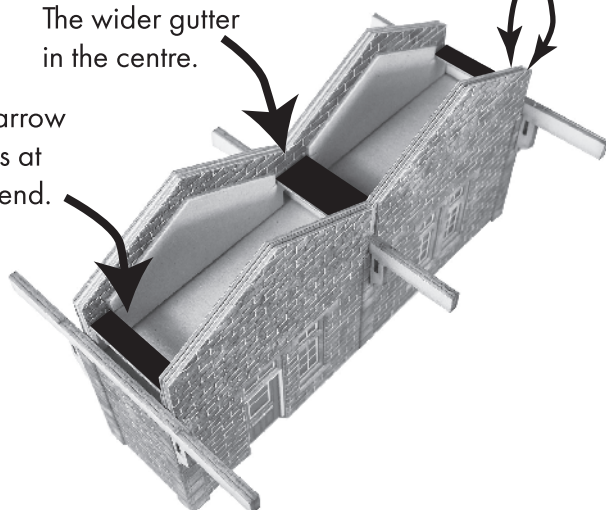
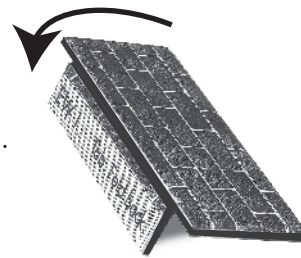
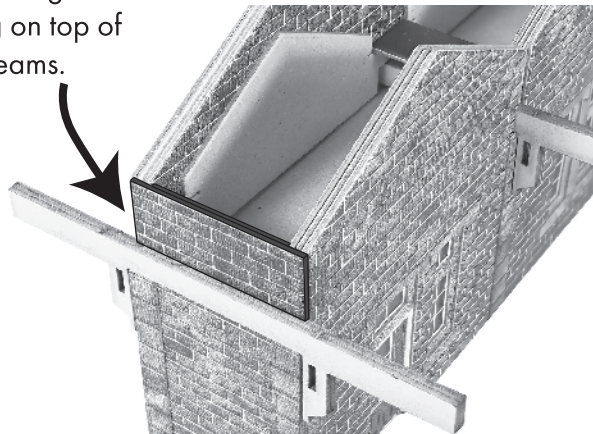

Fig.15. UPPER END WALLS.

Fold the tiny tab on each of the end walls EW.1. back over and glue.



Then fit walls to each end of building like this sitting on top of the beams.



The small stone strips EW.2. fit over the EW.1. grey tabs.

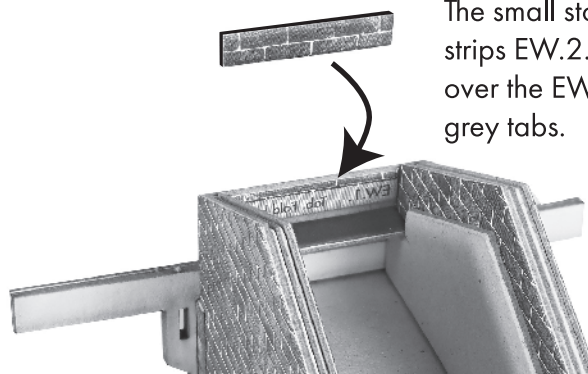
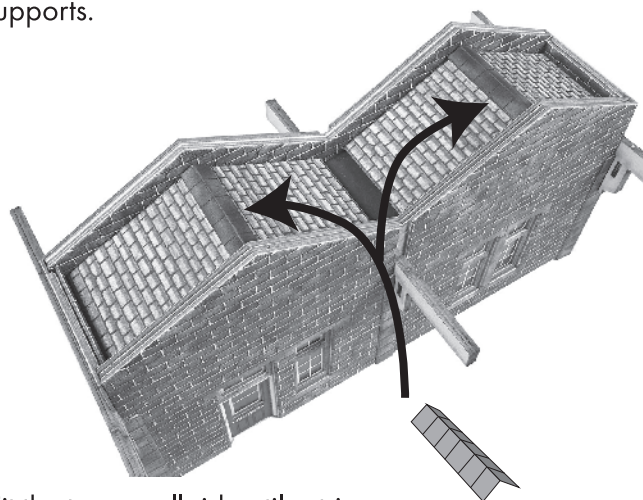

Fig.16. FIT THE ROOF.

Simply fit the two roof sections down inside the top of the building sitting on top of the grey supports.



Fit the two small ridge tile strips (located on sheet B) to the tops of the roofs. Don't forget to paint the centre score line and the edges before you fit them.

Fig.17. THE END CANOPIES.

We can now get on and finish off the rest of the canopies, starting with the end units. First check that the two slots in the posts are free from any glue or bits, then fix the first truss into the slot making sure that the lug on the bracket is seated fully into the slot with the end of the tie beam tight up against the main cross beam.

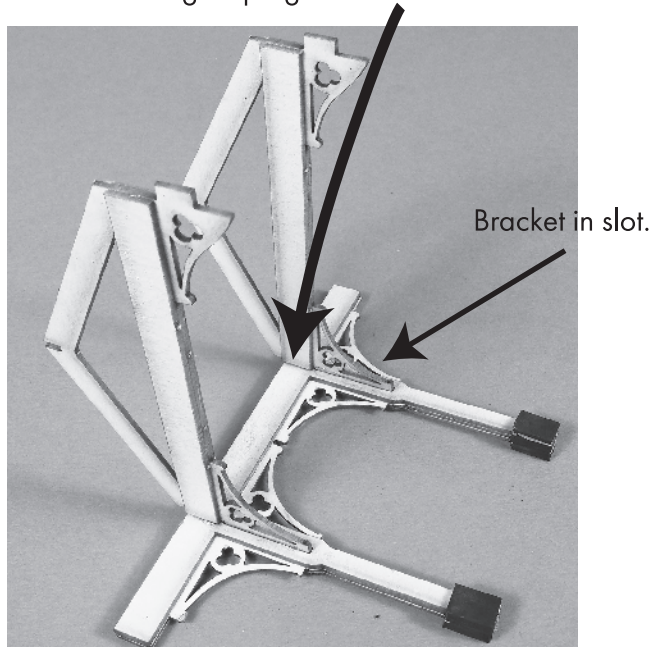

Hold at right angle until glue has set, then fit the second truss. Don't rush this delicate job!

Now repeat with the second set of posts & trusses. Leave both sets for a while for the glue to fully set.

Fig.18. THE WALL PLATES.

Now is a good time to fit the grey wall plates to the main building. The slotted ends fit over the beams and each one is fixed to the walls on both sides of the building.

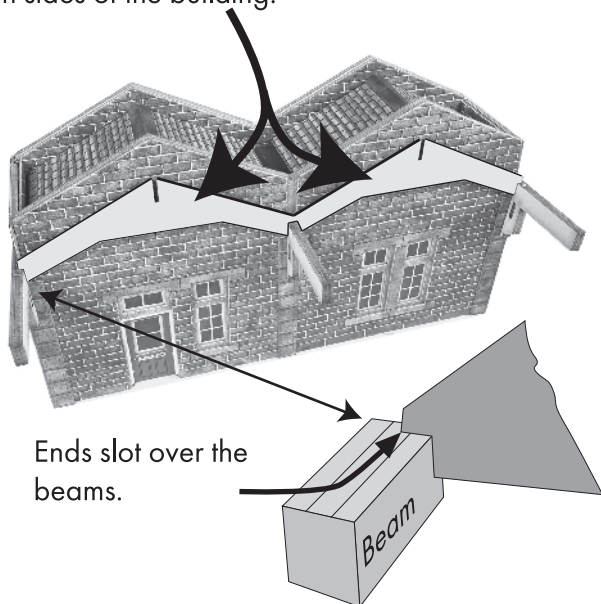
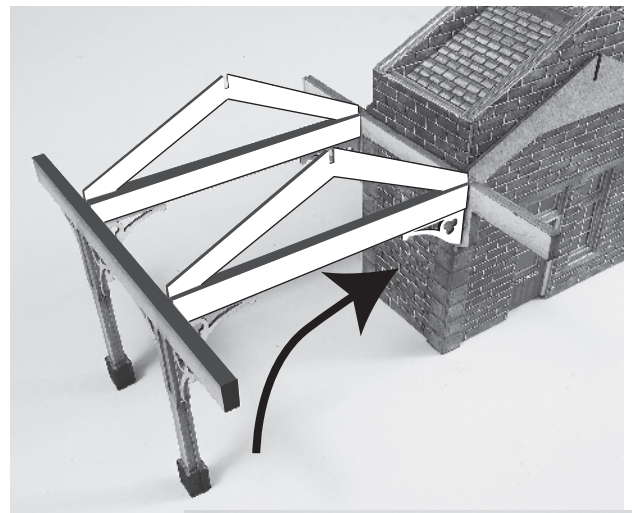

Fig.19. FIT END CANOPIES.

Now fit the end canopy structure with the two lugs on the ends of the smaller brackets fitting into the slots on the cross beams.



Next fit the ridge plate which sits into the two slots at the top of the two trusses.

Once all is fast, fit the other canopy unit to other end of building.

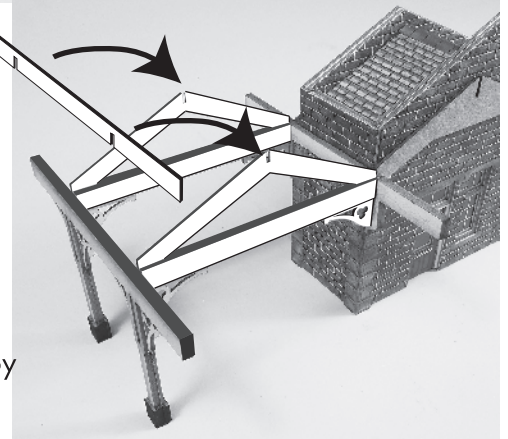
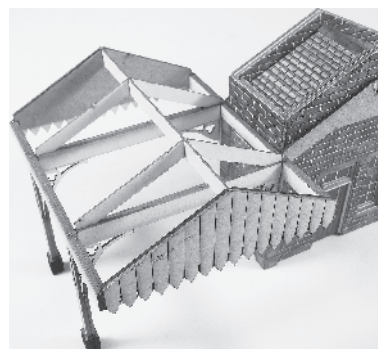
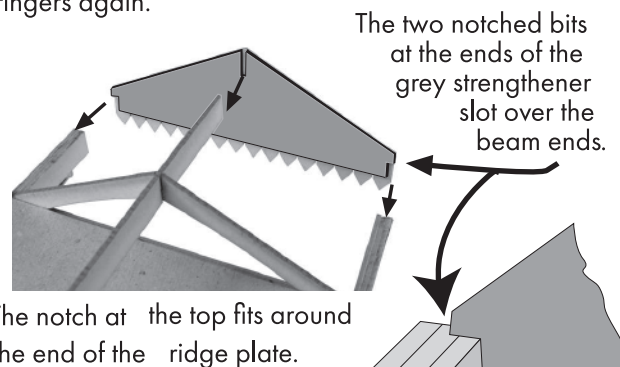

Fig.20. FIT GABLE ENDS.

This can be tricky and requires patience and light fingers again.



Now fit the rest around the building. SEE NEXT PICTURE showing how to fit the gable ends along side the building.

Fig.20. FIT GABLE ENDS continued.

As you fit the gables along side the building, you will need to fit the small ridge plates at the same time to hold the tops of the gables in place.

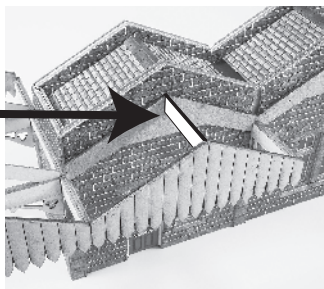
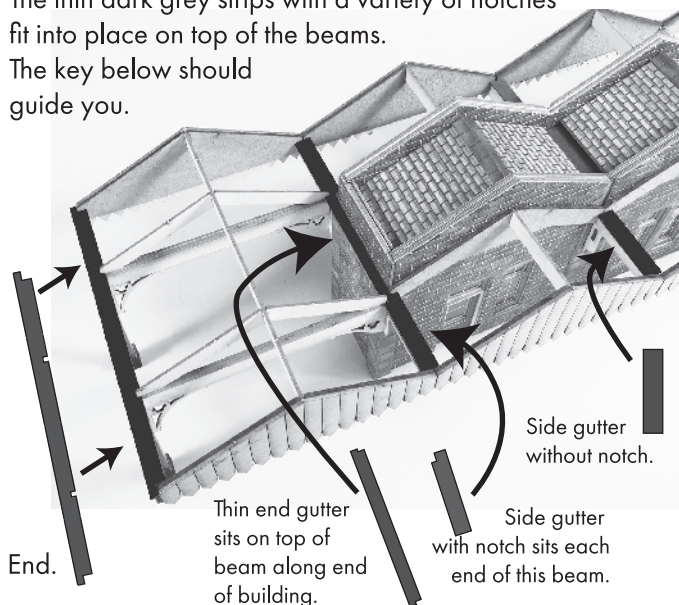

Fig.21. FIT THE GUTTERS STRIPS.

The thin dark grey strips with a variety of notches fit into place on top of the beams. The key below should guide you.



NOTE: If you are adding more canopies on to the end of this kit, replace the end gutter with this one  which allows room for the next set of trusses to be inserted into your canopy posts.

Fig.22. CANOPY ROOFS.



Fit the glazing sheets from underneath so that you can see where it is to be positioned. Test without glue first so that you can see where it fits.

The glazing should be flush along the bottom edge of the grey roof end sections. Use only tiny spots of glue placed on underside of card to fix to glazing.

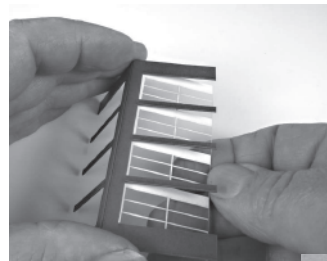
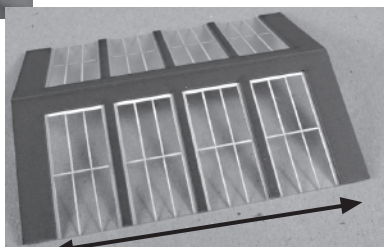

Glazing flush with card edges.

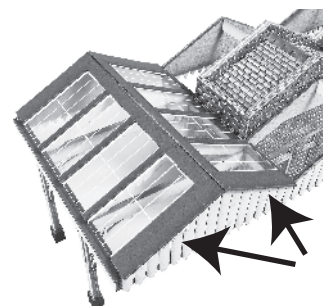

As you fix the roof to the framework make sure it is squared up at right angles to rest of building. The roof should overhang equally at both ends from top to bottom of all slopes.

Fig.23. SIDE CANOPY ROOFS.

After fitting the glazing to these smaller roof sections, take a close look and you will notice that one side is a bit wider. When you fit the four roof sections remember to fit with the wider edge away from the building to the outer rail edge.

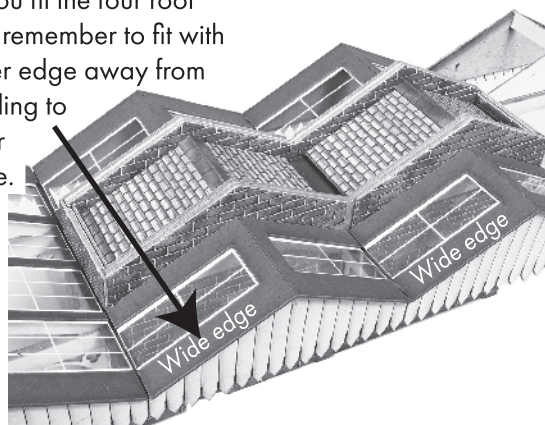

Fig.24. TOP CORNER STONES.

These tiny pieces of card located on sheet B fit around the four upper corners of the building where it sticks up past the canopy roofs.

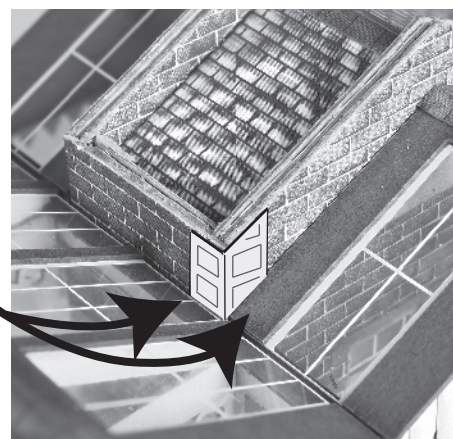
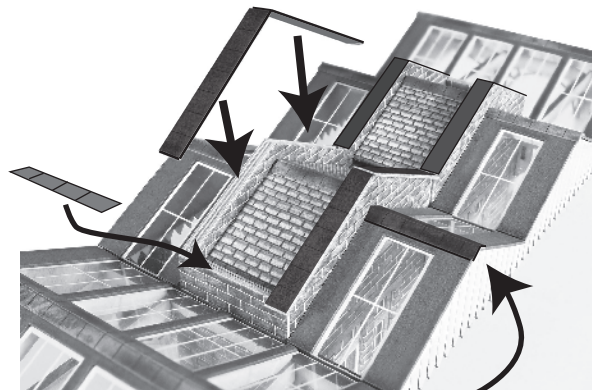

Fig.25. CAPPING STONES.

Fit the four strips with centre scoreline that fit over the sloping wall tops, then cut the smaller stone strip for the end walls to length and fit.



Don't forget to fit the rest of the ridge tile strips to the canopy roof as well. And that's the kit finished.

USE WITH PO235 STONE PLATFORM KIT.
Cut platform to 90mm. wide to fit with this kit.

© Copyright 2017 Metcalfe Models & Toys Ltd