

## Fig. 4 - SERVING COUNTER

Take the inside brown counter top and fix flush to the strengthener block aligning the tabs to the frame of the kiosk window.

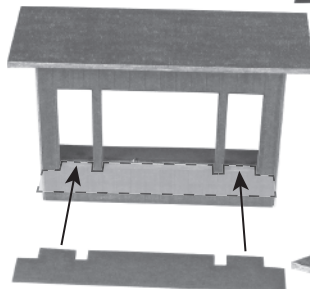
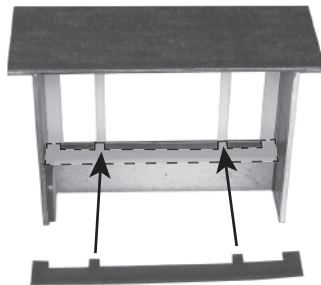

Now slot the outside counter top into the slots of the inside top and around the window frame.

You will finish with a nice flush counter top that encircles the kiosk window.



# P0517 Platform Kiosk

## CHECK LIST

This kit pack contains the following:

- |                        |                 |
|------------------------|-----------------|
| 1 x Sheet A            | 1 x Brown Laser |
| 1 x Sheet B            | 1 x Grey Laser  |
| 2 x Instruction Sheets |                 |

## Instruction Sheet 1

**READ THROUGH ALL THE INSTRUCTIONS  
BEFORE YOU START.**

To construct this kit you will need the following:

1. A Modellers knife.
2. A steel ruler.
3. Glue - UHU Solvent Free Clear Adhesive is our favourite.
4. A cutting surface - a sheet of card or a cutting mat.
5. Fine point tweezers to hold the smaller components.
6. Metcalfe UltraFine Tip Glue Bottle (Code: MT907)

## EXTRACTING COMPONENTS FROM SHEETS.

To stop the components from falling off the sheets, they are held secure with small score points.

To release them simply run the point of your knife along the cut lines and they will come seamlessly away.

To release the laser components *carefully* push them out from the card, these components are delicate.

Store the released components in a separate 'Builders Yard'. This is an area kept away from your working surface, keep the components here until needed. Use a tray or thick piece of card to make your builders yard.

### Fig. 1 - EDGES

Start off by lightly painting the white edges of the card with water paint. Use a slightly lighter colour than the artwork.

### Fig. 2 - ROOF & WALLS

Fold the roof back onto itself and glue together to make double thickness.

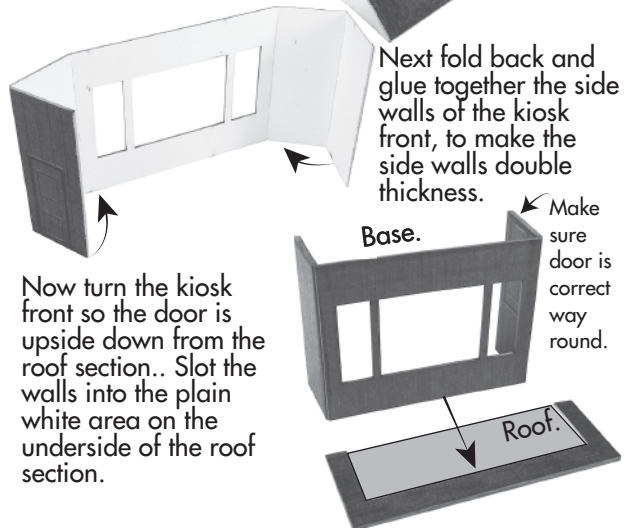

### Fig. 3 - STRENGTHNERS

Now add the large rectangle from the plain grey card, to the underside of the roof, flush against the walls strengthening the structure.

Glue the 4 smaller grey card rectangles together to create a single flush block

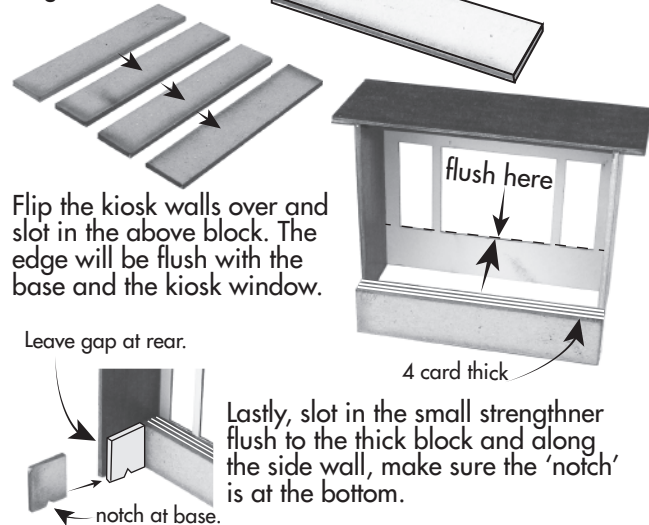

Lastly, slot in the small strengthner flush to the thick block and along the side wall, make sure the 'notch' is at the bottom.

## Fig. 7 - PAPER STAND

First make sure all the scores are easily folded.

Fold each of the dashed white scores 90 degrees and glue the base to the triangular sides.

Then fold the dashed shaded area back onto the itself.

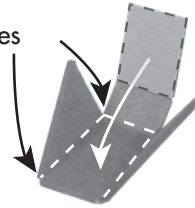

Like so.

Now cut out a stand display from Sheet B and slot it into place.



← Cut out a poster from Sheet B and add a brown laser cut frame for additional detail.

## P0517 Platform Kiosk Instruction Sheet 2

### Fig. 5 - SIDE & REAR WALL

Before fitting the rear wall, carefully cut to size a side wall display from sheet B and fix into place on the inner side wall.

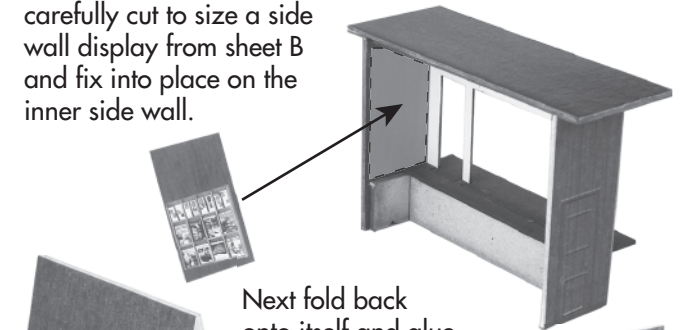

Next fold back onto itself and glue together the rear wall



Choose a rear wall display and cut to match the rear wall size and glue into place.

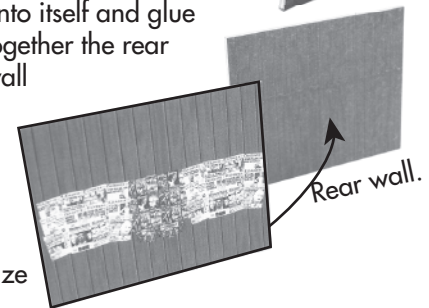

### Fig.5 - SIDE & REAR WALL cont.

Now attach the rear wall flush to the side strengtheners and against the roof strengthner on the underside of the roof. Make sure the rear wall display is the correct way around!

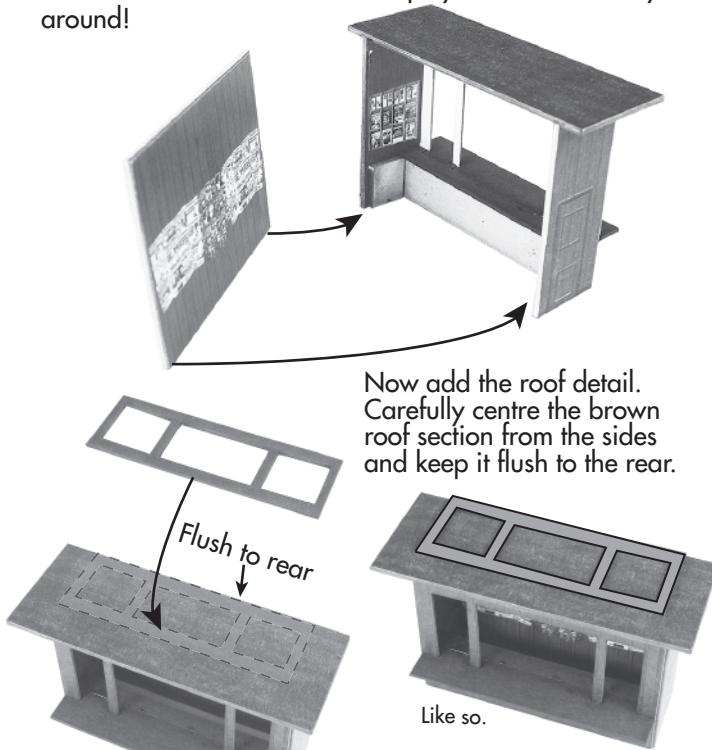

### Fig. 6 - FRONT DETAILS

Carefully cut free the under counter display from sheet B and align the newspaper headline with the laser cut brown frame.

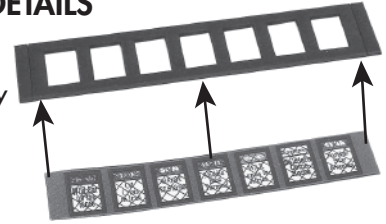

The display then fits snugly under the counter on the kiosk.

