

PO255 00/HO WORKERS COTTAGES

SHEET 1

READ THROUGH ALL THE INSTRUCTIONS BEFORE YOU START.

To construct this kit you will need the following:

1. A Modellers knife.
2. A pair of sharp pointed scissors.
3. A steel ruler.
4. Glue - UHU Clear Adhesive or Bostik Clear Adhesives are best.
5. A cutting surface - a sheet of card or a cutting mat.
6. Tweezers to hold the smaller components.

CHECK LIST

This kit pack should contain the following:

- 2 x SHEET A - House & shed walls and bases etc.
- 1 x SHEET B - Roofs and windows frames etc.
- 1 x GREY SHEET - Inner strengthening components.
- 1 x GLAZING SHEET.
- 1 x INSTRUCTION SHEET 1.
- 1 x INSTRUCTION SHEET 2.
- 1 x Ridge Tile Sheet.
- 1 x Curtains and alternative doors sheet.

GETTING STARTED

1 EXTRACTING COMPONENTS FROM BASE SHEETS.

To stop the components from falling off the sheets, they are held secure with scorelines. These are cuts that only go about 75% of the way through the card. To release them simply run the point of your knife along the scorelines and they will come seamlessly away.

These scorelines are indicated with blue or black arrows: →

2 MAKE YOUR 'BUILDERS YARD'.

Use a piece of thick card or a small tray to make your builders yard.

This is an area kept outside your working area where all the components are stored in neat piles until needed. Your working area should have a clean flat surface.

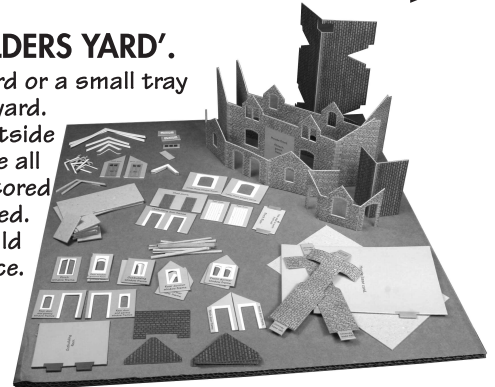

3 THIS KIT.

Makes two identical houses. To avoid getting in a mess, it is better to build the houses one at a time. Extract the components from ONE sheet 'A' and half of sheet 'B' and the grey strengthener card. Put rest to one side until needed.

Fig. 1. START WITH THE WINDOWS.

This is the fiddly bit!
Start by cutting out all the clear plastic window sections. Cut along the thin white lines that mark them out.

Fix each of the glazing sheets to the back of the inner window frames with the mat printed side facing through the openings.

Trim off any excess plastic that shows past the outer edges of the card.

IF YOU ARE ADDING CURTAINS, DO IT NOW.
See Fig.17.

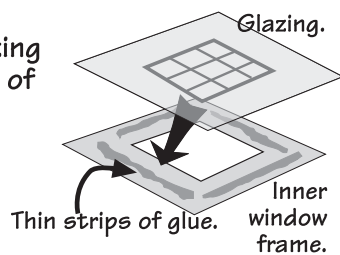

Fix the doors to the door frames as well.
Place on separate card or back in your builders yard.

Please note, not all glazing descriptions match exactly to the corresponding frame ie. 'shed - outbuilding' but it's easy to work out!

Fig. 2.

REAR WALL & BASE CARD.

Fix the rear wall to the base card with the two door steps positioned through the doorways. Stand on a flat surface and fix the base card to the inner edges of the walls FLUSH ALONG THE BOTTOM EDGES

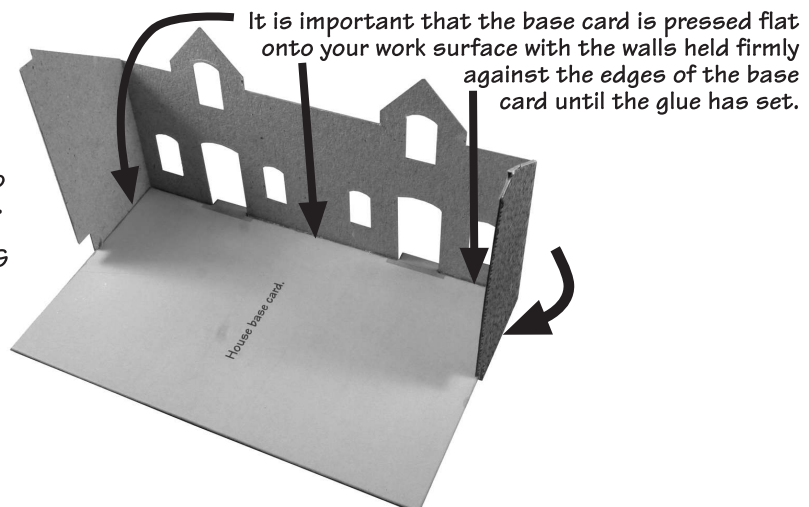

Fig. 3. ATTACH DOORS & WINDOWS.

Fix the two rear doors and the windows that fit either side.

Make sure they are fitted tightly down onto the base card. The top edges should all line up level.

DON'T FIT UPPER WINDOWS YET.

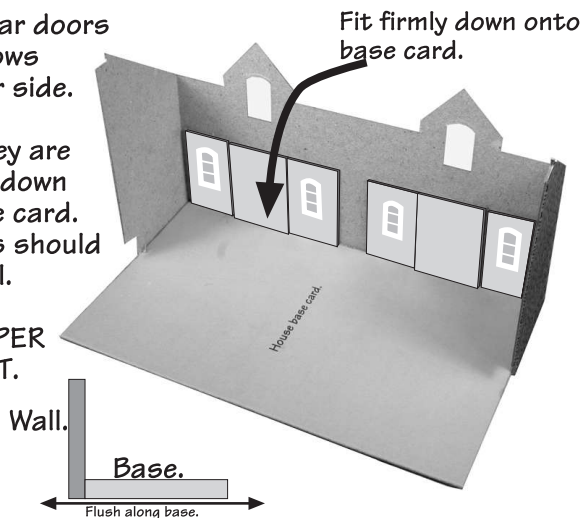
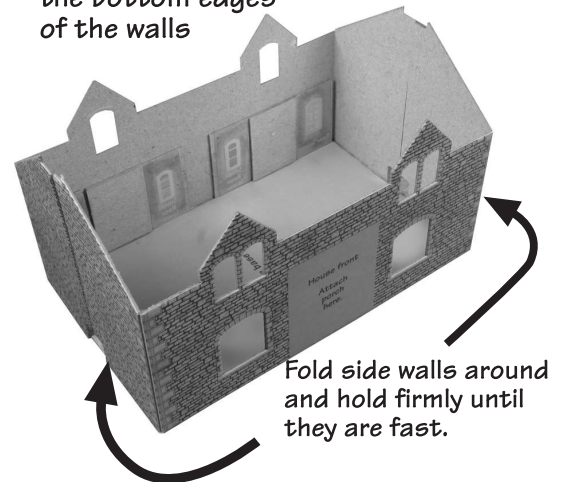

Fig. 4. FRONT WALL.

Fit the front wall to the base card in the same way as the rear wall, making sure the base is flush with the bottom edges of the walls



PLAIN GREY SHEET

The two halves of the grey sheet are identical. Each one contains the inner strengthening and spacing cards for one building

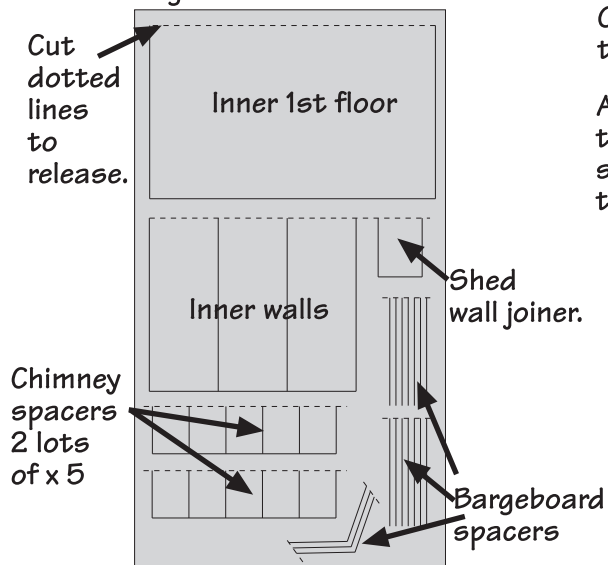

Fig. 5. INNER GREY WALLS.

Fit the three inner walls into the building. One at each end fitted to the backs of the side walls to act as a jointing brace.

And one across the centre to strengthen the building.

All three walls should be pushed down firmly onto base card held, butted together

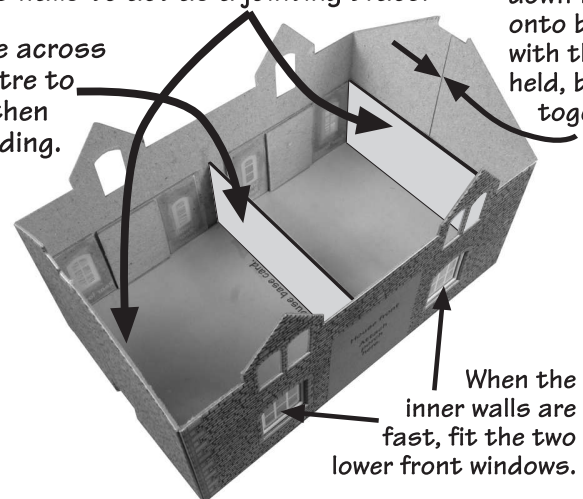

Fig. 6. CHIMNEY STACKS.

The chimneys are designed to cover up the joins on the gable walls.

Start by folding back the green tabs at each end and fix.

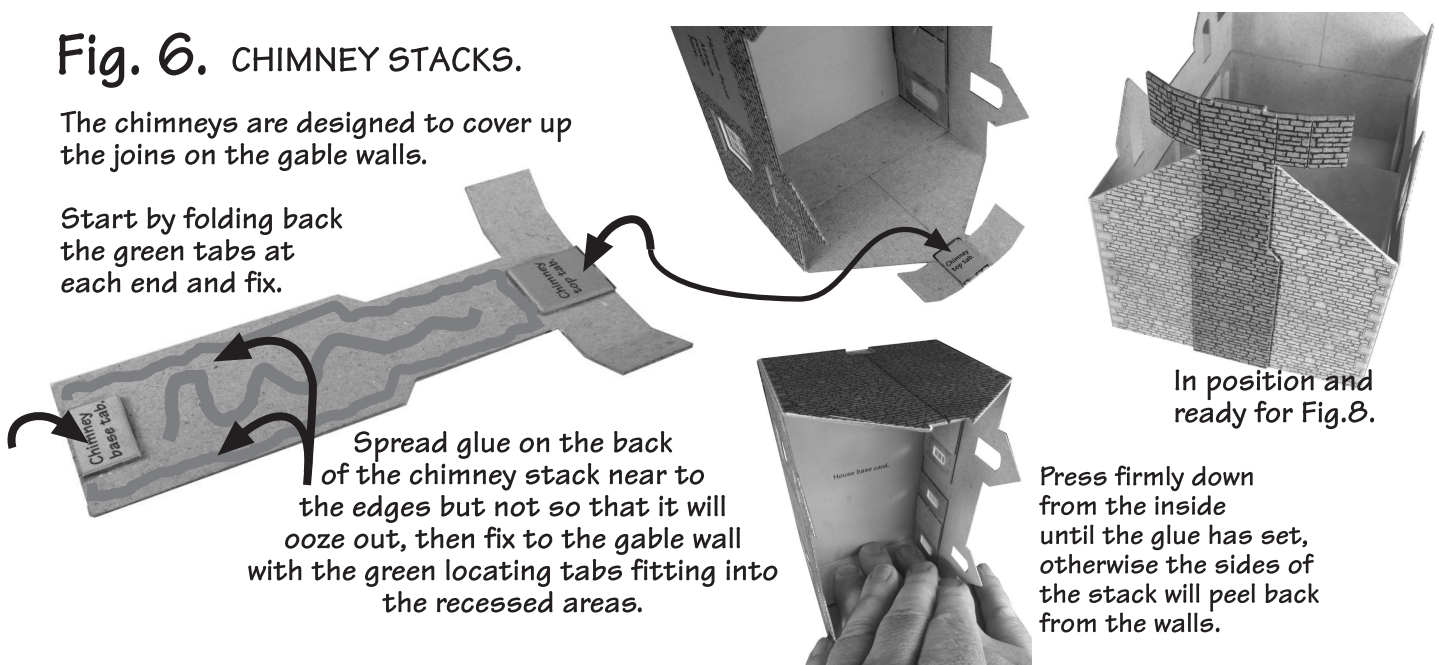
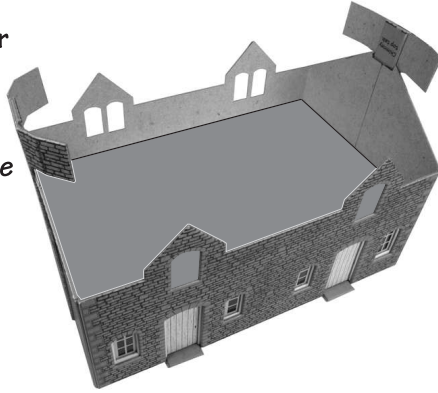

Fig. 7. INNER FLOOR AND UPPER WINDOWS.

The grey inner 1st. floor sits on top of the inner walls, doors and windows. There is no need to glue it in place, just push firmly down inside the building.



The dormer windows sit directly on the inner floor and the top edges should line up flush with the outer walls. If the inner floor hasn't quite seated down properly, then you may have to trim a little off the bottom edges.

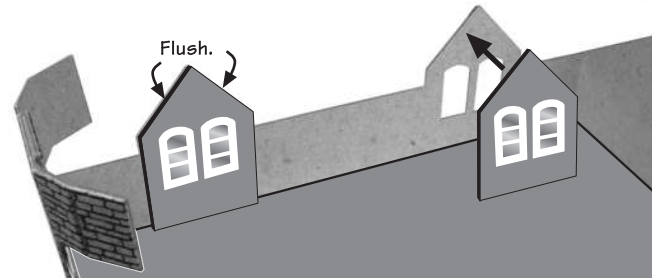
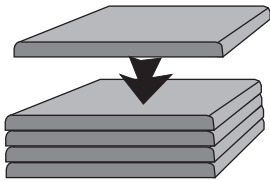
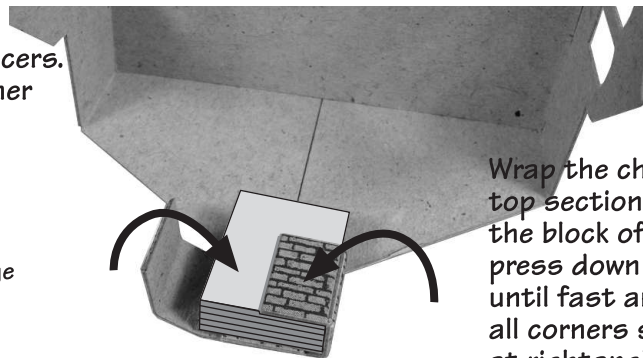

Fig. 8. CHIMNEY SPACERS.

Each chimney uses 5 of the small grey spacers. Start by gluing them one on top of the other to form a solid block



Keep them the same way up. If you look closely at the edges there is a rounded edge where they have been stamped out.



Wrap the chimney top section around the block of card press down tight until fast and keep all corners squared at rightangles.

Fig. 9. FITTING THE ROOF.

This is the awkward bit. The roof has to be fitted over the two chimney stacks and they are a tight fit, so carefully work the roof down over them, a bit at a time. Don't force it as you may split the small outer ridge folds. Now hold the roof upwards and place tiny spots of glue along the wall tops.

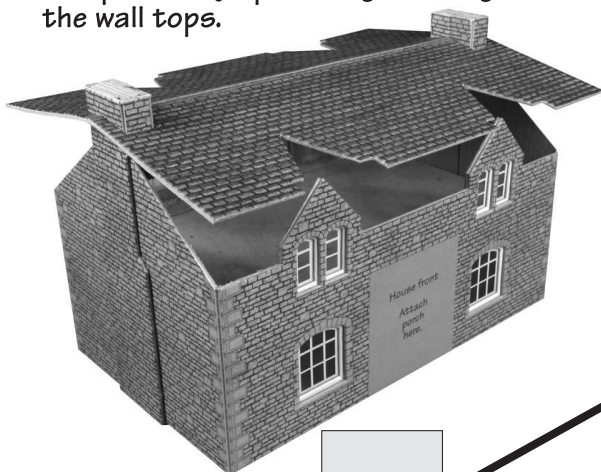

Fold the roof down at each side and fit behind the dormer windows, you will need to bend them outwards a little to fit it in.

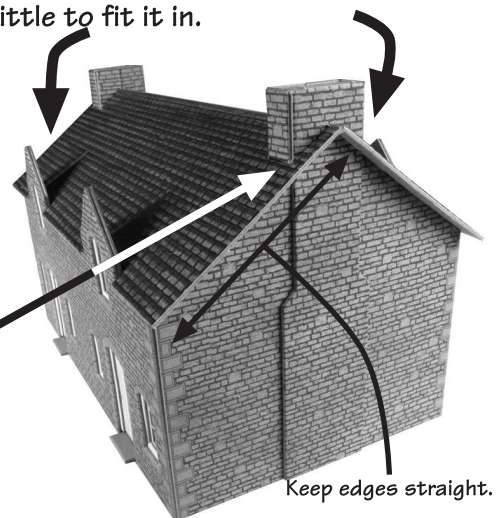

Gently work the roof into place so it sits evenly on top of the gable walls from top to bottom.

Keep edges straight.

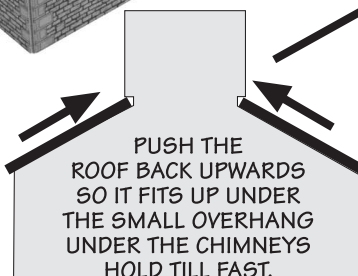
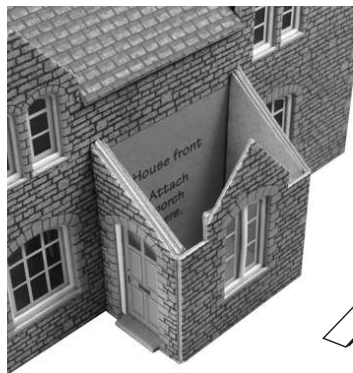
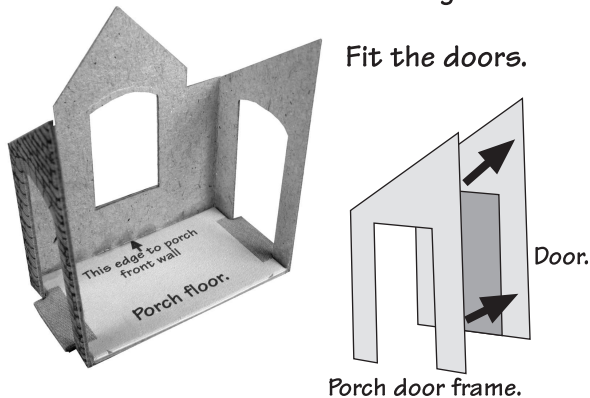
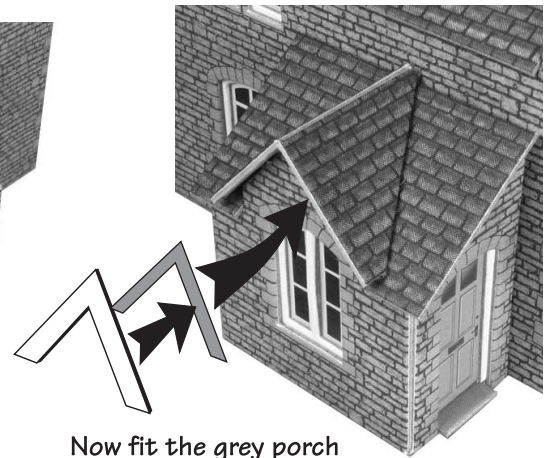

Fig. 10. FRONT PORCH.

Fold the sides around and fit to the porch floor. Keep floor flush with wall bottom as with main building.



Fix the porch to the front wall of building then fit the two roof sections. NOTE: The dormer type roof is smaller than the four upper dormers.



Now fit the grey porch bargeboard spacer up under the roof overhang and then fit the white porch bargeboard on top of it, pushed up against the underside of the roof.

Fig. 11. DORMER ROOFS & BARGEBOARDS.

Fit the bargeboards to each dormer roof as shown.

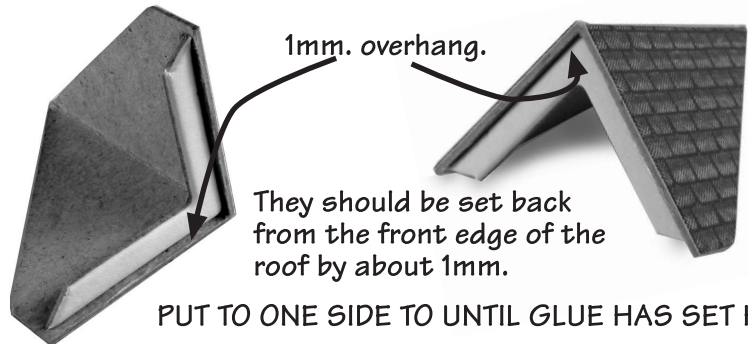
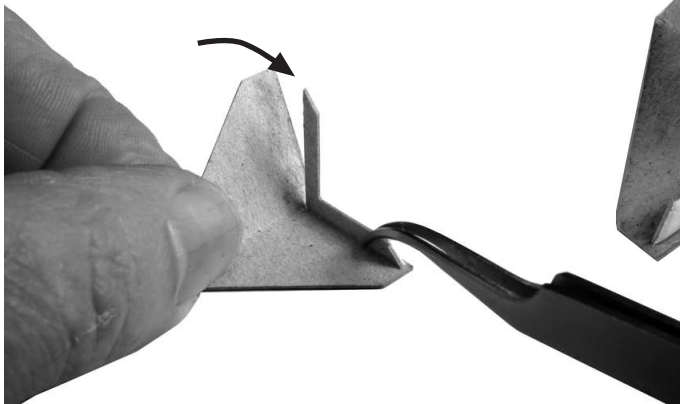

PUT TO ONE SIDE TO UNTIL GLUE HAS SET HARD.

Now attach TWO bargeboard spacers on top of each other on to the top of each window, flush with the top edges of the walls.

NOTE: There are 8 grey spacers and 8 white spacers in total in this kit, but they are all the same size and shape.



Fig. 12. CHIMNEY POTS.

Cut out the terracotta coloured strips below and roll tightly around a nail or drill bit (aprox. 4mm. dia.)

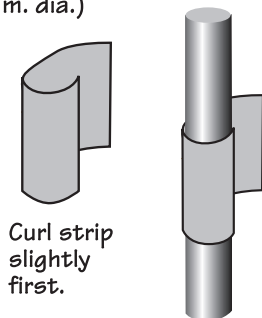

Roll up tight then unroll the end enough to smear with a little glue then roll back up and hold tight until fast.

Glue the two chimney top stones together as shown with the top one centred on the one below. When fast, attach the chimney pots.

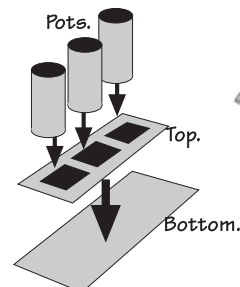
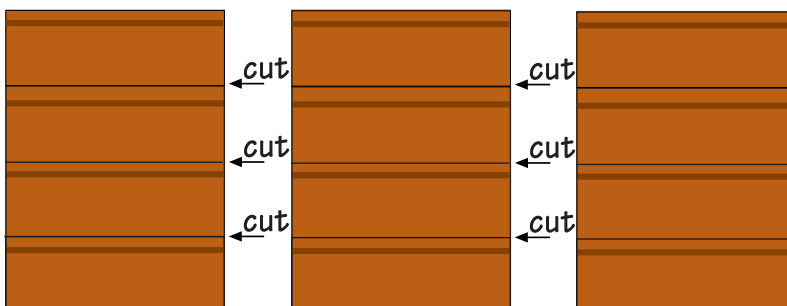

Put to one side so they can dry thoroughly.

PLEASE NOTE - once you have perfected the art of rolling your own chimney pots you will soon realise that they are extremely realistic. Much better than anything made from plastic or white metal. Please be patient & keep trying, the chimney pots make all the difference.

Fig. 15. OUTBUILDING.

Fold the outer walls around the base card in same way as you did with main building.
Fit the doors and windows.

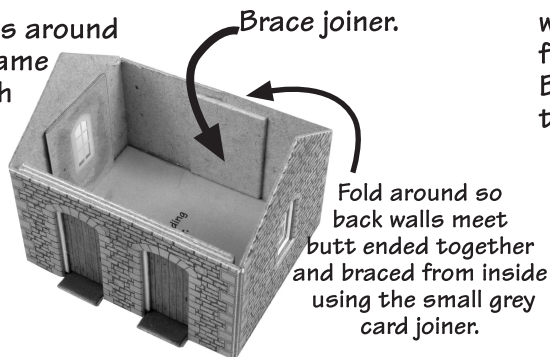

Fit the bargeboard spacers to the gable walls, flush with top edges, then fit the bargeboards BEFORE you fit the roof.

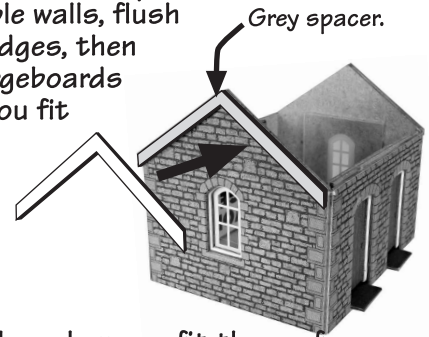

Now when you fit the roof it will overhang equally at each end,

Fig. 16. RIDGE TILE STRIPS.

Fitting the ridge tile strips (located on a small separate sheet) makes a world of difference to the finished look of your model. To fit simply run tiny spots of glue along the ridge and carefully lower the already folded and cut ridge tile strips on top.

You can also fit the chimney pots as well.



Fig. 17. CURTAINS (OPTIONAL).

For an added effect you can have a little bit of curtain showing down each side of the windows.

They are a little bit intricate to fit, and need to be fitted to the backs of the glazing after they have been attached to the window frames, (Fig. 1) but BEFORE they are fitted inside the building.

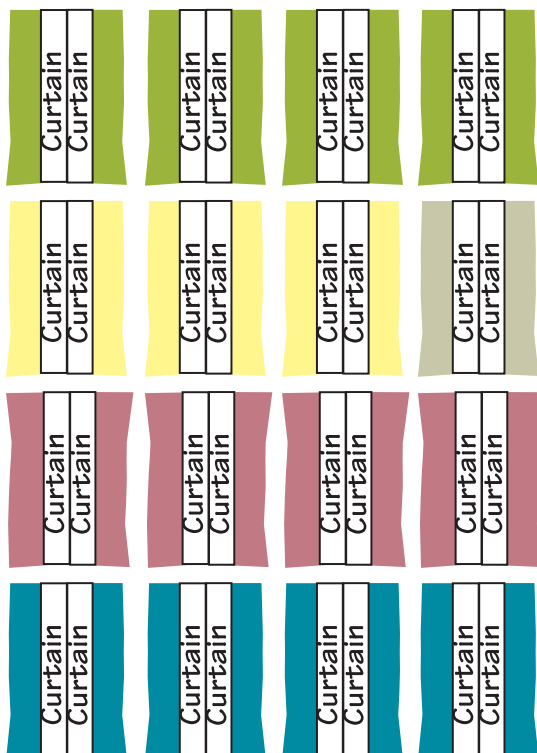
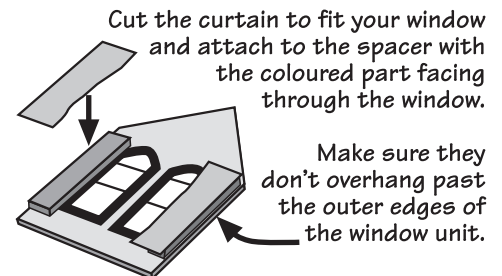
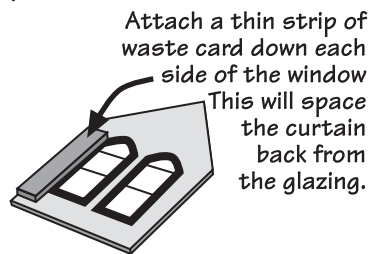

Alternative door styles and colours.

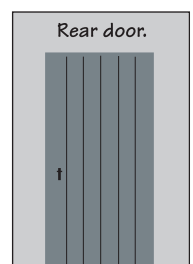
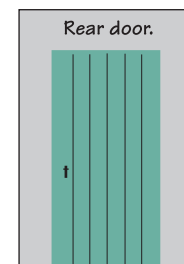
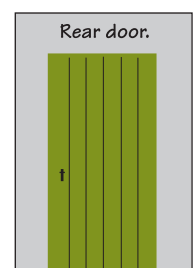
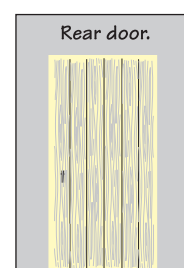
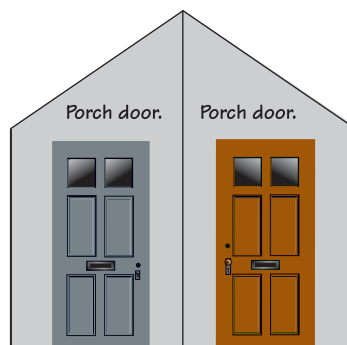

Stick the doors on top of the thick ready cut doors before attaching to buildings.

PO255 00/H0 WORKERS COTTAGES

Fig. 13. FIT THE DORMER ROOFS.

The roofs should sit in the correct position when pushed up against the bargeboard spacers. Place tiny spots of glue on the underside of the angled roof edges and on the tops of the bargeboard spacers. Hold firmly until the glue has set otherwise you may get gaps between the roof and back edges of dormer roof sections.



Fig. 14. LARGE BARGEBOARDS.

These fit onto the gable walls pushed up under the roof overhang. Start by fitting the spacers.

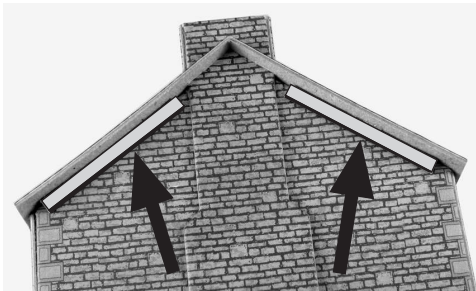

Cut two plain grey spacer strips to fit either side of the chimney stack up under the roof overhang.



Cut two slightly longer strips to fit over the first two spacers and the chimney.



Fit the bargeboard as shown, which should sit just nicely under the roof overhang.