

Fig. 13. MAIN ROOF SECTIONS.

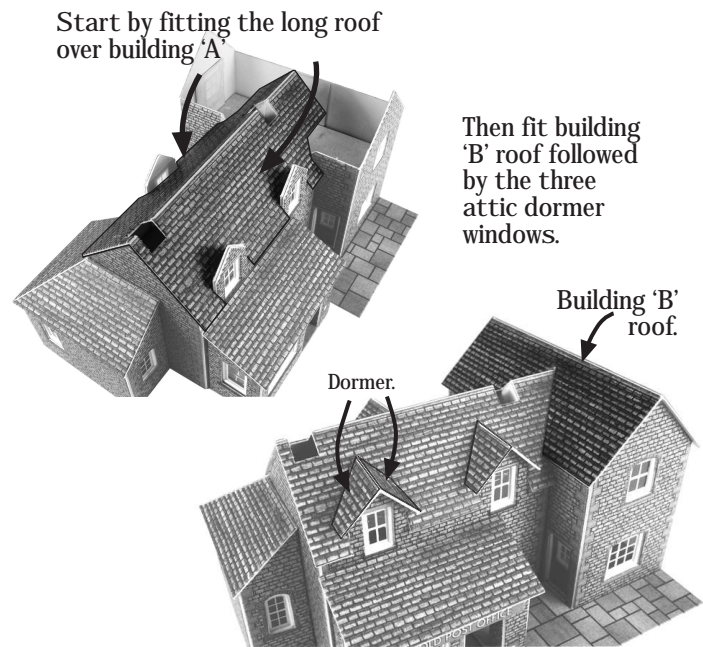
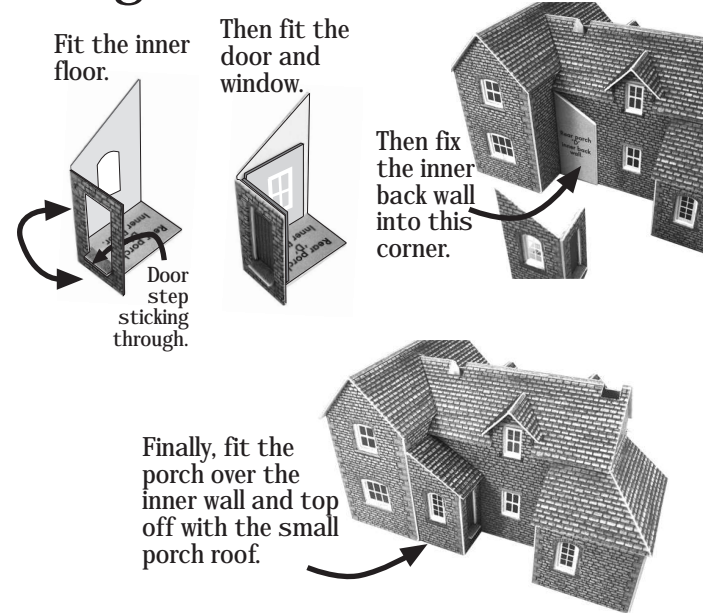

Fig. 14. REAR PORCH 'D'.



PN154 N Gauge VILLAGE SHOP & CAFE

READ THROUGH ALL THE INSTRUCTIONS BEFORE YOU START.

To construct this kit you will need the following:

1. A Modellers knife.
2. A pair of sharp pointed scissors.
3. A steel ruler.
4. Glue - UHU Clear Adhesive or Bostik Clear Adhesives are best.
5. A cutting surface - a sheet of card or a cutting mat.
6. Tweezers to hold the smaller components.

CHECK LIST

This kit pack should contain the following:

- 1 x SHEET A - All the printed components for the whole building.
- 1 x GREY SHEET - Inner strengthening components.
- 1 x GLAZING SHEET.
- 1 x INSTRUCTION SHEET 1.
- 1 x INSTRUCTION SHEET 2.
- 1 x Ridge Tile Sheet.

GETTING STARTED

1 EXTRACTING COMPONENTS FROM BASE SHEETS. To stop the components from falling off the sheets, they are held secure with scorelines. These are cuts that only go about 75% of the way through the card. To release them simply run the point of your knife along the scorelines and they will come seamlessly away. These scorelines are indicated with blue arrows: →

2 MAKE YOUR 'BUILDERS YARD'.

Use a piece of thick card or a tray to make your builders yard. This is an area kept away from your working surface where you store ALL the components extracted from the base sheets until needed. Your working area should have a clean flat surface, and should only contain the kit parts you are actually working on. EVERYTHING ELSE SHOULD BE KEPT NEATLY ARRANGED IN THE BUILDERS YARD, UNTIL NEEDED.

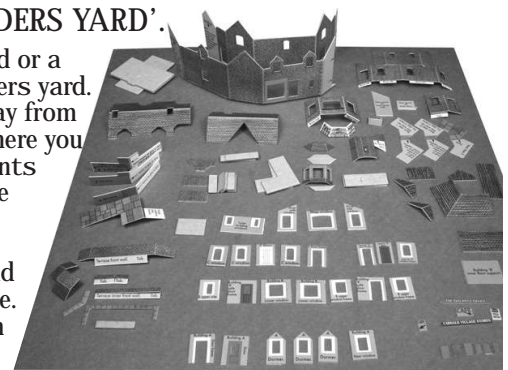

PLEASE NOTE: Don't throw anything away. Keep all offcuts and waste card in a box until the kit is finished, just in case you can't find anything. The chances are that it will be there.

Fig. 15. REAR STEPS.

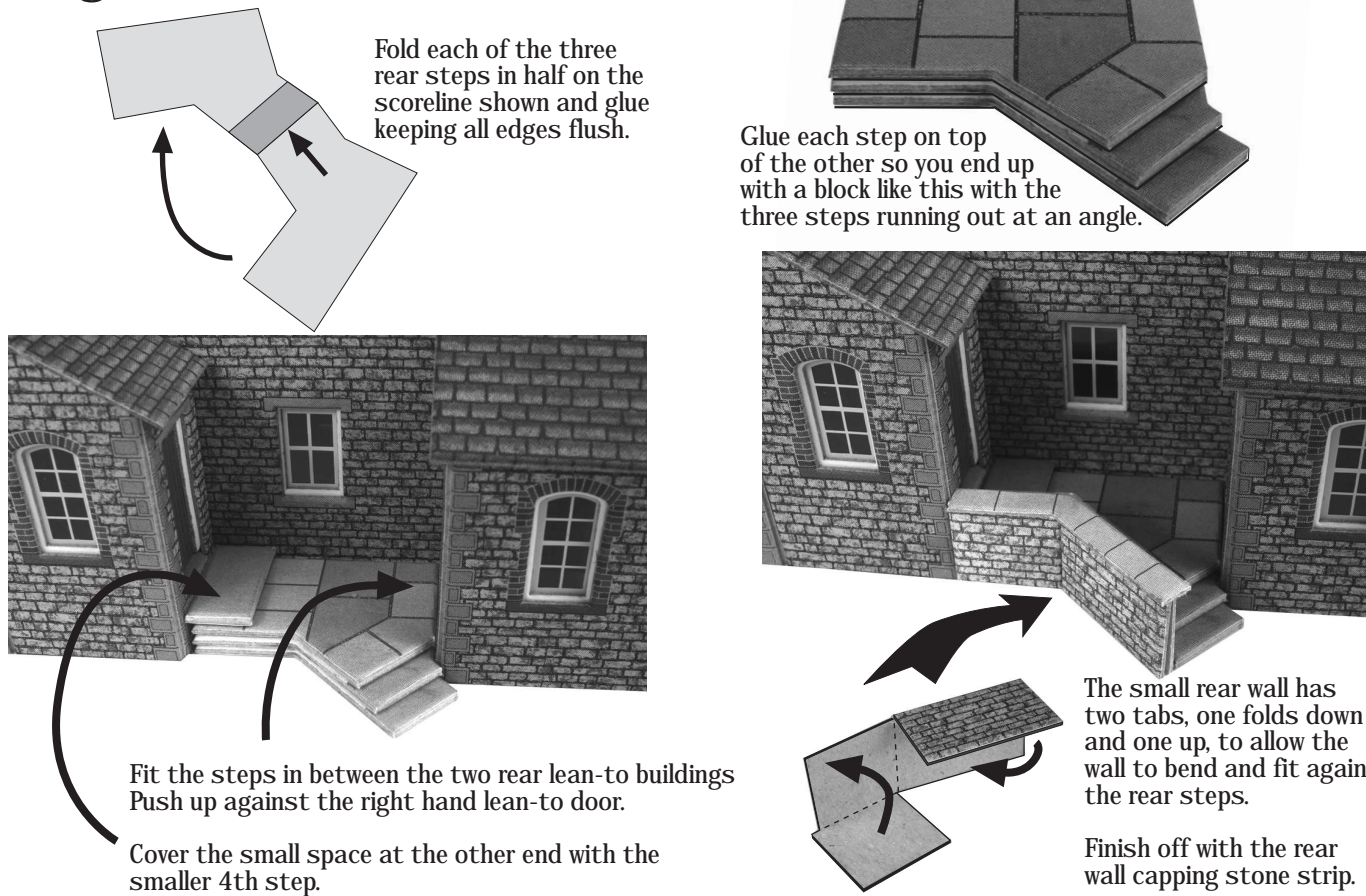
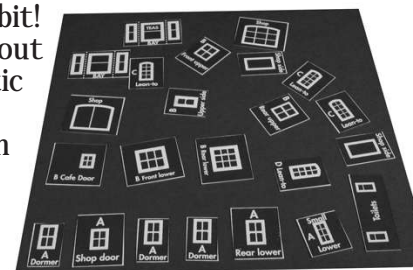

Fig. 1. START WITH THE WINDOWS.

This is the fiddly bit! Start by cutting out all the clear plastic window sections. Cut along the thin white lines that mark them out.



Place them on a dark surface so you can see them.

Fix each of the glazing sheets to the back of their corresponding inner window frames and doors, with the mat printed side facing through the openings.

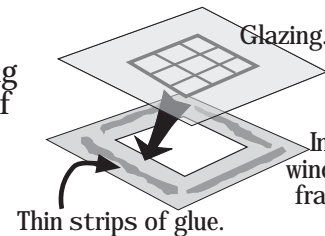

NOTE: 'A Small Lower' window for building 'A' has no window fram. It fits directly into the building.

Fix the doors to the door frames as well.

PLACE ALL COMPLETED DOORS AND WINDOWS BACK INTO THE BUILDERS YARD UNTIL NEEDED.

IF YOU ARE ADDING CURTAINS, DO IT NOW. See Fig.21.

Fig. 2. GREY CARD.

The thick grey unprinted sheet of card contains inner strengthening components to hold the kit together. The dotted lines indicate where you need to cut to release components from base sheet.

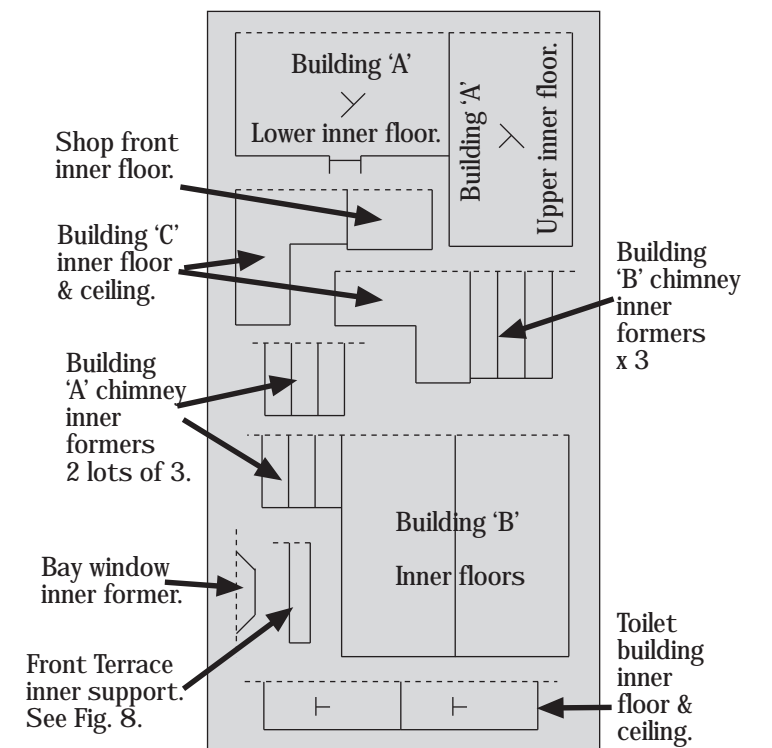

UHU GLUE TUBES

Although the 20ml. tubes of UHU have narrow nozzles, they are still a bit too big

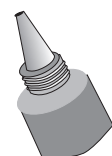

To make the nozzle smaller, put a piece of wire from a medium size paper clip or a large pin inside.

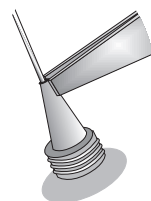

Then with a pair of pliers nip one side of the nozzle tightly, so that it squeezes the soft metal around the pin.

Keep the pin in the nozzle when not in use to stop it from blocking up.

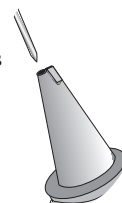

If using the glue frequently, it is not necessary to keep replacing the pin in the nozzle. To stop the glue running out, simply place the tube upright in an empty cup when not in use.

Fig. 3. BUILDING 'A'.

Along the base there are five yellow tabs. Fold around and glue to the back of the walls.

Fit the inner plain grey floor marked with a 'y' and a small tab on the long edge. Fit the floor so it sits on top of the yellow tabs of the front and gable walls.

Fit the small lower glazing to the small window next to the front door.

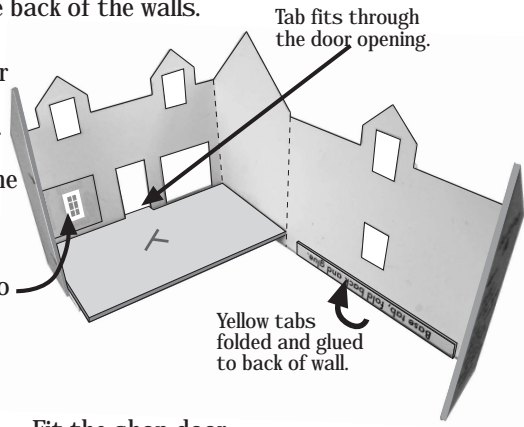

Fit the shop door sitting firmly down on the grey floor.

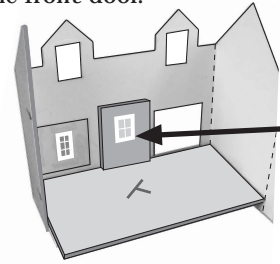

Yellow tabs folded and glued to back of wall.

Tab fits through the door opening.

Fig. 4. BUILDING 'A'. UPPER FLOOR & WINDOWS.

Fold the back wall around so that the two sections of the gable wall meet. Make sure the inner floor is sitting firmly down on all the yellow tabs, then fit the lower rear window.

The inner floor, marked with a 'y' is fixed inside, sitting on top of the door and rear window (keep it level).

Finally, fit the three pointed dormer windows.

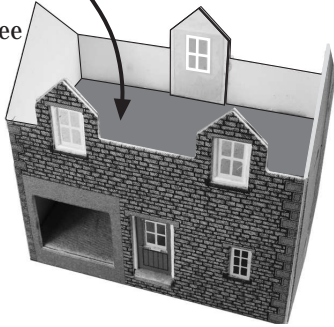
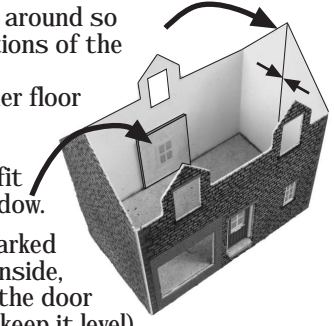
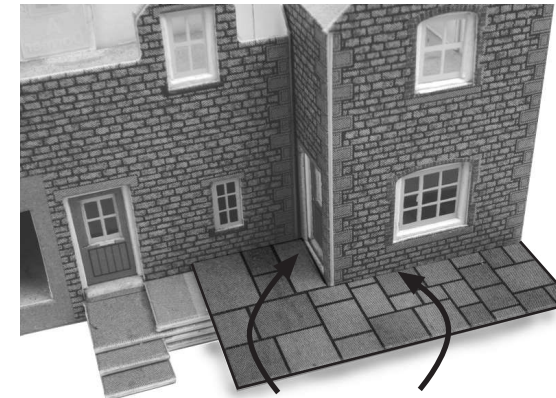

Fig. 9. FIT THE FRONT TERRACE.



The terrace base is also the last step up to the cafe door. Fold the yellow tab underneath and glue to the underside, then fix the base on to the top step, pushing it tight into the corner and up against the front wall on top of the green support. There is a wall to support the outer edges of the terrace but this is dealt with in Fig. 12.

Fig. 10. ENTRANCE CANOPY SUPPORT.

This is a stone pillar that supports the roof over the steps.

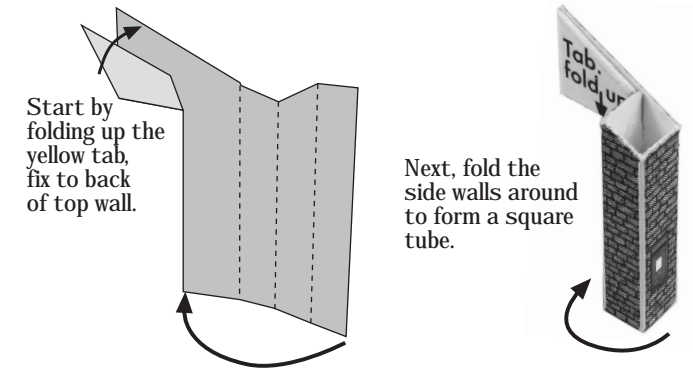

Start by folding up the yellow tab, fix to back of top wall.

Next, fold the side walls around to form a square tube.

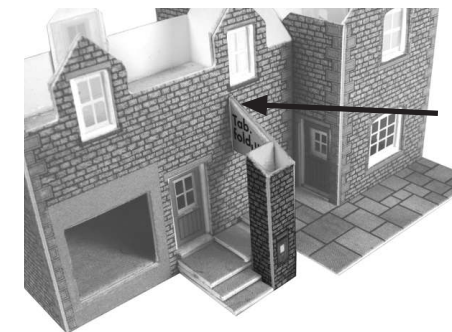

This now fits into the space between the steps and the terrace, with the top section fixed to the front wall of the building. Stand on a flat surface when fitting and hold tight until fast.

Fig. 5. BUILDING 'B'.

As with building 'A', fold the yellow base tabs over and glue to back of walls. Fit the lower inner grey floor so that it is sitting firmly down on the tabs.

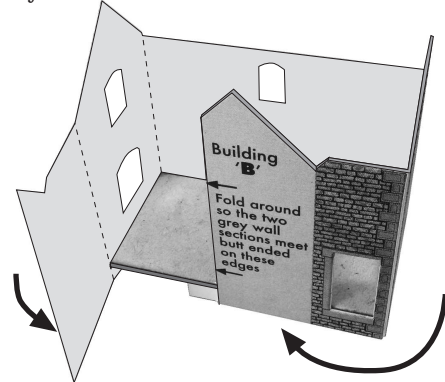

Fold the walls around in this order.

Fig. 6. UPPER FLOORS & WINDOWS.

Sit the upper floor on top of the lower windows and door. Next fit the three upper windows.

NOTE: When fitting any of the windows in this kit, make sure they are centred in the window openings when viewed from outside. If the inner floors are binding against them stopping them from going into place, simply cut a thin strip off with scissors. Test first without glue.

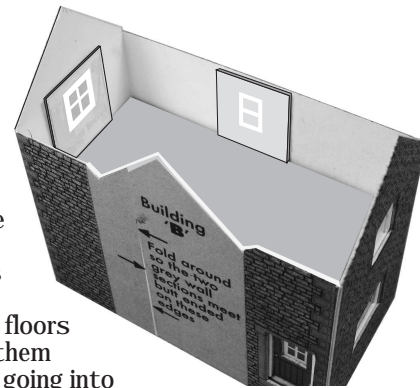
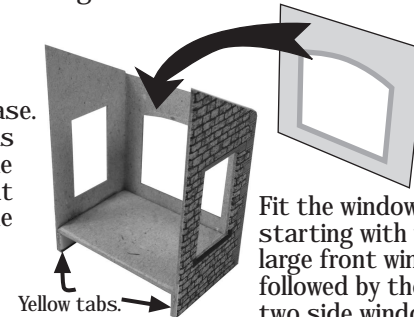

Fig. 11. SHOP FRONT.

The shop front window section is a small lean-to building with three sides.

Start by folding up the two yellow tabs along the base, then fold the walls around and fit the inner floor so that it is sitting on the yellow tabs.



Fit the windows next starting with the large front window, followed by the two two side window units.

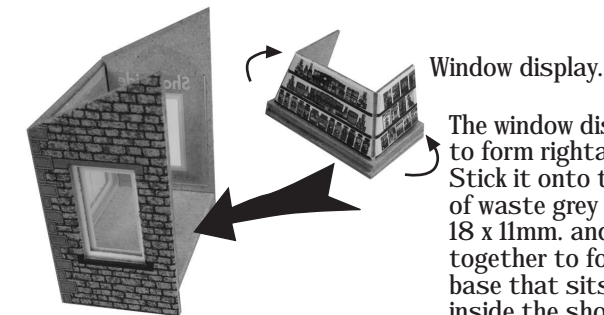

Window display.

The window display folds to form rightangles. Stick it onto two pieces of waste grey card cut to 18 x 11mm. and glued together to form a raised base that sits on the floor inside the shop window.



The shop front is now fixed to the front of the building up against the steps. When fast, fit the roof so that it overhangs equally at each side. Fix the sign across the front as shown.

Fig. 7. ATTACH BUILDINGS 'A' & 'B' TOGETHER.

Fasten the two grey gabled walls together so that the top edges fit flush. Stand on a flat surface and hold the two buildings tightly together until the glue has set.

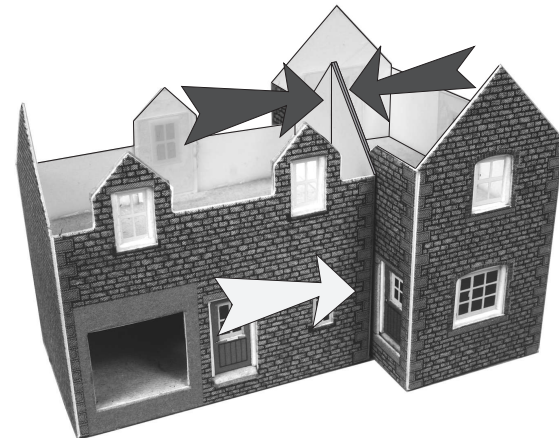
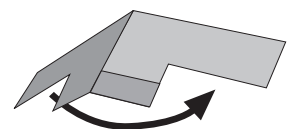
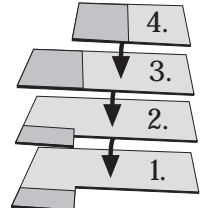

Fig. 8. FRONT STEPS.

There are four front steps. The first three lead up to the front door and the fourth turns towards the cafe door



Fold each step in half on the scoreline and glue to make double thickness.



Fix the steps one on top of the other. Keep all back and side edges flush.

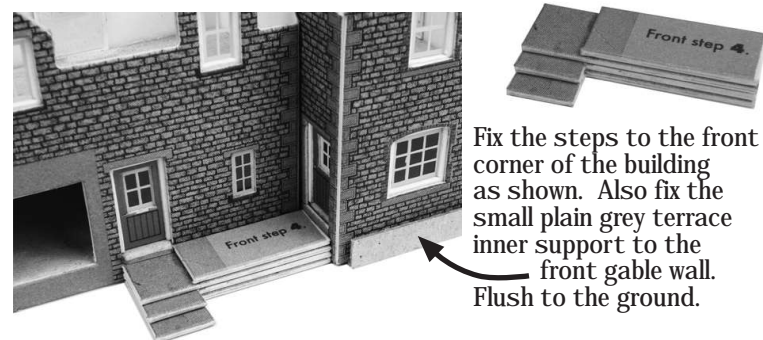

Fix the steps to the front corner of the building as shown. Also fix the small plain grey terrace inner support to the front gable wall. Flush to the ground.

Fig. 12. LEAN-TO BUILDING 'C'.

Fold back the yellow tabs and glue. Then fold the walls around and attach the L shaped plain grey inner floor so it sits firmly down on the tabs.

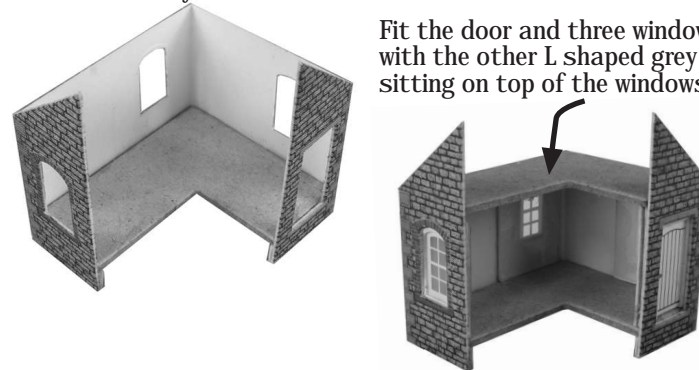

Fit the door and three windows followed with the other L shaped grey inner card sitting on top of the windows and door.

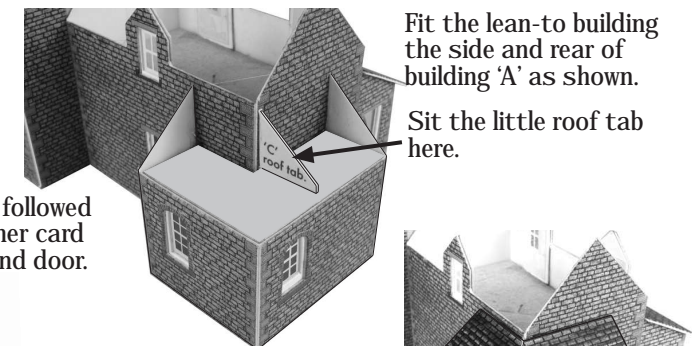

Fit the lean-to building the side and rear of building 'A' as shown.

Sit the little roof tab here.

Fit the roof

PN154 N Gauge VILLAGE SHOP & CAFE

SHEET 2

Fig. 19. CHIMNEY STACKS.

To make each chimney stack, start by gluing 3 of the grey former cards together, keeping all edges flush and at rightangles to form a solid block.

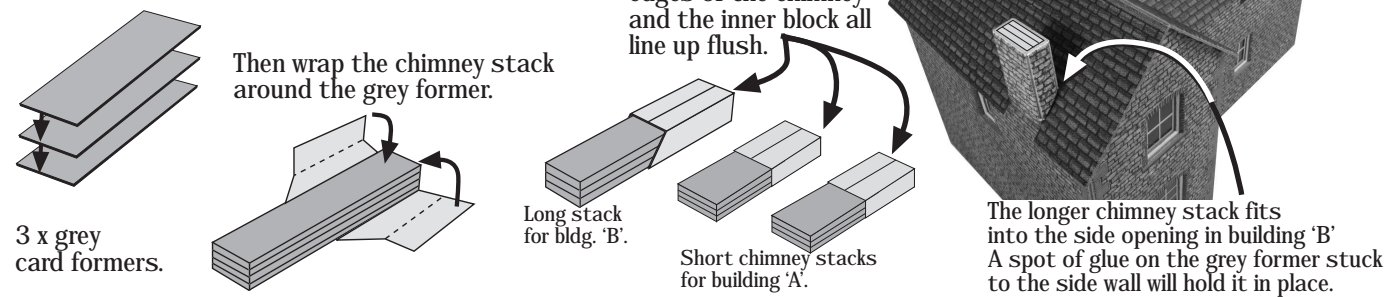

Fig. 20. RIDGE TILES & SIGNS.

To finish the roof off properly, the ridge tile strips enhance the kit greatly and brighten it up a lot. Cut each strip to fit, then locate the scoreline along the centre and fold to fit the ridge of each roof. Fix with tiny spots of glue place along the ridges.

Use the grey strips cut in half long ways as flashing



Fig. 21. CURTAINS (OPTIONAL).

For an added effect you can have a little bit of curtain showing down each side of the windows. They are a little bit intricate to fit, and need to be fitted to the backs of the glazing after they have been attached to the window frames, (Fig. 1) but BEFORE they are fitted inside the building.

Start by cutting two strips of the waste grey card and fix down either side of the window.

To make your curtains cut tiny strips of coloured paper from an old magazine

Cut the curtain to fit your window and attach to the spacer with the coloured part facing through the window.

Make sure they don't overhang past the outer edges of the window unit.

Coloured strips cut from old magazine which gives you a good choice of colours and shades.

Fig. 22. CHIMNEY POTS.

Cut out the terracotta coloured strips below and roll tightly around a nail or drill bit (aprox. 2mm. dia.)

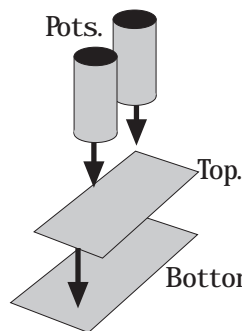
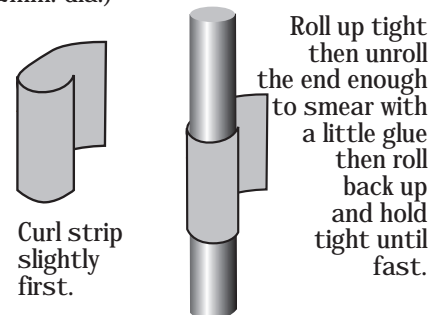

Glue the two chimney top stones together as shown with the smaller top centred on the one below. When fast, attach the chimney pots and set to one side to dry thoroughly.

PLEASE NOTE - once you have perfected the art of rolling your own chimney pots you will soon realise that they are extremely realistic. Much better than anything made from plastic or white metal. Please be patient & keep trying, the chimney pots make all the difference.

Fig. 16. BAY WINDOW (OPTIONAL).

This is an optional extra, but if you are going to fit it, this is what to do:

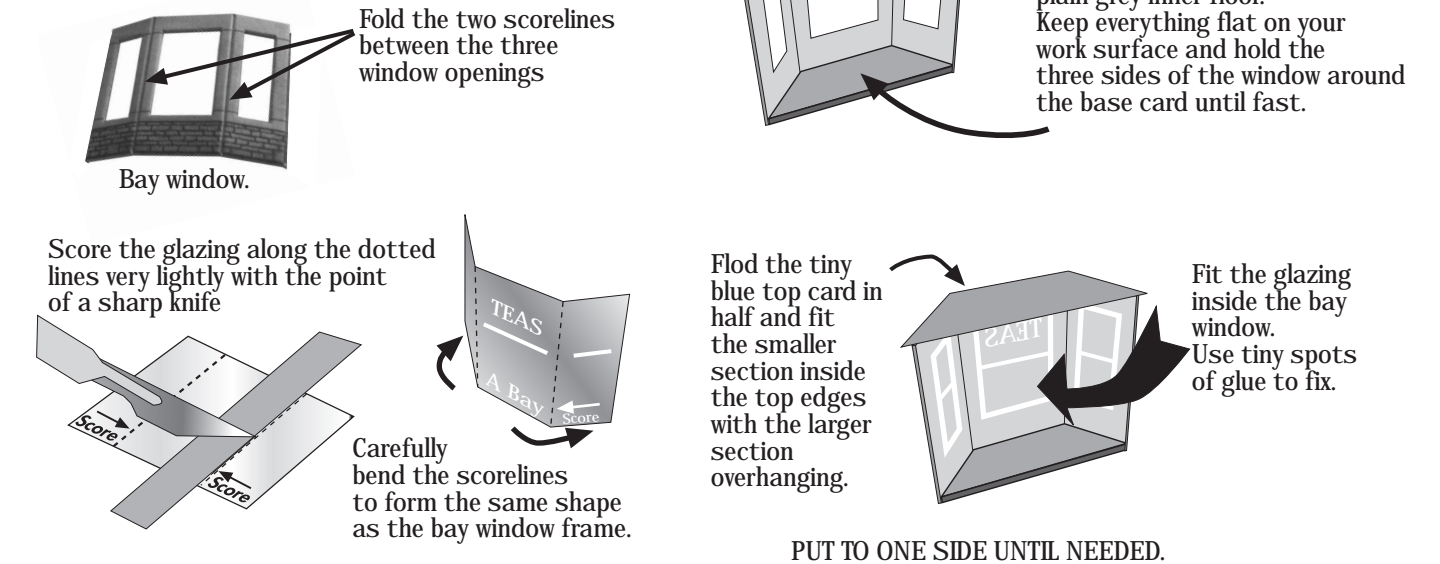

Fig. 17. FRONT TERRACE WALLS.

There are three inner walls and one outer. All have green tabs that fold back and glue.

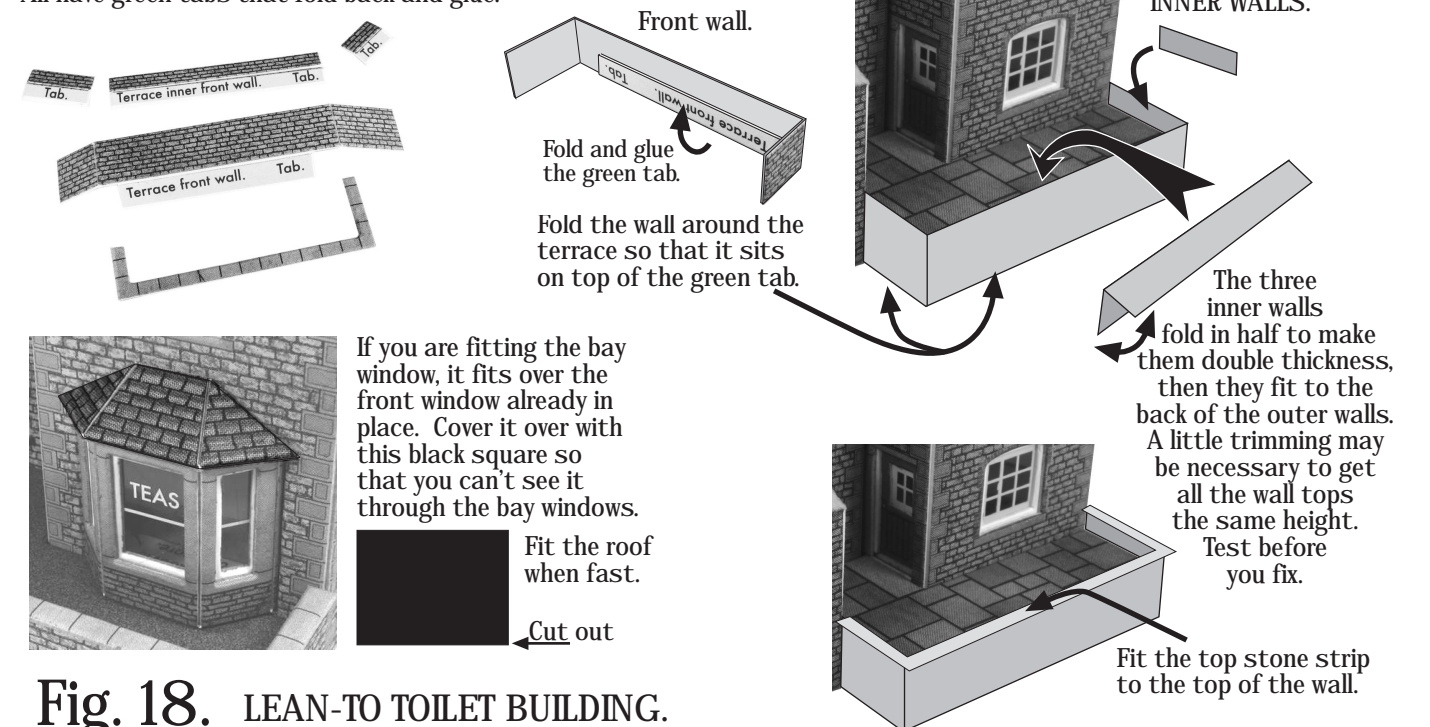

Fig. 18. LEAN-TO TOILET BUILDING.

