

# PO254 00/HO VILLAGE SHOP & CAFE

# SHEET 1

## READ THROUGH ALL THE INSTRUCTIONS BEFORE YOU START.

To construct this kit you will need the following:

1. A Modellers knife.
2. A pair of sharp pointed scissors.
3. A steel ruler.
4. Glue - UHU Clear Adhesive or Bostik Clear Adhesives are best.
5. A cutting surface - a sheet of card or a cutting mat.
6. Tweezers to hold the smaller components.

### PLEASE NOTE

Each component is fastened to the sheet by means of a score line. These are cut lines that have only gone about three quarters of the way through the card.

To detach each component from the sheet, locate the score line (usually indicated with blue arrows) and run the point of a knife carefully along the scoreline until the part is free from the backing sheet.

**CAUTION** - be very careful when running the point of your knife along these score lines, it is easy to run out of the groove and cut something you shouldn't.

## Your Work Surface

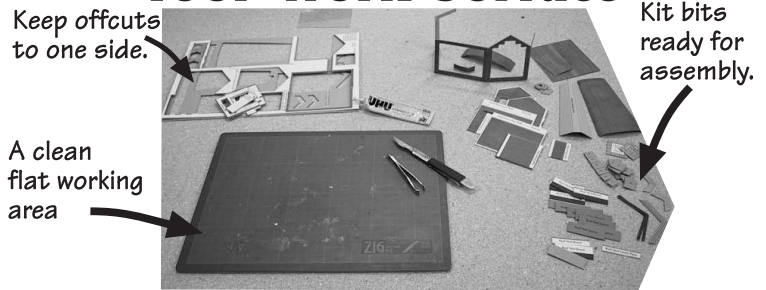

Keep it tidy. When you have extracted all the components from the sheet, place them in neat piles, FACE UP on sheets of thick card, so you can move them around as needed. Write a brief description on the back of any components that don't have it printed on as you remove from backing sheet. TAKE CARE WITH SMALL COMPONENTS PLACE MULTIPLES IN PILES TOGETHER. DON'T THROW ANYTHING OUT. Offcuts can come in handy for bracing etc. and it also reduces the risk of accidentally throwing anything away.

### CHECK LIST

- This kit pack should contain the following:
- 1 x SHEET A - Building 'A' and the windows and doors.
  - 1 x SHEET B - Building 'B', Roofs and Lean-to etc.
  - 1 x GREY SHEET - Inner strengthening components.
  - 1 x GLAZING SHEET.
  - 1 x INSTRUCTION SHEET 1.
  - 1 x INSTRUCTION SHEET 2.
  - 1 x Ridge Tile Sheet.

## Fig. 1. START WITH THE WINDOWS.

This is the fiddly bit!

Start by cutting out all the clear plastic window sections. Cut along the thin white lines that mark them out.

Lay them all out on a piece of dark card, so that you can see them all.

Fix each of the glazing sheets to the back of the inner window frames with the mat printed side facing through the openings.

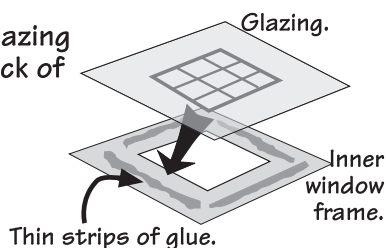

Do not fix the bay window glazing yet.

Note: 'B' small lower window doesn't have a window frame.

Fix the doors to the door frames as well. Lay out all the window units and doors on a sheet of card until needed.

## Fig. 2. GREY CARD.

The thick grey unprinted sheet of card contains inner strengthening components to hold the kit together.

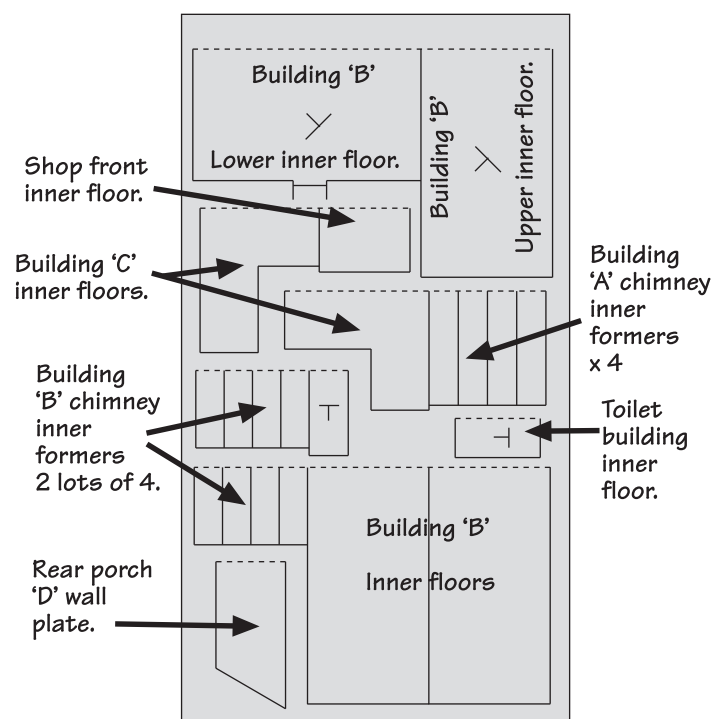

### Fig. 3. BUILDING 'A'.

Fold the corners to loosen them up, then fold over the four yellow tabs and glue them to the back of the walls.

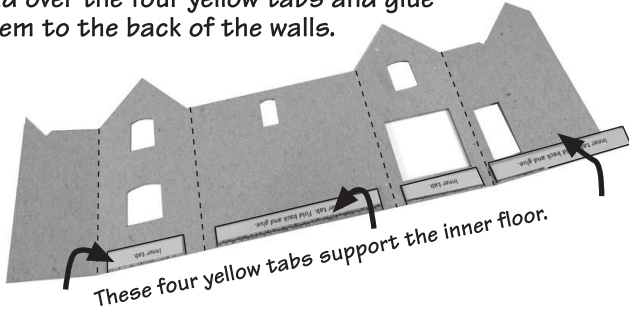

Fold the three walls shown around the grey inner floor. Making sure the floor is pushed firmly down onto the three yellow tabs.

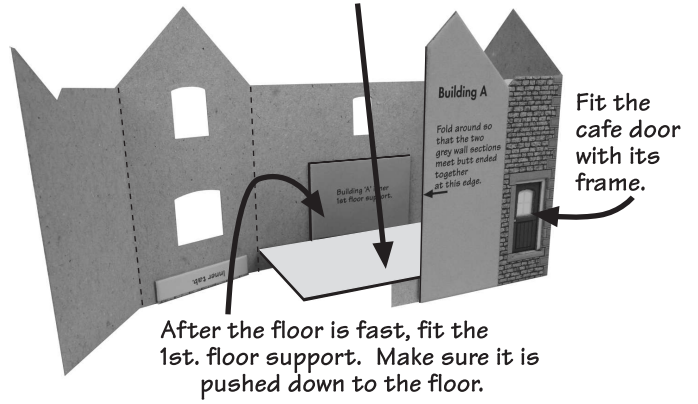

Fold the other two walls around and fix to the inner floor.

Then fit the rear lower window.

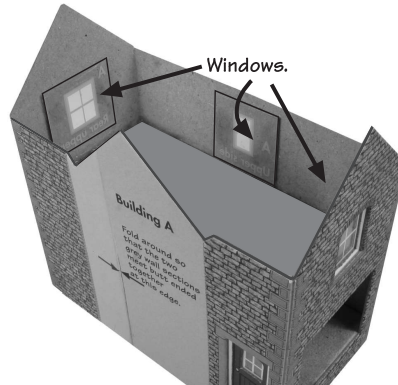
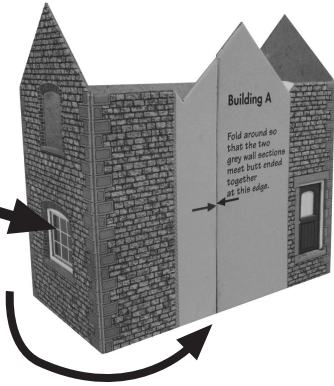

Fit the upper inner floor. Fit firmly down on top of the door, window and grey floor support.

Next, fit the three upper windows, then put the building to one side and go to building 'B'.

### Fig. 4. BUILDING 'B'.

In the same way as building 'A' fold the 5 yellow tabs back and glue to backs of walls.

Fit the inner floor marked with a 'Y' and a small tab on the long edge. Fit the floor so it sits on top of the yellow tabs of the front and gable walls. Fit the small lower glazing to the small window next to the front door.

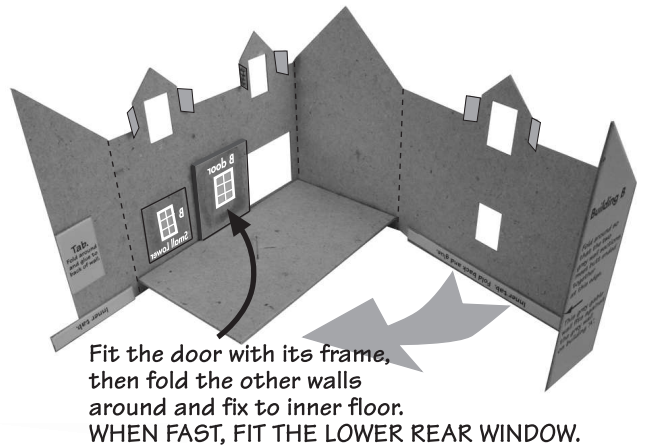
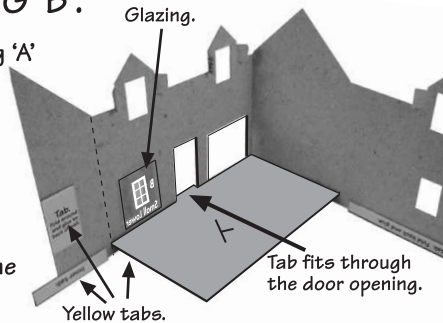

Fit the floor so it sits on top of the door and window. When in position run a small squirt of glue around its edges to fix.

Fit the three dormer windows. Make sure the side tabs can be folded back at rightangles.

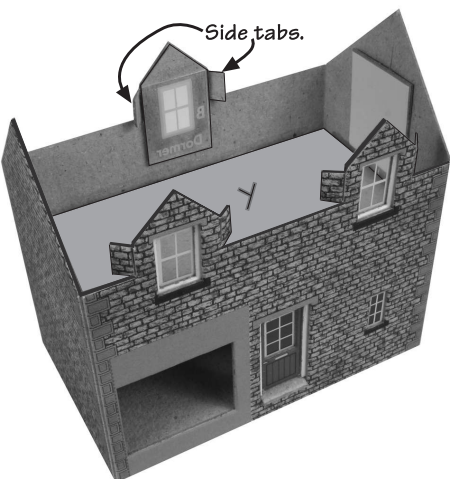

### Fig. 5. ATTACH BUILDINGS 'A' & 'B' TOGETHER.

Fasten the two grey gabled walls together so that the top edges fit flush. Stand on a flat surface and hold the two buildings tightly together until the glue has set.

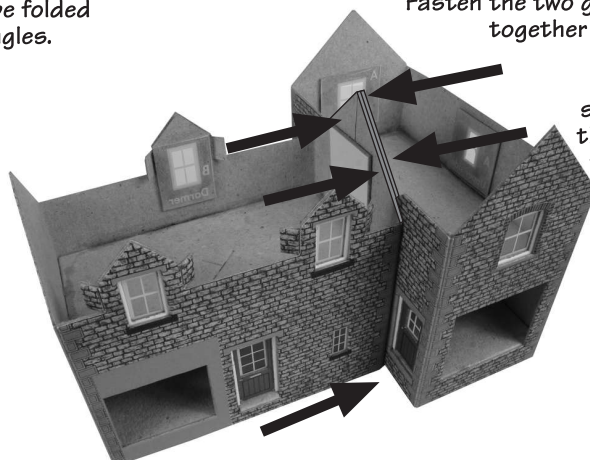

## Fig. 6. ROOFS.

Fit the roof to building 'B' first. Glue firmly on to the gable tops and the front and rear walls.

Fold the little side tabs back on the dormer windows as you fit it. They don't need any glue.

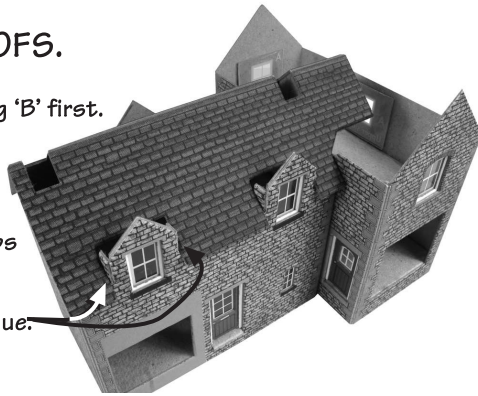

Fit the three dormer roofs.

The roof for building 'A' fits over the top of the other roof on building 'B'.

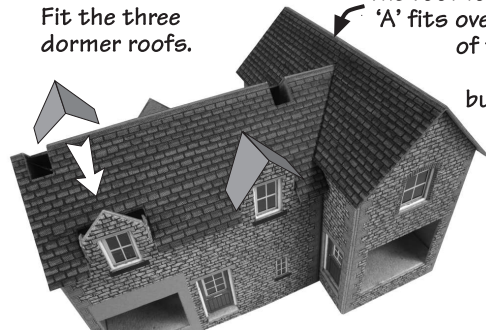

## Fig. 7. FRONT STEPS.

There are four front steps. The first three lead up to the front door and the fourth turns towards the cafe door.

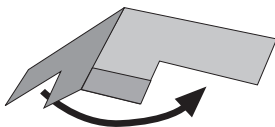

Fold each step in half on the scoreline and glue to make double thickness.

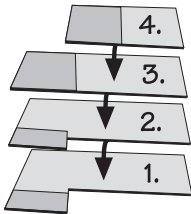

Fix the steps one on top of the other. Keep all back and side edges flush.

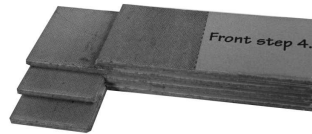

The steps now fit into the front corner between the two doors.

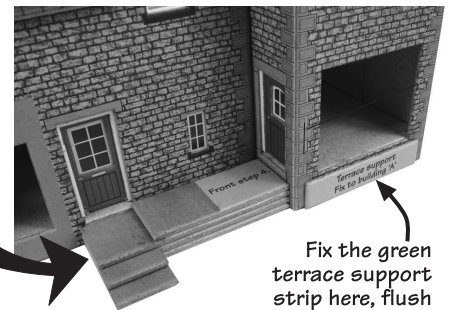

Fix the green terrace support strip here, flush with bottom edge of building wall.

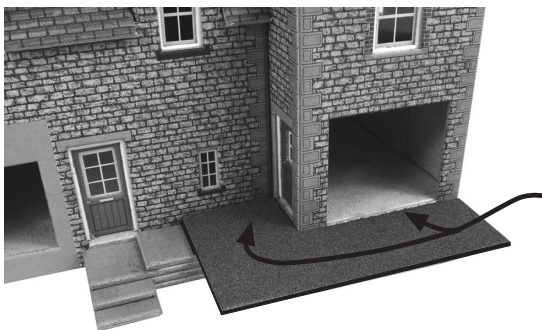

The terrace base is also the last step up to the cafe door. Fold the yellow tab underneath and glue to the underside, then fix the base on to the top step, pushing it tight into the corner and up against the front wall on top of the green support. There is a wall to support the outer edges of the terrace but this is dealt with in Fig. 10.

## Fig. 8. SHOP ENTRANCE ROOF SUPPORT.

This is a stone pillar that supports the roof over the steps.

Start by folding up the yellow tab, fix to back of top wall.

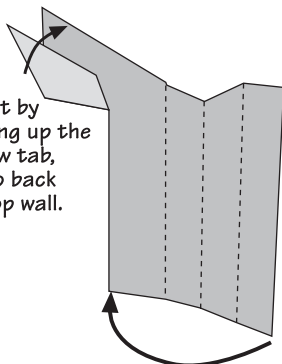

Next, fold the side walls around to form a square tube.



This now fits into the space between the steps and the terrace, with the top section fixed to the front wall of the building. Stand on a flat surface when fitting and hold tight until fast.

## Fig. 9. SHOP FRONT.

The shop front window section is a small lean-to building with three sides.

Start by folding up the three yellow tabs along the base, then fold the walls around and fit the inner floor so that it is sitting on the yellow tabs.

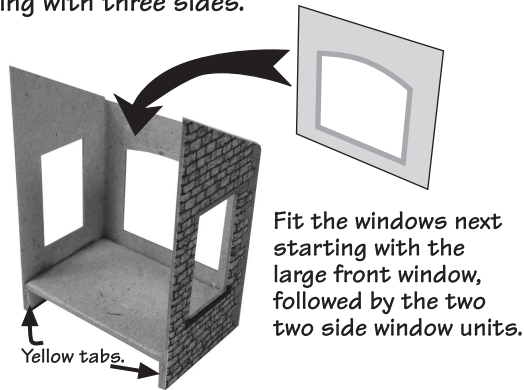

The window display folds to form rightangles. Stick it onto three pieces of waste grey card cut to

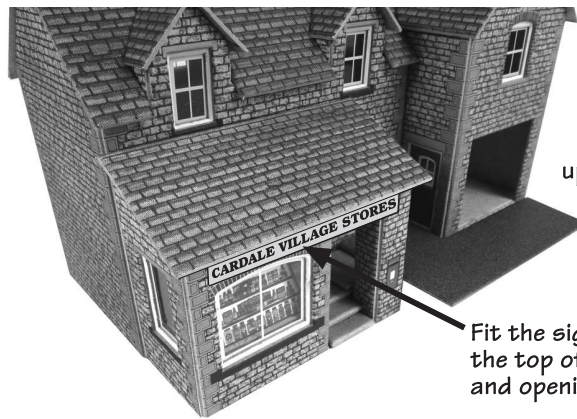
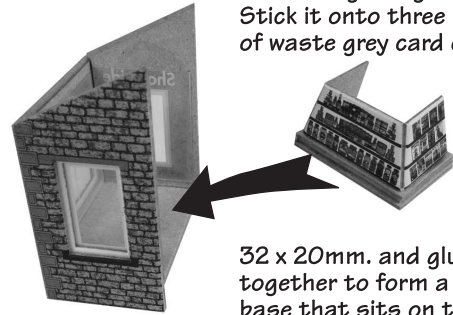

## Fig. 10. TERRACE WALLS.

