

PN170 N Gauge LOW RELIEF CINEMA

SHEET 1

READ THROUGH ALL THE INSTRUCTIONS BEFORE YOU START.

To construct this kit you will need the following:

1. A Modellers knife.
2. A pair of sharp pointed scissors.
3. A steel ruler.
4. Glue - UHU Clear Adhesive or Bostik Clear Adhesives are best.
Plastic Glue for the steps.
Make sure you get the tubes with the narrow nozzle for easy application.
5. A cutting surface - a sheet of card or a cutting mat.
6. Tweezers to hold the smaller components.

PLEASE NOTE

Each component is fastened to the sheet by means of a score line.

These are cut lines that have only gone about three quarters of the way through the card. To detach each component from the sheet, locate the score line that is holding it in place.

(most of these are clearly marked with blue arrows) and carefully run the point of your knife along the scoreline and the item will come seamlessly away.

CAUTION - be very careful when running the point of your knife along these score lines, it is easy to run out of the groove and cut something you shouldn't.

Your Work Surface

Keep offcuts to one side.

A clean flat working area

Kit bits ready for assembly.

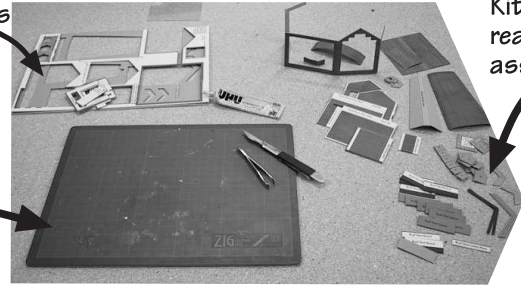

Keep it tidy. When you have extracted all the components from the sheet, place them in neat piles, FACE UP on sheets of thick card, so you can move them around as needed. TAKE CARE WITH SMALL COMPONENTS PLACE MULTIPLES IN PILES TOGETHER. DON'T THROW ANYTHING OUT. Offcuts can come in handy for bracing etc. and it also reduces the risk of accidentally throwing anything away.

CHECK LIST This kit pack should contain the following:

- 1 x KIT SHEET - Main building walls and windows.
- 1 x GREY SHEET - Inner strengthening components.
- 1 x GLAZING SHEET.
- 1 x INSTRUCTION SHEET.
- 1 x Ridge Tile Sheet.

Fig. 1. WINDOWS.

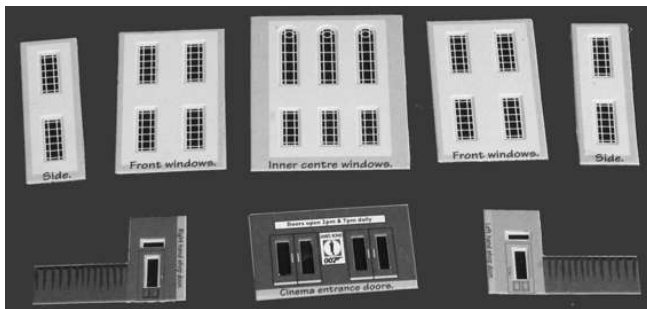

Before you do anything else, start by cutting out all the glazing components and carefully attach each one to the corresponding window opening. Except the shop windows which are dealt with in Fig.2. Place tiny spots of glue on the back of the card window opening sheets.

Small amount of glue placed near the edges. Not too much as it may ooze over the edges.

Fit the glazing so that the matt printed side faces through the openings.

Complete ALL the windows and put to one side until needed.

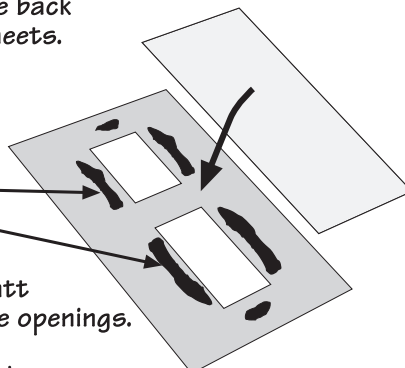

PLAIN THICK GREY CARD SHEETS.

There is a sheet of thick unprinted grey die cut card that contains components that are used within the kit to strengthen it.

Note: The dotted lines shown are the half cuts that hold the components on the sheet.

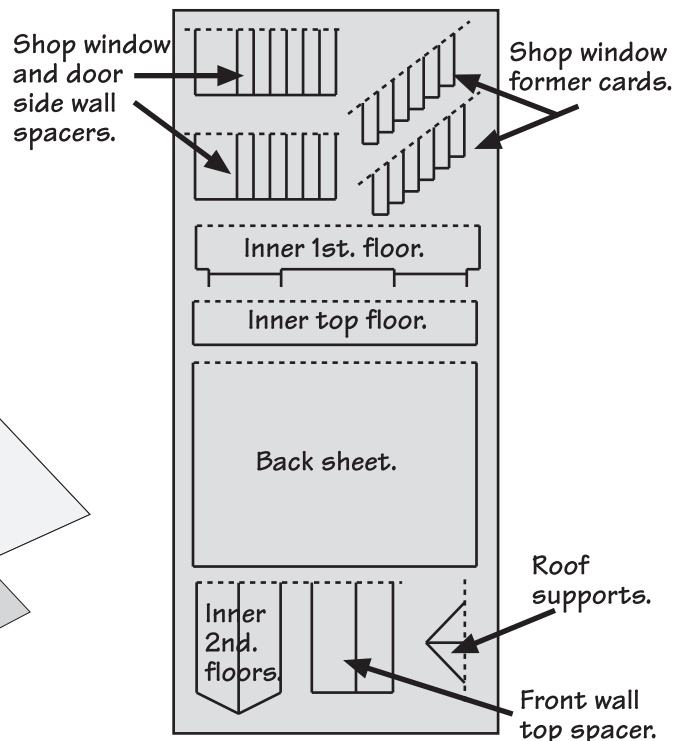
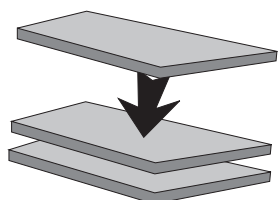

Fig. 2. SHOP WINDOWS.

Glue three of the grey card window formers together to form a solid block



Make sure all edges are flush

Repeat this with all the cards so that you end up with four block like this.

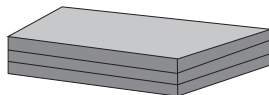

Bend the glazing to fit the grey former and fix as shown.

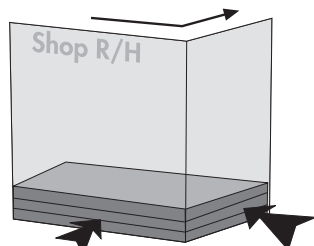

Stand on a flat surface and hold tight against the grey former until fast

Fit the upper former next (turn over and fit in the same way, on a flat surface).

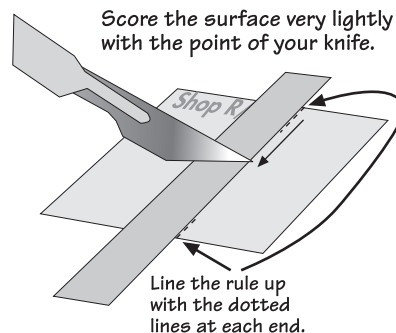
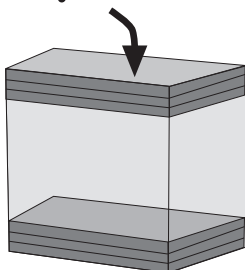

Next, fit the right hand window frame. Make sure it is fitted up against the glazing on all edges. Stand on a flat surface and hold tight until fast.

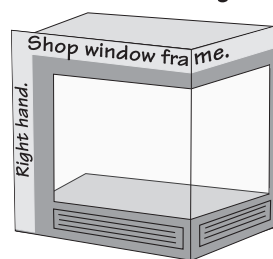

Fit tightly into the corner.

Fig. 3. WINDOW & DOOR SIDES.

Glue three of the grey window spacers together and fit into the space at the end of the window.

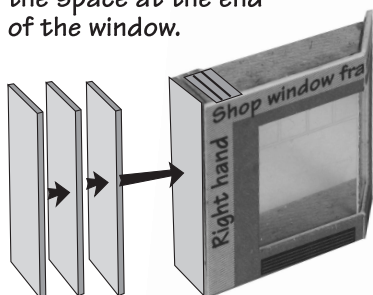

The door side, start by gluing together three short spacers and then the wide spacer

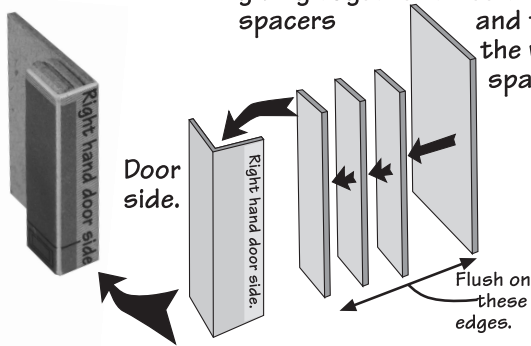

When the grey spacers are set. Fix the unit inside the folded door side.

Fit the door. Push end into corner.

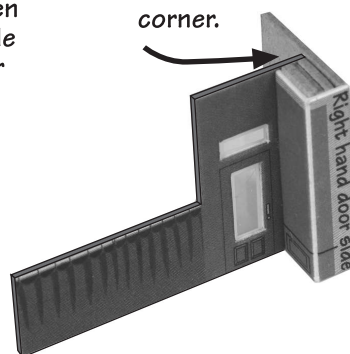

NOW BUILD THE LEFT HAND WINDOW UNIT IN JUST THE SAME WAY.

Fig. 4. FIT SHOP WINDOW INSIDE THE BUILDING.

Start by fitting the window unit up against the cinema entrance side wall. The top fixes to the thin band of card below the horizontal slot in the front wall.

Stand on flat surface when fitting.

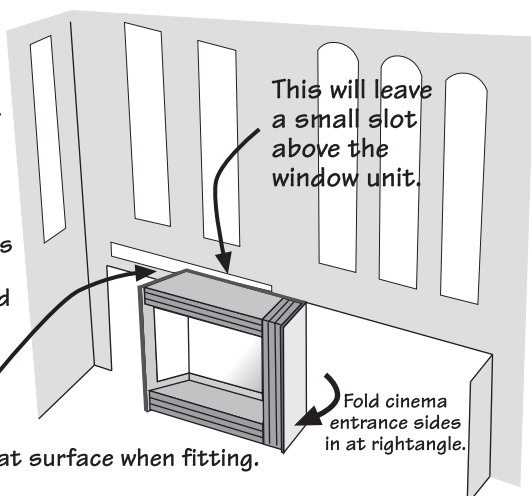

This will leave a small slot above the window unit.

Fold cinema entrance sides in at right angle.

The door unit is now fitted into the opposite corner with the window display back piece fixed along the base of the window unit.

Repeat with the left hand window.

Note: this little groove is to accommodate the back wall.

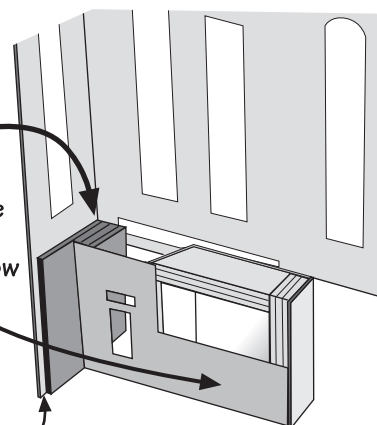

Fit window display of your choice leaning against curtains.

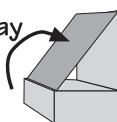
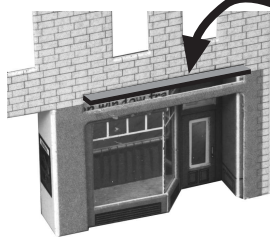

Fig. 5. INNER FLOORS AND WINDOWS.

Start by fitting the inner 1st. floor card.
Note: the two long tabs slot through the openings above the shop windows. Push through so that the recessed edges fit up against the main wall.



The tabs stick through the wall to support the shop signs when fitted.

Inner 1st. floor.

Cinema doors.

When the floor is fast, fit the cinema door unit then fix the five inner windows so they line up with the outer openings.
Note: they sit directly onto the 1st. floor.

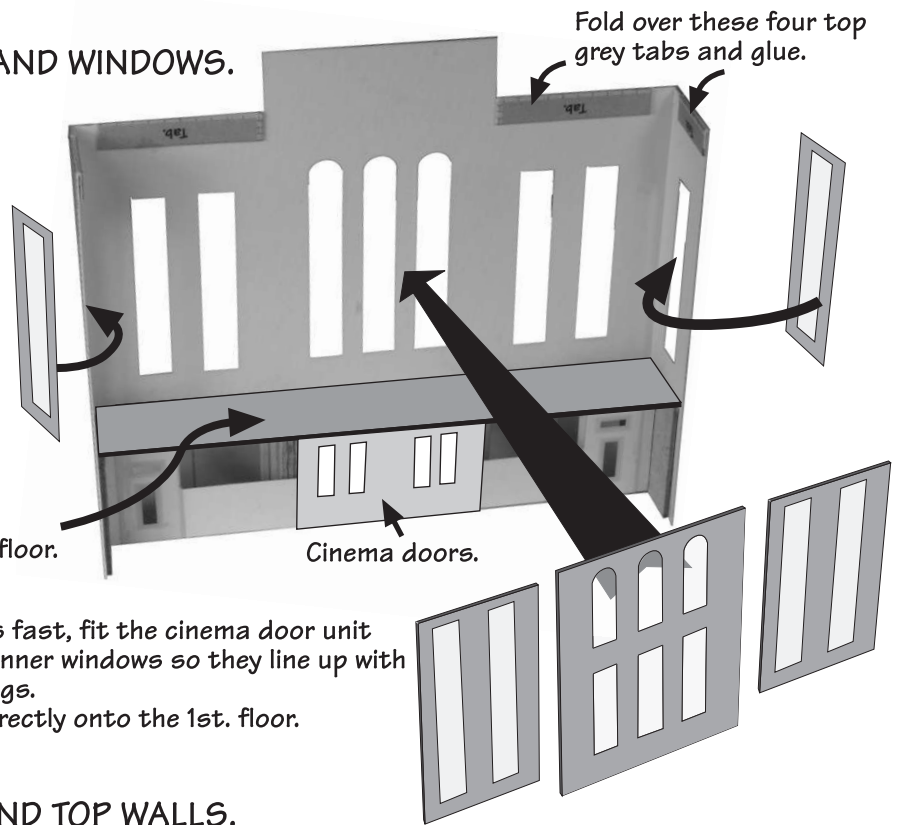
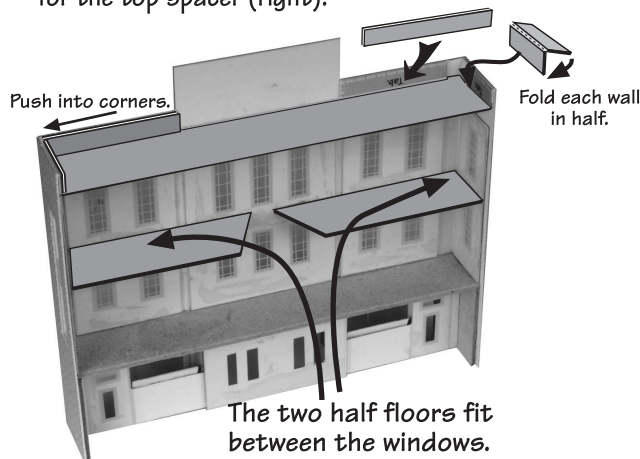

Fig. 6. UPPER FLOORS AND TOP WALLS.

Fold the four top inner wall strips in half along the centre scorelines and attach to the grey tabs, flush with the wall tops. FIT THE LONG FRONT WALLS FIRST make sure they fit tight into the corners to allow room for the top spacer (right).



The two half floors fit between the windows.
The top floor sits on top of the centre windows and up against the four grey tabs

Front wall top spacer

Fit the backing card

Fold the small grey spacer in two and fit to the back of the tall centre wall. The recessed strip should run along the base, to allow the roof to fit in.

Fig. 8. CORNER & CENTRE STONE STRIPS.

Fig. 7. CINEMA STEPS.

There are three steps that each fold in half and glue back to back to make double thick steps. Glue them one on top of the other making sure that the back and side edges and sides are lined up flush.

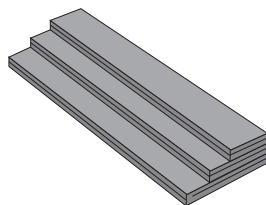

When fast, fit the steps into the opening up against the doors after the base card has been fitted.

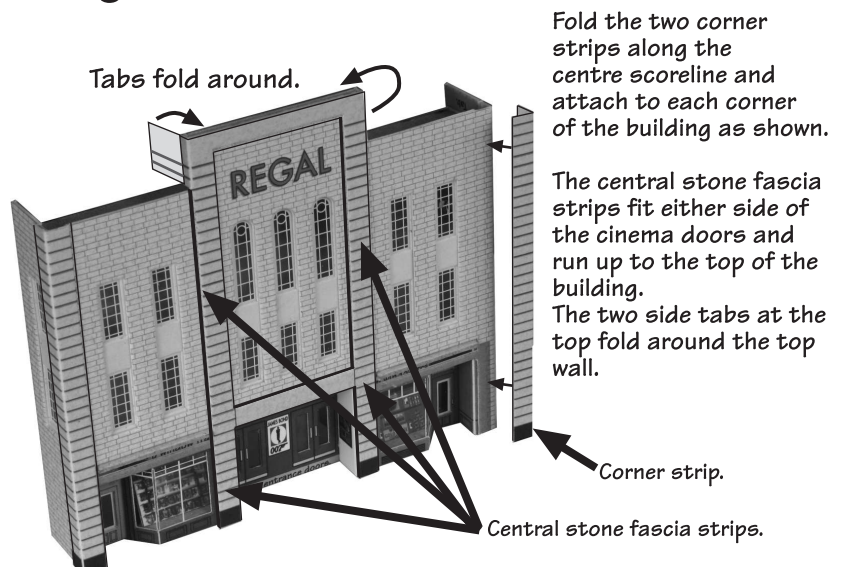

Fold the two corner strips along the centre scoreline and attach to each corner of the building as shown.

The central stone fascia strips fit either side of the cinema doors and run up to the top of the building. The two side tabs at the top fold around the top wall.

Corner strip.

Central stone fascia strips.

Fig. 9. CINEMA CANOPY.

Fold over and glue the black part of the entrance top.

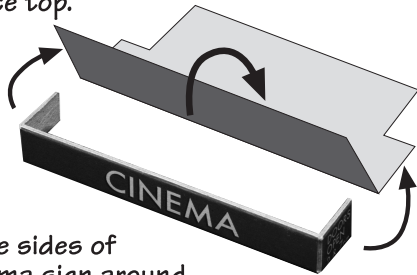

Wrap the sides of the cinema sign around the top unit. Keep on a flat surface.

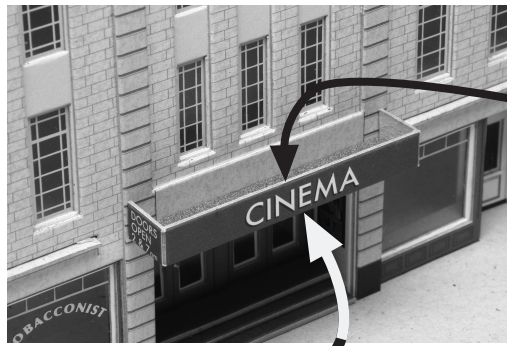

Top strip is then fixed on to the canopy.

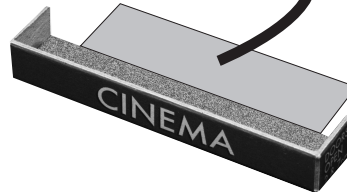

The tab part of the entrance canopy slots in the doorway and is fixed to the underside of the inner floor.

Fig. 10. ROOF.

The roof is simple to fit. Fold down the two triangular sections at each end and place tiny spots of glue around the base. Sit the roof on top of the upper grey floor and push the bottom edges up against the front and side walls.

Insert the two roof braces.



PROJECTION ROOM ROOF.

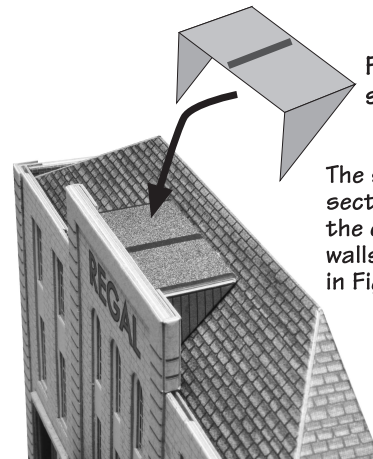

Fold down sides.

The small centre roof section fits in between the ends of the fascia walls that folded around in Fig. 8.

Fit the capping stones

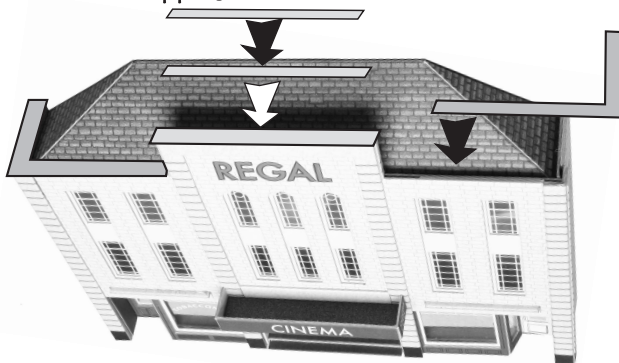
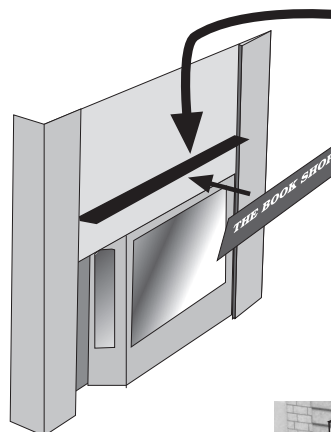

Fig. 11. SHOP SIGNS.

There are a number of alternative signs for you to choose from

The black sign top strip sits on top of the grey tab.

Then the shop sign is fitted underneath it against the grey 1st. floor tab, with the bottom of the sign leaning inwards at an angle.



The cinema sign sides fold at rightangles and the sign of your choice can be attached over the windows.

A cinema employee would have to climb out of the window and put up a ladder to change the lettering each time a new film came to town.

Finally, attach the base card then the steps into the cinema and the two shop doorsteps.

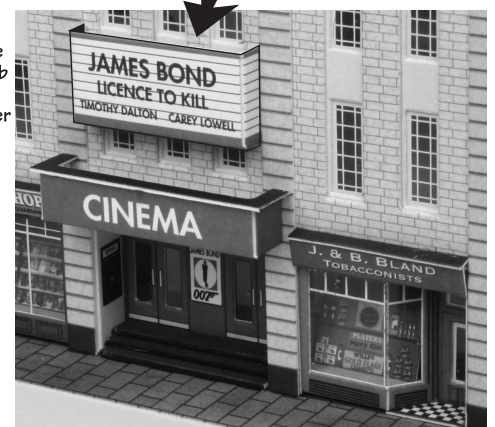

UHU GLUE TUBES

Although the 20ml. tubes of UHU have narrow nozzles, they are still a bit too big

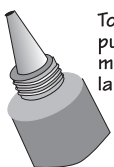

To make the nozzle smaller, put a piece of wire from a medium size paper clip or a large pin inside.

If using the glue frequently, it is not necessary to keep replacing the pin in the nozzle. To stop the glue running out, simply place the tube upright in an empty cup when not in use.

Then with a pair of pliers nip one side of the nozzle tightly, so that it squeezes the soft metal around the pin.

Keep the pin in the nozzle when not in use to stop it from blocking up.

