

READ THROUGH ALL THE INSTRUCTIONS BEFORE YOU START.

To construct this kit you will need the following:

1. A Modellers knife.
2. A pair of sharp pointed scissors.
3. A steel ruler.
4. Glue - UHU Clear Adhesive or Bostik Clear Adhesive are best.
Plastic Glue for the steps.
Make sure you get the tubes with the narrow nozzle for easy application.
5. A cutting surface - a sheet of card or a cutting mat.
6. Tweezers to hold the smaller components.

PLEASE NOTE

Each component is fastened to the sheet by means of a score line.

These are cut lines that have only gone about three quarters of the way through the card. To detach each component from the sheet, locate the score line that is holding it in place.

(most of these are clearly marked with blue arrows) and carefully run the point of your knife along the scoreline and the item will come seamlessly away.

CAUTION - be very careful when running the point of your knife along these score lines, it is easy to run out of the groove and cut something you shouldn't.

Your Work Surface

Keep offcuts to one side.

A clean flat working area

Kit bits ready for assembly.

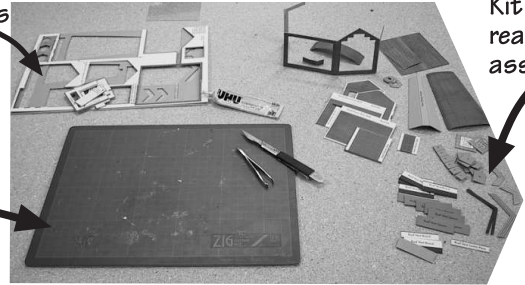

Keep it tidy. When you have extracted all the components from the sheet, place them in neat piles, FACE UP on sheets of thick card, so you can move them around as needed. TAKE CARE WITH SMALL COMPONENTS PLACE MULTIPLES IN PILES TOGETHER. DON'T THROW ANYTHING OUT. Offcuts can come in handy for bracing etc. and it also reduces the risk of accidentally throwing anything away.

CHECK LIST This kit pack should contain the following:

- 1 x SHEET A - Main building outer walls and weighbridge.
- 1 x SHEET B - Gable walls and office.
- 1 x SHEET C - Side walls and roof.
- 1 x GREY SHEET Inner strengthening components.
- 1 x GLAZING SHEET.
- 2 x A3 INSTRUCTION SHEETS.
- 1 x Ridge Tile Sheet.
- 1 x Brown roof trusses card

Fig. 1. OUTER BRICK FASCIA WALLS.

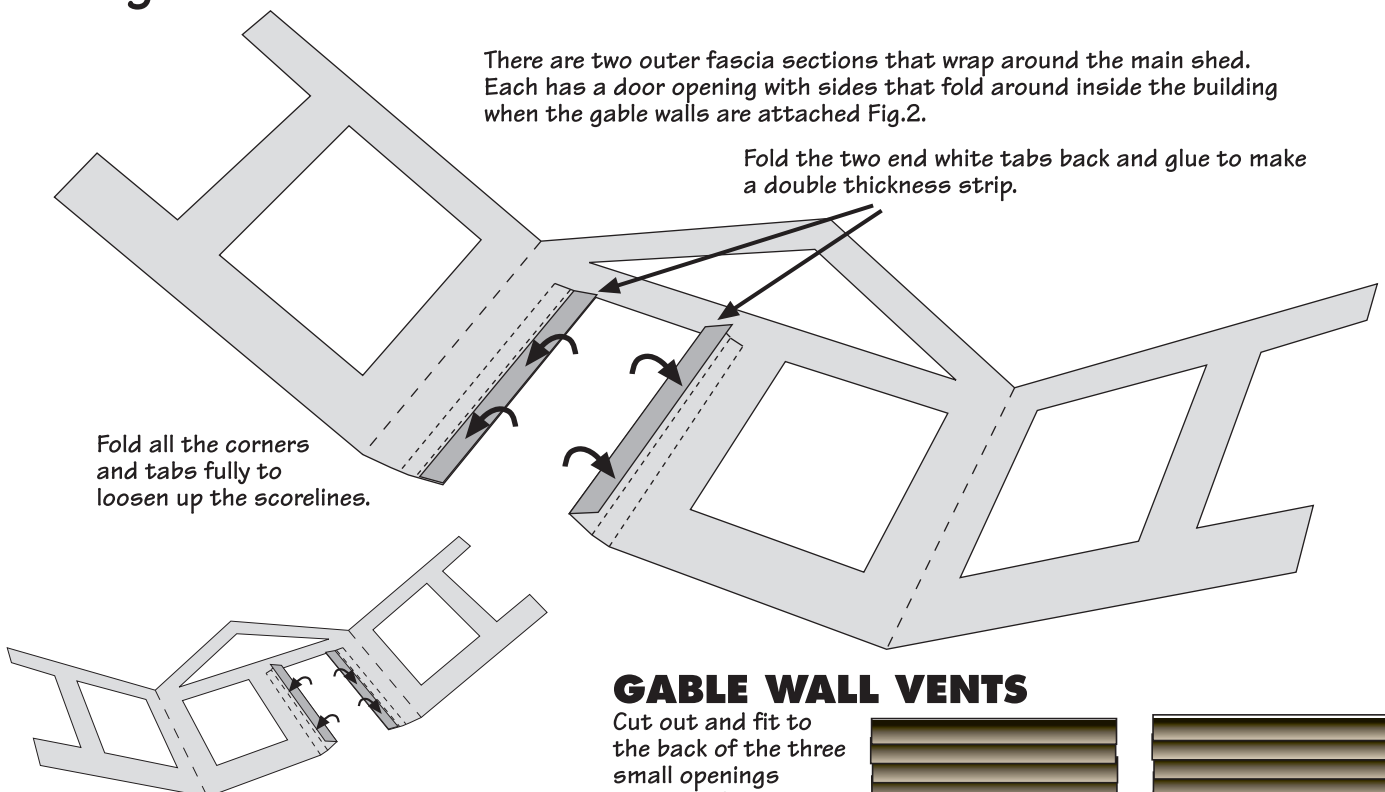

GABLE WALL VENTS

Cut out and fit to the back of the three small openings on each of the gable walls, before gluing the two halves back to back. See Fig. 2.

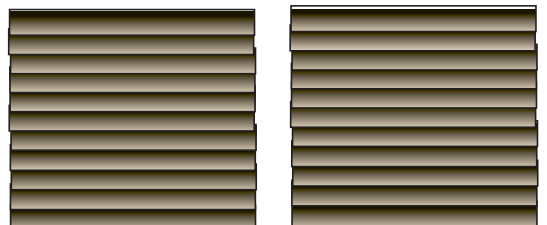

UNPRINTED THICK GREY CARD SHEETS.

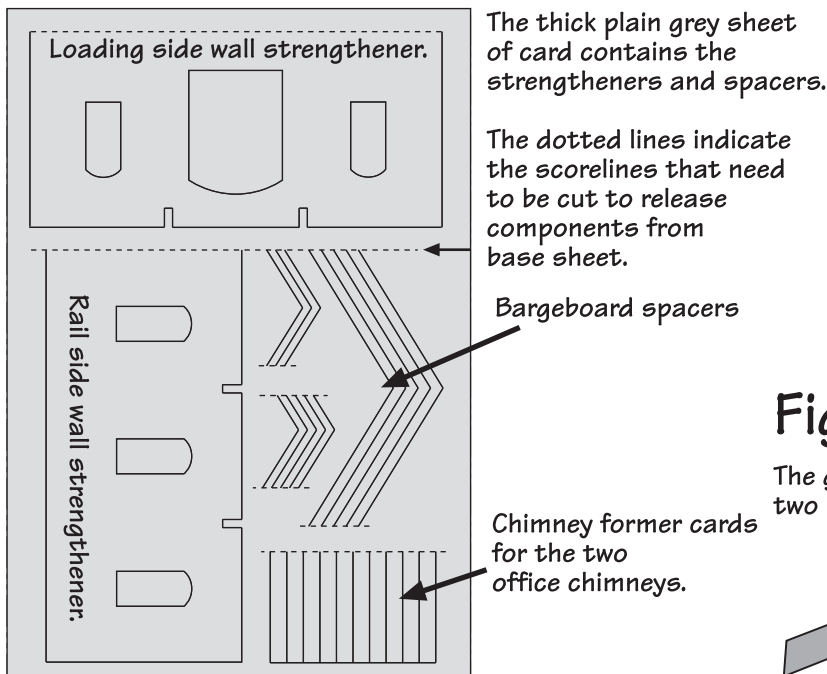

Fig. 2. GABLE WALLS.

The gable wall sections fold in half to give a two sided sheet.

BUT FIRST

Fix the vent to the back of the outer wall so that it shows through the three openings

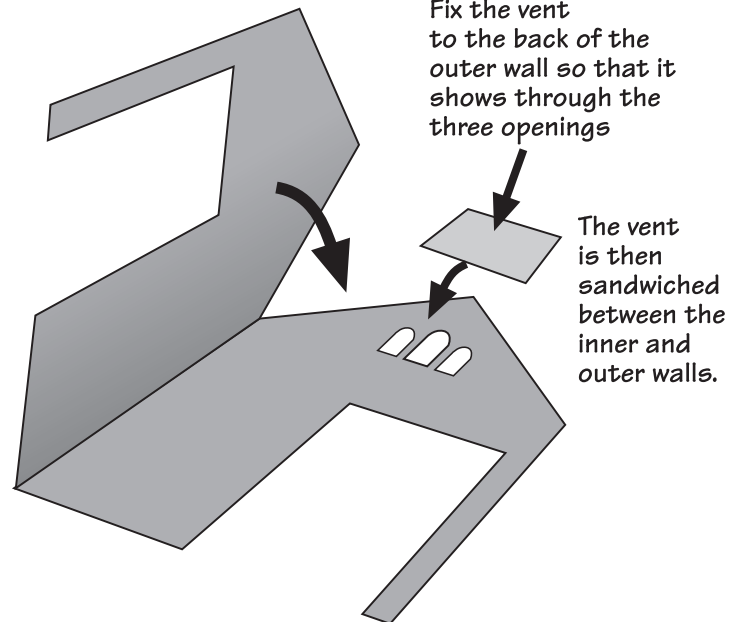

Fig. 3. FIX GABLES TO OUTER BRICK.

Fix the gable to the back of the outer brick so that the outer edges all line up flush.

Fold over the doorway side strips and glue to the inside wall.

Hold firmly until the glue is fully set.

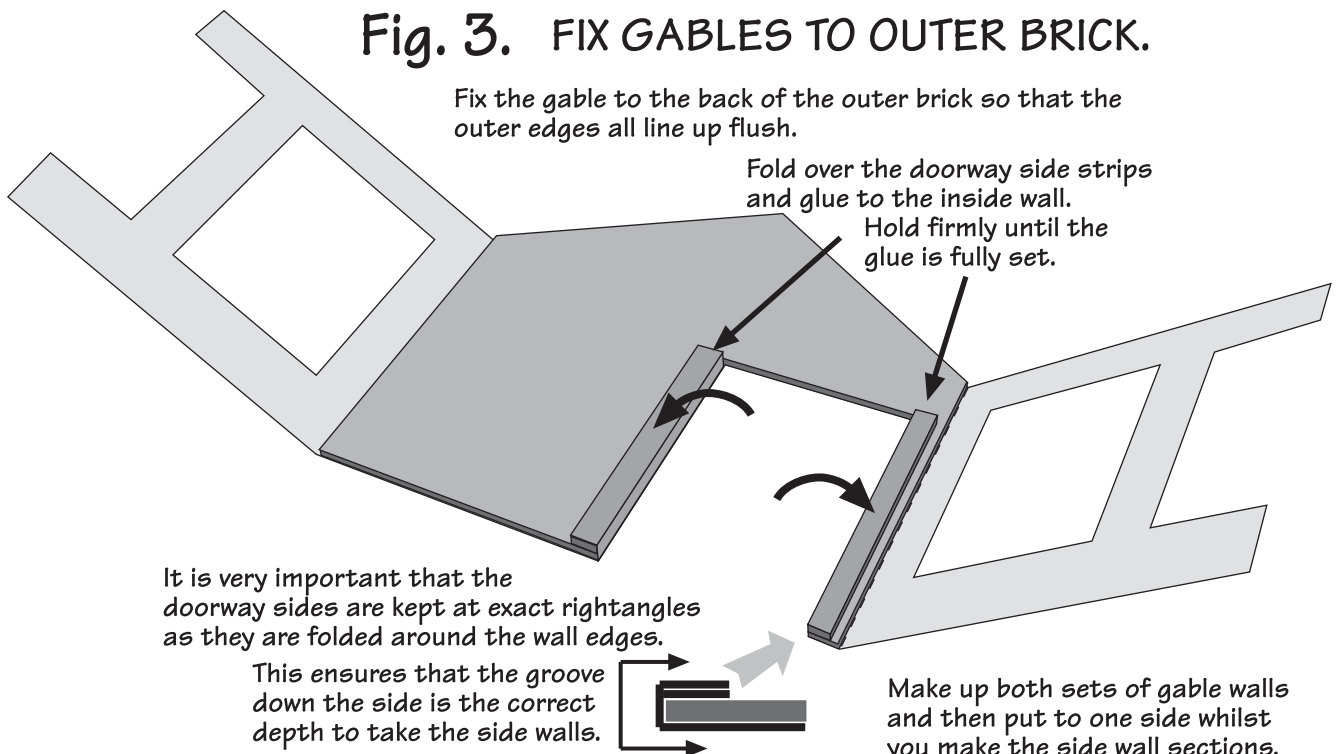

Fig. 4. THE SIDE WALLS.

The side walls are made by bonding three layers of card and a layer of glazing to make a thick and solid structure.

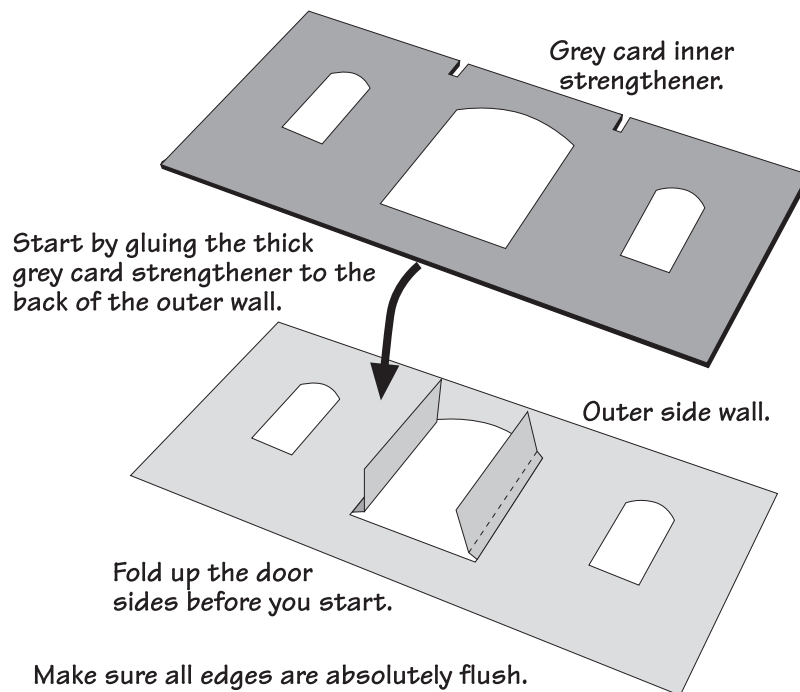

Fig. 5. FIT GLAZING & INNER WALL.

Glue the glazing to the back of the grey card so that the matt printed side faces out through the window openings.

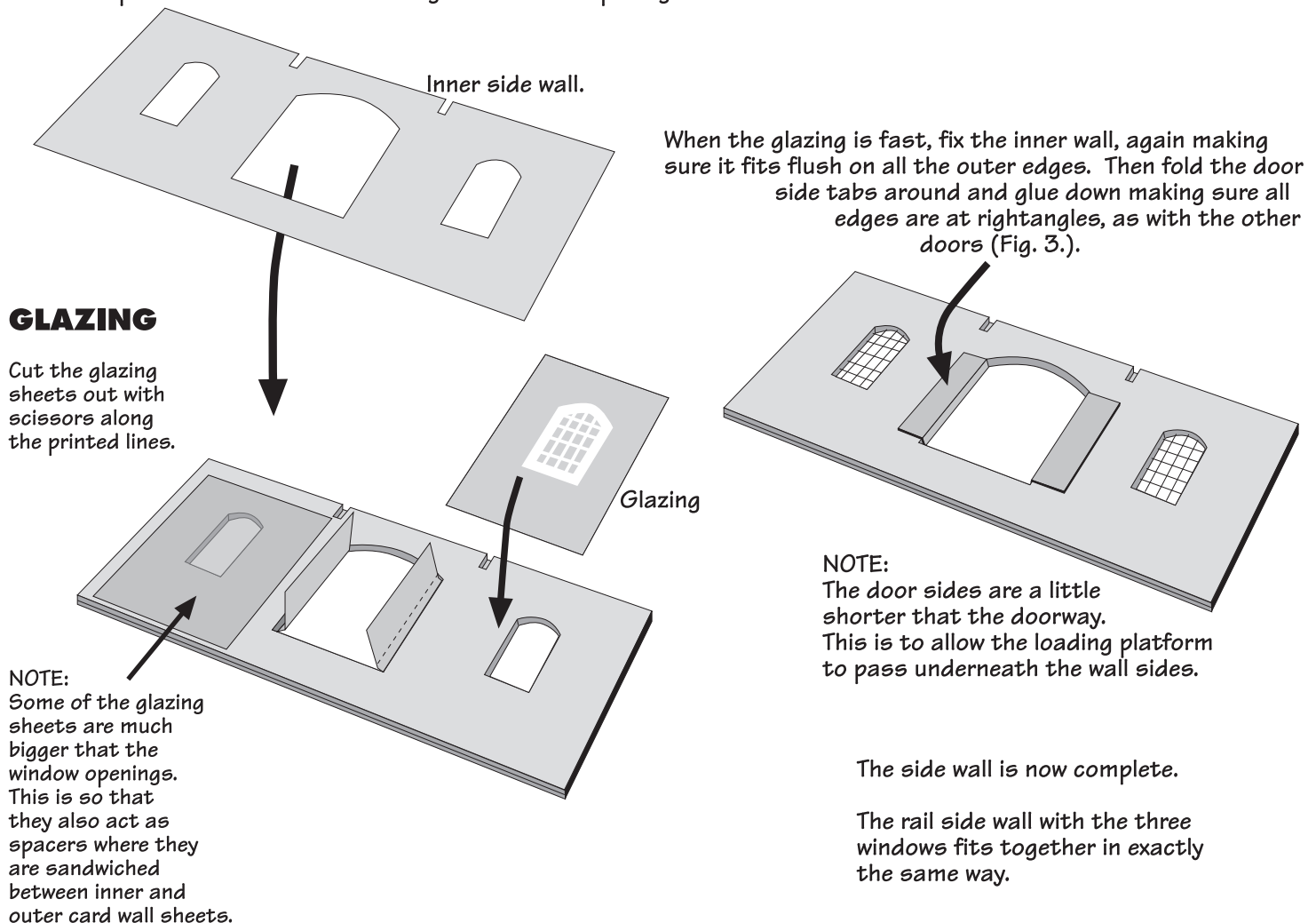
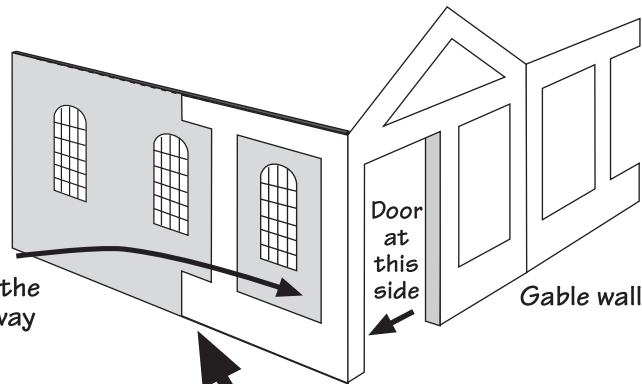

Fig. 6. ATTACH RAIL SIDE WALL TO OUTER BRICK.

The rail side wall is the one with the three windows. Fit to the DOOR side of the gable wall.

Make sure the wall is pushed firmly against the inside of the gable wall. The end should be sitting in the slot at the side of the doorway



Fold the outer brickwork around and fix to the side wall.

Fig. 7.

Fix the other half of the outer brickwork to the railside wall.

The two ends of the outer brickwork should meet butt ended together in the middle.

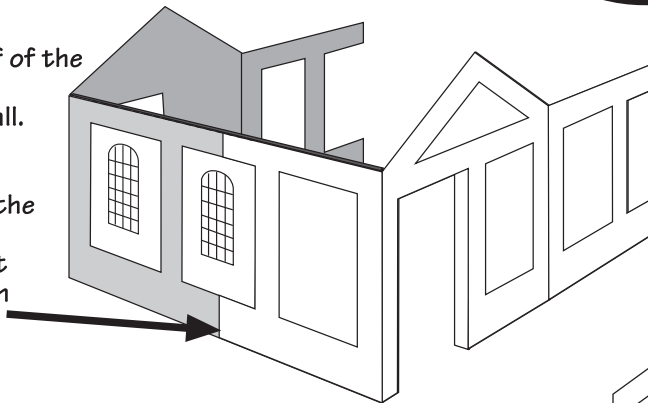
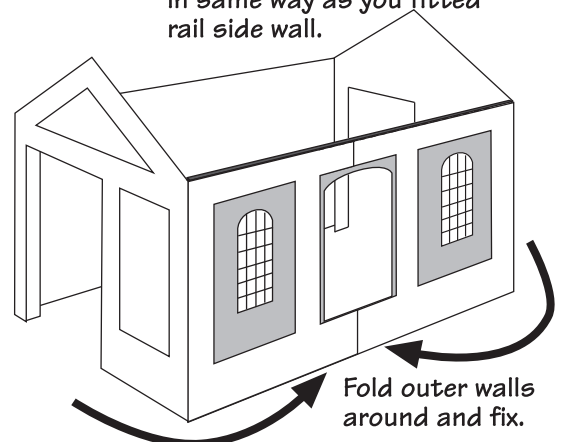

Fig. 8.

Fit loading door side wall in same way as you fitted rail side wall.



WARNING, MAKE SURE YOU ARE FIXING THE CORRECT SIDE WALLS TO THE OUTER BRICK WALLS. IT IS VERY EASY TO GET IT WRONG. TEST FIRST.

Fig.9. INNER PLATFORM.

Place the platform top, FACE DOWN, on your work surface. Then fold back the narrow platform edging on the long front edge and glue back to the underside of the platform. DON'T fold the shorter one at the other side just yet.

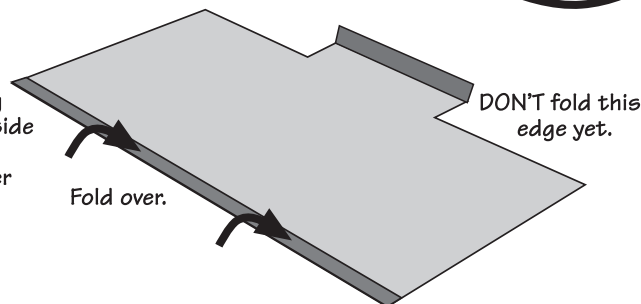

Chimney Pots

PLEASE NOTE - once you have perfected the art of rolling your own chimney pots you will soon realise that they are extremely realistic. Much better than anything made from plastic or white metal. So please be patient & keep trying, the chimney pots make all the difference.

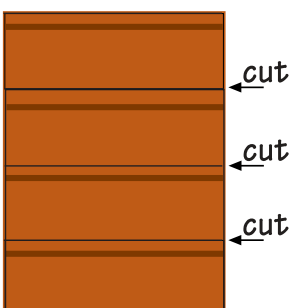

Cut into strips then roll tightly around a nail or screw (apx. 3-4mm dia.) and fix the end with a tiny spot of glue. Paint the insides black to get rid of the white card then finish off by cutting pointed edges with a fine knife or scissors.



Curl strip slightly first.



Roll up tight then unroll the end enough to smear with a little glue then roll backup and hold tight until fast.

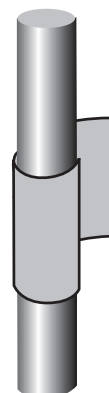

Fig. 10. INNER PLATFORM.

Fix the inner platform wall to the underside so it stands up against the strip. Brace from behind using card pushed out from the windows.

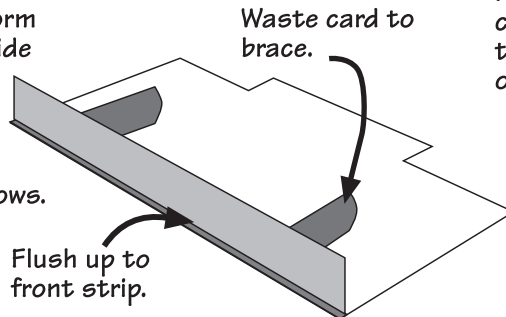
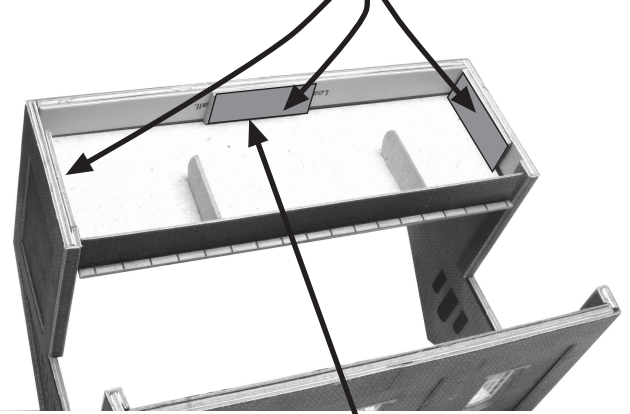

Fig. 11. FIT INNER PLATFORM.

Fit the platform in to the building from underneath. carefully feed the loading door part of the platform through the door so it fits in the slots at the base of the door side walls.

Then fit the three inner platform fixing tabs



Put plenty of glue on the top edges so that when you turn the building back over, the platform can be pressed onto the tabs and they will hold it in place. Press the sides of the building against the platform edges until the whole thing is fast and rigid.

Fig. 12. DOORS.

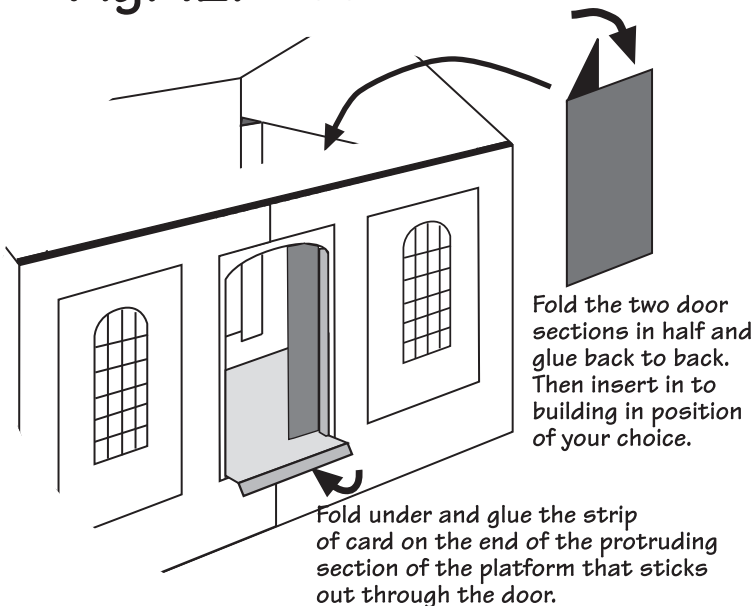
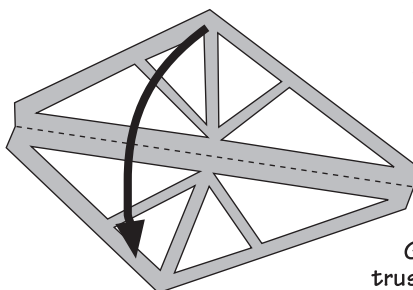

Fig. 13. ROOF TRUSSES.

There are two self adhesive backed roof trusses, die cut on to brown card. Peel then out from the base card and fold each one in two along the centre scoreline. Press firmly together so all edges stick.



There are two slots in each inner side wall. These are for the roof trusses to sit in.

Glue the ends of the trusses and place in slots on inner wall tops. Hold upright until they are fast.

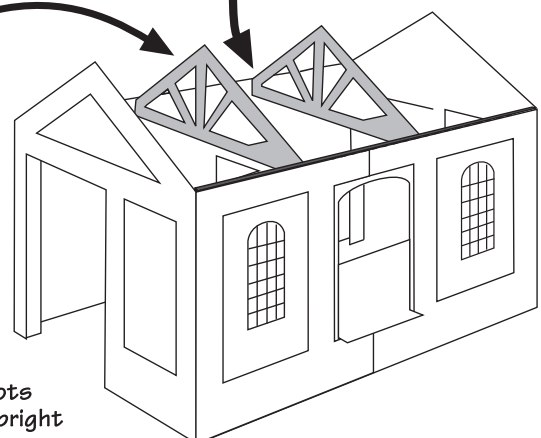

Fig. 20.

OUTER PLATFORM.

Place the platform top face down and then fold the two side trips over and glue (as you did with the inner platform) BUT FIRST, cut a tiny nick out of the strip at the point where the ramp folds down.

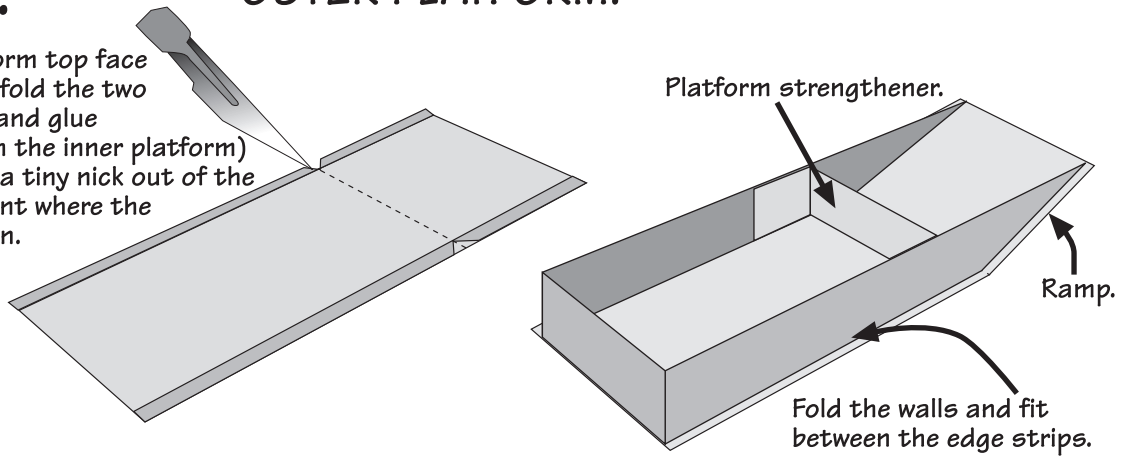
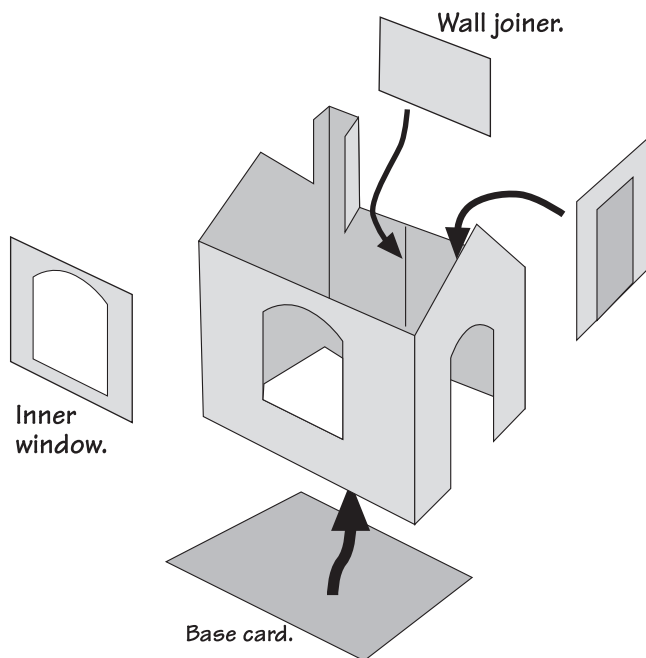

Fig. 21. WEIGHBRIDGE OFFICE.



The weighbridge goes together in the following order:

1. Fix glazing to the door.
2. Fit the door inside the building.
3. Fit glazing to inner window
4. Fit inner window inside the building.
5. fold the building around the base card
Note: if you want the door to open, you will need to cut a little bit away to give it space.
6. Fit the inner joiner to the back wall.
7. Make the chimney stack, see Fig.16.
8. Fit the roof.
9. Fit bargeboards.

Fig. 22.

Assemble the chimney tops

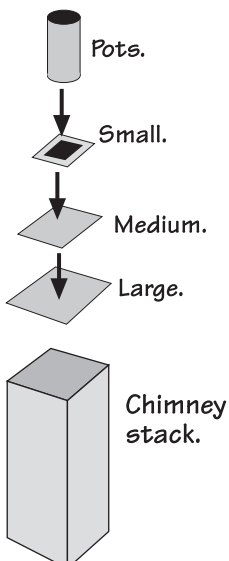

It should end up looking like this.



Fig. 14. ROOF.

Fit the glazing to the underside of the openings and when fast fit the roof to the building so that the sides overhang equally on all edges.

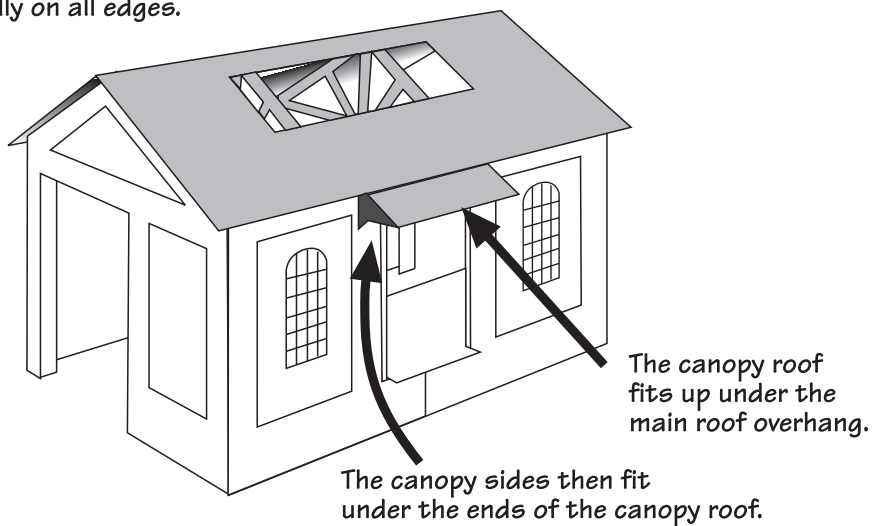

Fig. 15. OFFICE.

Fold up the three tabs on the office walls and fix to back of walls, and then fold the walls around the office floor card so that it sits on top of the three tabs.

There is a protruding part that fits through the door and a tab on the end that folds underneath.

The back walls should meet end to end, Brace the two joining walls from inside using some waste card.

Fit the door after the inner floor is in place.

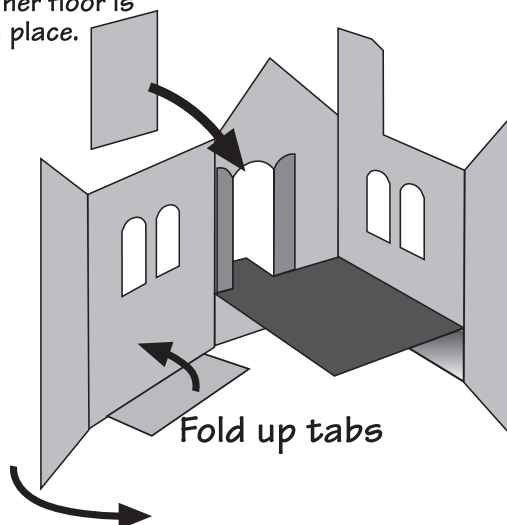

The office should now look like this.



Fig. 16. OFFICE CHIMNEY.

There are ten chimney formers on the thick grey card sheet. Glue five of them in to a solid block, making sure all edges are squared up at rightangles.

The chimney stack is then folded around the card block. Hold tight until the glue has set.

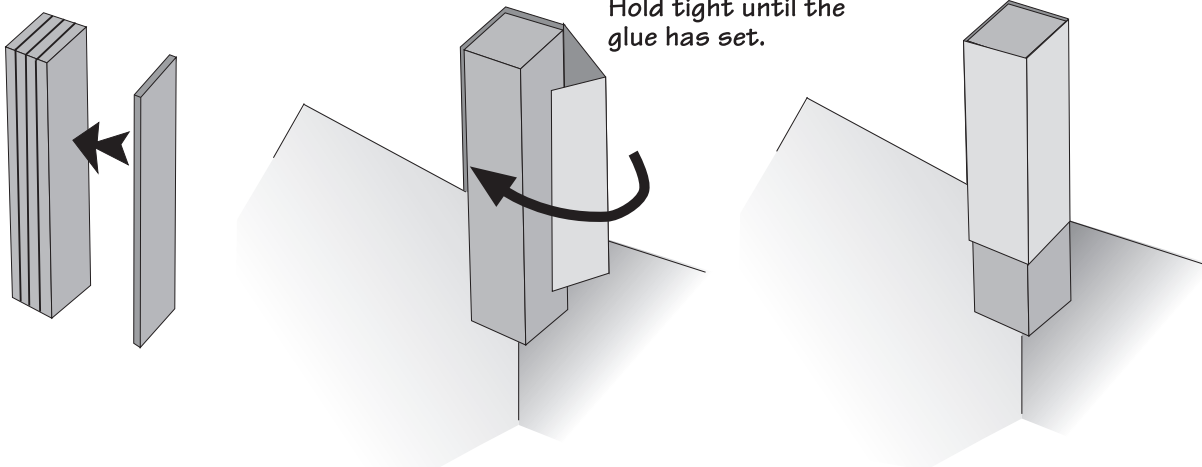

Fig. 17.
FIX OFFICE TO MAIN SHED.

The office can be fitted to either end of the goods shed, but whichever end you choose, you will need to put back the piece of card taken out of the relief brick walls

The tab on the office step folds under and glues to make double thick. When the steps are made they will fit underneath this top step.

Put back the card that was pushed out earlier, to make the shed wall flat. Then the office can be attached to a level surface.

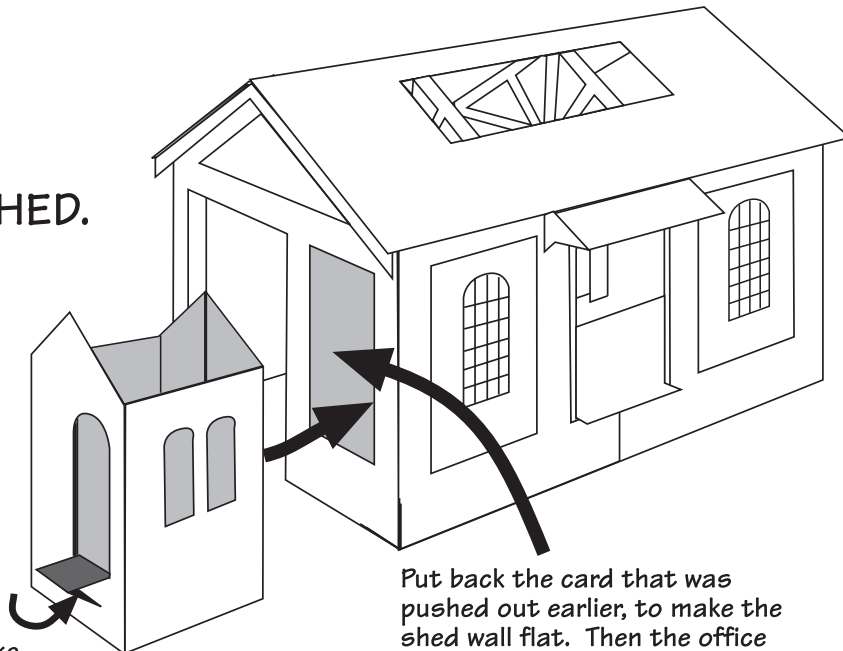
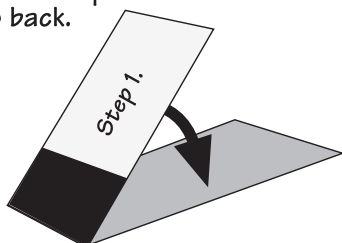

Fig. 18. OFFICE STEPS.

Each step folds in half, then is glued back to back to make it double thickness.

Glue all six steps back to back.



Glue the steps on top of each other, starting at the bottom with the longest step no. 1.

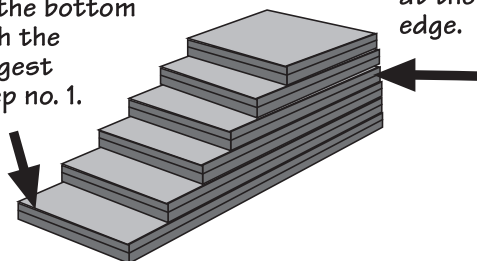

Line all the steps up vertically at the back edge.

When the steps are fast, attach the small wall to the side and back.

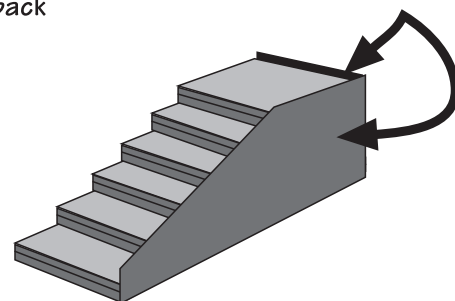

Fit the roof after the office walls have been fixed to main building.

Fit steps here.

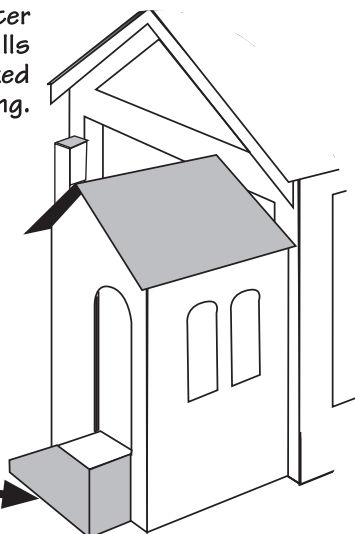
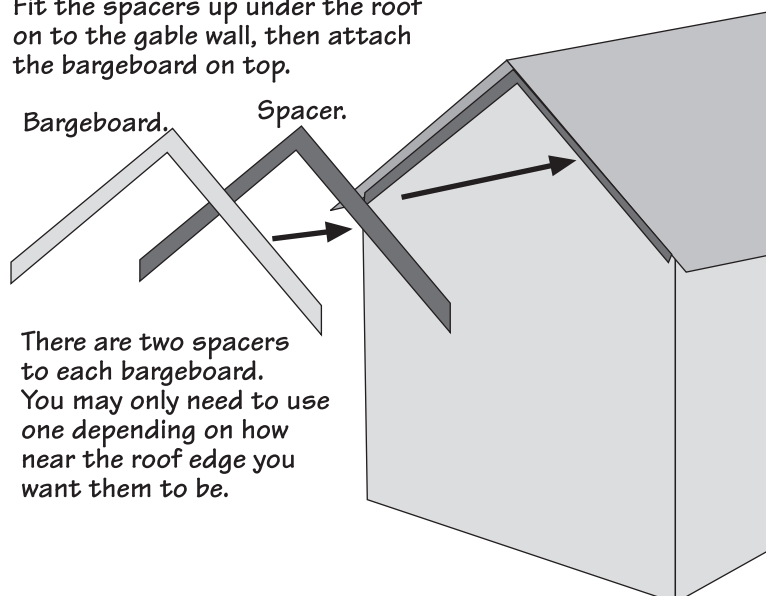

Fig. 19. BARGEBOARDS.

Fit the spacers up under the roof on to the gable wall, then attach the bargeboard on top.

Bargeboard.

Spacer.



There are two spacers to each bargeboard. You may only need to use one depending on how near the roof edge you want them to be.